Report To:	THE INVERCLYDE COUNCIL	Date: 19 FEBRUARY 2015
Report By:	CORPORATE DIRECTOR, ENVIRONMENT, REGENERATION & RESOURCES	Report No: LP/026/15
Contact Officer:	JOANNA DALGLEISH	Contact No: 01475 712123
Subject:	PROPOSED TRAFFIC REGULATION ORDER – DISABLED PERSONS’ PARKING PLACES (ON-STREET) ORDER NO. 3 2014	

1.0 PURPOSE

- 1.1 The purpose of this report is to request the Council to consider a remit from the Environment & Regeneration Committee.

2.0 SUMMARY

- 2.1 The Environment & Regeneration Committee held on 15 January 2014 after consideration of a Report by the Corporate Director Environment, Regeneration & Resources on the proposed Traffic Regulation Order – The Inverclyde Council, Disabled Persons’ Parking Places (On-Street) Order No. 3 2014 recommended that the Inverclyde Council be asked to make the Traffic Regulation Order and remit it to the Head of Environmental and Commercial Services and the Head of Legal and Property Services to arrange for its implementation.

3.0 RECOMMENDATION

- 3.1 That the Inverclyde Council approve the making of the Traffic Regulation Order – The Inverclyde Council, Disabled Persons’ Parking Places (On-Street) Order No. 3 2014, all as detailed in the copy of the proposed Order forming a supplement to the principal Minute hereof, and that the Head of Environmental and Commercial Services and the Head of Legal and Property Services be authorised to take all necessary action in connection therewith. Appendix 1

Gerard Malone
Head of Legal and Property Services

4.0 BACKGROUND

- 4.1 Local Authorities are empowered to make Orders under the Road Traffic Regulation and Roads (Scotland) Acts 1984 and under the Council's Scheme of Administration the Head of Environmental and Commercial Services is responsible for the making, implementation and review of Traffic Management Orders and Traffic Regulation Orders.
- 4.2 The provision of on-street parking places for use by disabled drivers, who are the holders of a Disabled Person's Badge, is regulated by The Disabled Persons' Parking Places (Scotland) Act 2009. Inverclyde Council is required to promote a Traffic Regulation Order to regulate the use of such parking places.
- 4.3 The Council is asked to note that, if approved, the Order may not be implemented until the making of the Order has been advertised to allow any persons who so wish a period of six weeks to question the validity of the Order in terms of the Road Traffic Regulation Act 1984.

5.0 IMPLICATIONS

Finance

- 5.1 There are no financial implications arising from this report.

Legal

- 5.2 There are no legal implications arising from this report.

Human Resources

- 5.3 There are no HR implications arising from this report.

Equalities

- 5.4 There are no equalities implications arising from this report.

Repopulation

- 5.5 There are no repopulation implications arising from this report.

6.0 CONSULTATIONS

- 6.1 The proposals have been advertised in the Greenock Telegraph and full details of the proposals have been made available for public inspection during normal office hours at the offices of the Head of Environmental and Commercial Services, the Head of Legal and Property Services and at Central Library, Port Glasgow Library, Gourock Library and Inverkip & Wemyss Bay Library.

7.0 LIST OF BACKGROUND PAPERS

- 7.1 None

THE INVERCLYDE COUNCIL
DISABLED PERSONS' PARKING PLACES
(ON-STREET) ORDER NO. 3 2014
TRAFFIC REGULATION ORDER

DRAFT

THE INVERCLYDE COUNCIL
DISABLED PERSONS' PARKING PLACES (ON-STREET)
ORDER NO. 3 2014

The Inverclyde Council in exercise of the powers conferred on them by Sections 32(1) of the Road Traffic Regulation Act 1984 ("the Act") and of all other enabling powers and after consultation with the Chief Constable of Police Scotland in accordance with Part III of Schedule 9 to the Act hereby make the following Order.

1. This Order may be cited as "The Inverclyde Council Disabled Persons' Parking Places (On-Street) Order No. 3 2014" and shall come into operation on #####.
2. In this Order the following expressions have the meanings hereby assigned to them
 - "Council" means The Inverclyde Council or its successors as Roads Authority;
 - "disabled person's badge" means:
 - (a) a badge issued under Section 21 of the Chronically Sick and Disabled Persons Act 1970 (as amended);
 - (b) a badge issued under a provision of the law of Northern Ireland corresponding to that section; or
 - (c) a badge issued by any member State other than the United Kingdom for purposes corresponding to the purposes for which badges under that section are issued;and has not ceased to be in force.
 - "disabled person's vehicle" means a vehicle lawfully displaying a disabled person's badge;
 - "parking attendant" means a person employed in accordance with Section 63A of the Act to carry out the functions therein;
 - "parking place" means a place where a vehicle, or vehicles of any class, may wait i.e. the area of land specified in the Schedule for which the use as a parking place has been authorised by the Council under Section 32(1) of the Act;
 - "traffic sign" means a sign prescribed or authorised under Section 64 of the Act;
 - "vehicle" unless the context otherwise requires, means a vehicle of any description and includes a machine or implement of any kind drawn or propelled along roads whether or not by mechanical power;
3. Each area of road which is described in the Schedule and plans relative to this Order is hereby designated as a parking place.
4. The parking places designated in this Order shall only be used for the leaving of disabled persons' vehicles displaying a valid disabled person's badge.

5. The limits of each parking place designated in this Order shall be indicated on the carriageway as prescribed by The Traffic Signs Regulations and General Directions 2002.
6. Every vehicle left in any parking place designated in this Order shall stand such that no parking place is occupied by more than one vehicle and that every part of the vehicle is within the limits of the parking place provided that, where the length of a vehicle precludes compliance with this paragraph, such vehicle shall be deemed to be within the limits of a parking place if;
 - i. the extreme front portion or, as the case may be, the extreme rear portion of the vehicle is within 300mm of an indication on the carriageway provided under this Order in relation to the parking place; and
 - ii. the vehicle, or any part thereof, is not within the limits of any adjoining parking place.
7. Any person duly authorised by the Council or a police officer in uniform or a traffic warden or parking attendant may move or cause to be moved in case of any emergency, to any place they think fit, vehicles left in a parking place.
8. Any person duly authorised by the Council may suspend the use of a parking place or any part thereof whenever such suspension is considered reasonably necessary:
 - i. for the purpose of facilitating the movement of traffic or promoting its safety;
 - ii. for the purpose of any building operation, demolition, or excavation in or adjacent to the parking place or the laying, erection, alteration, removal or repair in or adjacent to the parking place of any sewer or of any main, pipe, apparatus for the supply of gas, water electricity or of any telecommunications apparatus, traffic sign or parking meter;
 - iii. for the convenience of occupiers of premises adjacent to the parking place on any occasion of the removal of furniture from one office or dwellinghouse to another or the removal of furniture from such premises to a depository or to such premises from a depository;
 - iv. on any occasion on which it is likely by reason of some special attraction that any street will be thronged or obstructed; or
 - v. for the convenience of occupiers of premises adjacent to the parking place at times of weddings or funerals or on other special occasions.
9. A police officer in uniform may suspend for not longer than twenty four hours the use of a parking place or part thereof whenever such suspension is considered reasonably necessary for the purpose of facilitating the movement of traffic or promoting its safety.

10. This Order insofar as it relates to the parking places to be revoked (R) and amended, as specified in the Schedule to this Order, partially revokes and amends The Inverclyde Council On-Street Parking Places (Without Charges) Order Nos: 01/2003, 01/2004, 02/2006, 01/2008, 02/2008, The Inverclyde Council Disabled Persons' Parking Places (On-Street) Order Nos: 01/2010, 02/2013, 04/2013 and 01/2014 respectively.

Sealed with the Common Seal of The Inverclyde Council and subscribed for them and on their behalf by ##

DRAFT

INVERCLYDE COUNCIL

DISABLED PERSONS' PARKING PLACES (ON-STREET) ORDER No.3 2014

SCHEDULE

Rev A

All and whole that area of ground as described in Column 2 in the table below:

<u>Ref No.</u>	<u>Address of Disabled Person's Parking Place to be created or revoked ® "ex-adverso"</u>
1379	45 Glen Crescent, Inverkip
1381	55 Finch Road, Greenock
1401	0 Papermill Road, Greenock
1406	15 Newton Street, Greenock
1407	33 Cambridge Road, Greenock
1408	50 Brougham Street, Greenock
1410	0 Murdieston Street, Greenock
1412	49 Glenside Road, Port Glasgow
1416	46 Hillend Drive, Greenock
1417	75 Berwick Road, Greenock
1418	77 Langside Terrace, Port Glasgow
1420	19 Sandray Avenue, Port Glasgow
1422	16 Northfield Avenue, Port Glasgow
0260	142 Finnart Street, Greenock ®
0332	81 Waverley Street, Greenock ®
0635	13 Fort Matilda Place, Gourock ®
0750	16 Grenville Road, Gourock ®
0815	21A Margaret Street, Greenock ®
0945	141 Marloch Avenue, Port Glasgow ®
1257	18 Flatterton Road, Greenock ®
1304	14 Ashton Road, Gourock ®
1333	57 Bridgend Avenue, Port Glasgow ®
1343	28 Braeside Road, Greenock ®
1352	15 Ashton Road, Gourock ®

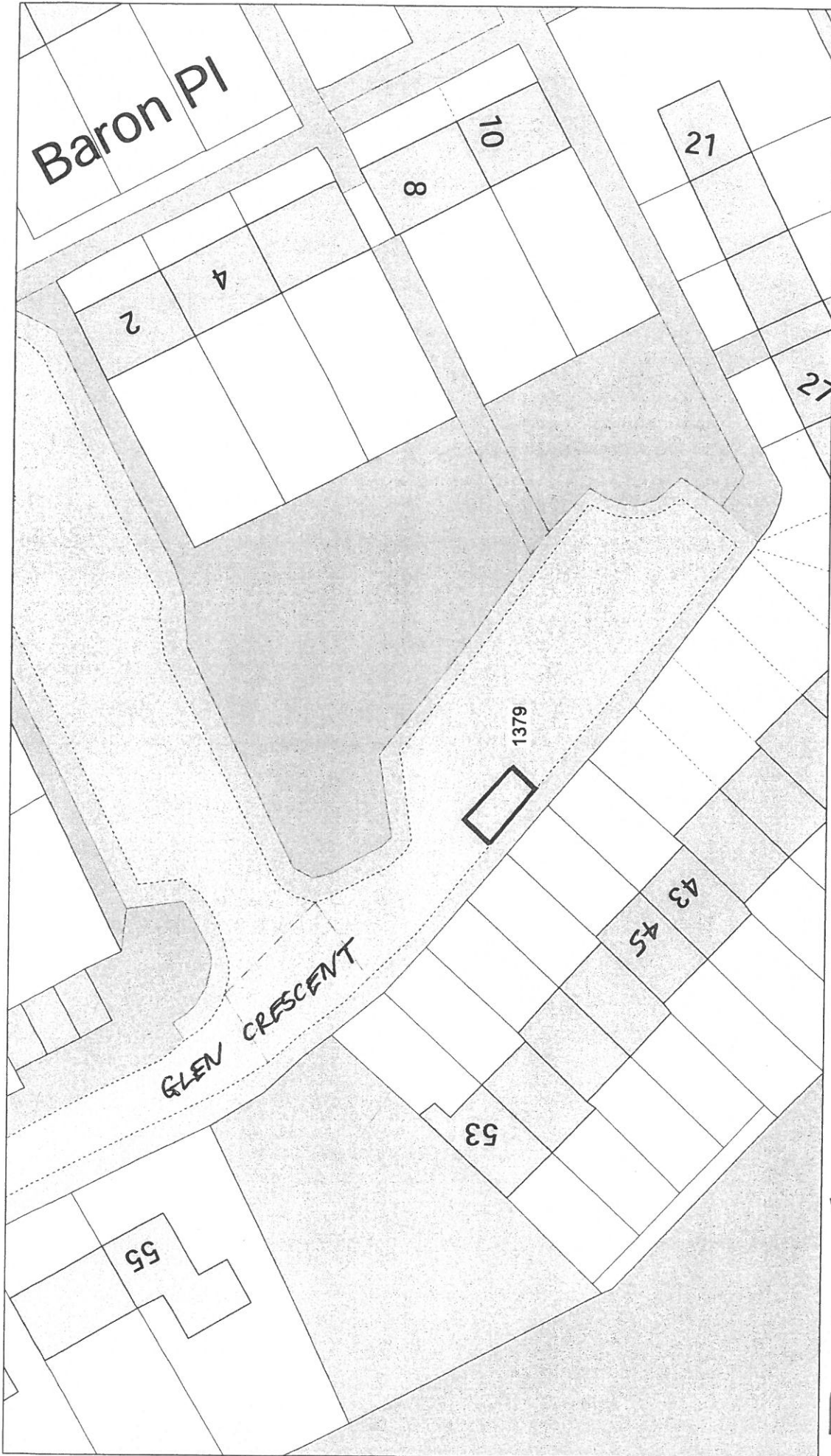

The material has been reproduced from Ordnance Survey digital map data with the permission of the Controller of Her Majesty's Stationery Office. © Crown copyright. Licence Number: nnnnnn

DISABLED PERSONS' PARKING PLACE
 45 GLEN CRESCENT, INVERKIP
 PLACE No. 1379



Sterling Court
 Norton Road
 Stevenage
 Herts SG1 2JY
 UK
 Tel : +44 (0)1438 747996
 Fax : +44 (0)1438 747997
 E-mail: info@cadcorp.com



The material has been reproduced from Ordnance Survey maps with the permission of the Controller of Her Majesty's Stationery Office. License Number: 1000000000



DISABLED PERSONS' PARKING PLACE
55 FINCH ROAD, GREENOCK
PLACE No. 1381



Sterling Court
Norton Road
Stevenage
Herts SG1 2JY
UK
Tel : +44 (0)1438 747996
Fax : +44 (0)1438 747997
E-mail: info@cadcorp.com

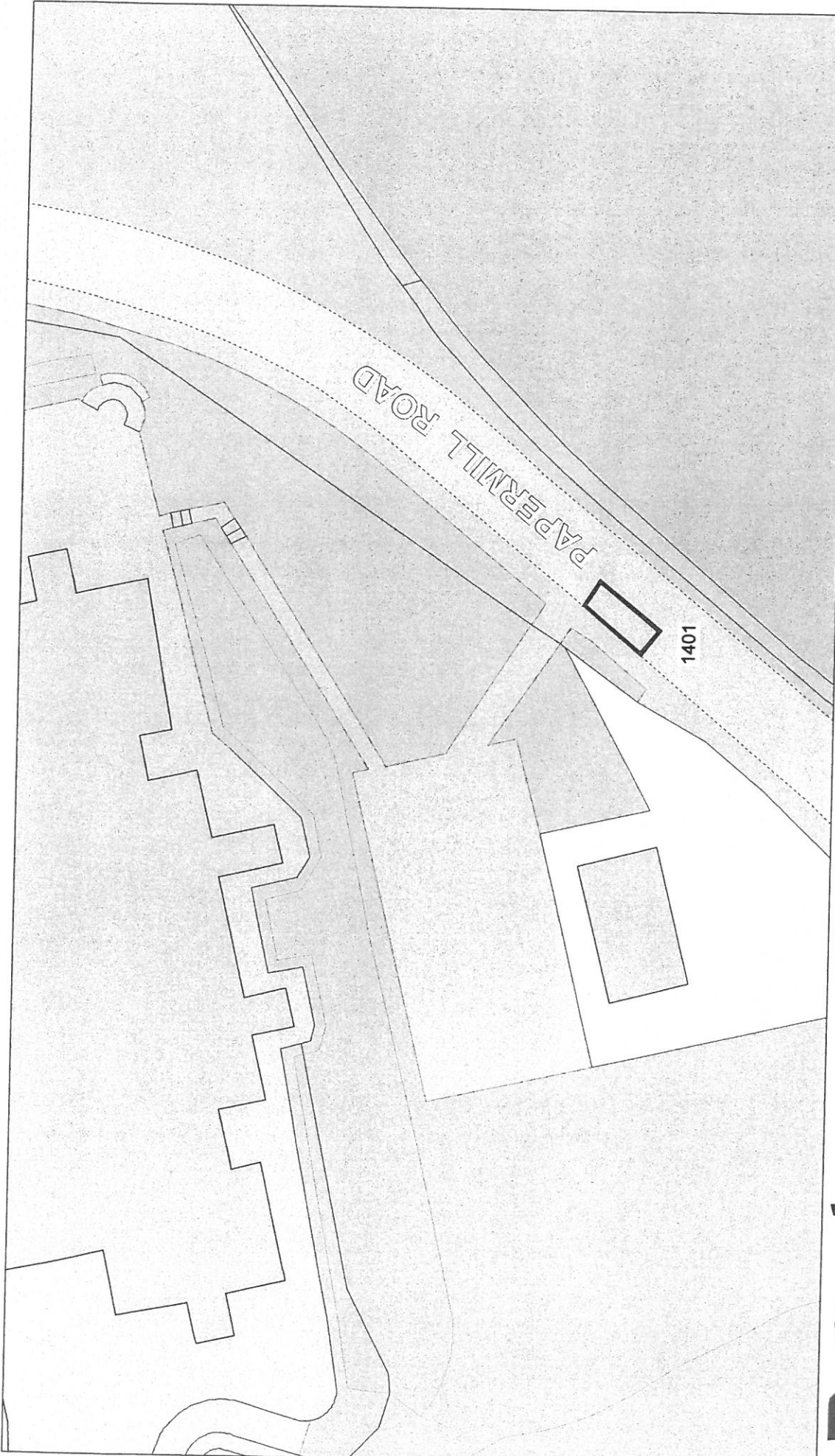

Licensed System Supplier

This material has been reproduced from Ordnance Survey map data with the permission of the Controller of Her Majesty's Stationery Office. © Crown copyright. Licence Number: nnnnnn

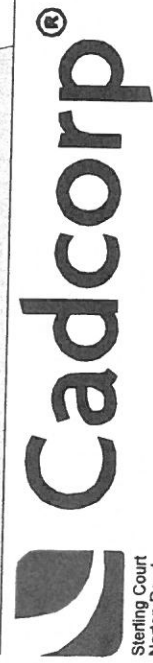

Sterling Court
Norton Road
Stevenage
Herts SG1 2JY
UK

Tel : +44 (0)1438 747996
Fax : +44 (0)1438 747997
E-mail: info@cadcorp.com

DISABLED PERSONS' PARKING PLACE
PAPERMILL ROAD, GREENOCK
PLACE No. 1401

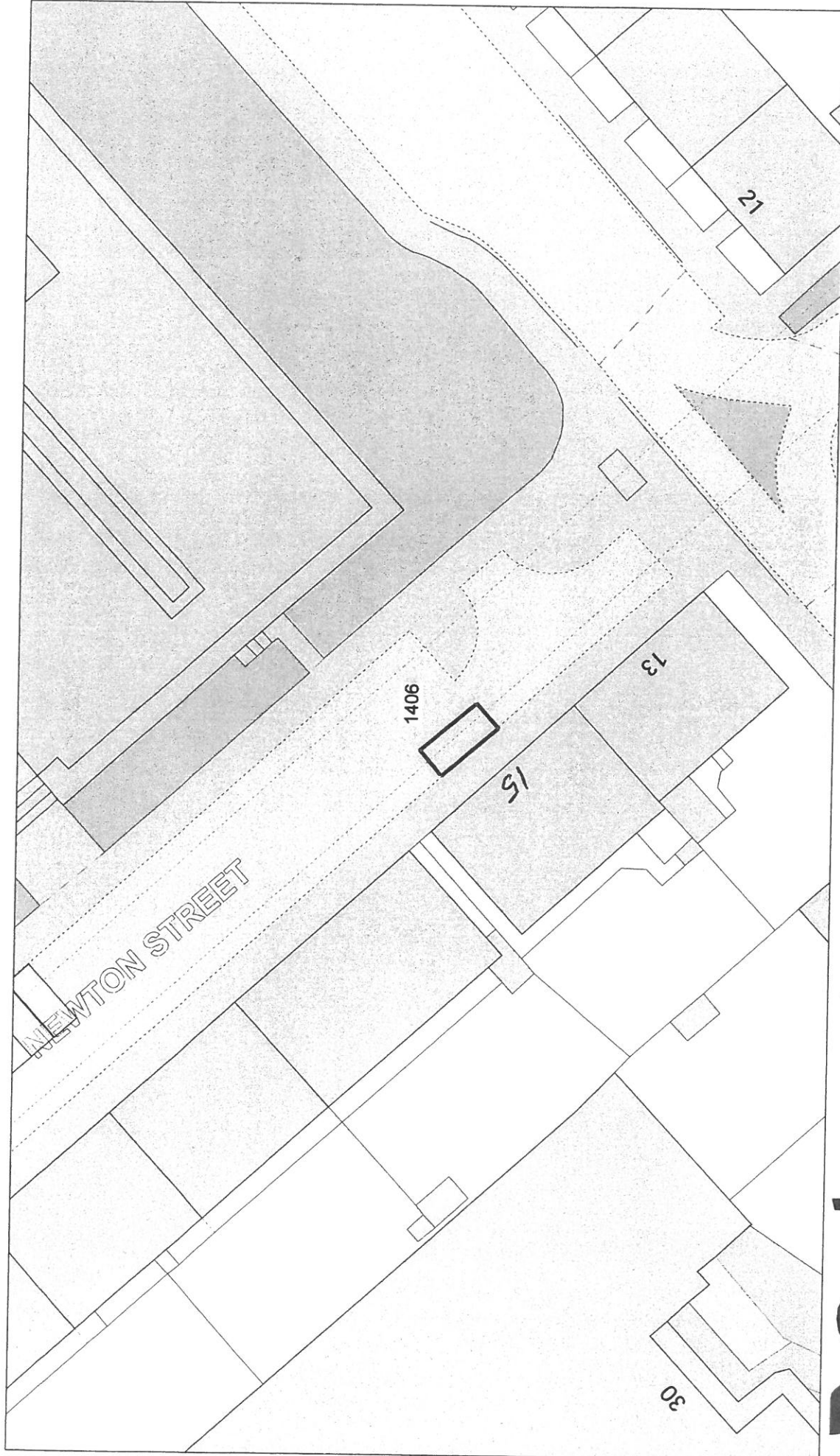

The material has been reproduced from Ordnance Survey data with the permission of the Controller of Her Majesty's Stationery Office. Licence Number: 100019999

DISABLED PERSONS' PARKING PLACE
15 NEWTON STREET, GREENOCK
PLACE No. 1406



Sterling Court
Norton Road
Stevenson
Glasgow G5 1JY
UK
Tel : +44 (0)1438 747996
Fax : +44 (0)1438 747997
E-mail : info@cadcorp.com

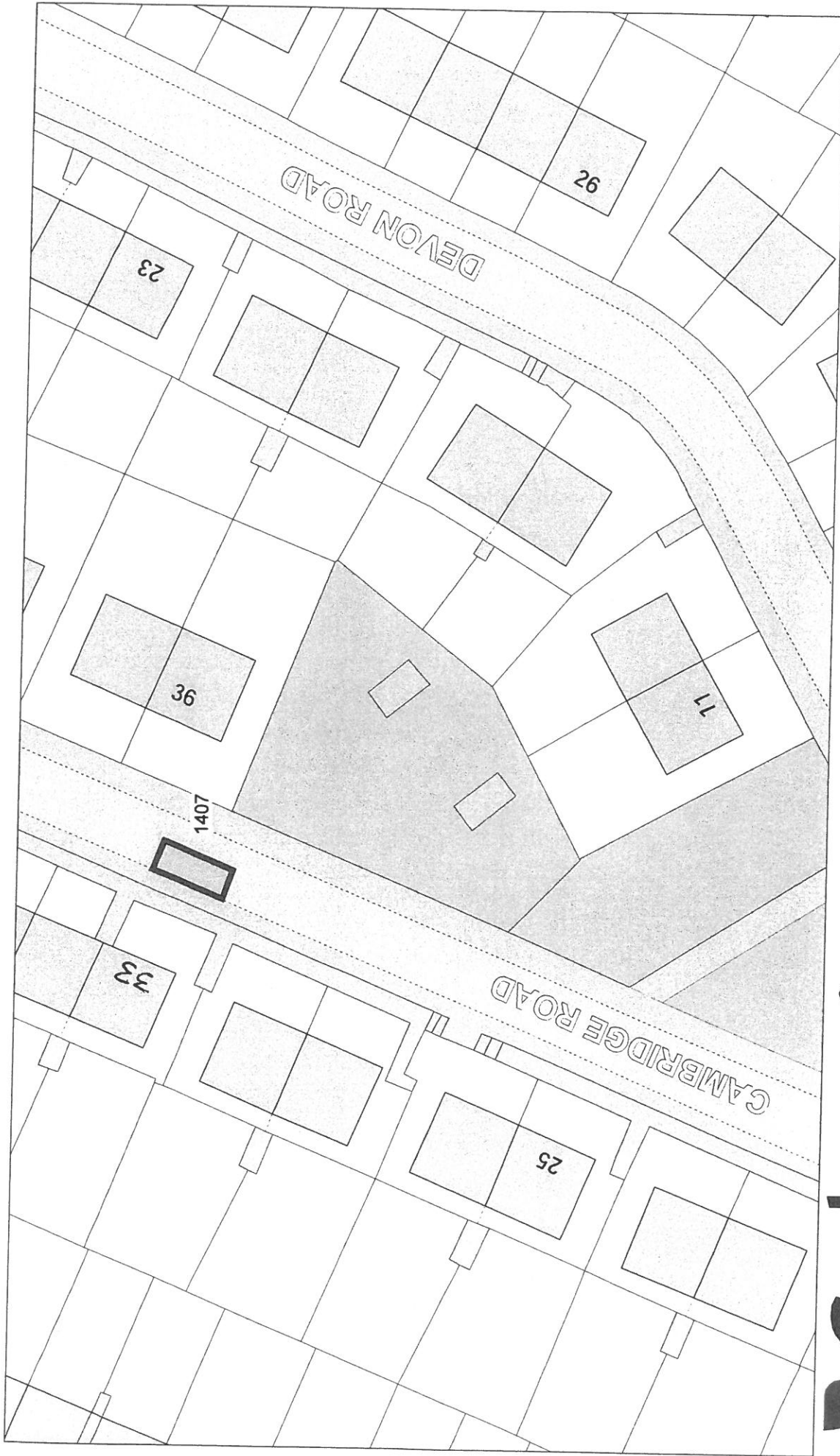

The material has been reproduced from Ordnance Survey digital map data with the permission of the Controller of Her Majesty's Stationery Office. © Crown copyright. Licence Number: 100000000



Sterling Court
Norton Road
Stevenage
Herts SG1 2JY
UK

Tel : +44 (0)1438 747996
Fax : +44 (0)1438 747997
E-mail: info@cadcorp.com

DISABLED PERSONS' PARKING PLACE
33 CAMBRIDGE ROAD, GREENOCK
PLACE No. 1407

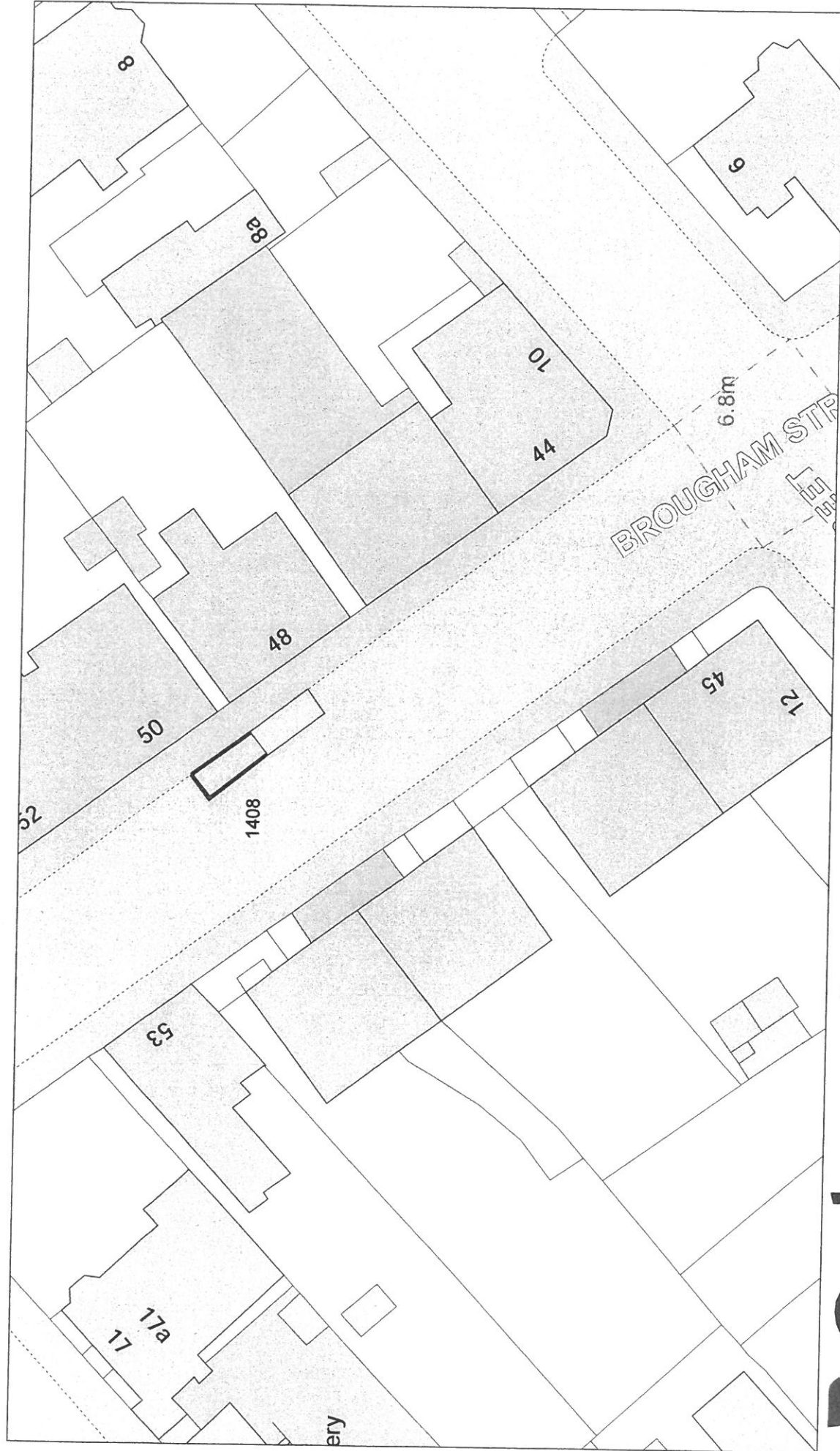

The material has been reproduced from Ordnance Survey digital map data with the permission of Her Majesty's Stationery Office.
 © Crown copyright. Licence Number: INNNNN

DISABLED PERSONS' PARKING PLACE
50 BROUGHAM STREET, GREENOCK
PLACE No. 1408



Sterling Court
 Norton Road
 Stevenage
 Herts SG1 2JY
 UK
 Tel : +44 (0)1438 747996
 Fax : +44 (0)1438 747997
 E-mail: info@cadcorp.com

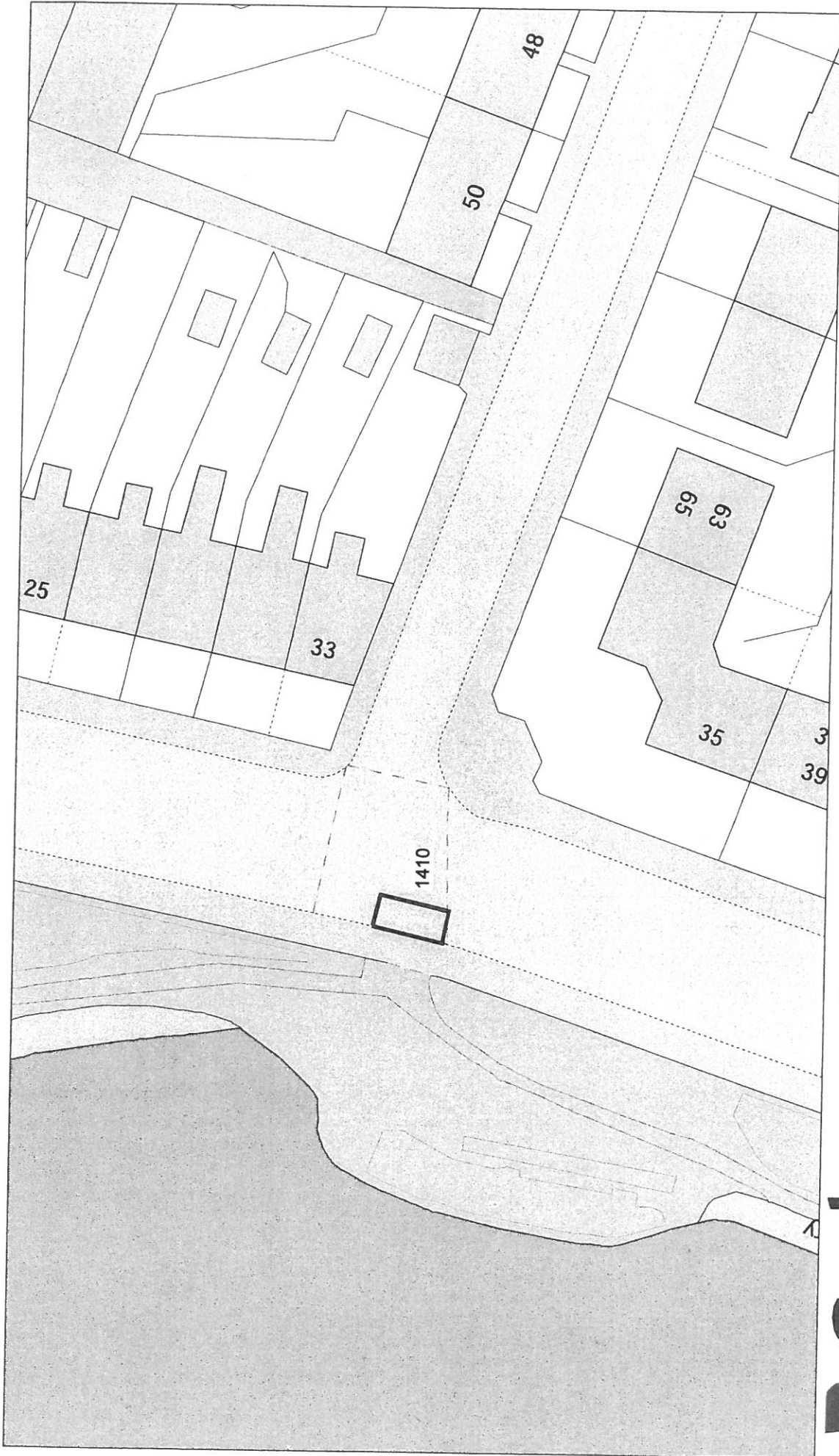

The material has been reproduced from Ordnance Survey digital map data with the permission of the Controller of Her Majesty's Stationery Office. © Crown copyright. Licence Number: 100000000

DISABLED PERSONS' PARKING PLACE
MURDIESTON STREET, GREENOCK
PLACE No. 1410

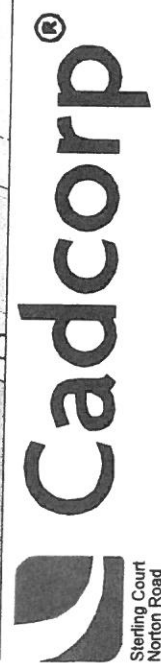

Sterling Court
 Norton Road
 Stevenage
 Herts SG1 2JY
 UK

Tel : +44 (0)1438 747996
 Fax : +44 (0)1438 747997
 E-mail: info@cadcorp.com

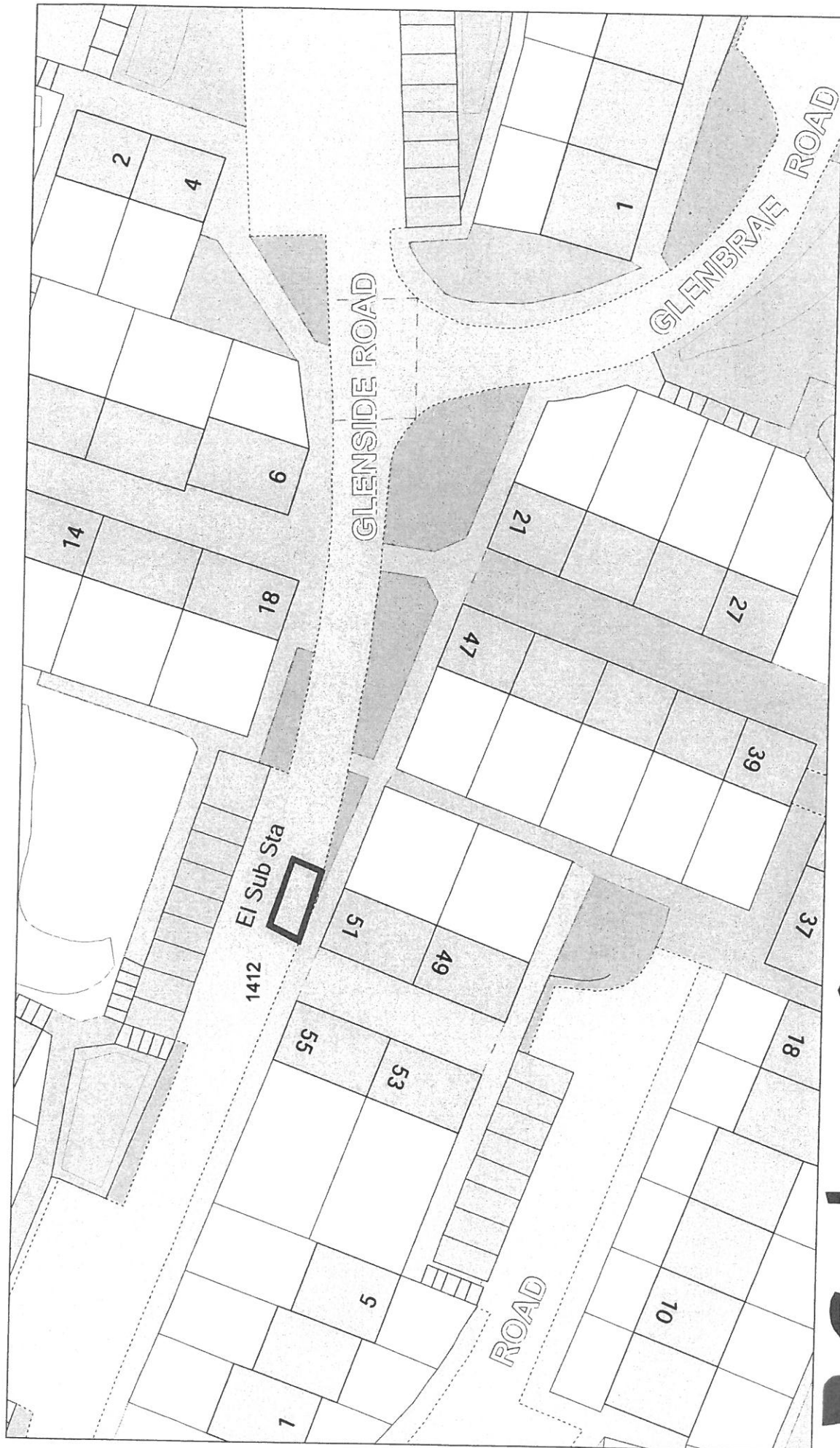

This material has been reproduced from Ordnance Survey digital map data with the permission of the Controller of Her Majesty's Stationery Office. © Crown copyright. License Number: nmmmm

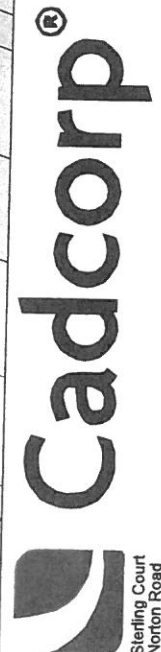

Sterling Court
Norton Road
Stevenage
Herts SG1 2JY
UK
Tel : +44 (0)1438 747996
Fax : +44 (0)1438 747997
E-mail: info@cadcorp.com

DISABLED PERSONS' PARKING PLACE
49 GLENSIDE ROAD, PORT GLASGOW
PLACE No. 1412

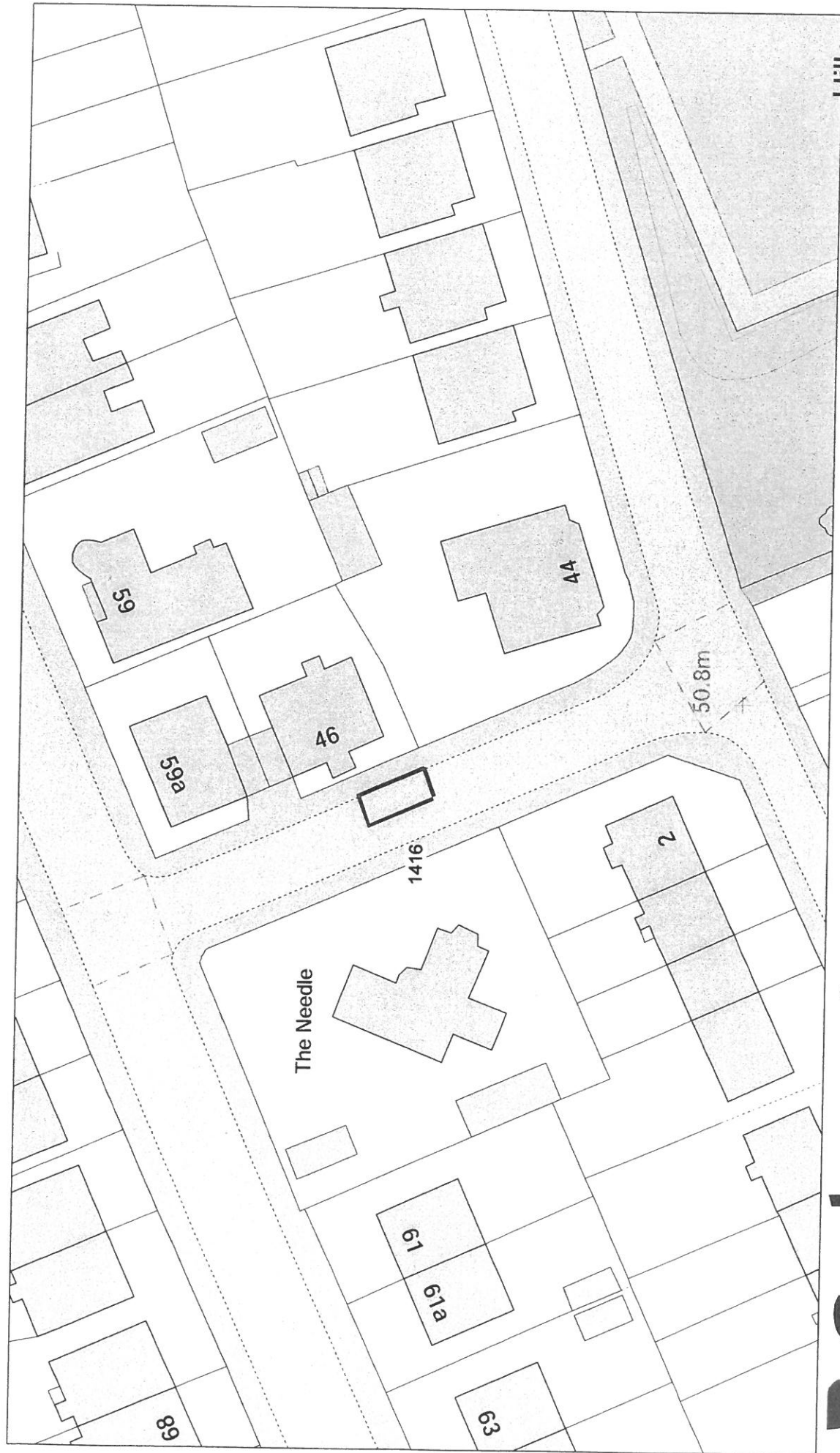

The material has been reproduced from Ordnance Survey digital map data with the permission of Ordnance Survey on behalf of Her Majesty's Stationary Office. © Crown copyright. Licence Number: 100000000

DISABLED PERSONS' PARKING PLACE
 46 HILLEND DRIVE, GREENOCK
 PLACE No. 1416



Sterling Court
 Norton Road
 Stevenage
 Herts SG1 2JY
 UK

Tel : +44 (0)1438 747996
 Fax : +44 (0)1438 747997
 E-mail: info@cadcorp.com



The material has been reproduced from Ordnance Survey digital map data with Her Majesty's Stationary Office. © Crown copyright. License Number: 1000000



Sterling Court
Norton Road
Stevenage
Herts SG1 2JY
UK

Tel : +44 (0)1438 747996
Fax : +44 (0)1438 747997
E-mail: info@cadcorp.com

DISABLED PERSONS' PARKING PLACE
75 BERWICK ROAD, GREENOCK
PLACE No. 1417

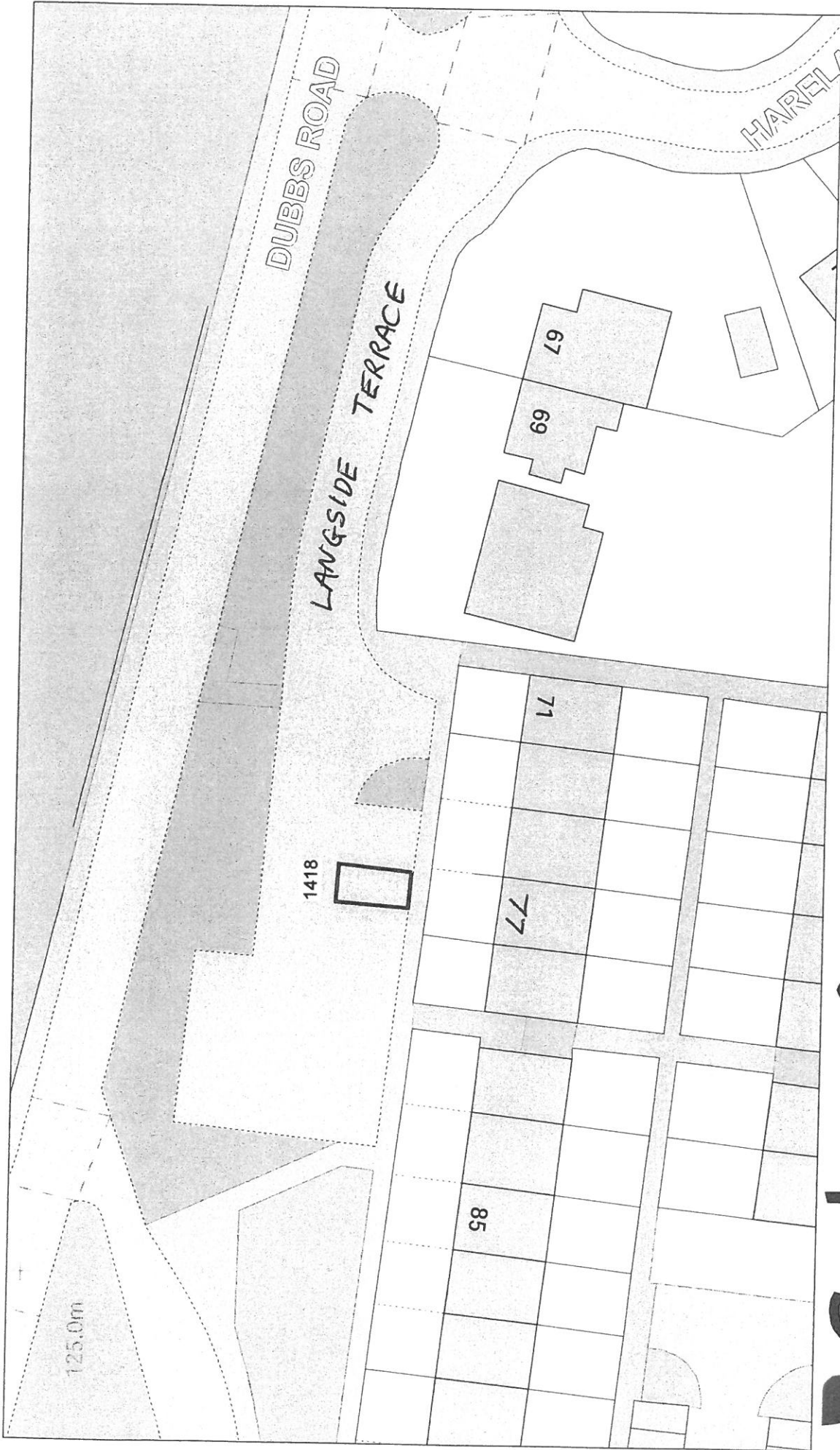

The material has been reproduced from
 Ordnance Survey digital map data with
 permission of Her Majesty's Stationery Office.
 © Crown copyright.
 Licence Number: 1000000000

DISABLED PERSONS' PARKING PLACE
 77 LANGSIDE TERRACE, PORT GLASGOW
 PLACE No. 1418



Sterling Court
 Norton Road
 Stevenage
 Herts SG1 2JY
 UK

Tel: +44 (0)1438 747996
 Fax: +44 (0)1438 747987
 E-mail: info@cadcorp.com

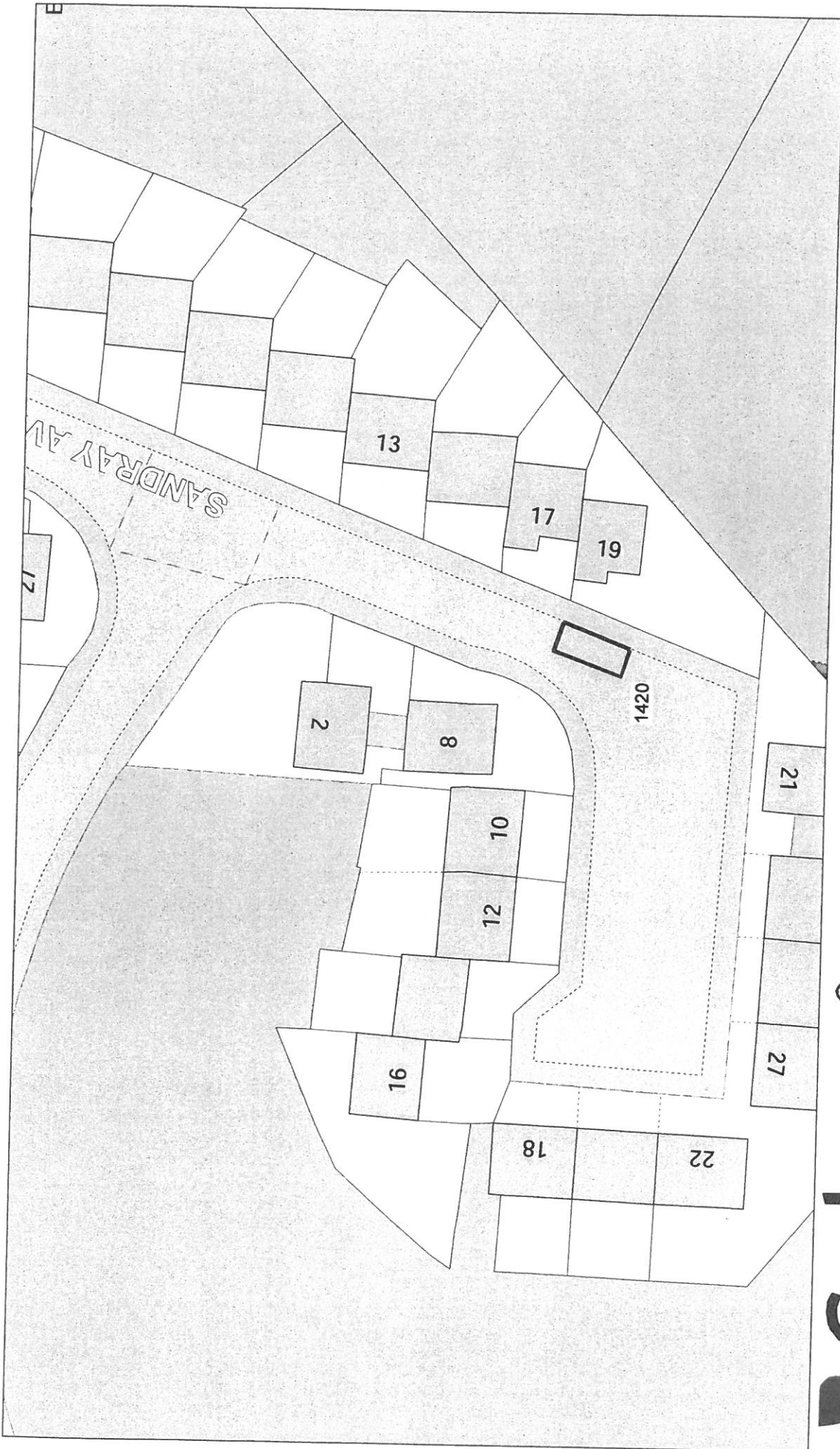

The material has been reproduced from
 Ordnance Survey digital map data with
 permission of the Controller of
 Her Majesty's Stationery Office.
 © Crown copyright.
 Licence Number: nnnnnn



Sterling Court
 Norton Road
 Stevenage
 Herts SG1 2JY
 UK

Tel : +44 (0)1438 747986
 Fax : +44 (0)1438 747987
 E-mail: info@cadcorp.com

DISABLED PERSONS' PARKING PLACE
 19 SANDRAY AVENUE, PORT GLASGOW
 PLACE No. 1420



OS Ordnance Survey
 Licensed System Supplier

The material has been reproduced from
 Ordnance Survey digital map data with
 the permission of the Controller of
 Her Majesty's Stationery Office.
 © Crown copyright. 100000000

Cadcorp®

Sterling Court
 Norton Road
 Stevenage
 Herts SG1 2JY
 UK

Tel : +44 (0)1438 747996
 Fax : +44 (0)1438 747997
 E-mail: info@cadcorp.com

DISABLED PERSONS' PARKING PLACE
 16 NORTHFIELD AVENUE, PORT GLASGOW
 PLACE No. 1422

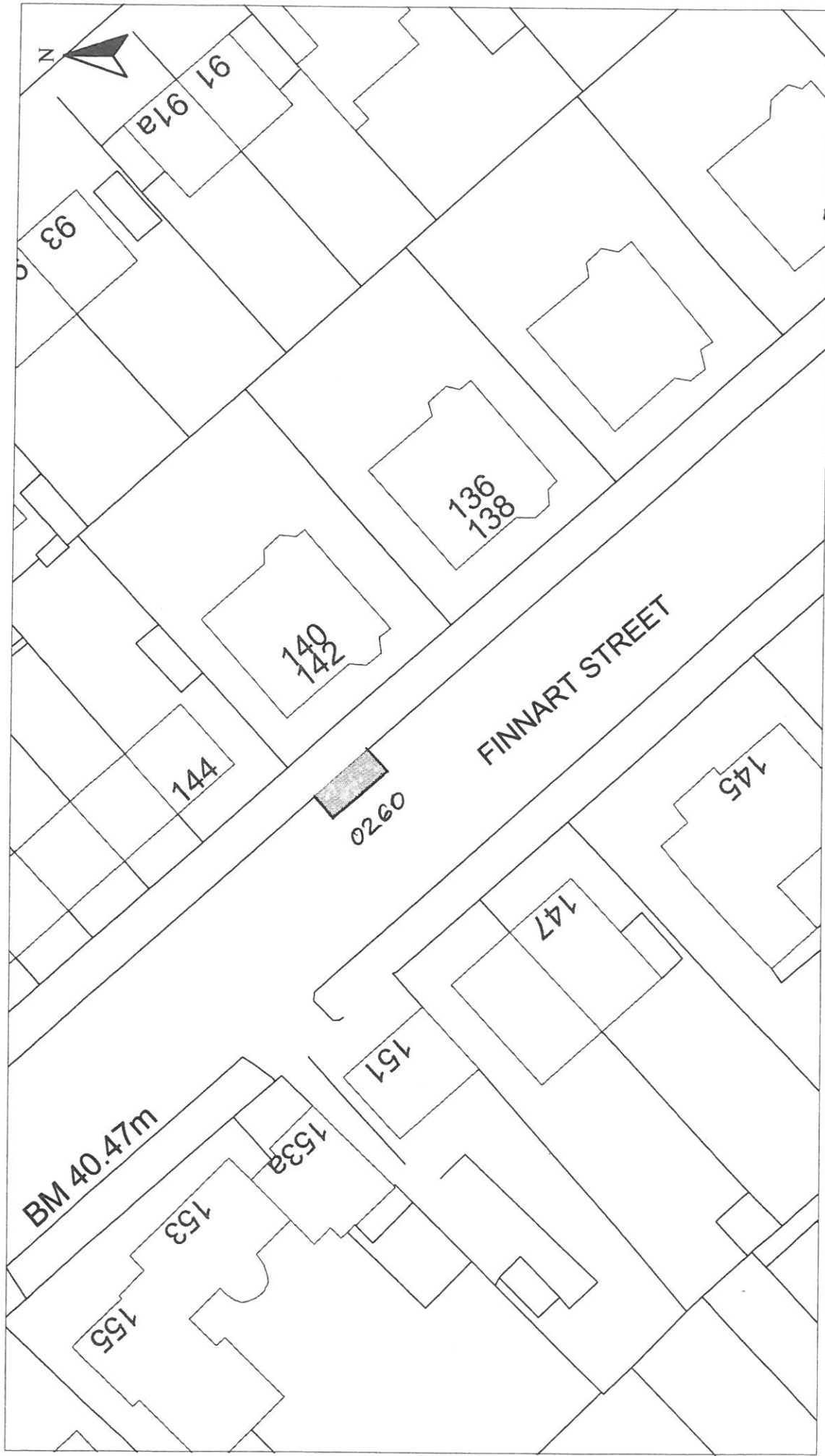

HEAD OF TRANSPORTATION AND ROADS
R.J. SMALL B.Sc., C.Eng., M.I.C.E.

Disabled Bays
71 EAST HAMILTON STREET
GREENOCK, PA15 2UA

Reproduced from Ordnance Survey mapping with the permission of the Controller of Her Majesty's Stationery Office. Crown Copyright.
Unauthorised reproduction infringes Crown Copyright and may result in prosecution or legal proceedings.
Licence No. LA03097L

DISABLED DRIVER'S PARKING BAY
142 FINNART STREET, GREENOCK
PLACE No. 0260 REVOCATION

Scale :	1:500	Date :	MAY 2003
Prepared by :	R. MACKAY	Checked by :	
Drawn by :	R. MACKAY	Approved by :	
Drawing No. :		File No. :	19/12

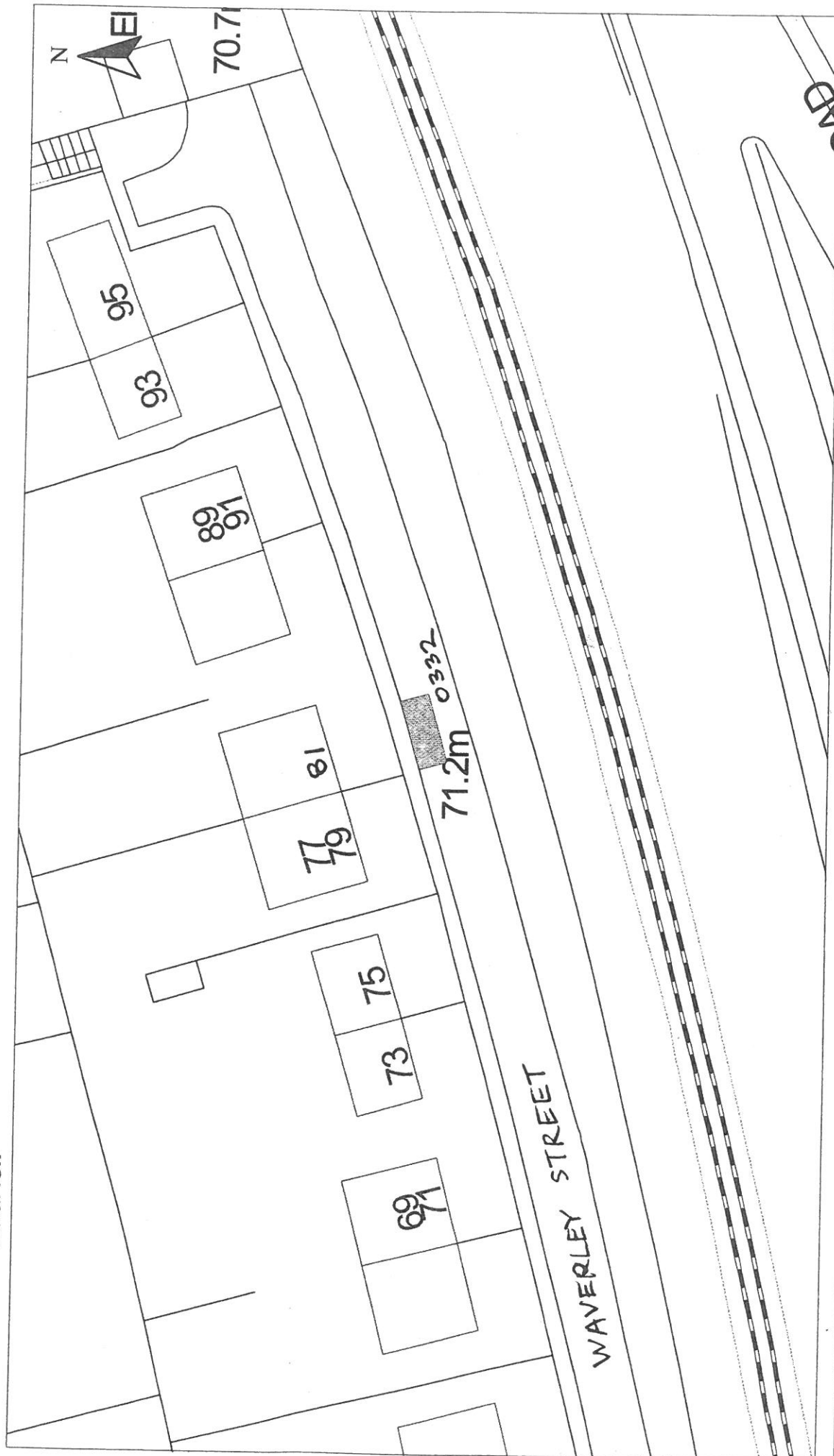

<p>HEAD OF TRANSPORTATION AND ROADS E. McCARRON C.Eng., M.I.C.E.</p>		<p>Scale : 1:500</p>		<p>Date : JULY 2004</p>	
<p>71 EAST HAMILTON STREET GREENOCK, PA15 2UA</p>		<p>Prepared by : R. MACKAY</p>		<p>Checked by :</p>	
<p>Disabled Bays</p>		<p>Drawn by : R. MACKAY</p>		<p>Approved by :</p>	
<p>DISABLED DRIVER'S PARKING BAY 81 WAVERLEY STREET, GREENOCK PLACE No. 0332 REVOCATION</p>		<p>Drawing No. :</p>		<p>File No. : 19/12</p>	
<p><small>Reproduced from Ordnance Survey mapping with the permission of the Controller of Her Majesty's Stationery Office. Crown Copyright. Unauthorised reproduction infringes Crown Copyright and may result in prosecution or legal proceedings. Licence No. LA00097L</small></p>					

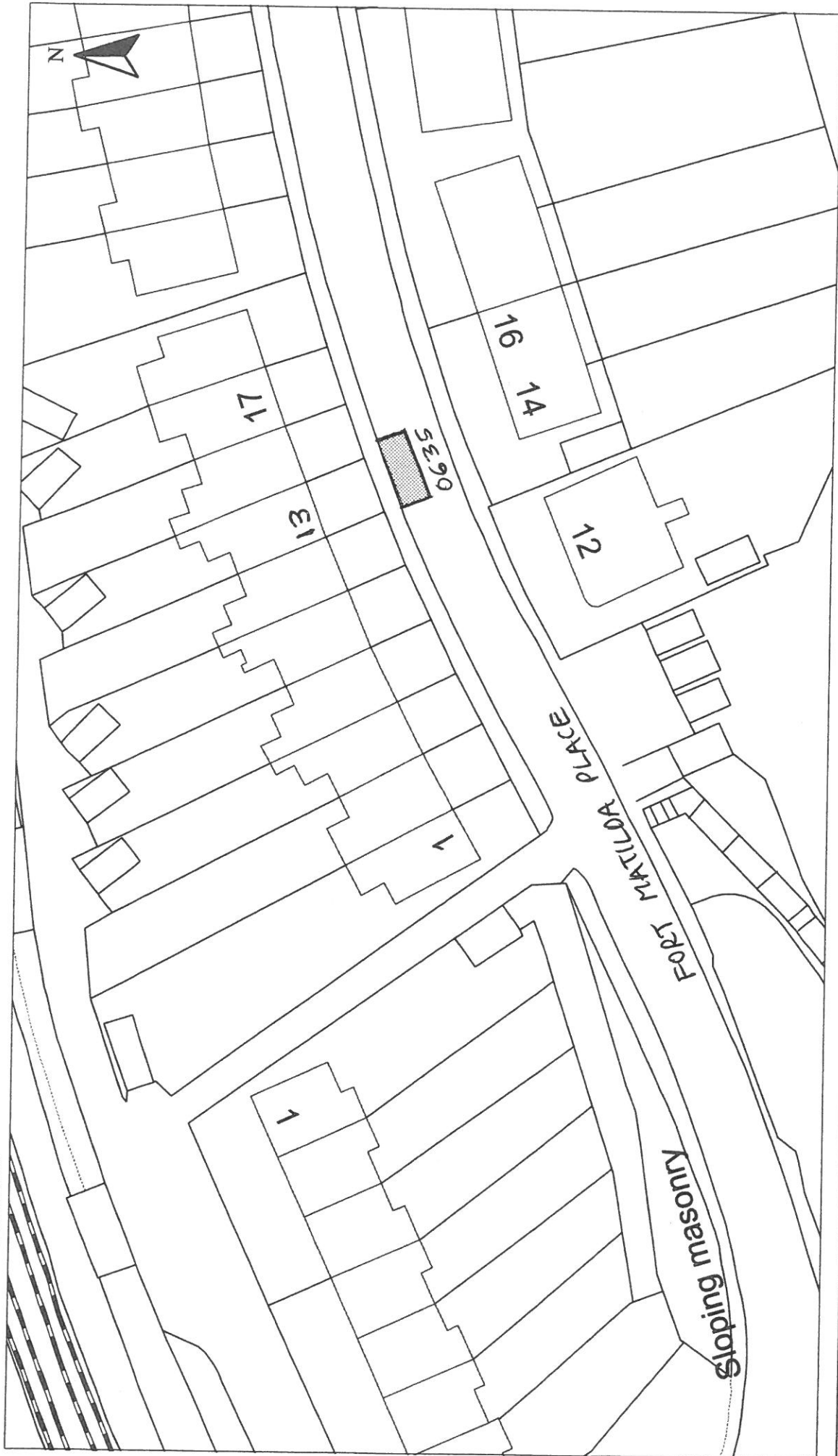

HEAD OF TRANSPORTATION AND ROADS
R.M. GRAHAM M.C.M.I., A.I.M.B.M.

Disabled Bays
71 EAST HAMILTON STREET
GREENOCK, PA15 2UA

Reproduced from Ordnance Survey mapping with the permission of the Controller of Her Majesty's Stationary Office. Crown Copyright. Use in any reproduction infringes Crown Copyright and may result in prosecution or legal proceedings.

Licence No. LA03087L
OS Ordnance Survey

DISABLED PERSON'S PARKING BAY
13 FORT MATILDA PLACE, GOUROCK
PLACE No. 0635 REVOCATION

Scale : 1:500

Prepared by : R. MACKAY

Drawn by : R. MACKAY

Drawing No. :

Date : OCT 2006

Checked by :

Approved by :

File No. : 19/12



HEAD OF PLANNING, HOUSING AND
TRANSPORTATION :- F. K. WILLIAMSON

Disabled Bays
6 CATHCART SQUARE
GREENOCK, PA15 1LS

Reproduced from Ordnance Survey mapping with the permission
of the Controller of Her Majesty's Stationary Office. Crown
Copyright. Unauthorised reproduction infringes Crown Copyright
and may result in prosecution or legal proceedings.
Licence No. 1000023421
(2008)



DISABLED PERSON'S PARKING BAY

16 GRENVILLE ROAD, GOUROCK
PLACE No. 0750 REVOCATION

Scale : 1:500

Prepared by : R. MACKAY

Drawn by : R. MACKAY

Drawing No. :

Date : FEB 2008

Checked by :

Approved by :

File No. : 19/12

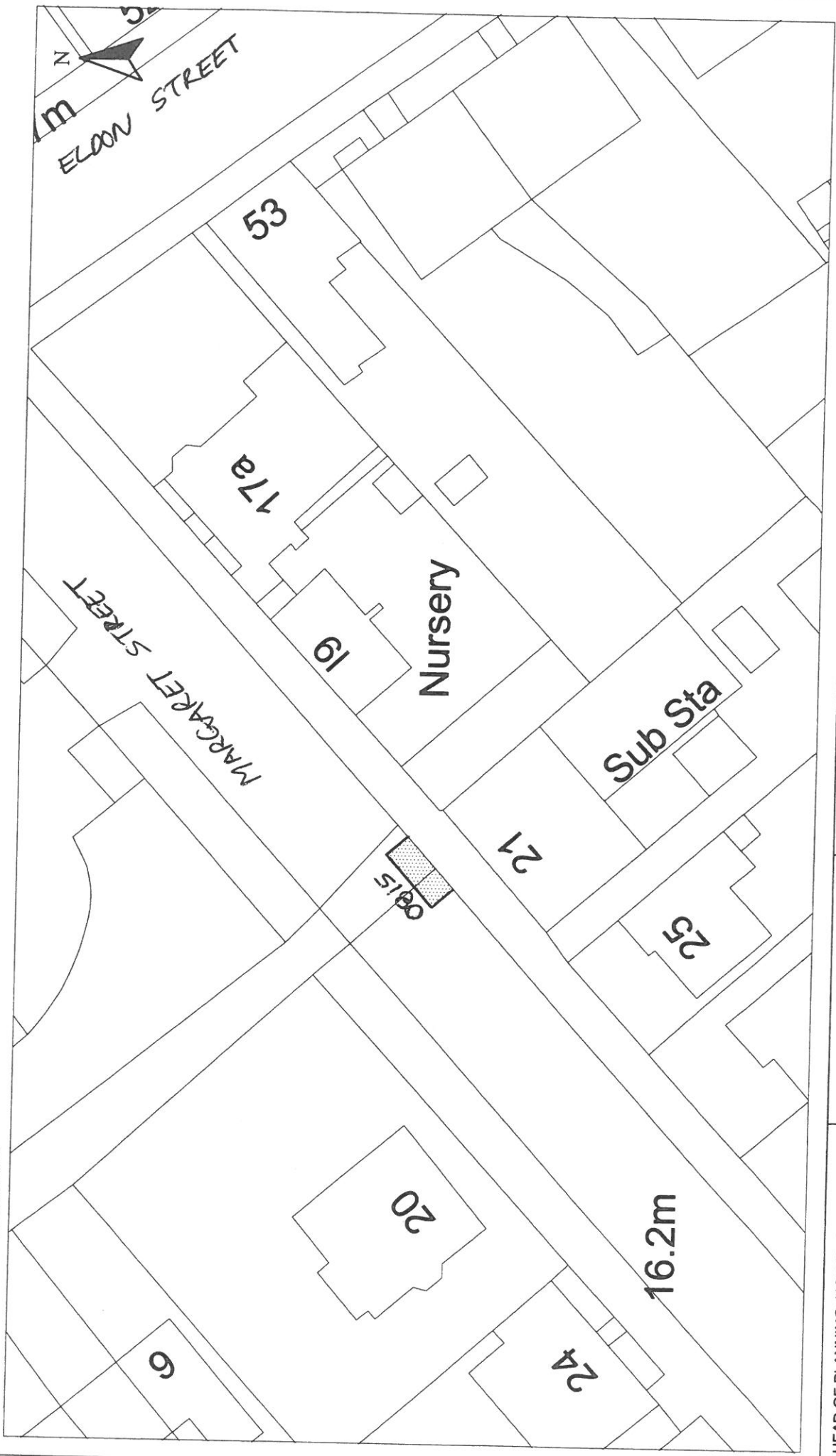

HEAD OF PLANNING, HOUSING AND TRANSPORTATION :- F. K. WILLIAMSON

Disabled Bays
6 CATHCART SQUARE
GREENOCK, PA15 1LS

Reproduced from Ordnance Survey mapping with the permission of Her Majesty's Stationery Office. Crown Copyright. Use of reproduction infringes Crown Copyright and may result in prosecution or legal proceedings.

Licence No. 1000023421 (2008)

Ordnance Survey

DISABLED PERSON'S PARKING BAY
21 MARGARET STREET, GREENOCK
PLACE No. 0815 REVOCATION

Scale : 1:500
Date : MAY 2008
Prepared by : R. MACKAY
Checked by :
Drawn by : R. MACKAY
Approved by :
Drawing No. :
File No. : 19/12

Inverclyde council ENVIRONMENTAL SERVICES

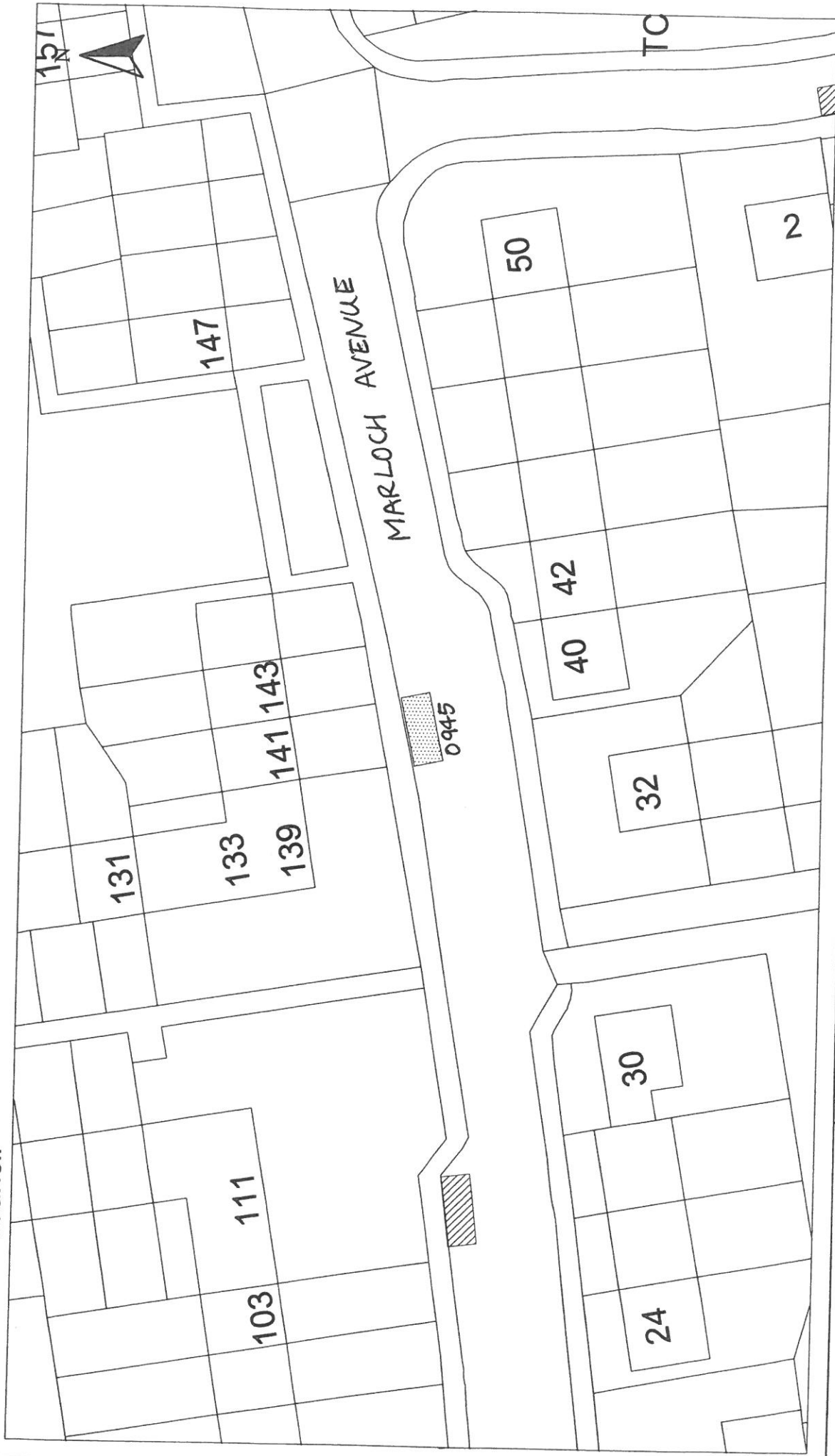

HEAD OF SERVICE ALAN G BARNES MCIWM CEnv		Scale : 1:500 Date : NOV 2009	
Disabled Bays 71 EAST HAMILTON STREET GREENOCK, PA15 2UA		Prepared by : R. MACKAY Checked by : Drawn by : R. MACKAY Approved by : Drawing No. : File No. : 19/12	
DISABLED PERSONS' PARKING PLACE 141 MARLOCH AVENUE, PORT GLASGOW PLACE No. 0945 REVOCATION			
<small> Reproduced from Ordnance Survey mapping with the permission of the Controller of Her Majesty's Stationery Office. Crown Copyright. Unauthorised reproduction infringes Crown Copyright and may result in prosecution or legal proceedings. </small>			
Licence No. LA03097L 			

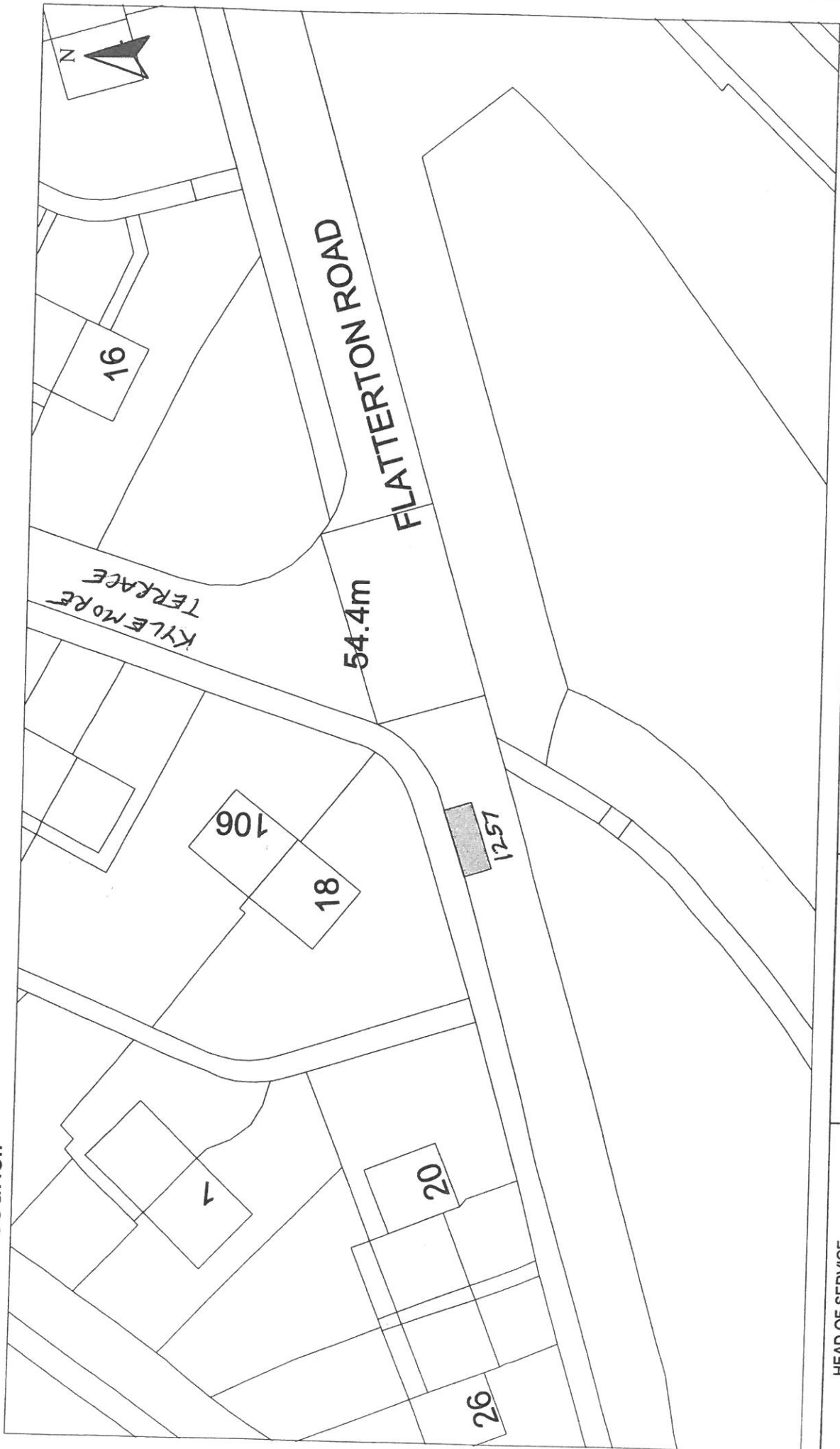

HEAD OF SERVICE
IAN MOFFAT

71 EAST HAMILTON STREET
GREENOCK, PA15 2UA

Reproduced from Ordnance Survey mapping with the permission of the Controller, Her Majesty's Stationery Office. Crown Copyright. Unauthorised reproduction from infringes Crown Copyright and may result in prosecution or legal proceedings.



DISABLED PERSONS' PARKING PLACE

18 FLATTERTON ROAD, GREENOCK
PLACE No. 1257 REVOCATION

Scale : 1:500

Prepared by : R. MACKAY

Drawn by : R. MACKAY

Date : JAN 2013

Checked by :

Approved by :

File No. : 19/12

Disabled Bays

Inverclyde ENVIRONMENTAL & COMMERCIAL SERVICES
council



Date : JULY 2013	Scale : 1:500	DISABLED PERSONS' PARKING PLACE 57 BRIDGEND AVENUE, PORT GLASGOW PLACE No. 1333 REVOCATION
Checked by :	Prepared by : R. MACKAY	HEAD OF SERVICE IAN MOFFAT
Approved by :	Drawn by : R. MACKAY	71 EAST HAMILTON STREET GREENOCK, PA15 2UA
File No. : 19/12	Drawing No. :	Disabled Bays

Reproduced from Ordnance Survey mapping with the permission of the Controller of Her Majesty's Stationery Office. Copyright. Unauthorised reproduction infringes Crown Copyright and may result in prosecution or legal proceedings.



Licence No. LA03097L

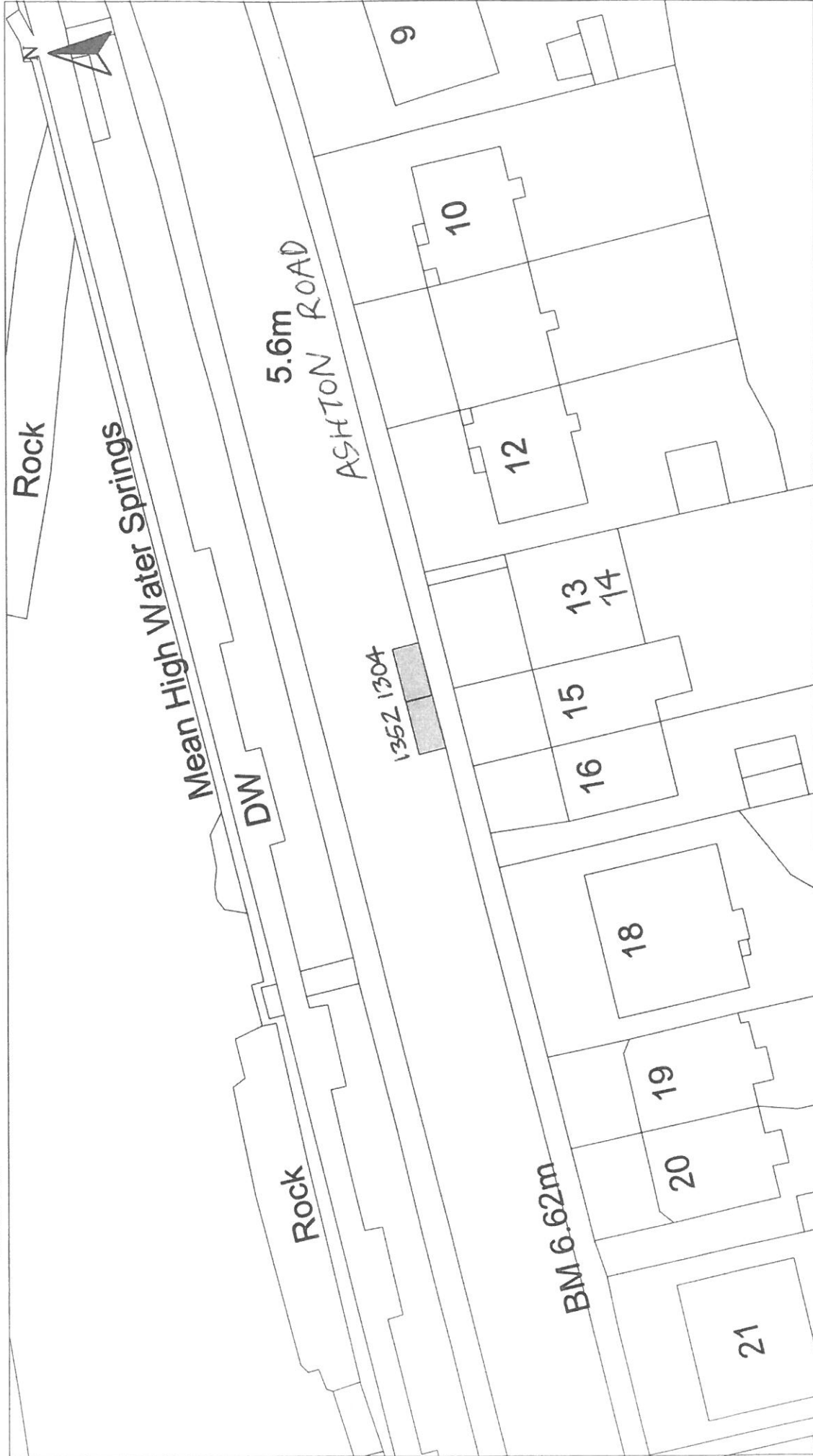

HEAD OF SERVICE IAN MOFFAT		Scale : 1:500		Date : NOV 2013	
71 EAST HAMILTON STREET GREENOCK, PA15 2UA		Prepared by : R. MACKAY		Checked by :	
Disabled Bays		Drawn by : R. MACKAY		Approved by :	
		Drawing No. :		File No. : 19/12	
DISABLED PERSONS' PARKING PLACE 14 & 15 ASHTON ROAD, GOUROCK PLACES Nos. 1304 & 1352 REVOCATION					
<small> Reproduced from Ordnance Survey mapping with the permission of the Controller of Her Majesty's Stationary Office. Crown Copyright. Unauthorised reproduction infringes Crown Copyright and may result in prosecution or legal proceedings. </small>					
Licence No. LA03097L					



HEAD OF SERVICE IAN MOFFAT	Reproduced from Ordnance Survey mapping with the permission of the Controller of Her Majesty's Stationery Office. Crown Copyright. Unauthorised reproduction infringes Crown Copyright and may result in prosecution or legal proceedings.	DISABLED PERSONS' PARKING PLACE 28 BRAESIDE ROAD, GREENOCK PLACE No. 1343 REVOCATION	Scale : 1:500 Prepared by : R. MACKAY Drawn by : R. MACKAY	Date : NOV 2013 Checked by : Approved by :
Disabled Bays 71 EAST HAMILTON STREET GREENOCK, PA15 2UA	Licence No. LA03097L 		Drawing No. :	File No. : 40140