Report To: THE INVERCLYDE COUNCIL **Date:** 10 OCTOBER 2013

Report By: CORPORATE DIRECTOR **Report No:** LA/1075/13
ENVIRONMENT, REGENERATION &
RESOURCES

Contact Officer: JOANNA DALGLEISH **Contact No:** 01475 712123

Subject: PROPOSED TRAFFIC REGULATION ORDER –
DISABLED PERSONS' PARKING PLACES (ON STREET)
ORDER NO 3 2013

1.0 PURPOSE

- 1.1 The purpose of the report is to introduce Traffic Regulation Order – Disabled Persons' Parking Places (On Street) Order No 3 2013.

2.0 SUMMARY

- 2.1 In order to comply with the Disabled Persons' Parking Places (Scotland) Act 2009, Section 5 and to provide assistance to disabled persons who hold a badge under the Disabled Persons (Badges for Motor Vehicles) (Scotland) Regulations 2000 as amended, the Environment & Regeneration Committee at the meeting held on 5 September 2013 agreed that The Inverclyde Council be asked to make the Traffic Regulation Order – Disabled Persons' Parking Places (On Street) Order No 3 2013 in terms of the Road Traffic Regulation Act 1984, Roads (Scotland) Act 1984 and associated Regulations.
- 2.2 The proposals have been advertised and no objections have been received.
- 2.3 There are no legal or financial implications.

3.0 RECOMMENDATION

- 3.1 That a Resolution is made in the following terms:
- 3.2 THE INVERCLYDE COUNCIL, incorporated under the Local Government etc. (Scotland) Act 1994, RESOLVE TO MAKE as they HEREBY MAKE a Resolution under Section 32(1) and Part III of Schedule 9 of the Road Traffic Regulation Act 1984 to permit the provision of parking places for disabled persons who hold a badge under the Disabled Persons (Badges for Motor Vehicles) (Scotland) Regulations 2000 as amended all as detailed in a copy of the Order forming a supplement to the principal minute hereof, and that the Head of Environmental & Commercial Services and Head of Legal & Democratic Services be authorised to take all necessary action in connection therewith.

Appendix

Legal & Democratic Services

THE INVERCLYDE COUNCIL
DISABLED PERSONS' PARKING PLACES
(ON STREET) ORDER NO. 3 2013
TRAFFIC REGULATION ORDER

DRAFT

THE INVERCLYDE COUNCIL
DISABLED PERSONS' PARKING PLACES (ON STREET)
ORDER NO. 3 2013

The Inverclyde Council in exercise of the powers conferred on them by Sections 32(1) of the Road Traffic Regulation Act 1984 ("the Act") and of all other enabling powers and after consultation with the Chief Constable of Strathclyde Police in accordance with Part III of Schedule 9 to the Act hereby make the following Order.

1. This Order may be cited as "The Inverclyde Council Disabled Persons' Parking Places (On Street) Order No. 3 2013 and shall come into operation on #####"

2. In this Order the following expressions have the meanings hereby assigned to them:

"vehicle" unless the context otherwise requires, means a vehicle of any description and includes a machine or implement of any kind drawn or propelled along roads whether or not by mechanical power;

"parking place" means a place where a vehicle, or vehicles of any class, may wait i.e. the area of land specified in the Schedule for which the use as a parking place has been authorised by the Council under Section 32(1) of the Act;

"sign" means a traffic sign;

"disabled person's badge" means:-

(a) a badge issued under Section 21 of the Chronically Sick and Disabled Persons Act 1970;

(b) a badge issued under a provision of the law of Northern Ireland corresponding to that section; or

(c) a badge issued by any member State other than the United Kingdom for purposes corresponding to the purposes for which badges under that section are issued;

and has not ceased to be in force.

"disabled person's vehicle" means a vehicle lawfully displaying a disabled person's badge;

"Council" means The Inverclyde Council;

3. Each area of road which is described in the Schedule and plans relative to this Order is hereby designated as a parking place.

4. The parking places designated in this Order shall only be used for the leaving of disabled persons' vehicles displaying a valid disabled person's badge.

5. The limits of each parking place designated in this Order shall be indicated on the carriageway as prescribed by The Traffic Signs Regulations and General Directions 2002 as amended.
6. Every vehicle left in any parking place designated in this Order shall stand such that no parking place is occupied by more than one vehicle and that every part of the vehicle is within the limits of the parking place provided that, where the length of a vehicle precludes compliance with this paragraph, such vehicle shall be deemed to be within the limits of a parking place if;
 - i. the extreme front portion or, as the case may be, the extreme rear portion of the vehicle is within 300mm of an indication on the carriageway provided under this Order in relation to the parking place; and
 - ii. the vehicle, or any part thereof, is not within the limits of any adjoining parking place.
7. Any person duly authorised by the Council or a police officer in uniform or a traffic warden or parking attendant may move or cause to be moved in case of any emergency, to any place they think fit, vehicles left in a parking place.
8. Any person duly authorised by the Council may suspend the use of a parking place or any part thereof whenever such suspension is considered reasonably necessary:
 - i. for the purpose of facilitating the movement of traffic or promoting its safety;
 - ii. for the purpose of any building operation, demolition, or excavation in or adjacent to the parking place or the laying, erection, alteration, removal or repair in or adjacent to the parking place of any sewer or of any main, pipe, apparatus for the supply of gas, water electricity or of any telecommunications apparatus, traffic sign or parking meter;
 - iii. for the convenience of occupiers of premises adjacent to the parking place on any occasion of the removal of furniture from one office or dwellinghouse to another or the removal of furniture from such premises to a depository or to such premises from a depository;
 - iv. on any occasion on which it is likely by reason of some special attraction that any street will be thronged or obstructed; or
 - v. for the convenience of occupiers of premises adjacent to the parking place at times of weddings or funerals or on other special occasions.
9. A police officer in uniform may suspend for not longer than twenty four hours the use of a parking place or part thereof whenever such suspension is considered reasonably necessary for the purpose of facilitating the movement of traffic or promoting its safety.

10. This Order insofar as it relates to the parking places to be revoked (R) and amended, as specified in the Schedule to this Order, partially revokes and amends the On-Street Parking Places (Without Charges) Order No. 2 1997, No. 1 2005, No. 1 2008 and the Disabled Persons' Parking Places (On Street) Order No. 1 2010, No. 2 2011 and No. 3 2011 respectively.

Sealed with the Common Seal of The Inverclyde Council and subscribed for them and on their behalf by ##

DRAFT

INVERCLYDE COUNCIL

**DISABLED PERSONS' PARKING PLACES (ON STREET)
ORDER NO. 3 2013**

**Statement of Reasons for Proposing to Make
the Above Order**

It is considered necessary to make the above Order to provide assistance for disabled persons who hold a badge under the Disabled Persons (Badges for Motor Vehicles) (Scotland) Regulations 2000 as amended and by revoking those parking places no longer required to maximise street parking capacity.

DRAFT

INVERCLYDE COUNCIL

DISABLED PERSONS' PARKING PLACES (ON-STREET) ORDER No.3 2013

SCHEDULE

Rev B

All and whole that area of ground as described in Column 2 in the table below:

<u>Ref No.</u>	<u>Address of Disabled Person's Parking Place to be created or revoked @ "ex-adverso"</u>
1207	76 Manor Crescent, Gourrock
1303	28 Newton Street, Greenock
1307	15 Highholm Street, Port Glasgow
1310	30 Newark Street, Greenock
1313	1 Sir Michael Place, Greenock
1314	46A Newton Street, Greenock
0455a	6 Regent Street, Greenock
9741	Cathcart Square, Greenock ®
9741a	Cathcart Square, Greenock ®
0395	Willison's Lane, Port Glasgow ®
0396	Willison's Lane, Port Glasgow ®
0451	34 Brisbane Street, Greenock ®
0762	5 Fergus Road, Greenock ®
1074	69 Islay Avenue, Port Glasgow ®
1082	20 Dunlop Street, Greenock ®

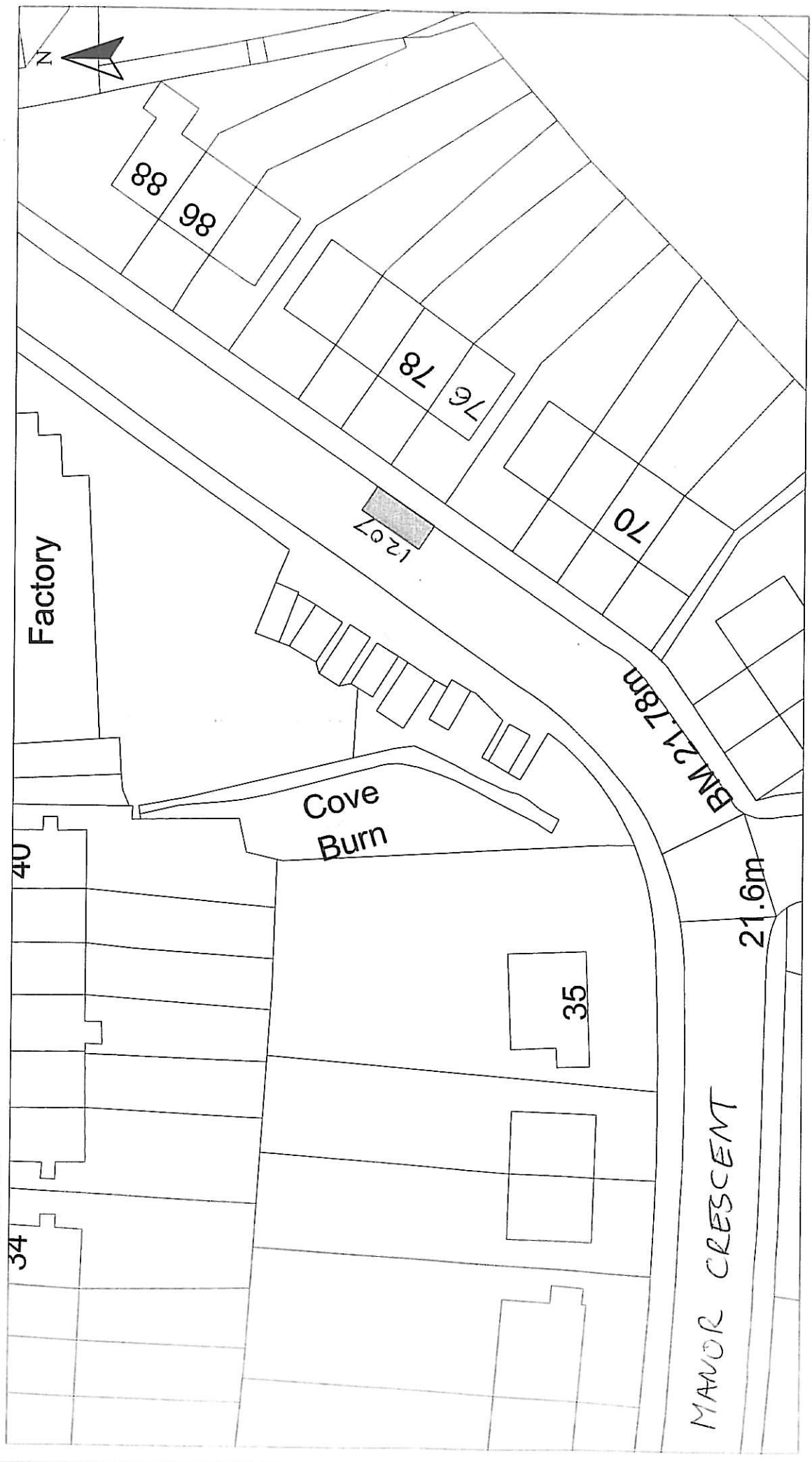

Disabled Bays HEAD OF SERVICE IAN MOFFAT 71 EAST HAMILTON STREET GREENOCK, PA15 2UA	Reproduced from Ordnance Survey mapping with the permission of the Controller of Her Majesty's Stationery Office. Copyright. Unauthorised reproduction infringes Crown Copyright and may result in prosecution or legal proceedings.  Licence No. LA03097L	DISABLED PERSONS' PARKING PLACE 76 MANOR CRESCENT, GOUROCK PLACE No. 1207		Scale : 1:500 Prepared by : R. MACKAY Drawn by : R. MACKAY Drawing No. :	Date : APRIL 2013 Checked by : Approved by : File No. : 19/12

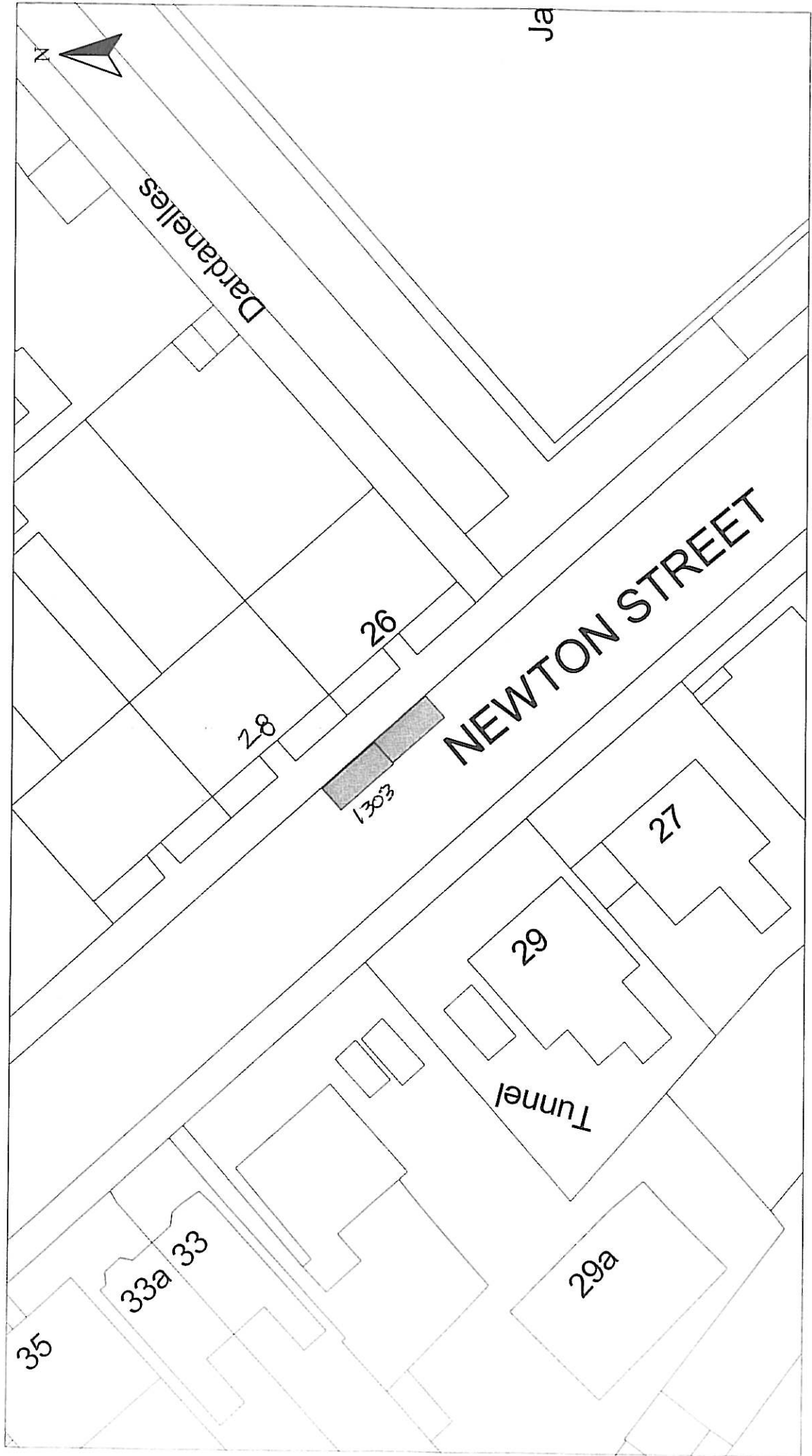

DISABLED PERSONS' PARKING PLACE
28 NEWTON STREET, GREENOCK
PLACE No. 1303

Reproduced from Ordnance Survey mapping with the permission of the Controller of Her Majesty's Stationery Office. Crown Copyright. Unauthorised reproduction infringes Crown Copyright and may result in prosecution or legal proceedings.

Ordnance Survey
Licence No. LA03097L

HEAD OF SERVICE
IAN MOFFAT
71 EAST HAMILTON STREET
GREENOCK, PA15 2UA

Disabled Bays

Scale : 1:500
Prepared by : R. MACKAY
Drawn by : R. MACKAY
Date : APRIL 2013
Checked by :
Approved by :
File No. : 19/12

Inverclyde council ENVIRONMENTAL & COMMERCIAL SERVICES

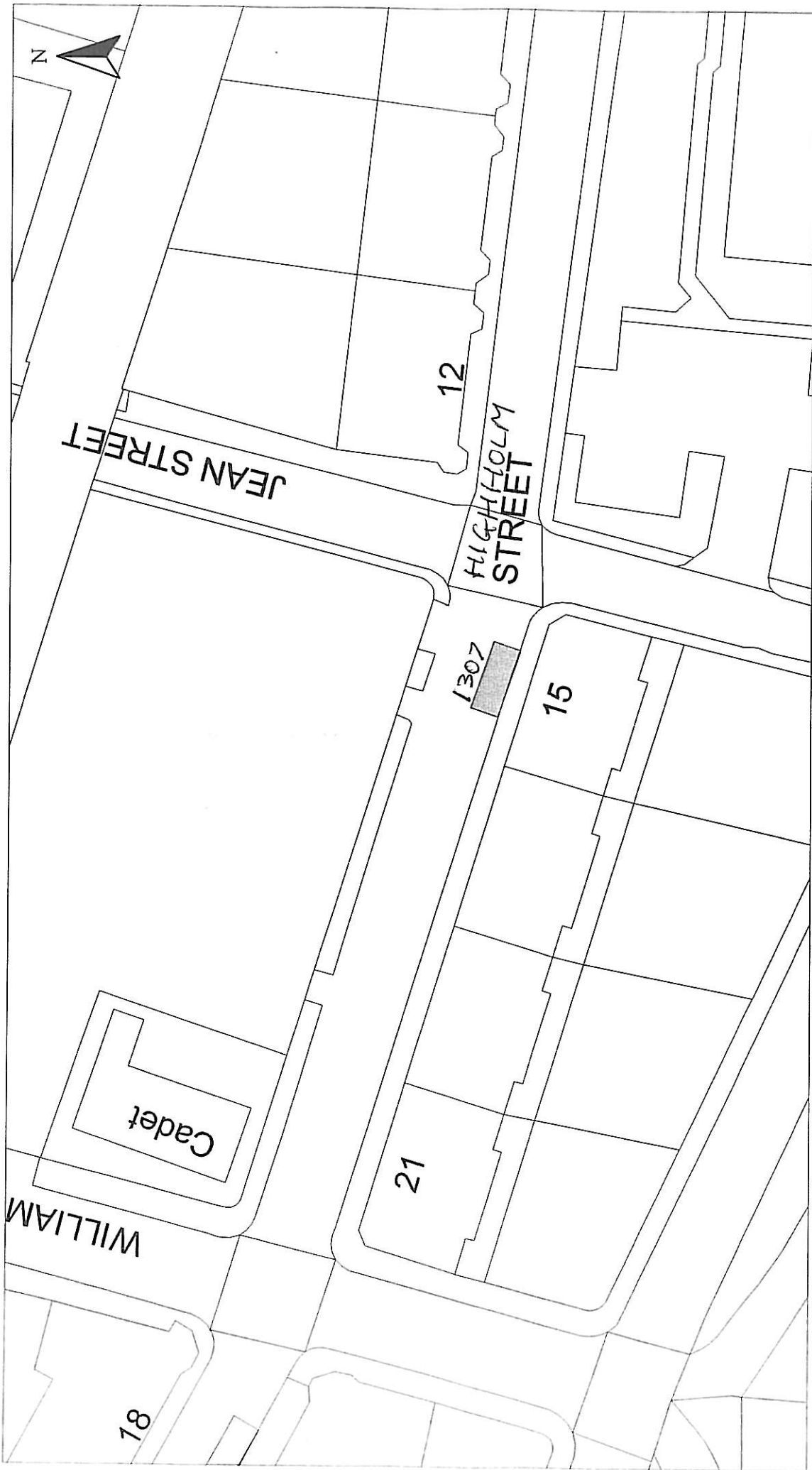

HEAD OF SERVICE IAN MOFFAT	Scale : 1:500	Date : APRIL 2013
Disabled Bays	Prepared by : R. MACKAY	Checked by :
71 EAST HAMILTON STREET GREENOCK, PA15 2UA	Drawn by : R. MACKAY	Approved by :
Reproduced from Ordnance Survey mapping with the permission of the Controller of Her Majesty's Stationery Office. Crown Copyright. No part of this publication may be reproduced, stored in a retrieval system or transmitted in any form or by any means, electronic, mechanical, photocopying, recording or otherwise, without the prior written permission of Ordnance Survey.		Disabled PERSONS' PARKING PLACE 15 HIGH HOLM STREET, PORT GLASGOW PLACE No. 1307
Licence No. LA03097L		File No. : 19/12
Ordnance Survey		Drawing No. :

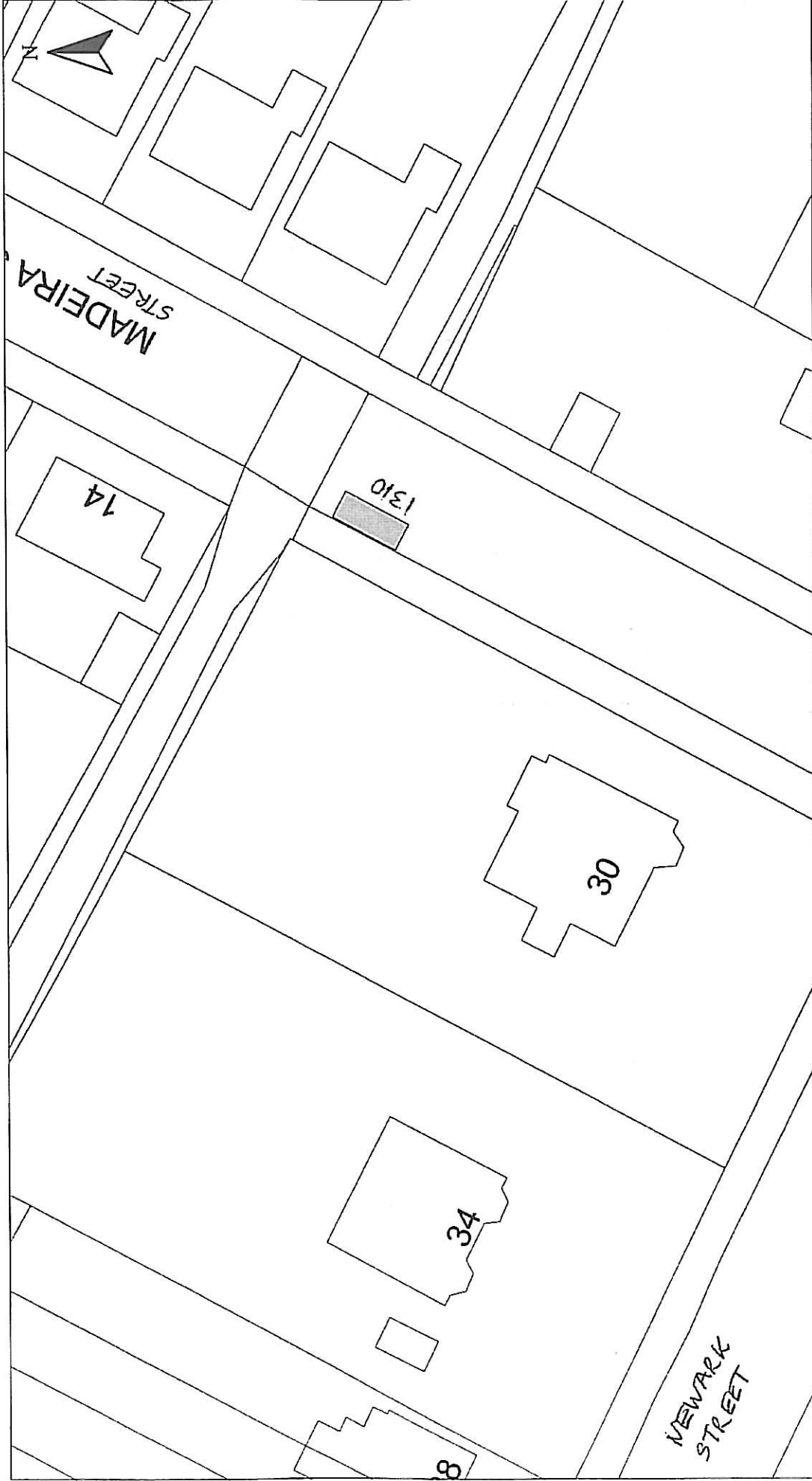

DISABLED PERSONS' PARKING PLACE
30 NEWARK STREET, GREENOCK
PLACE No. 1310

Reproduced from Ordnance Survey mapping with the permission of the Controller of Her Majesty's Stationery Office. Crown Copyright. Unauthorised reproduction is prohibited and may result in prosecution or legal proceedings.

Ordnance Survey
Licence No. LA03097L

HEAD OF SERVICE
IAN MOFFAT

71 EAST HAMILTON STREET
GREENOCK, PA15 2UA

Disabled Bays

Scale : 1:500
Prepared by : R. MACKAY
Drawn by : R. MACKAY
Date : JULY 2013
Checked by :
Approved by :
File No. : 19/12

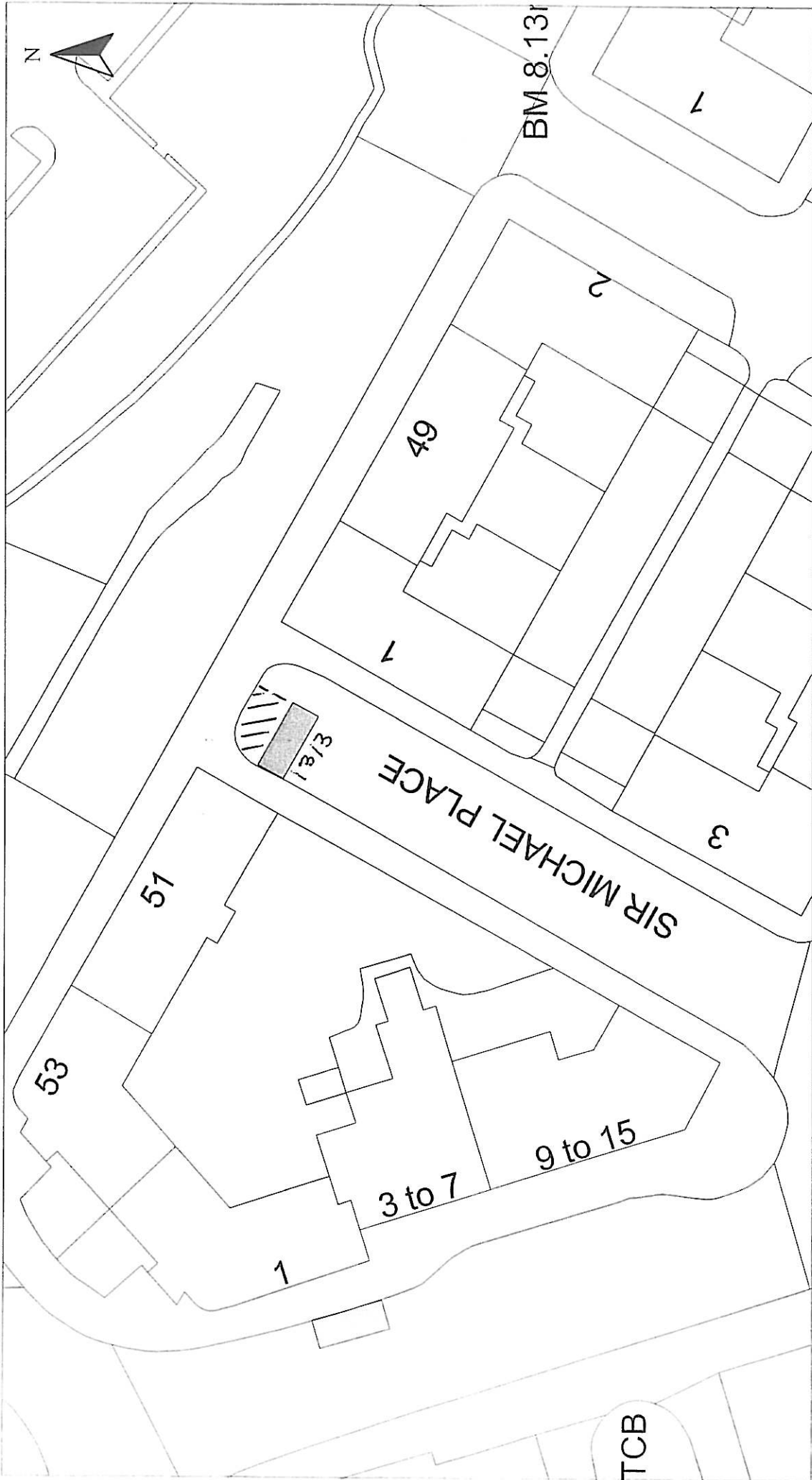

HEAD OF SERVICE
IAN MOFFAT

Disabled Bays
71 EAST HAMILTON STREET
GREENOCK, PA15 2UA

Reproduced from Ordnance Survey mapping with the permission of the Controller of Her Majesty's Stationery Office. Crown Copyright. Unauthorised reproduction infringes Crown Copyright and may result in prosecution or legal proceedings.



DISABLED PERSONS' PARKING PLACE
1 SIR MICHAEL PLACE, GREENOCK
PLACE No. 1313

Scale : 1:500
Prepared by : R. MACKAY
Drawn by : R. MACKAY
Date : MAY 2013
Checked by :
Approved by :
File No. : 19/12

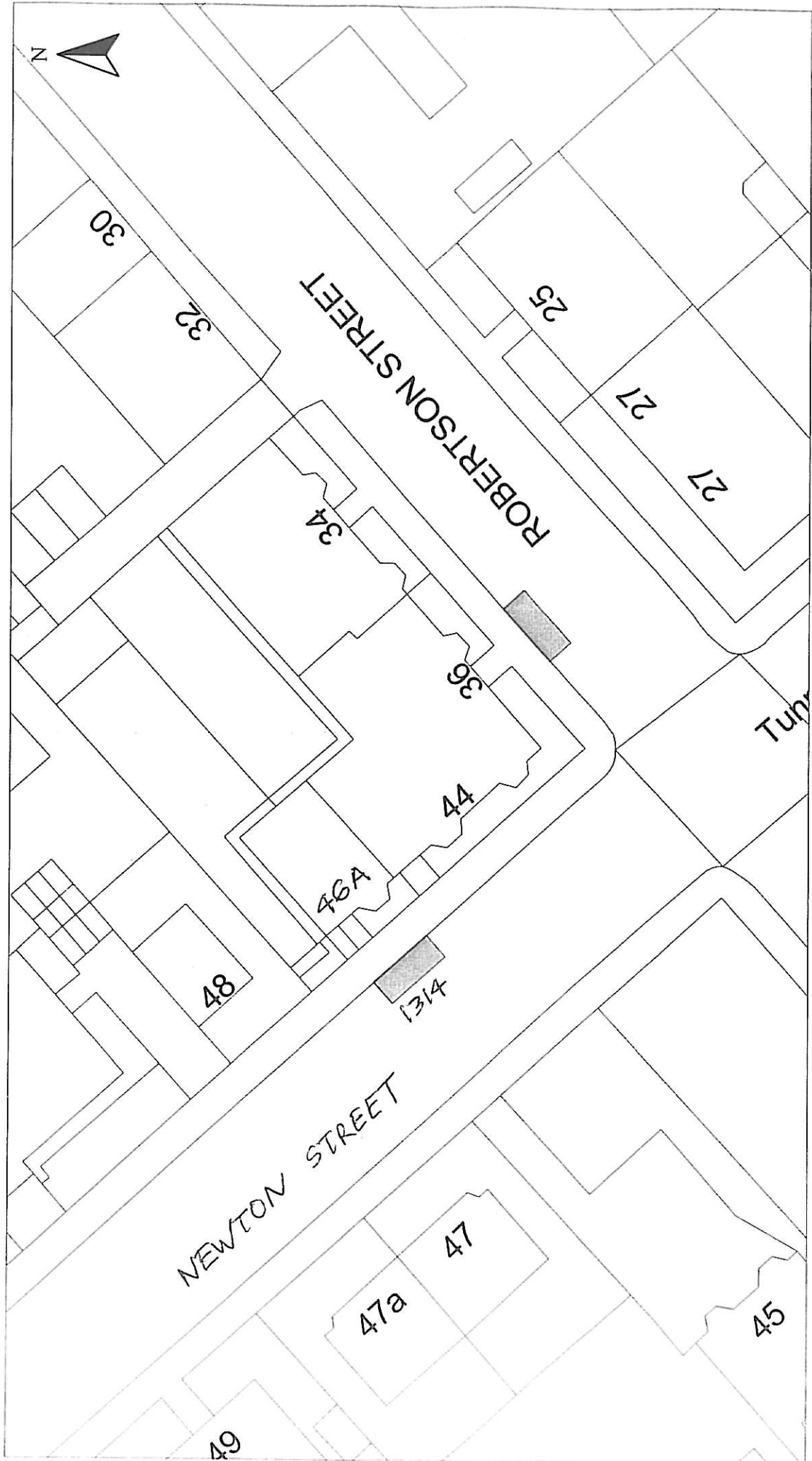

HEAD OF SERVICE
IAN MOFFAT

Disabled Bays
71 EAST HAMILTON STREET
GREENOCK, PA15 2JA

Reproduced from Ordnance Survey mapping with the permission of the Controller of Her Majesty's Stationery Office. Crown Copyright. Unauthorised reproduction infringes Crown Copyright and may result in prosecution or legal proceedings.



DISABLED PERSONS' PARKING PLACES
46A NEWTON STREET, GREENOCK
PLACE No. 1314

Scale : 1:500

Prepared by : R. MACKAY

Drawn by : R. MACKAY

Checked by :
Approved by :
Drawing No. : 19/12

Date : APRIL 2013

Inverclyde ENVIRONMENTAL & COMMERCIAL SERVICES

council

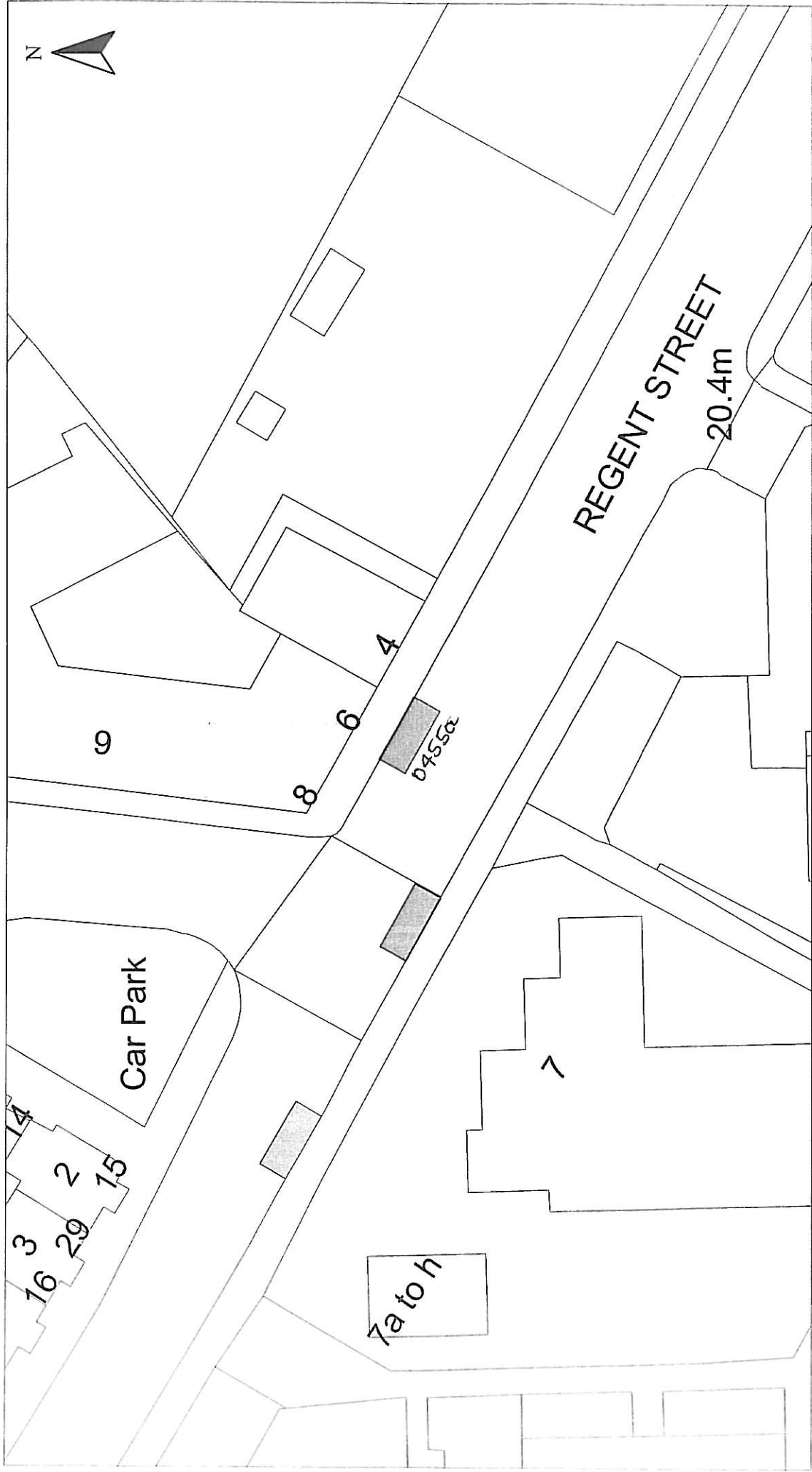

HEAD OF SERVICE
IAN MOFFAT

71 EAST HAMILTON STREET
GREENOCK, PA15 2JA

Disabled Bays

Reproduced from Ordnance Survey mapping with the permission of the Controller of Her Majesty's Stationery Office. Crown Copyright. Unauthorised reproduction infringes Crown Copyright and may result in prosecution or legal proceedings.

OS Ordnance Survey
Licence No. LA03097L

DISABLED PERSONS' PARKING PLACE

6 REGENT STREET, GREENOCK

PLACE No. 0455a

Scale : 1:500

Prepared by : R. MACKAY

Drawn by : R. MACKAY

Checked by :
Approved by :

Date : APRIL 2013

File No. : 19/12

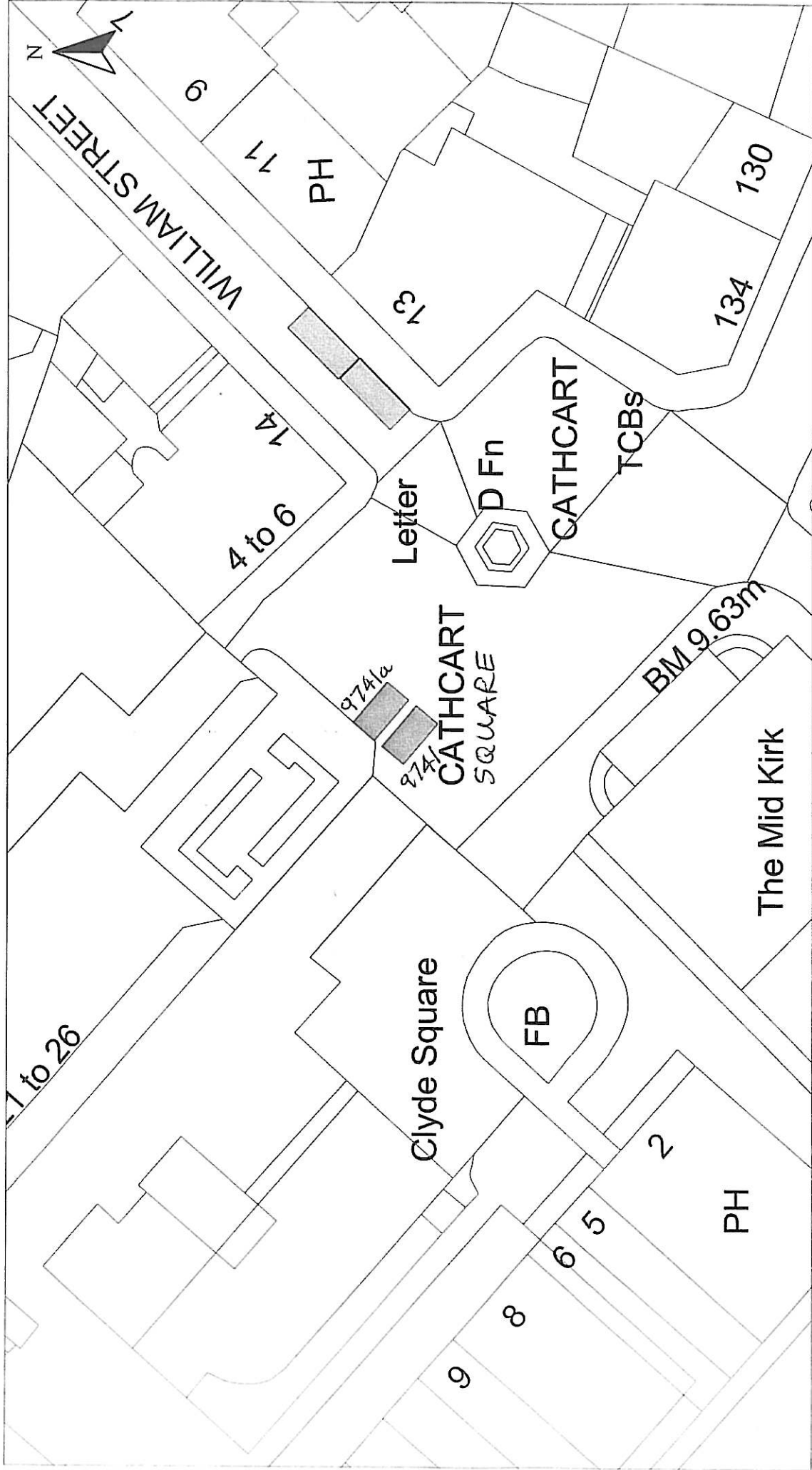

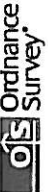
Disabled Bays 71 EAST HAMILTON STREET GREENOCK, PA15 2UA	HEAD OF SERVICE IAN MOFFAT	Reproduced from Ordnance Survey mapping with the permission of the Controller of Her Majesty's Stationery Office. Crown Copyright. Unauthorised reproduction infringes Crown Copyright and may result in prosecution or legal proceedings.  Licence No. LA03097L	DISABLED PERSONS' PARKING PLACE CATHCART SQUARE, GREENOCK PLACES No. 9741 & 9741a REVOCATION	Scale : 1:500 Prepared by : R. MACKAY Drawn by : R. MACKAY Drawing No. :	Date : APRIL 2013 Checked by : Approved by : File No. : 19/12
				Date : APRIL 2013 Checked by : Approved by : File No. : 19/12	

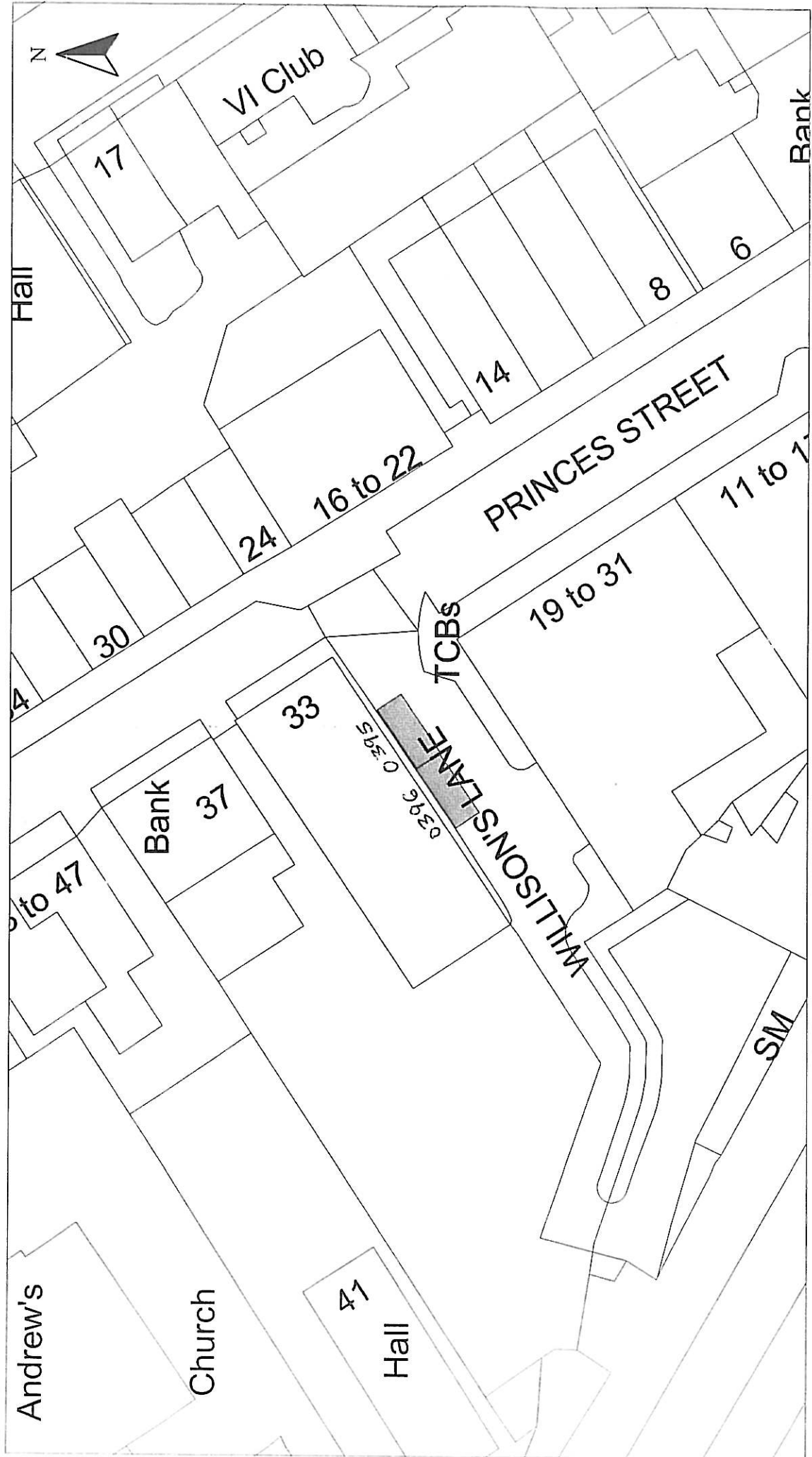

HEAD OF SERVICE IAN MOFFAT 71 EAST HAMILTON STREET GREENOCK, PA15 2UA	Scale : 1:500	Date : APRIL 2013
	Prepared by : R. MACKAY	Checked by :
Disabled Bays	Drawn by : R. MACKAY	Approved by :
Disabled PERSONS' PARKING PLACE WILLISON'S LANE, PORT GLASGOW PLACES No. 0395 & 0396 REVOCATION	Drawing No. : 19/12	File No. :

Reproduced from Ordnance Survey mapping with the permission
 of the Controller of Her Majesty's Stationery Office. Crown
 Copyright. Unauthorised reproduction infringes Crown Copyright
 and may result in prosecution or legal proceedings.

 Licence No. LA03097L

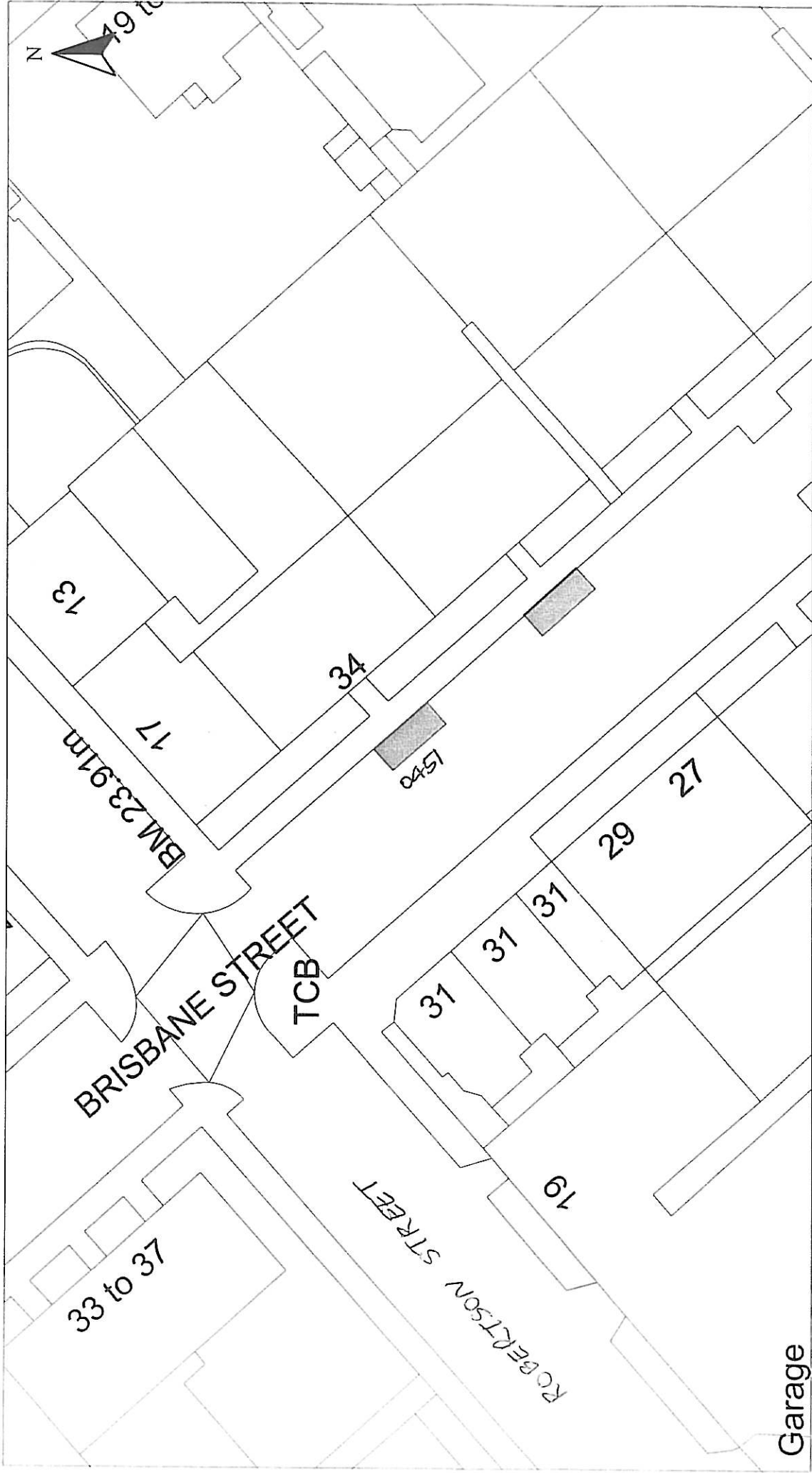

Garage

Disabled Bays HEAD OF SERVICE IAN MOFFAT 71 EAST HAMILTON STREET GREENOCK, PA15 2UA	Reproduced from Ordnance Survey mapping with the permission of the Controller of Her Majesty's Stationery Office. Crown Copyright. Unauthorised reproduction infringes Crown Copyright and may result in prosecution or legal proceedings.  Licence No. LA03097L		DISABLED PERSONS' PARKING PLACE 34 BRISBANE STREET, GREENOCK PLACE No. 0451 REVOCATION		Scale : 1:500 Prepared by : R. MACKAY Drawn by : R. MACKAY Drawing No. :	Date : APRIL 2013 Checked by : Approved by : File No. : 19/12

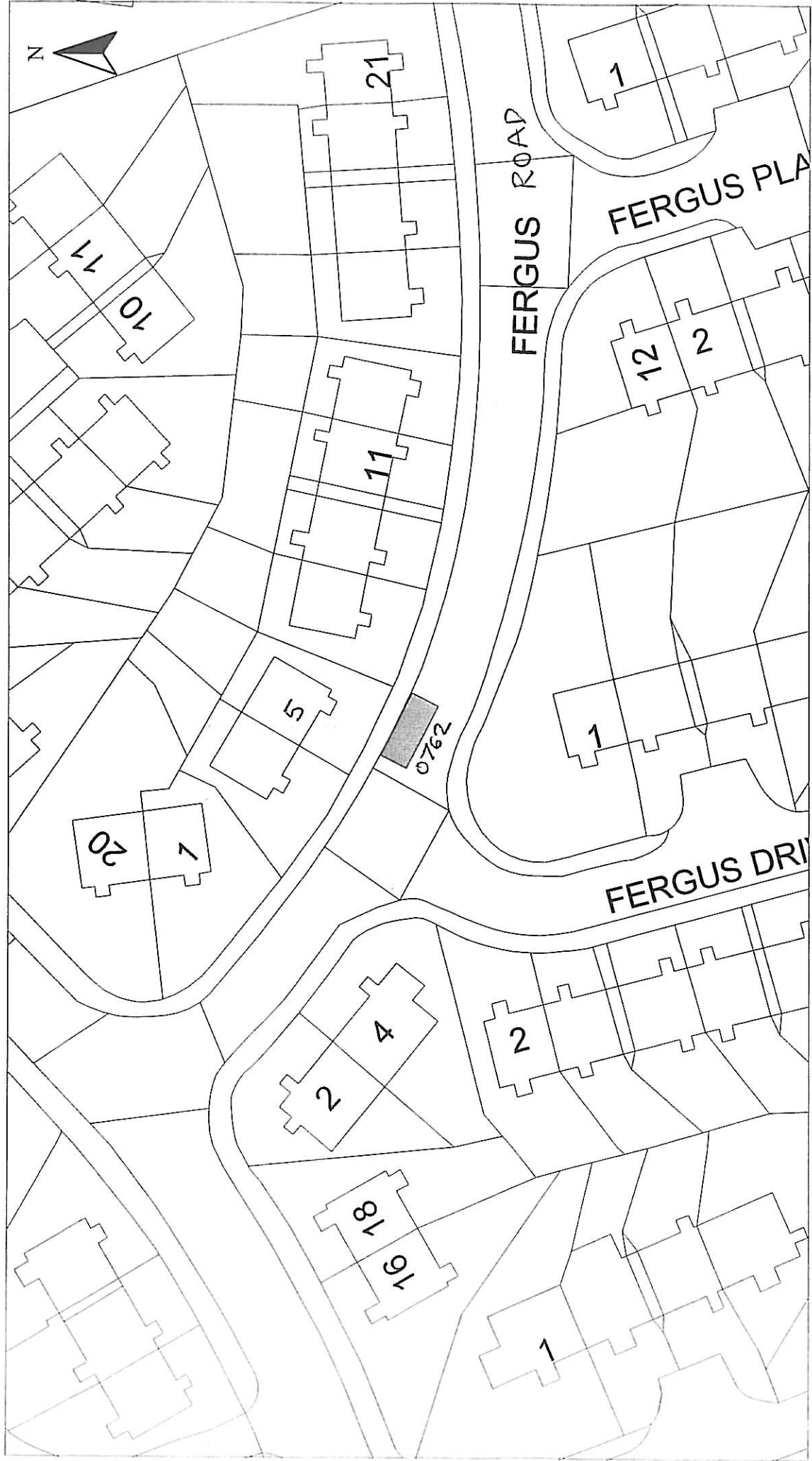

DISABLED PERSONS' PARKING PLACE
5 FERGUS ROAD, GREENOCK
PLACE No. 0762 REVOCATION

Scale : 1:500
Date : APRIL 2013
Prepared by : R. MACKAY
Checked by :
Drawn by : R. MACKAY
Approved by :
Drawing No. : 19/12

Reproduced from Ordnance Survey mapping with the permission of the Controller of Her Majesty's Stationary Office. Crown Copyright. Unauthorised reproduction infringes Crown Copyright and may result in prosecution or legal proceedings.

Licence No. LA03097L

HEAD OF SERVICE
IAN MOFFAT

71 EAST HAMILTON STREET
GREENOCK, PA15 2UA

Disabled Bays



HEAD OF SERVICE
IAN MOFFAT

Disabled Bays
71 EAST HAMILTON STREET
GREENOCK, PA15 2JA

Reproduced from Ordnance Survey mapping with the permission of the Controller of Her Majesty's Stationery Office. Crown Copyright. Unauthorised reproduction infringes Crown Copyright and may result in prosecution or legal proceedings.

Ordnance Survey
Licence No. LA03097L

DISABLED PERSONS' PARKING PLACE
69 ISLAY AVENUE, GREENOCK
PLACE No. 1074 REVOCATION

Scale : 1:500

Prepared by : R. MACKAY

Drawn by : R. MACKAY

Checked by :
Approved by :
File No. : 19/12

Date : APRIL 2013

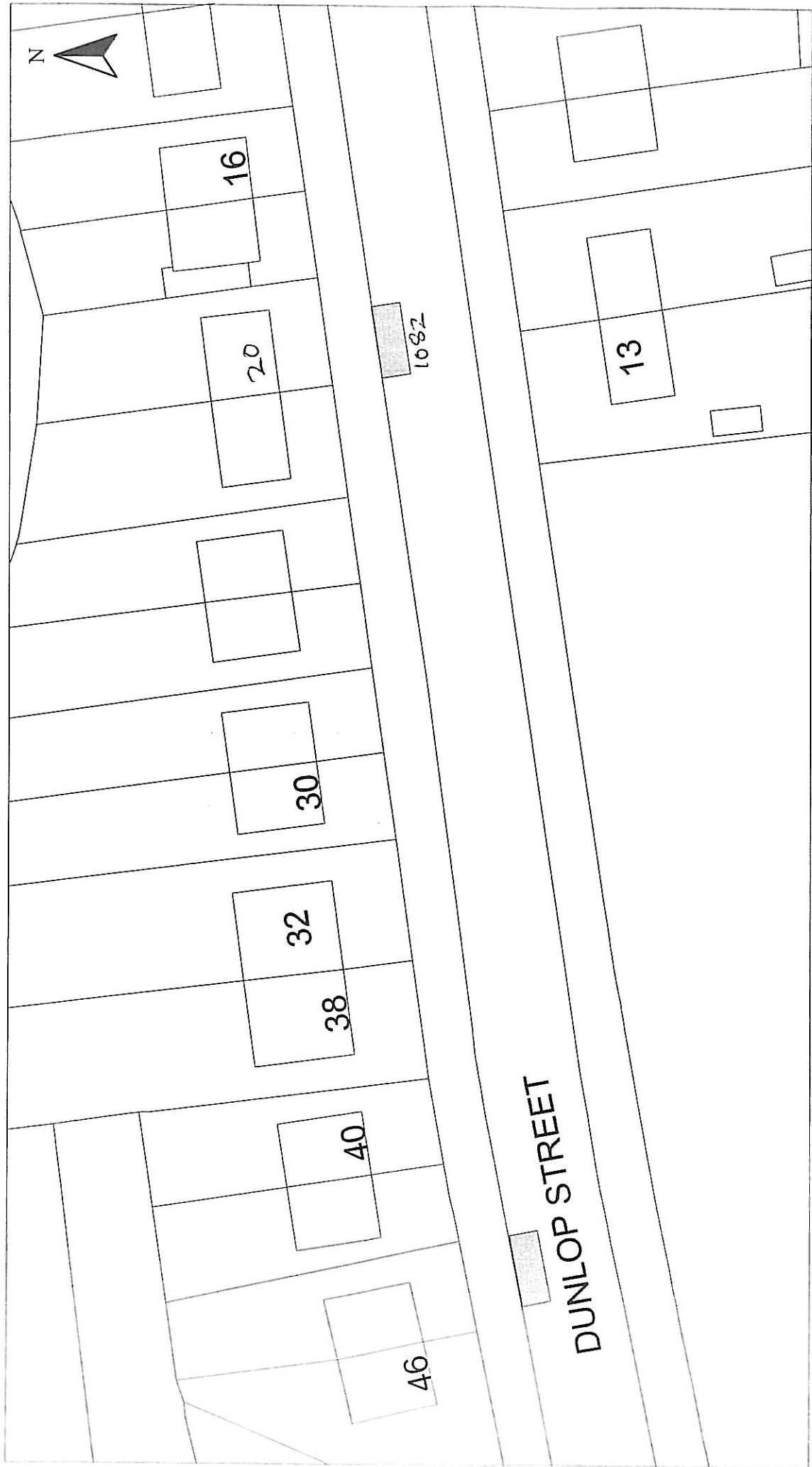

HEAD OF SERVICE
IAN MOFFAT

Disabled Bays
71 EAST HAMILTON STREET
GREENOCK, PA15 2UA

Reproduced from Ordnance Survey mapping with the permission of the Controller of Her Majesty's Stationery Office. Crown Copyright. Unauthorised reproduction infringes Crown Copyright and may result in prosecution or legal proceedings.
Licence No. LA030097L
Ordnance Survey

DISABLED PERSONS' PARKING PLACE
20 DUNLOP STREET, GREENOCK
PLACE No. 1082 REVOCATION

Scale : 1:500
Prepared by : R. MACKAY
Drawn by : R. MACKAY
Drawing No. :

Date : APRIL 2013
Checked by :
Approved by :
File No. : 19/12