

**Report To:** ENVIRONMENT AND REGENERATION COMMITTEE Date: 5 SEPT 2013

**Report By:** CORPORATE DIRECTOR,  
ENVIRONMENT, REGENERATION &  
RESOURCES Report No: LA/1055/13

**Contact Officer:** JOANNA DALGLEISH Contact No: 01475 712123

**Subject:** PROPOSED TRAFFIC REGULATION ORDER – DISABLED PERSONS’ PARKING PLACES (ON STREET) ORDER NO. 3 2013

---

## 1.0 PURPOSE

1.1 Local Authorities are empowered to make Orders under the Road Traffic Regulation and Roads (Scotland) Acts 1984 and under the Council’s Scheme of Administration the Head of Environmental & Commercial Services is responsible for the making, implementation and review of Traffic Management Orders and Traffic Regulation Orders.

## 2.0 BACKGROUND

2.1 In order to comply with the Disabled Persons’ Parking Places (Scotland) Act 2009, Section 5, it is proposed to introduce a Traffic Regulation Order to accompany the provision of parking bays for the disabled. This will restrict parking to drivers displaying a Blue Badge only, and will enable the Police to enforce such restrictions.

2.2 The proposals have been advertised in the Greenock Telegraph and full details of the proposals have been made available for public inspection during normal office hours at the offices of the Head of Environmental & Commercial Services, the Head of Legal & Democratic Services and at Central, Port Glasgow, Gourock and South West Libraries. A copy of the draft Order is appended hereto for Members’ information.

Appendix

2.3 No objections to the proposals have been received and, accordingly, the Committee is requested to approve the Order.

2.4 The Committee is asked to note that, if approved, the Order may not be implemented until the making of the Order has been advertised to allow any persons who so wish a period of six weeks to question the validity of the Order in terms of the Road Traffic Regulation Act 1984.

## 3.0 RECOMMENDATION

3.1 That the Committee recommend to The Inverclyde Council the making of the Traffic Regulation Order – Disabled Persons’ Parking Places (On Street) Order No 3. 2013 and remit it to the Head of Environmental & Commercial Services and Head of Legal & Democratic Services to arrange for its implementation.

**Legal & Democratic Services**

**THE INVERCLYDE COUNCIL**  
**DISABLED PERSONS' PARKING PLACES**  
**(ON STREET) ORDER NO. 3 2013**  
**TRAFFIC REGULATION ORDER**

DRAFT

**THE INVERCLYDE COUNCIL**  
**DISABLED PERSONS' PARKING PLACES (ON STREET)**  
**ORDER NO. 3 2013**

The Inverclyde Council in exercise of the powers conferred on them by Sections 32(1) of the Road Traffic Regulation Act 1984 ("the Act") and of all other enabling powers and after consultation with the Chief Constable of Strathclyde Police in accordance with Part III of Schedule 9 to the Act hereby make the following Order.

1. This Order may be cited as "The Inverclyde Council Disabled Persons' Parking Places (On Street) Order No. 3 2013 and shall come into operation on #####"

2. In this Order the following expressions have the meanings hereby assigned to them:

"vehicle" unless the context otherwise requires, means a vehicle of any description and includes a machine or implement of any kind drawn or propelled along roads whether or not by mechanical power;

"parking place" means a place where a vehicle, or vehicles of any class, may wait i.e. the area of land specified in the Schedule for which the use as a parking place has been authorised by the Council under Section 32(1) of the Act;

"sign" means a traffic sign;

"disabled person's badge" means:-

(a) a badge issued under Section 21 of the Chronically Sick and Disabled Persons Act 1970;

(b) a badge issued under a provision of the law of Northern Ireland corresponding to that section; or

(c) a badge issued by any member State other than the United Kingdom for purposes corresponding to the purposes for which badges under that section are issued;

and has not ceased to be in force.

"disabled person's vehicle" means a vehicle lawfully displaying a disabled person's badge;

"Council" means The Inverclyde Council;

3. Each area of road which is described in the Schedule and plans relative to this Order is hereby designated as a parking place.

4. The parking places designated in this Order shall only be used for the leaving of disabled persons' vehicles displaying a valid disabled person's badge.

5. The limits of each parking place designated in this Order shall be indicated on the carriageway as prescribed by The Traffic Signs Regulations and General Directions 2002 as amended.
6. Every vehicle left in any parking place designated in this Order shall stand such that no parking place is occupied by more than one vehicle and that every part of the vehicle is within the limits of the parking place provided that, where the length of a vehicle precludes compliance with this paragraph, such vehicle shall be deemed to be within the limits of a parking place if;
  - i. the extreme front portion or, as the case may be, the extreme rear portion of the vehicle is within 300mm of an indication on the carriageway provided under this Order in relation to the parking place; and
  - ii. the vehicle, or any part thereof, is not within the limits of any adjoining parking place.
7. Any person duly authorised by the Council or a police officer in uniform or a traffic warden or parking attendant may move or cause to be moved in case of any emergency, to any place they think fit, vehicles left in a parking place.
8. Any person duly authorised by the Council may suspend the use of a parking place or any part thereof whenever such suspension is considered reasonably necessary:
  - i. for the purpose of facilitating the movement of traffic or promoting its safety;
  - ii. for the purpose of any building operation, demolition, or excavation in or adjacent to the parking place or the laying, erection, alteration, removal or repair in or adjacent to the parking place of any sewer or of any main, pipe, apparatus for the supply of gas, water electricity or of any telecommunications apparatus, traffic sign or parking meter;
  - iii. for the convenience of occupiers of premises adjacent to the parking place on any occasion of the removal of furniture from one office or dwellinghouse to another or the removal of furniture from such premises to a depository or to such premises from a depository;
  - iv. on any occasion on which it is likely by reason of some special attraction that any street will be thronged or obstructed; or
  - v. for the convenience of occupiers of premises adjacent to the parking place at times of weddings or funerals or on other special occasions.
9. A police officer in uniform may suspend for not longer than twenty four hours the use of a parking place or part thereof whenever such suspension is considered reasonably necessary for the purpose of facilitating the movement of traffic or promoting its safety.

10. This Order insofar as it relates to the parking places to be revoked (R) and amended, as specified in the Schedule to this Order, partially revokes and amends the On-Street Parking Places (Without Charges) Order No. 2 1997, No. 1 2005, No. 1 2008 and the Disabled Persons' Parking Places (On Street) Order No. 1 2010, No. 2 2011 and No. 3 2011 respectively.

Sealed with the Common Seal of The Inverclyde Council and subscribed for them and on their behalf by ##

DRAFT

**INVERCLYDE COUNCIL**

**DISABLED PERSONS' PARKING PLACES (ON STREET)  
ORDER NO. 3 2013**

**Statement of Reasons for Proposing to Make  
the Above Order**

It is considered necessary to make the above Order to provide assistance for disabled persons who hold a badge under the Disabled Persons (Badges for Motor Vehicles) (Scotland) Regulations 2000 as amended and by revoking those parking places no longer required to maximise street parking capacity.

DRAFT

INVERCLYDE COUNCIL

DISABLED PERSONS' PARKING PLACES (ON-STREET)  
ORDER No.3 2013

SCHEDULE

Rev B

All and whole that area of ground as described in Column 2 in the table below:

<u>Ref No.</u>	<u>Address of Disabled Person's Parking Place to be created or revoked @ "ex-adverso"</u>
1207	76 Manor Crescent, Gourrock
1303	28 Newton Street, Greenock
1307	15 Highholm Street, Port Glasgow
1310	30 Newark Street, Greenock
1313	1 Sir Michael Place, Greenock
1314	46A Newton Street, Greenock
0455a	6 Regent Street, Greenock
9741	Cathcart Square, Greenock ®
9741a	Cathcart Square, Greenock ®
0395	Willison's Lane, Port Glasgow ®
0396	Willison's Lane, Port Glasgow ®
0451	34 Brisbane Street, Greenock ®
0762	5 Fergus Road, Greenock ®
1074	69 Islay Avenue, Port Glasgow ®
1082	20 Dunlop Street, Greenock ®

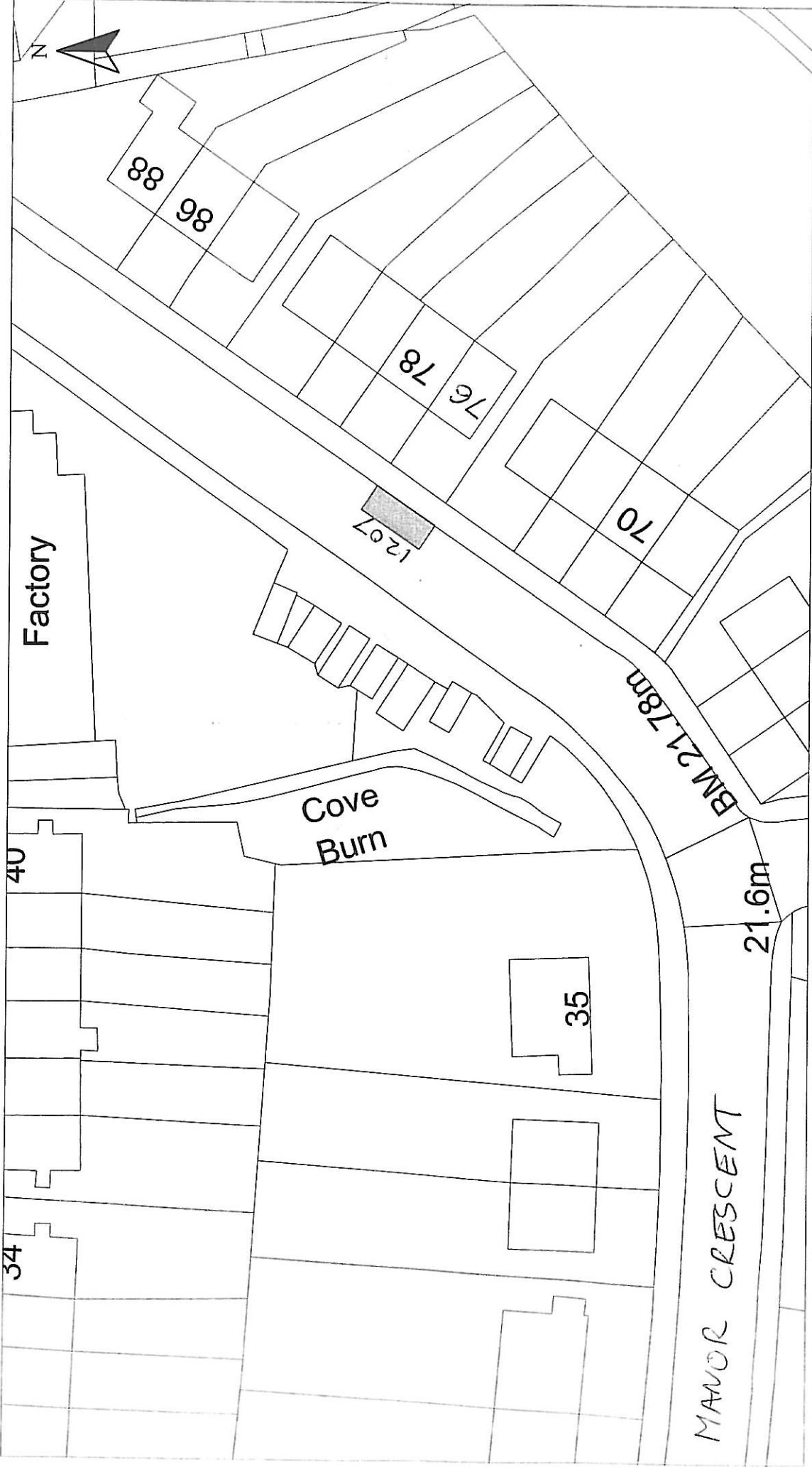

HEAD OF SERVICE  
IAN MOFFAT

Disabled Bays  
71 EAST HAMILTON STREET  
GREENOCK, PA15 2UA

Reproduced from Ordnance Survey mapping with the permission of the Controller of Her Majesty's Stationery Office. Copyright. Unauthorised reproduction infringes Crown Copyright and may result in prosecution or legal proceedings.



**DISABLED PERSONS' PARKING PLACE**  
76 MANOR CRESCENT, GOUROCK  
PLACE No. 1207

Scale : 1:500

Prepared by : R. MACKAY

Drawn by : R. MACKAY

Checked by :  
Approved by :  
File No. : 19/12

Date : APRIL 2013



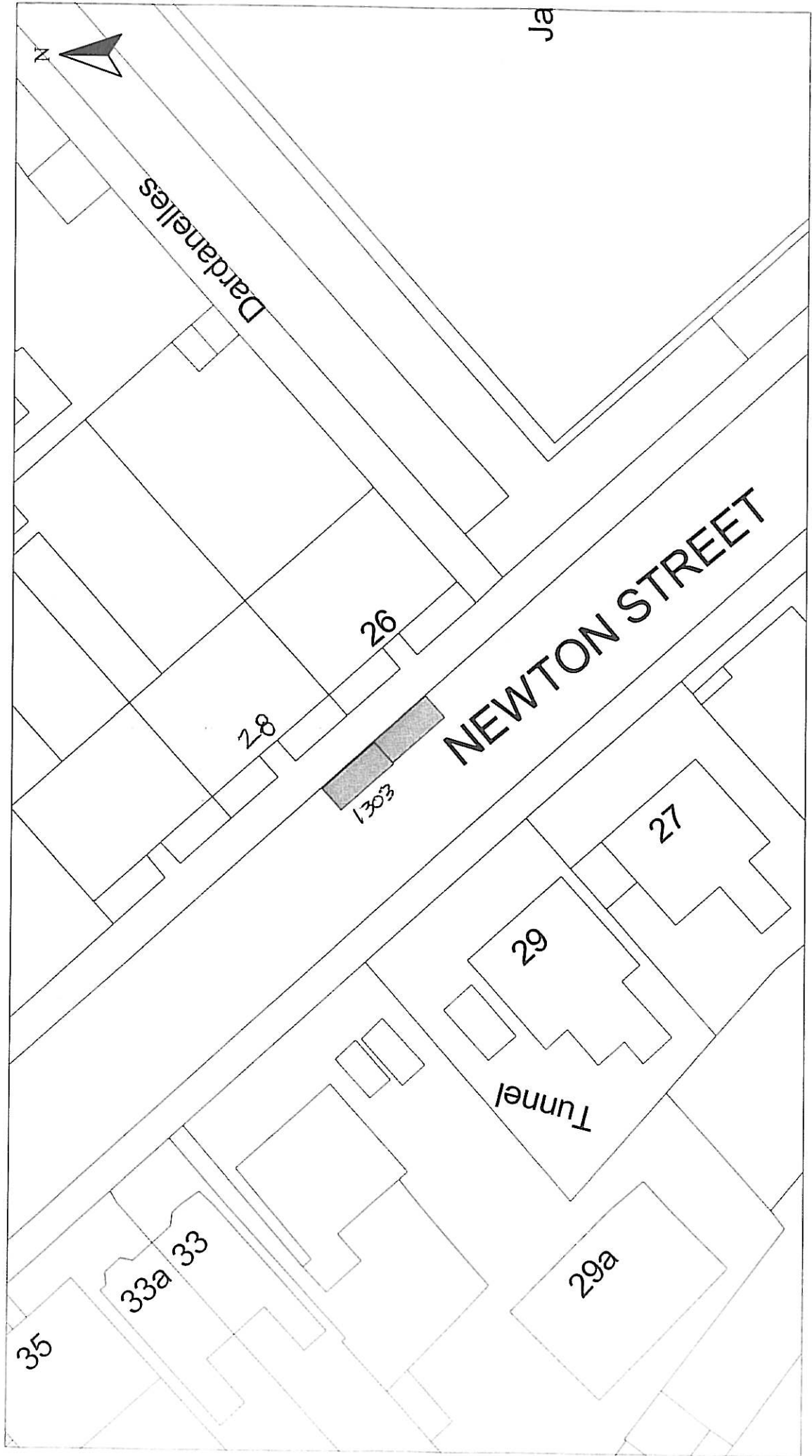

HEAD OF SERVICE  
IAN MOFFAT

71 EAST HAMILTON STREET  
GREENOCK, PA15 2UA

Disabled Bays

Reproduced from Ordnance Survey mapping with the permission of the Controller of Her Majesty's Stationery Office. Crown Copyright. Unauthorised reproduction infringes Crown Copyright and may result in prosecution or legal proceedings.

Licence No. LA03097L  
**Ordnance Survey**

**DISABLED PERSONS' PARKING PLACE**  
28 NEWTON STREET, GREENOCK  
PLACE No. 1303

Scale : 1:500

Prepared by : R. MACKAY

Drawn by : R. MACKAY

Drawing No. : 19/12

Date : APRIL 2013

Checked by :

Approved by :

File No. :

# Inverclyde council

## ENVIRONMENTAL & COMMERCIAL SERVICES

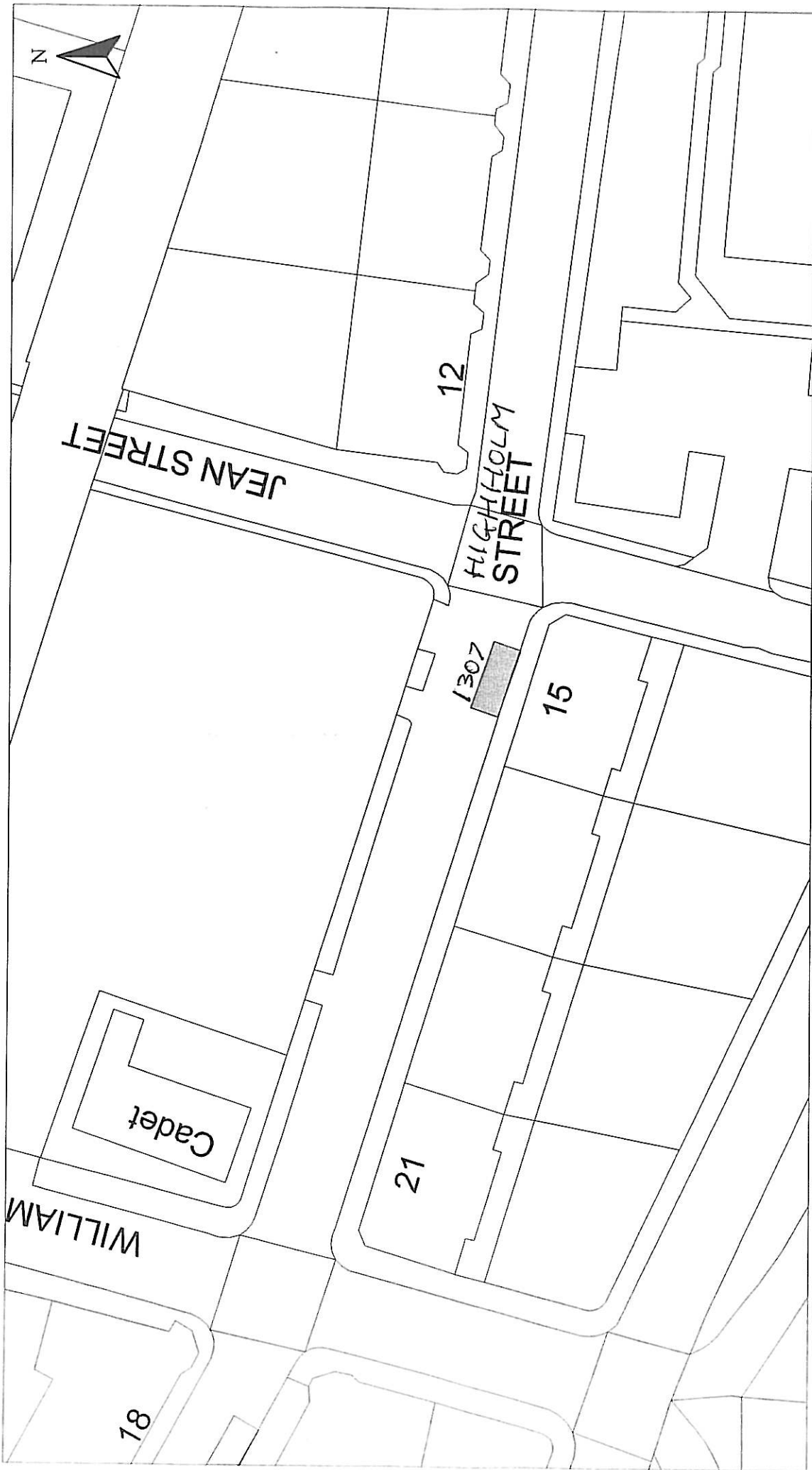

HEAD OF SERVICE IAN MOFFAT	DISABLED PERSONS' PARKING PLACE		Scale : 1:500	Date : APRIL 2013
	15 HIGHHOLM STREET, PORT GLASGOW PLACE No. 1307		Prepared by : R. MACKAY	Checked by :
Disabled Bays	71 EAST HAMILTON STREET GREENOCK, PA15 2UA		Drawn by : R. MACKAY	Approved by :
	<small>Reproduced from Ordnance Survey mapping with the permission of the Controller of Her Majesty's Stationery Office. Crown Copyright. No part of this publication may be reproduced, stored in a retrieval system or transmitted in any form or by any means, electronic, mechanical, photocopying, recording and may result in prosecution or legal proceedings.</small>  <small>Licence No. LA03097L</small>		Drawing No. :	File No. : 19/12

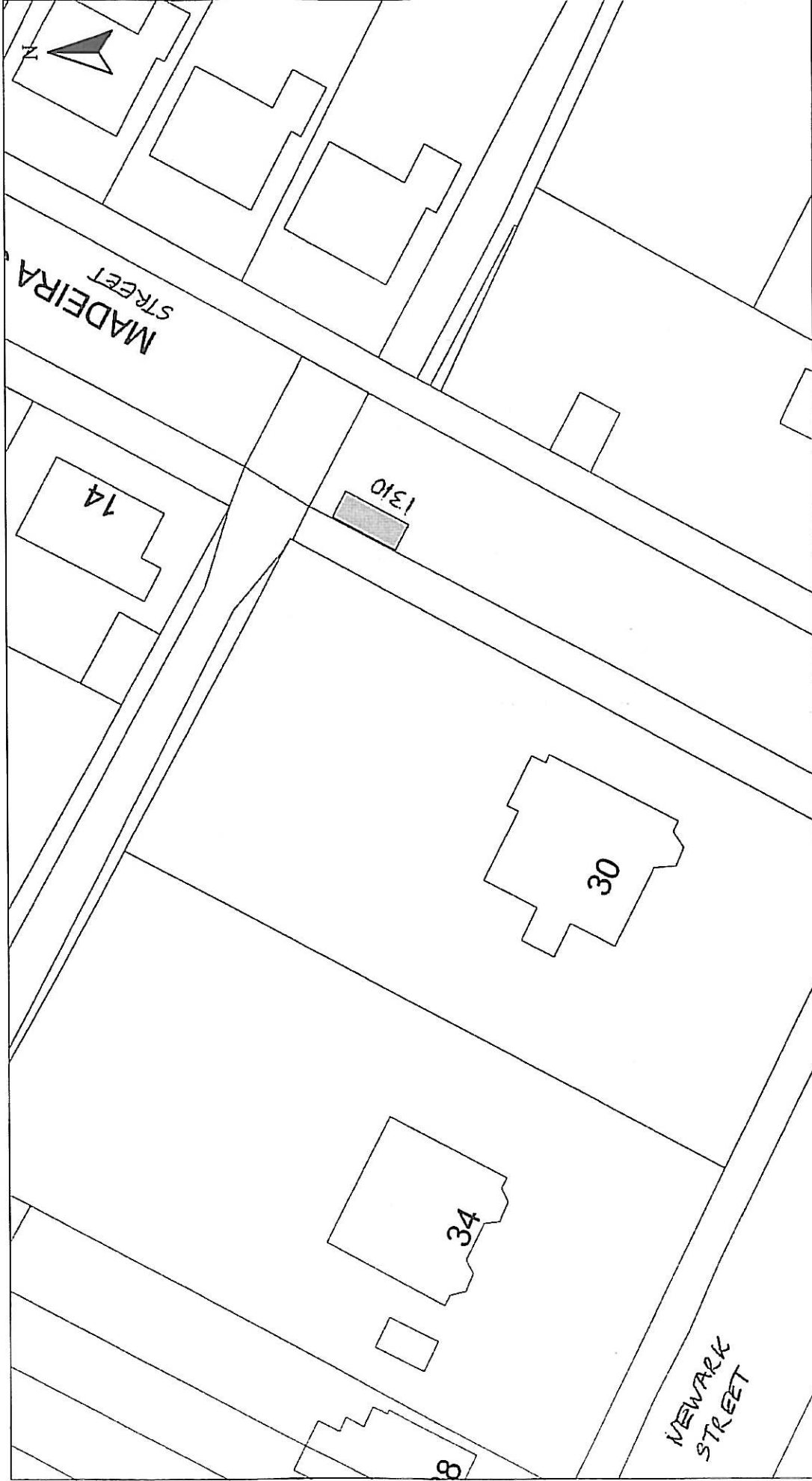

**DISABLED PERSONS' PARKING PLACE**  
30 NEWARK STREET, GREENOCK  
PLACE No. 1310

Reproduced from Ordnance Survey mapping with the permission of the Controller of Her Majesty's Stationery Office. Crown Copyright. Unauthorised reproduction is prohibited in law and may result in prosecution or legal proceedings.  
Licence No. LA03097L  
**Ordnance Survey**

**HEAD OF SERVICE**  
IAN MOFFAT  
71 EAST HAMILTON STREET  
GREENOCK, PA15 2UA

Disabled Bays

Scale : 1:500  
Prepared by : R. MACKAY  
Drawn by : R. MACKAY  
Date : JULY 2013  
Checked by :  
Approved by :  
File No. : 19/12

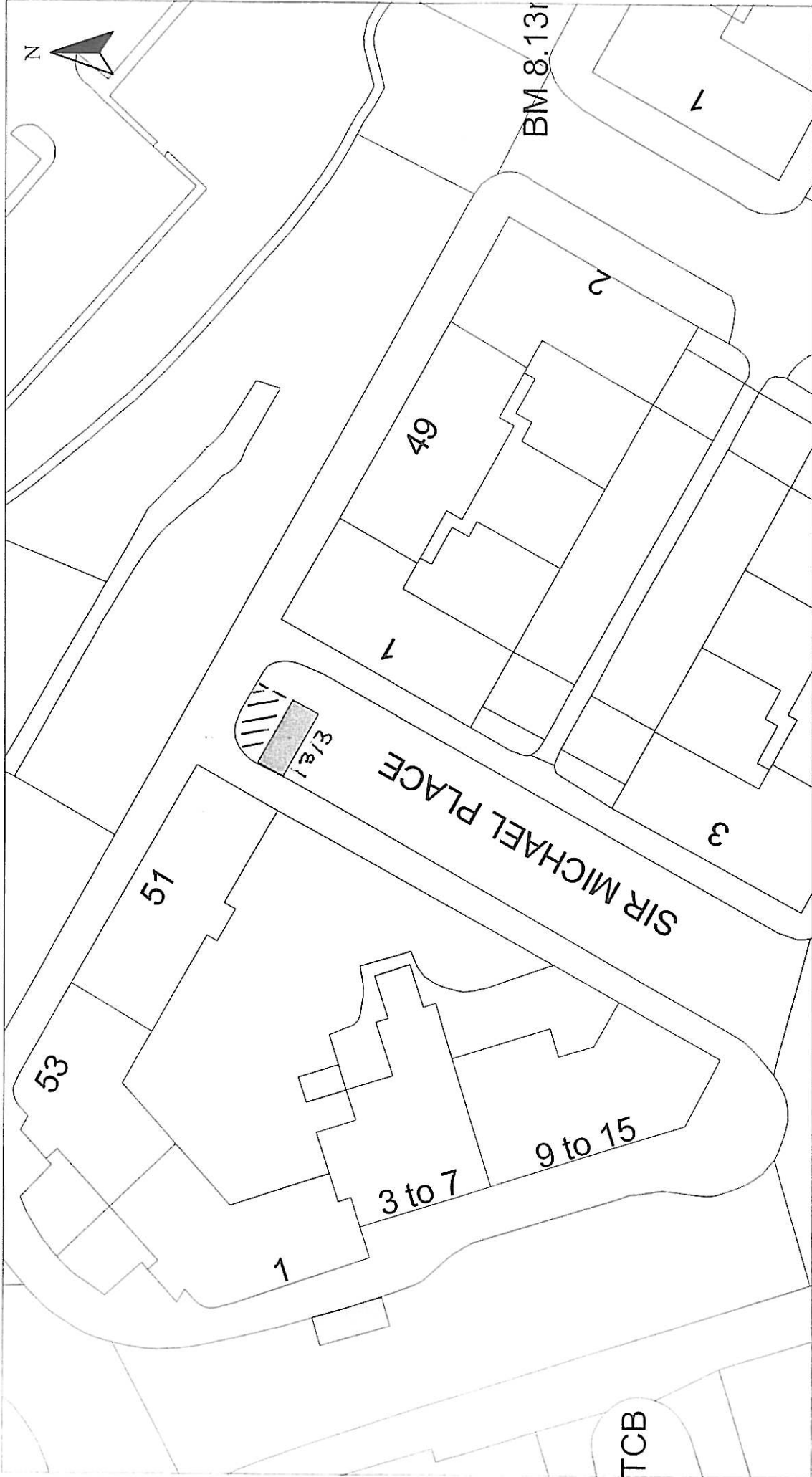

HEAD OF SERVICE  
IAN MOFFAT

Disabled Bays  
71 EAST HAMILTON STREET  
GREENOCK, PA15 2UA

Reproduced from Ordnance Survey mapping with the permission of the Controller of Her Majesty's Stationery Office. Crown Copyright. Unauthorised reproduction infringes Crown Copyright and may result in prosecution or legal proceedings.



Licence No. LA03097L

**DISABLED PERSONS' PARKING PLACE**  
1 SIR MICHAEL PLACE, GREENOCK  
PLACE No. 1313

Scale :	1:500	Date :	MAY 2013
Prepared by :	R. MACKAY	Checked by :	
Drawn by :	R. MACKAY	Approved by :	
Drawing No. :		File No. :	19/12

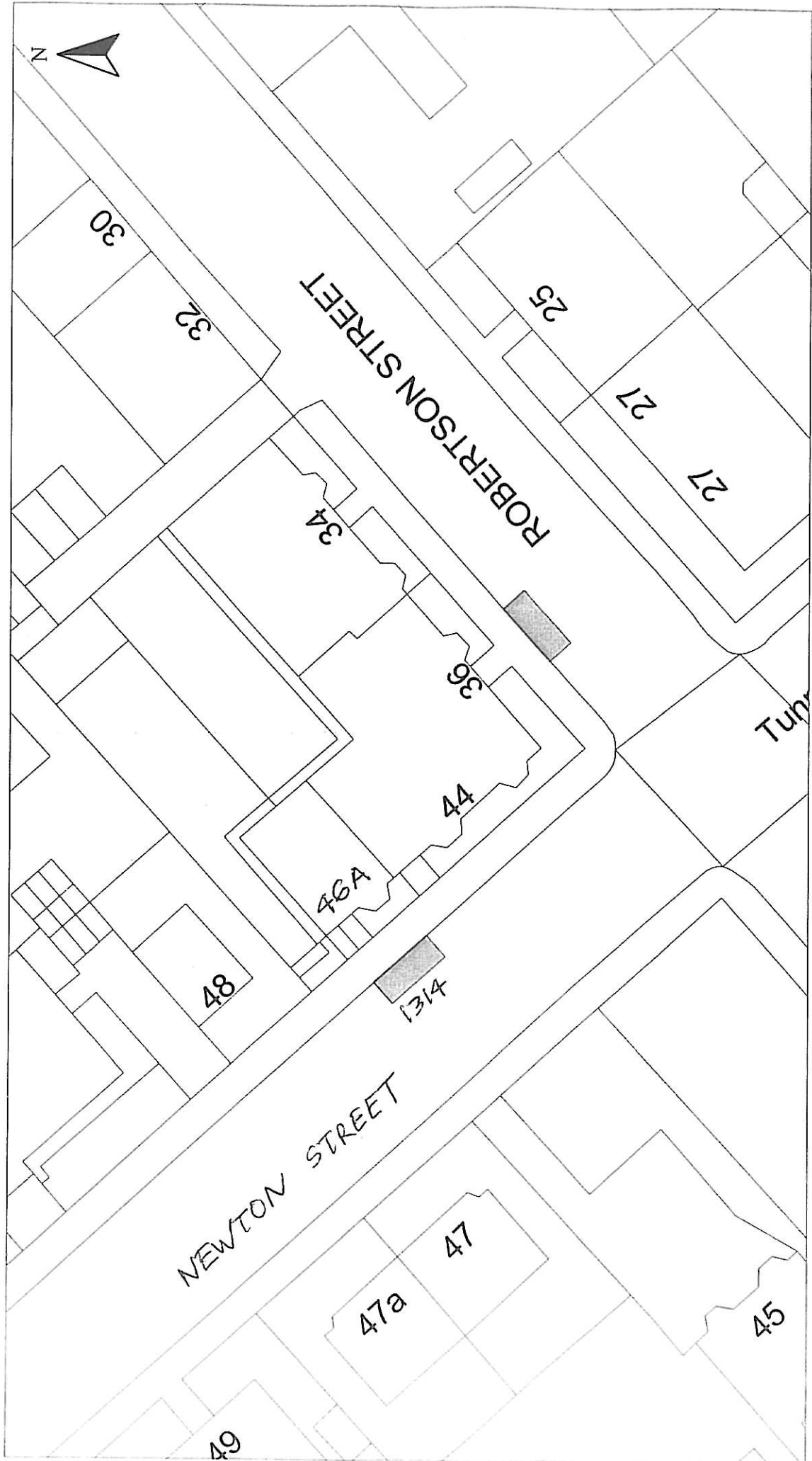

HEAD OF SERVICE  
IAN MOFFAT

Disabled Bays  
71 EAST HAMILTON STREET  
GREENOCK, PA15 2JA

Reproduced from Ordnance Survey mapping with the permission of the Controller of Her Majesty's Stationery Office. Crown Copyright. Unauthorised reproduction infringes Crown Copyright and may result in prosecution or legal proceedings.  
Licence No. LA03097L  
**Ordnance Survey**

**DISABLED PERSONS' PARKING PLACES**  
46A NEWTON STREET, GREENOCK  
PLACE No. 1314

Scale :	1:500	Date :	APRIL 2013
Prepared by :	R. MACKAY	Checked by :	
Drawn by :	R. MACKAY	Approved by :	
Drawing No. :		File No. :	19/12

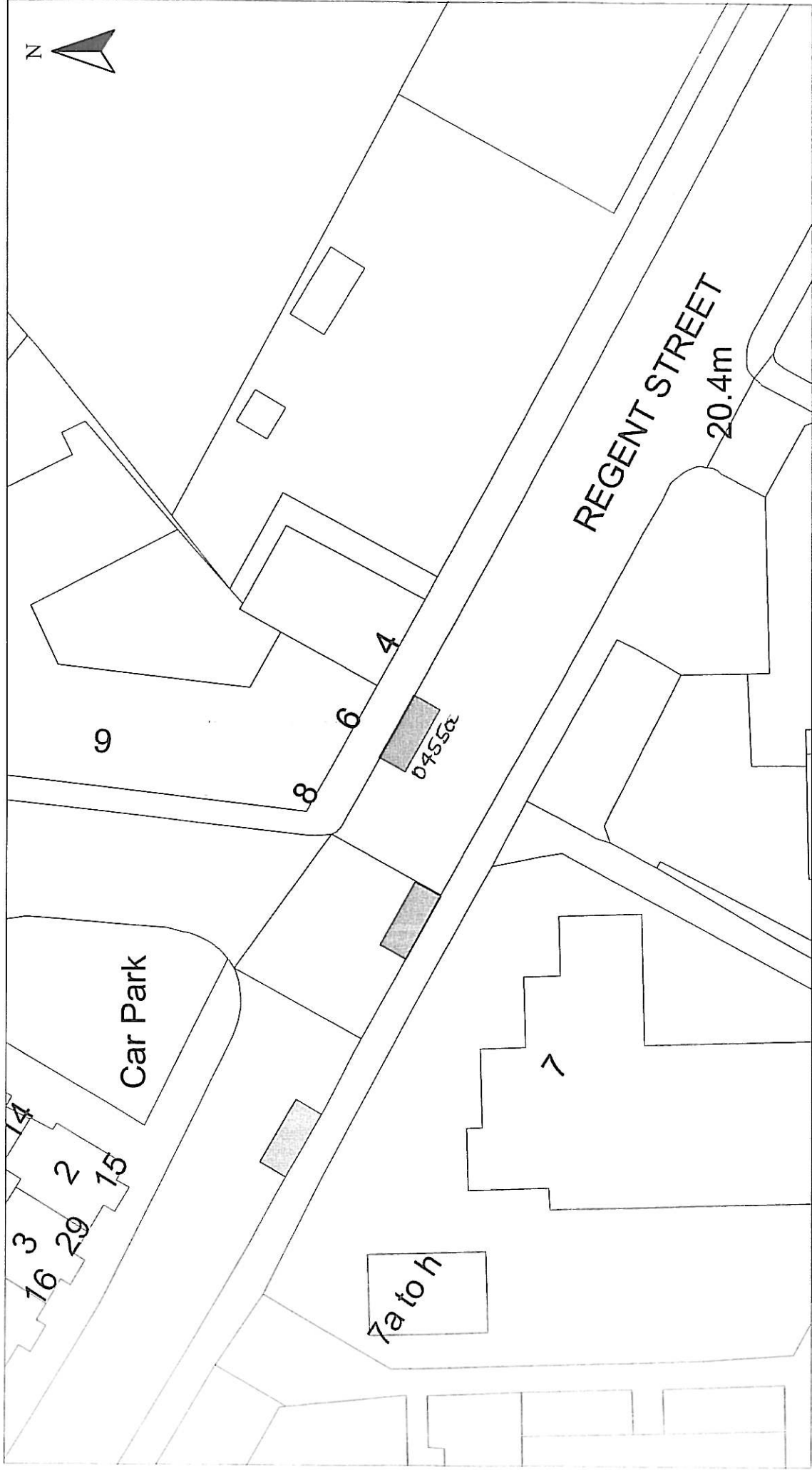

HEAD OF SERVICE  
IAN MOFFAT

71 EAST HAMILTON STREET  
GREENOCK, PA15 2JA

Reproduced from Ordnance Survey mapping with the permission of the Controller of Her Majesty's Stationery Office. Crown Copyright. Unauthorised reproduction infringes Crown Copyright and may result in prosecution or legal proceedings.



**DISABLED PERSONS' PARKING PLACE**  
**6 REGENT STREET, GREENOCK**  
**PLACE No. 0455a**

Scale :	1:500	Date :	APRIL 2013
Prepared by :	R. MACKAY	Checked by :	
Drawn by :	R. MACKAY	Approved by :	
Drawing No. :		File No. :	19/12

Disabled Bays

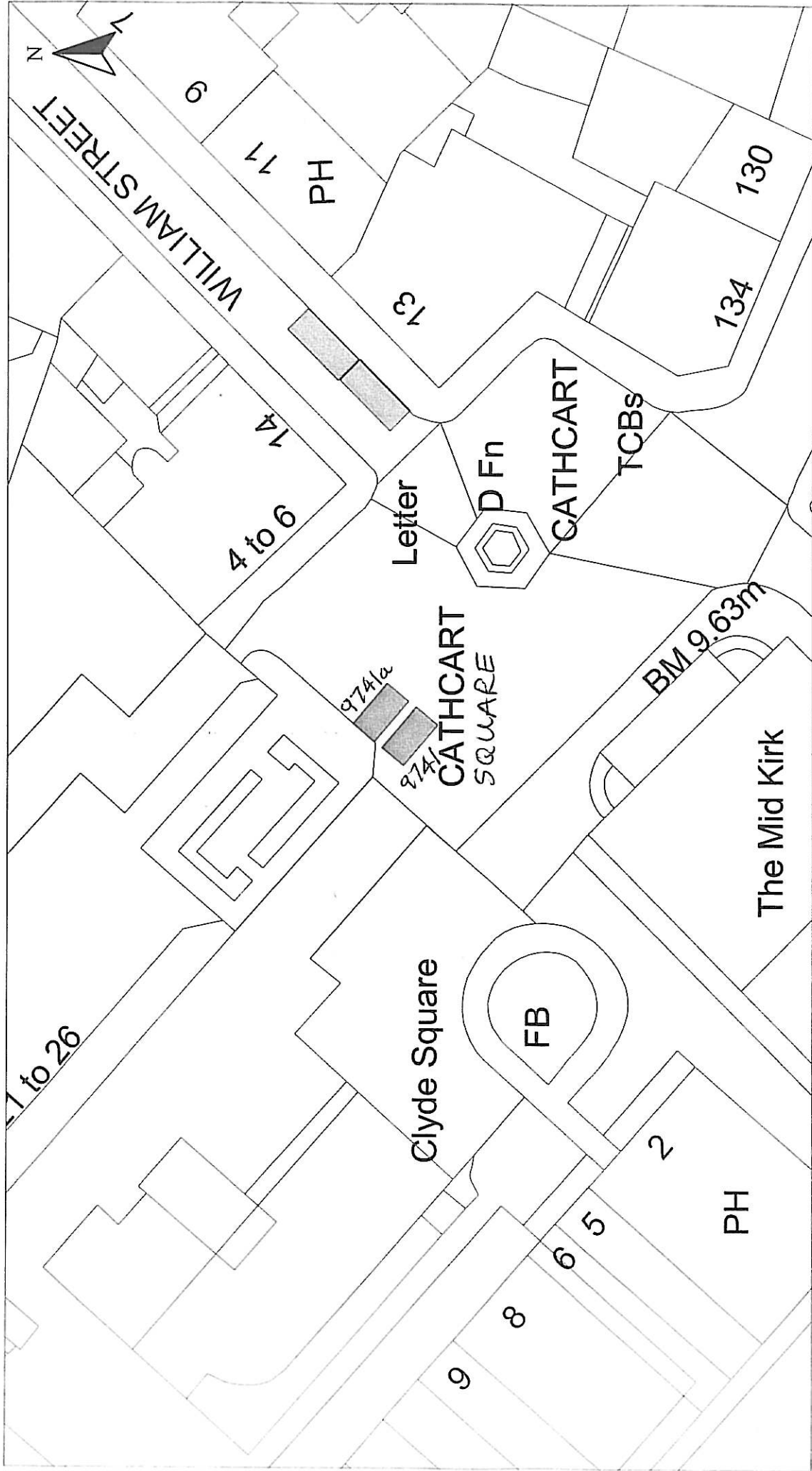

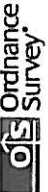
Disabled Bays 71 EAST HAMILTON STREET GREENOCK, PA15 2UA	HEAD OF SERVICE IAN MOFFAT		Reproduced from Ordnance Survey mapping with the permission of the Controller of Her Majesty's Stationery Office. Crown Copyright. Unauthorised reproduction infringes Crown Copyright and may result in prosecution or legal proceedings.  Licence No. LA03097L		DISABLED PERSONS' PARKING PLACE CATHCART SQUARE, GREENOCK PLACES No. 9741 & 9741a REVOCATION		Scale : 1:500	Date : APRIL 2013
					Prepared by : R. MACKAY	Checked by :		
				Drawn by : R. MACKAY		Approved by :		
				Drawing No. :		File No. : 19/12		

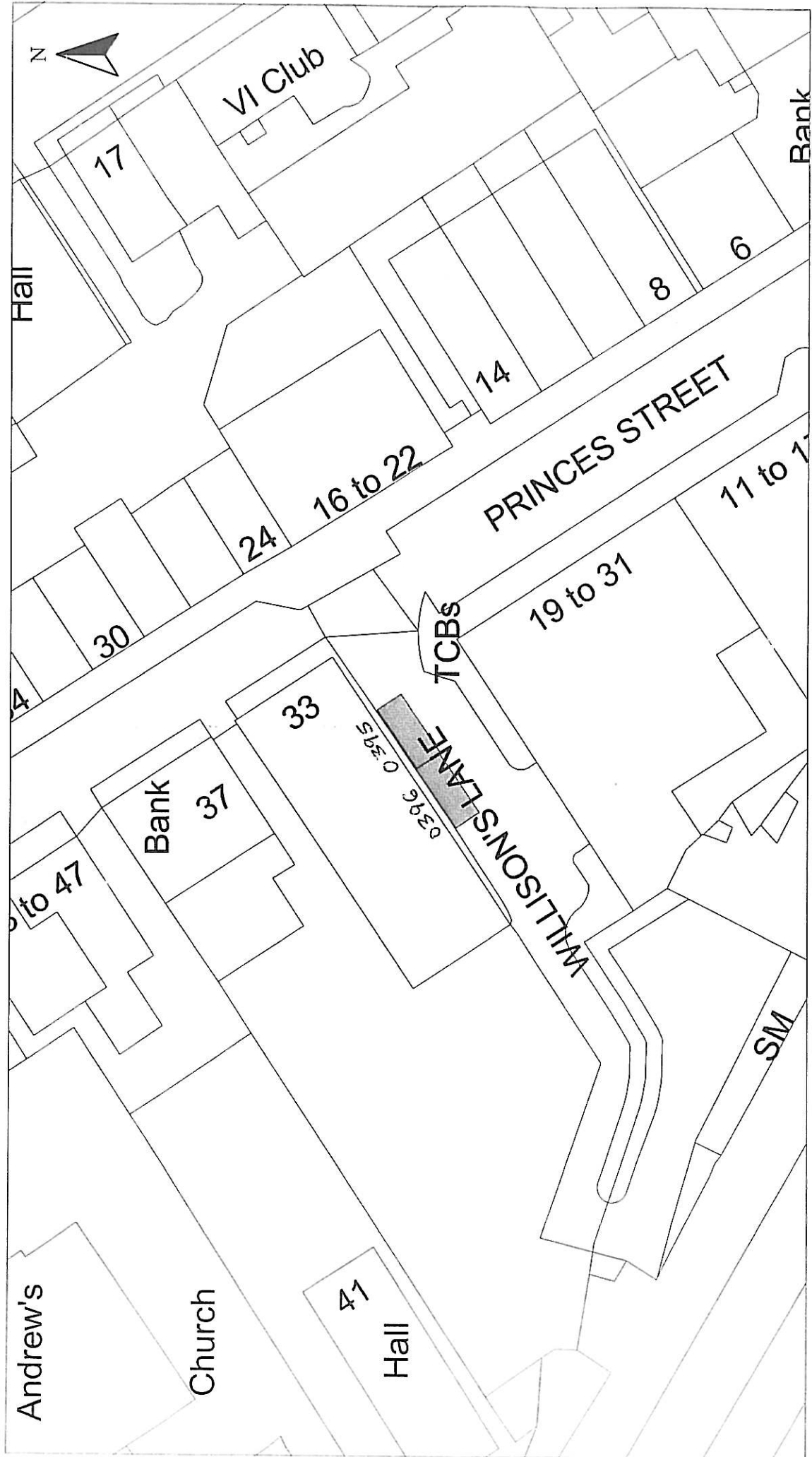

HEAD OF SERVICE IAN MOFFAT  71 EAST HAMILTON STREET GREENOCK, PA15 2UA	Scale : 1:500	Date : APRIL 2013
	Prepared by : R. MACKAY	Checked by :
Disabled Bays	Drawn by : R. MACKAY	Approved by :
Disabled PERSONS' PARKING PLACE WILLISON'S LANE, PORT GLASGOW PLACES No. 0395 & 0396 REVOCATION	Drawing No. :	File No. : 19/12

Reproduced from Ordnance Survey mapping with the permission  
 of the Controller of Her Majesty's Stationery Office. Crown  
 Copyright. Unauthorised reproduction infringes Crown Copyright  
 and may result in prosecution or legal proceedings.  
 Licence No. LA03097L



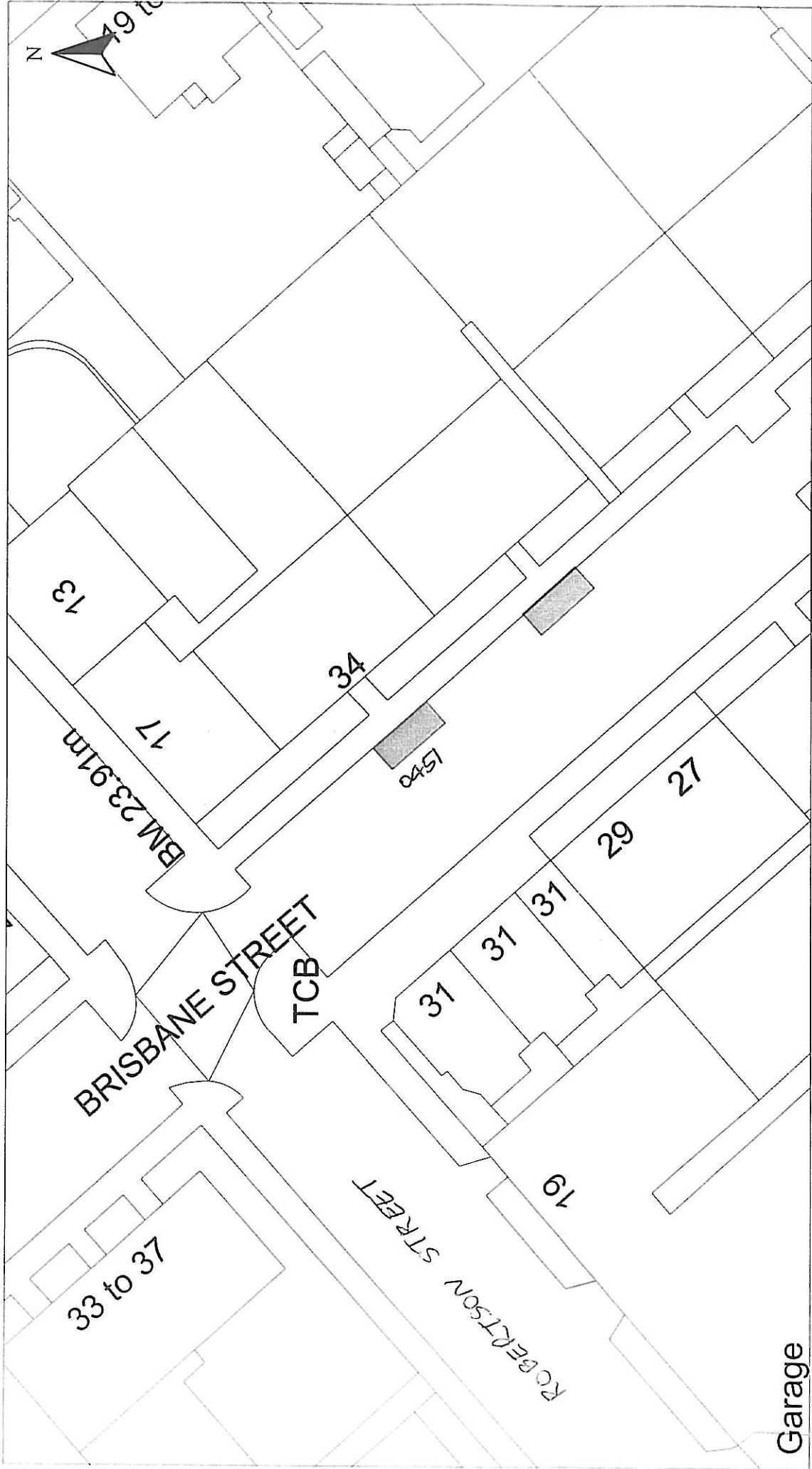

HEAD OF SERVICE  
IAN MOFFAT

Disabled Bays  
71 EAST HAMILTON STREET  
GREENOCK, PA15 2UA

Reproduced from Ordnance Survey mapping with the permission of the Controller of Her Majesty's Stationery Office. Crown Copyright. Unauthorised reproduction infringes Crown Copyright and may result in prosecution or legal proceedings.



**DISABLED PERSONS' PARKING PLACE**  
34 BRISBANE STREET, GREENOCK  
PLACE No. 0451 REVOCATION

Scale : 1:500

Prepared by : R. MACKAY

Drawn by : R. MACKAY

Drawing No. :

Date : APRIL 2013

Checked by :

Approved by :

File No. : 19/12



**DISABLED PERSONS' PARKING PLACE**  
5 FERGUS ROAD, GREENOCK  
PLACE No. 0762 REVOCATION

Scale : 1:500  
Date : APRIL 2013  
Prepared by : R. MACKAY  
Checked by :  
Drawn by : R. MACKAY  
Approved by :  
Drawing No. : 19/12

Reproduced from Ordnance Survey mapping with the permission of the Controller of Her Majesty's Stationary Office. Crown Copyright. Unauthorised reproduction infringes Crown Copyright and may result in prosecution or legal proceedings.

Licence No. LA03097L

HEAD OF SERVICE  
IAN MOFFAT

71 EAST HAMILTON STREET  
GREENOCK, PA15 2UA

Disabled Bays



HEAD OF SERVICE  
IAN MOFFAT

Disabled Bays  
71 EAST HAMILTON STREET  
GREENOCK, PA15 2JA

Reproduced from Ordnance Survey mapping with the permission of the Controller of Her Majesty's Stationery Office. Crown Copyright. Unauthorised reproduction infringes Crown Copyright and may result in prosecution or legal proceedings.

Ordnance Survey  
Licence No. LA03097L

**DISABLED PERSONS' PARKING PLACE**  
69 ISLAY AVENUE, GREENOCK  
PLACE No. 1074 REVOCATION

Scale : 1:500

Prepared by : R. MACKAY

Drawn by : R. MACKAY

Checked by :  
Approved by :  
Drawing No. : 19/12

Date : APRIL 2013

# Inverclyde ENVIRONMENTAL & COMMERCIAL SERVICES

council

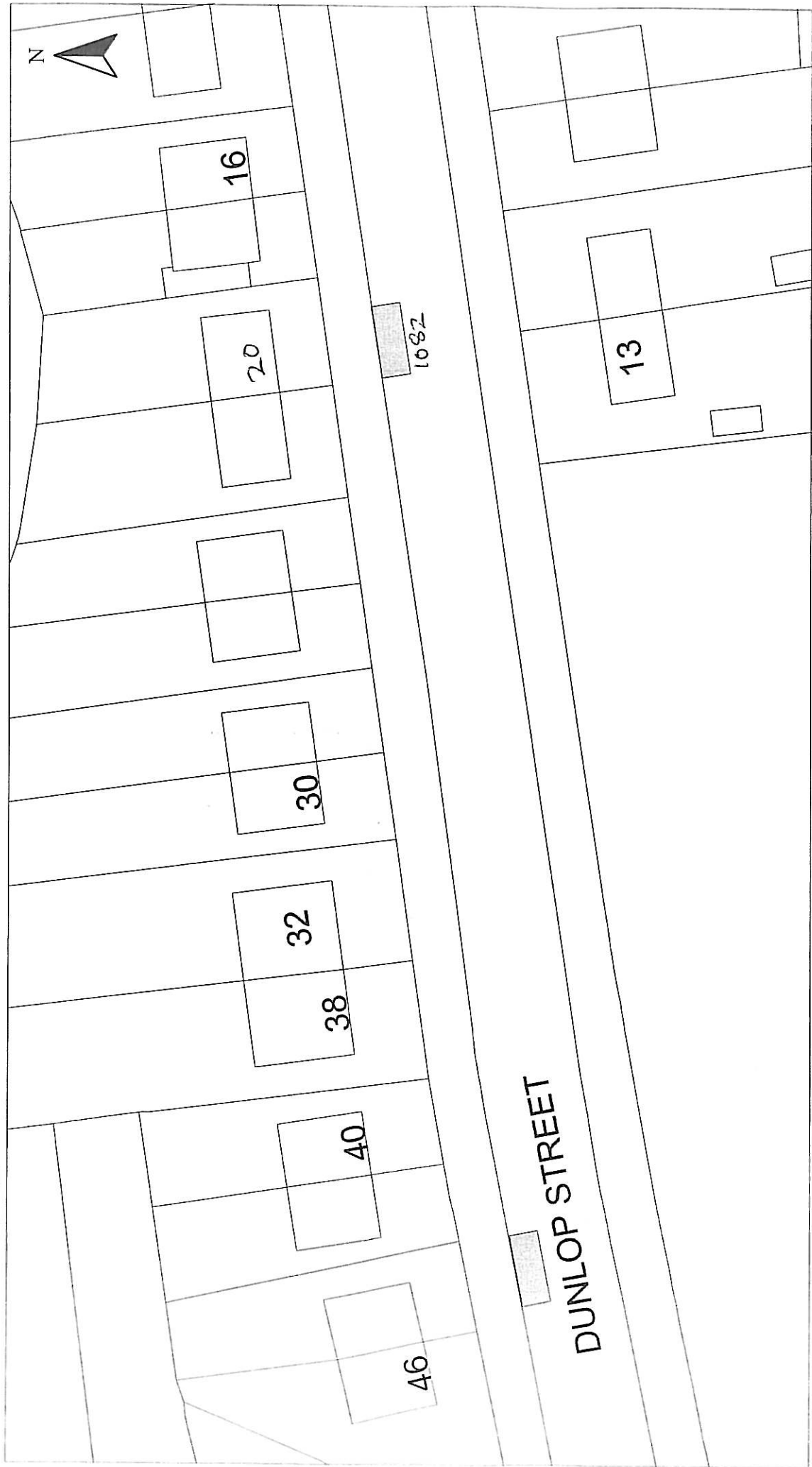

HEAD OF SERVICE IAN MOFFAT	Scale : 1:500 Prepared by : R. MACKAY Drawn by : R. MACKAY Drawing No. : 19/12	Date : APRIL 2013 Checked by : Approved by : File No. :
DISABLED PERSONS' PARKING PLACE 20 DUNLOP STREET, GREENOCK PLACE No. 1082 REVOCATION		
Disabled Bays	71 EAST HAMILTON STREET GREENOCK, PA15 2UA	

Reproduced from Ordnance Survey mapping with the permission  
 of the Controller of Her Majesty's Stationery Office. Crown  
 Copyright. Unauthorised reproduction infringes Crown Copyright  
 and may result in prosecution or legal proceedings.  
 Licence No. LA03097L  
