

Report To: ENVIRONMENT AND REGENERATION COMMITTEE **Date:** 5 SEPT 2013

Report By: CORPORATE DIRECTOR,
ENVIRONMENT, REGENERATION &
RESOURCES **Report No:** LA/1054/13

Contact Officer: JOANNA DALGLEISH **Contact No:** 01475 712123

Subject: PROPOSED TRAFFIC REGULATION ORDER – DISABLED PERSONS’ PARKING PLACES (ON STREET) ORDER NO. 2 2013

1.0 PURPOSE

1.1 Local Authorities are empowered to make Orders under the Road Traffic Regulation and Roads (Scotland) Acts 1984 and under the Council’s Scheme of Administration the Head of Environmental & Commercial Services is responsible for the making, implementation and review of Traffic Management Orders and Traffic Regulation Orders.

2.0 BACKGROUND

2.1 In order to comply with the Disabled Persons’ Parking Places (Scotland) Act 2009, Section 5, it is proposed to introduce a Traffic Regulation Order to accompany the provision of parking bays for the disabled. This will restrict parking to drivers displaying a Blue Badge only, and will enable the Police to enforce such restrictions.

2.2 The proposals have been advertised in the Greenock Telegraph and full details of the proposals have been made available for public inspection during normal office hours at the offices of the Head of Environmental & Commercial Services, the Head of Legal & Democratic Services and at Central, Port Glasgow, Gourock, South West and Inverkip & Wemyss Bay Libraries. A copy of the draft Order is appended hereto for Members’ information.

Appendix

2.3 No objections to the proposals have been received and, accordingly, the Committee is requested to approve the Order.

2.4 The Committee is asked to note that, if approved, the Order may not be implemented until the making of the Order has been advertised to allow any persons who so wish a period of six weeks to question the validity of the Order in terms of the Road Traffic Regulation Act 1984.

3.0 RECOMMENDATION

3.1 That the Committee recommend to The Inverclyde Council the making of the Traffic Regulation Order – Disabled Persons’ Parking Places (On Street) Order No 2. 2013 and remit it to the Head of Environmental & Commercial Services and Head of Legal & Democratic Services to arrange for its implementation.

Legal & Democratic Services

THE INVERCLYDE COUNCIL
DISABLED PERSONS' PARKING PLACES
(ON STREET) ORDER NO. 2 2013
TRAFFIC REGULATION ORDER

DRAFT

THE INVERCLYDE COUNCIL
DISABLED PERSONS' PARKING PLACES (ON STREET)
ORDER NO. 2 2013

The Inverclyde Council in exercise of the powers conferred on them by Sections 32(1) of the Road Traffic Regulation Act 1984 ("the Act") and of all other enabling powers and after consultation with the Chief Constable of Strathclyde Police in accordance with Part III of Schedule 9 to the Act hereby make the following Order.

1. This Order may be cited as "The Inverclyde Council Disabled Persons' Parking Places (On Street) Order No. 2 2013 and shall come into operation on ##
2. In this Order the following expressions have the meanings hereby assigned to them:
 - "vehicle" unless the context otherwise requires, means a vehicle of any description and includes a machine or implement of any kind drawn or propelled along roads whether or not by mechanical power;
 - "parking place" means a place where a vehicle, or vehicles of any class, may wait i.e. the area of land specified in the Schedule for which the use as a parking place has been authorised by the Council under Section 32(1) of the Act;
 - "sign" means a traffic sign;
 - "disabled person's badge" means:
 - (a) a badge issued under Section 21 of the Chronically Sick and Disabled Persons Act 1970;
 - (b) a badge issued under a provision of the law of Northern Ireland corresponding to that section; or
 - (c) a badge issued by any member State other than the United Kingdom for purposes corresponding to the purposes for which badges under that section are issued;
 - "disabled person's vehicle" means a vehicle lawfully displaying a disabled person's badge;
 - "Council" means The Inverclyde Council;
3. Each area of road which is described in the Schedule and plans relative to this Order is hereby designated as a parking place.
4. The parking places designated in this Order shall only be used for the leaving of disabled persons' vehicles displaying a valid disabled person's badge.

5. The limits of each parking place designated in this Order shall be indicated on the carriageway as prescribed by The Traffic Signs Regulations and General Directions 2002.
6. Every vehicle left in any parking place designated in this Order shall stand such that no parking place is occupied by more than one vehicle and that every part of the vehicle is within the limits of the parking place provided that, where the length of a vehicle precludes compliance with this paragraph, such vehicle shall be deemed to be within the limits of a parking place if;
 - i. the extreme front portion or, as the case may be, the extreme rear portion of the vehicle is within 300mm of an indication on the carriageway provided under this Order in relation to the parking place; and
 - ii. the vehicle, or any part thereof, is not within the limits of any adjoining parking place.
7. Any person duly authorised by the Council or a police officer in uniform or a traffic warden or parking attendant may move or cause to be moved in case of any emergency, to any place they think fit, vehicles left in a parking place.
8. Any person duly authorised by the Council may suspend the use of a parking place or any part thereof whenever such suspension is considered reasonably necessary:
 - i. for the purpose of facilitating the movement of traffic or promoting its safety;
 - ii. for the purpose of any building operation, demolition, or excavation in or adjacent to the parking place or the laying, erection, alteration, removal or repair in or adjacent to the parking place of any sewer or of any main, pipe, apparatus for the supply of gas, water electricity or of any telecommunications apparatus, traffic sign or parking meter;
 - iii. for the convenience of occupiers of premises adjacent to the parking place on any occasion of the removal of furniture from one office or dwellinghouse to another or the removal of furniture from such premises to a depository or to such premises from a depository;
 - iv. on any occasion on which it is likely by reason of some special attraction that any street will be thronged or obstructed; or
 - v. for the convenience of occupiers of premises adjacent to the parking place at times of weddings or funerals or on other special occasions.
9. A police officer in uniform may suspend for not longer than twenty four hours the use of a parking place or part thereof whenever such suspension is considered reasonably necessary for the purpose of facilitating the movement of traffic or promoting its safety.

10. This Order insofar as it relates to the parking places to be revoked (R) and amended, as specified in the Schedule to this Order, partially revokes and amends the On-Street Parking Places (Without Charges) Order No.1 2006 and the Disabled Persons' Parking Places (On Street) Order Nos. 1, 2, 3 and 4 2011 and No. 1 2012 respectively.

Sealed with the Common Seal of The Inverclyde Council and subscribed for them and on their behalf by ##

DRAFT

INVERCLYDE COUNCIL

**DISABLED PERSONS' PARKING PLACES (ON STREET)
ORDER NO. 2 2013**

**Statement of Reasons for Proposing to Make
the Above Order**

It is considered necessary to make the above Order to provide assistance for disabled persons who hold a badge under the Disabled Persons (Badges for Motor Vehicles) (Scotland) Regulations 2000 as amended and by revoking those parking places no longer required to maximise street parking capacity.

DRAFT

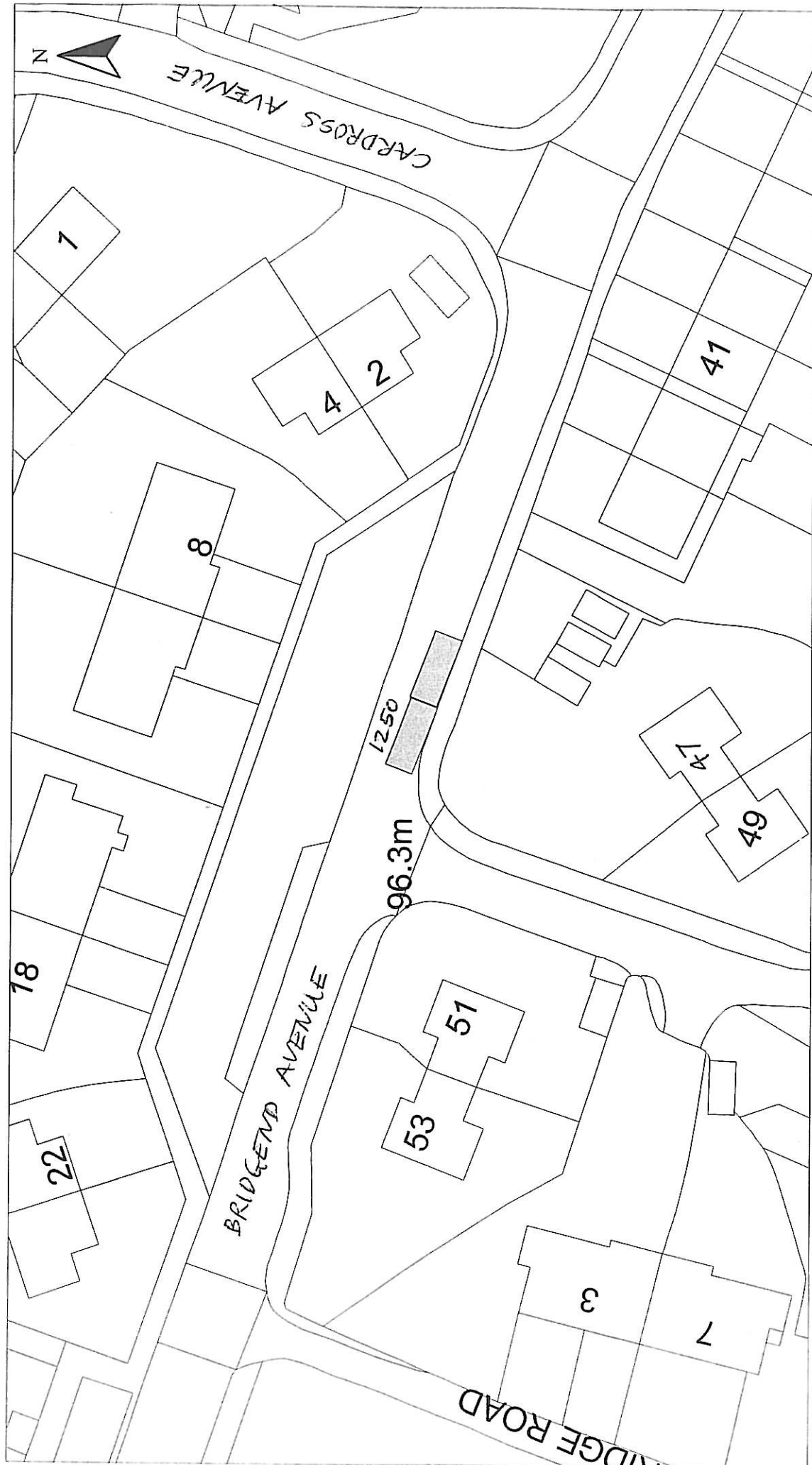

HEAD OF SERVICE
IAN MOFFAT

Disabled Bays
71 EAST HAMILTON STREET
GREENOCK, PA15 2UA

Reproduced from Ordnance Survey mapping with the permission of the Controller of Her Majesty's Stationery Office. Crown Copyright. Unauthorised reproduction infringes Crown Copyright and may result in prosecution or legal proceedings.
Licence No. LA03097L
Ordnance Survey

DISABLED PERSONS' PARKING PLACE
47 BRIDGEND AVENUE, PORT GLASGOW
PLACE No. 1250

Scale :	1:500	Date :	JAN 2013
Prepared by :	R. MACKAY	Checked by :	
Drawn by :	R. MACKAY	Approved by :	
Drawing No. :		File No. :	19/12

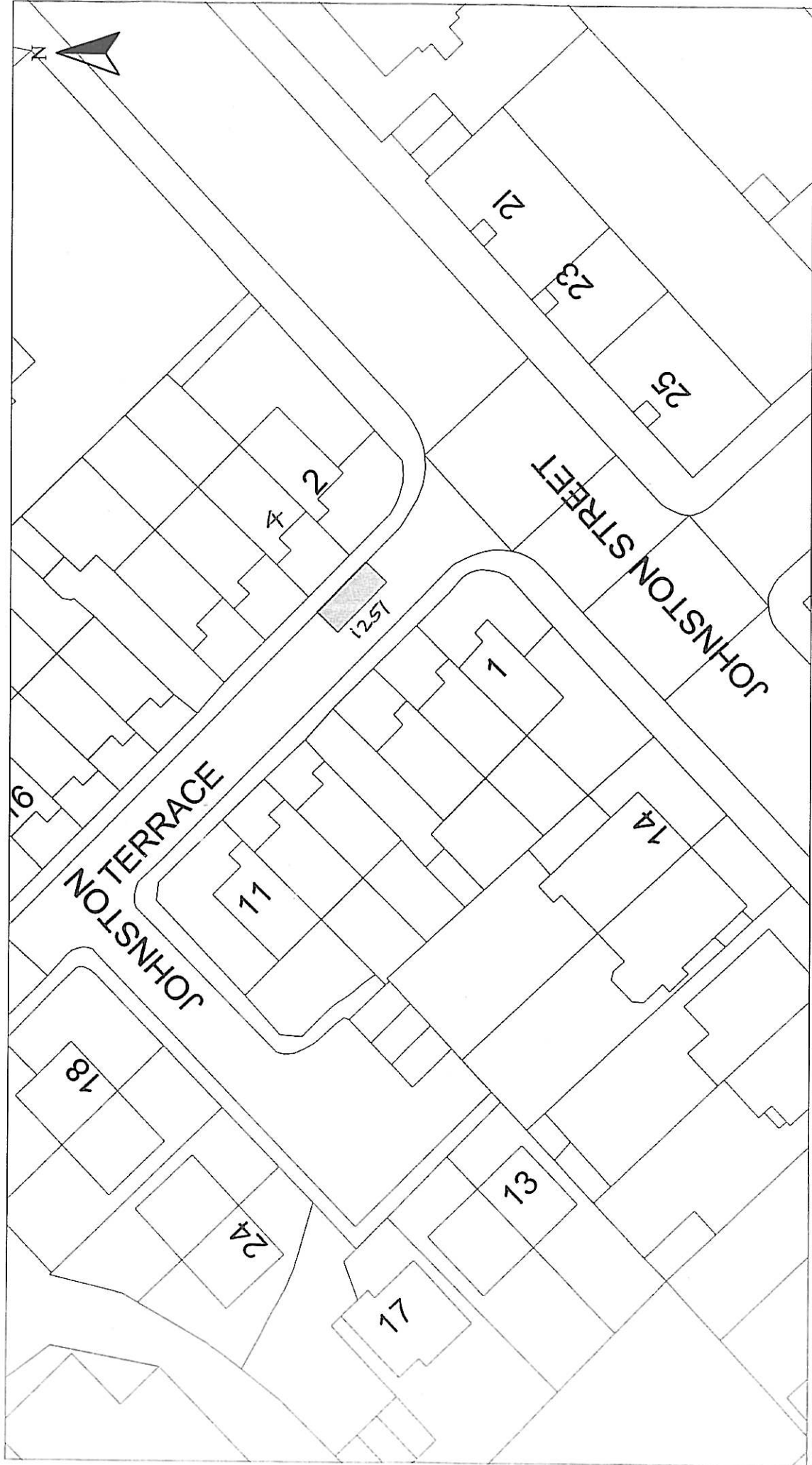

<p>HEAD OF SERVICE IAN MOFFAT</p>	<p>Scale : 1:500</p>	<p>Date : JAN 2013</p>
<p>Disabled Bays</p>	<p>Prepared by : R. MACKAY</p>	<p>Checked by :</p>
<p>71 EAST HAMILTON STREET GREENOCK, PA15 2UA</p>	<p>Drawn by : R. MACKAY</p>	<p>Approved by :</p>
<p>DISABLED PERSONS' PARKING PLACE 4 JOHNSTON STREET, GREENOCK PLACE No. 1251</p>	<p>Drawing No. :</p>	<p>File No. : 19/12</p>

Reproduced from Ordnance Survey mapping with the permission of the Controller of Her Majesty's Stationery Office. Crown Copyright. Unauthorised reproduction infringes Crown Copyright and may result in prosecution or legal proceedings.

Licence No. LA03097L



Ordnance Survey

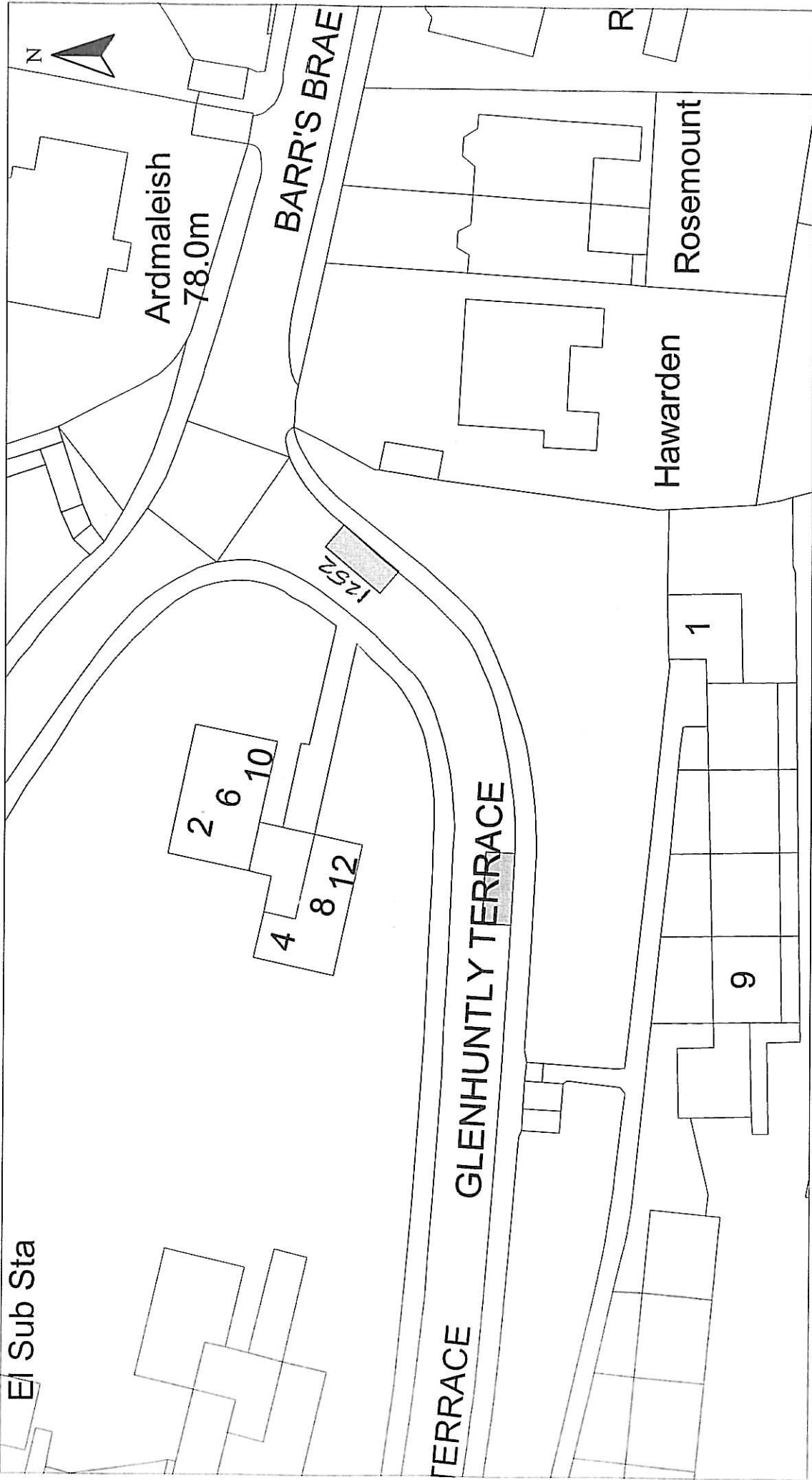

EI Sub Sta

Ardmaleish
78.0m

BARR'S BRAE

TERRACE GLENHUNTLY TERRACE

Hawarden

Rosemount

HEAD OF SERVICE
IAN MOFFAT

71 EAST HAMILTON STREET
GREENOCK, PA15 2UA

Reproduced from Ordnance Survey mapping with the permission
of the Controller of Her Majesty's Stationery Office. Crown
Copyright. Unauthorised reproduction infringes Crown Copyright
and may result in prosecution or legal proceedings.

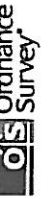

Licence No. LA03097L

DISABLED PERSONS' PARKING PLACE

6 GLENHUNTLY TERR, PORT GLASGOW
PLACE No. 1252

Scale : 1:500

Prepared by : R. MACKAY

Drawn by : R. MACKAY

Approved by :

Date : JAN 2013

Checked by :

Approved by :

File No. : 19/12

Disabled Bays



HEAD OF SERVICE
IAN MOFFAT

Disabled Bays
71 EAST HAMILTON STREET
GREENOCK, PA15 2UA

Reproduced from Ordnance Survey mapping with the permission
of the Controller of Her Majesty's Stationery Office. Crown
Copyright. All rights reserved. Ordnance Survey
and may result in prosecution or legal proceedings.
Licence No. LA03097L
OS Ordnance
Survey

DISABLED PERSONS' PARKING PLACE
4 CASTLEHILL AVENUE, PORT GLASGOW
PLACE No. 1253

Scale : 1:500
Prepared by : R. MACKAY
Drawn by : R. MACKAY
Date : JAN 2013
Checked by :
Approved by :
File No. : 19/12

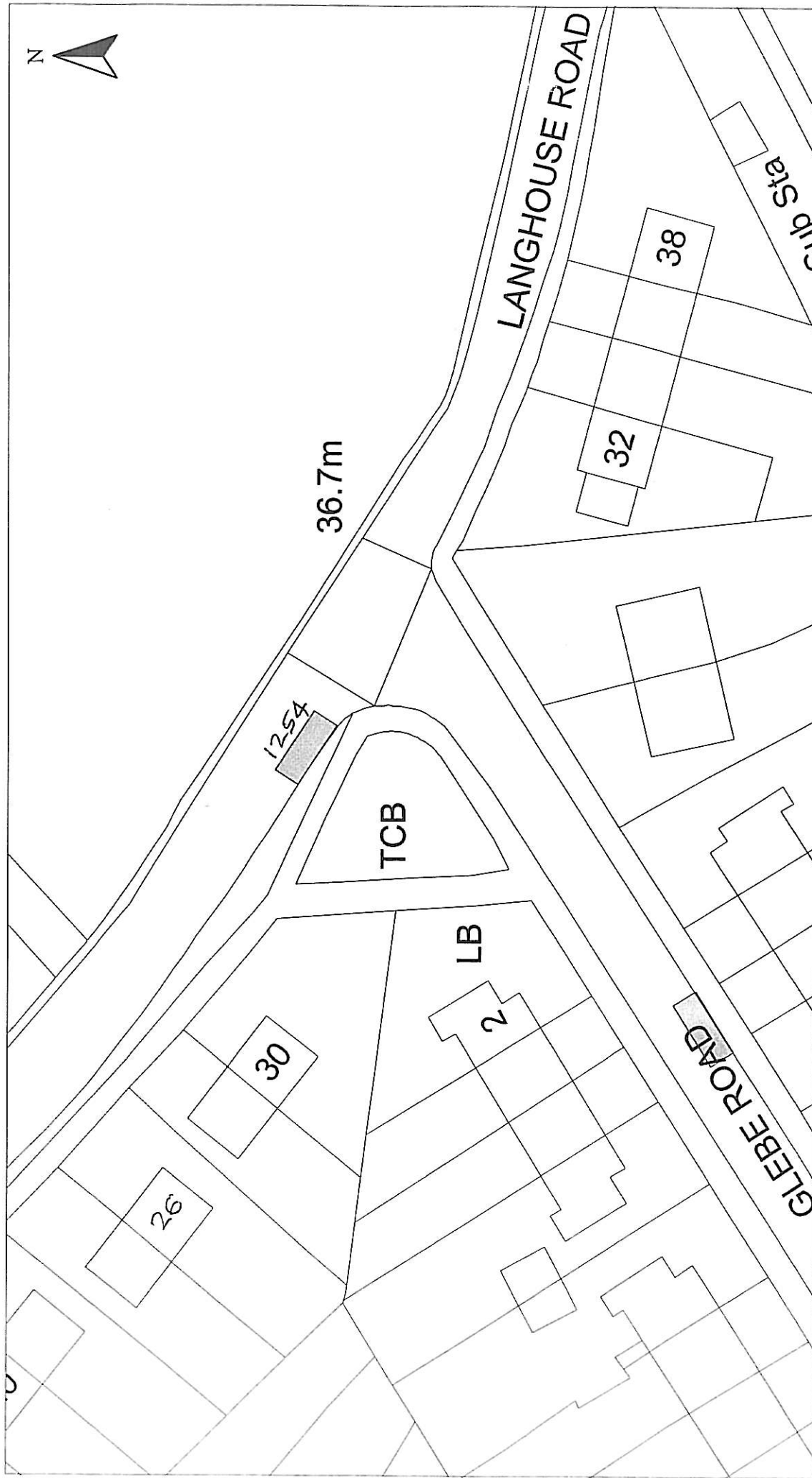

Disabled Bays	HEAD OF SERVICE IAN MOFFAT	Reproduced from Ordnance Survey mapping with the permission of the Controller of Her Majesty's Stationery Office. Crown Copyright. Unauthorised reproduction infringes Crown Copyright and may result in prosecution or legal proceedings. Ordnance Survey Licence No. LA03097L	DISABLED PERSONS' PARKING PLACE 26 LANGHOUSE ROAD, INVERKIP PLACE No. 1254	Scale : 1:500	Date : JAN 2013
	71 EAST HAMILTON STREET GREENOCK, PA15 2UA			Prepared by : R. MACKAY	Checked by :
				Drawing No. :	File No. : 19/12

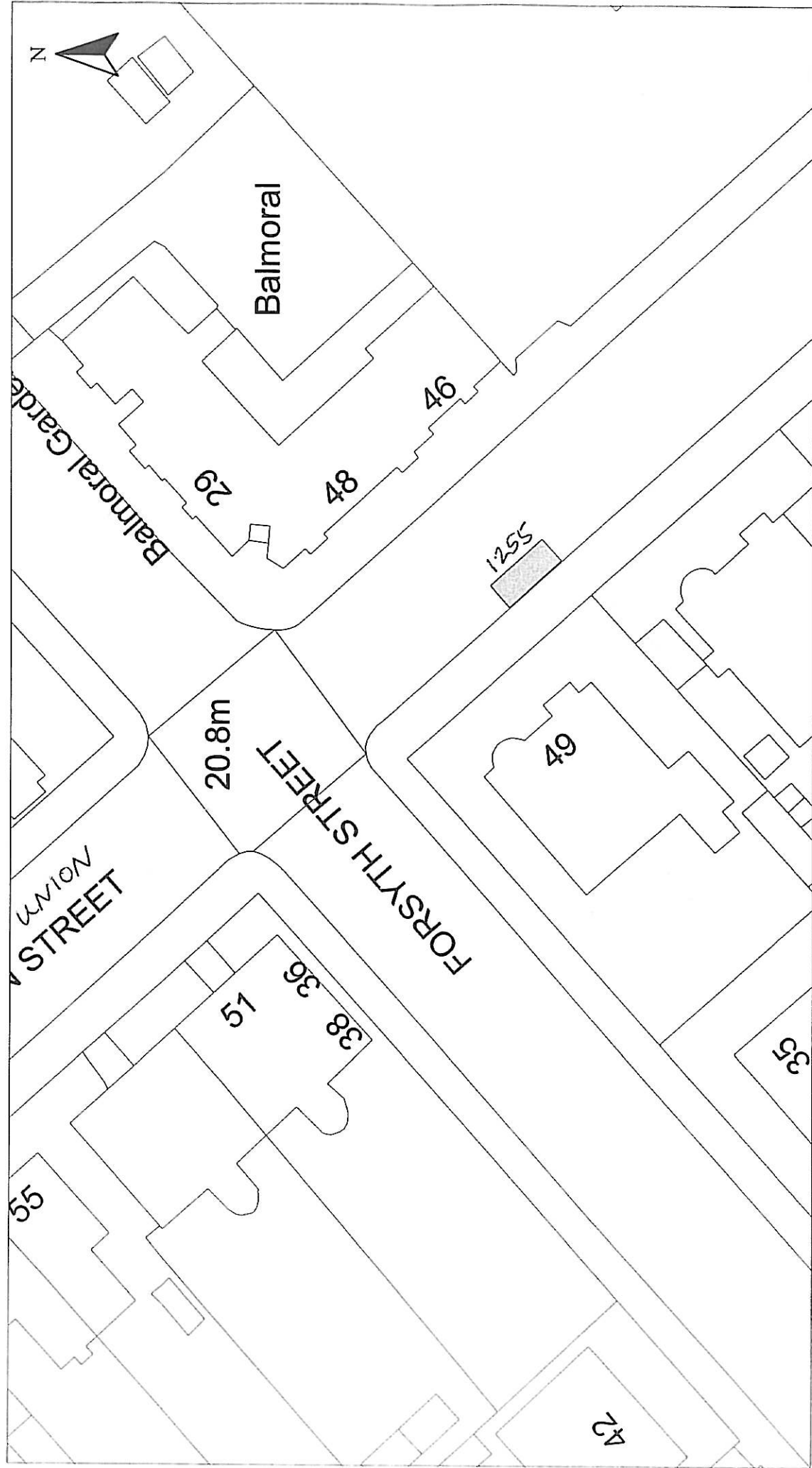

HEAD OF SERVICE
IAN MOFFAT

Disabled Bays
71 EAST HAMILTON STREET
GREENOCK, PA15 2UA

Reproduced from Ordnance Survey mapping with the permission of the Controller of Her Majesty's Stationery Office. Crown Copyright. Unauthorised reproduction infringes Crown Copyright and may result in prosecution or legal proceedings.

Licence No. LA03097L



DISABLED PERSONS' PARKING PLACE

49 UNION STREET, GREENOCK
PLACE No. 1255

Scale : 1:500

Prepared by : R. MACKAY

Drawn by : R. MACKAY

Checked by :
Approved by :
File No. : 19/12

Date : JAN 2013



HEAD OF SERVICE
IAN MOFFAT

71 EAST HAMILTON STREET
GREENOCK, PA15 2UA

Disabled Bays

Reproduced from Ordnance Survey mapping with the permission of the Controller of Her Majesty's Stationery Office. Crown Copyright. Unauthorised reproduction infringes Crown Copyright and may result in prosecution or legal proceedings.



Licence No. LA003097L

DISABLED PERSONS' PARKING PLACE

NORFOLK ROAD, GREENOCK
PLACE No. 1256

Scale : 1:500

Prepared by : R. MACKAY

Checked by :

Drawn by : R. MACKAY

Approved by :

Date : JAN 2013

Checked by :

Approved by :

File No. : 19/12

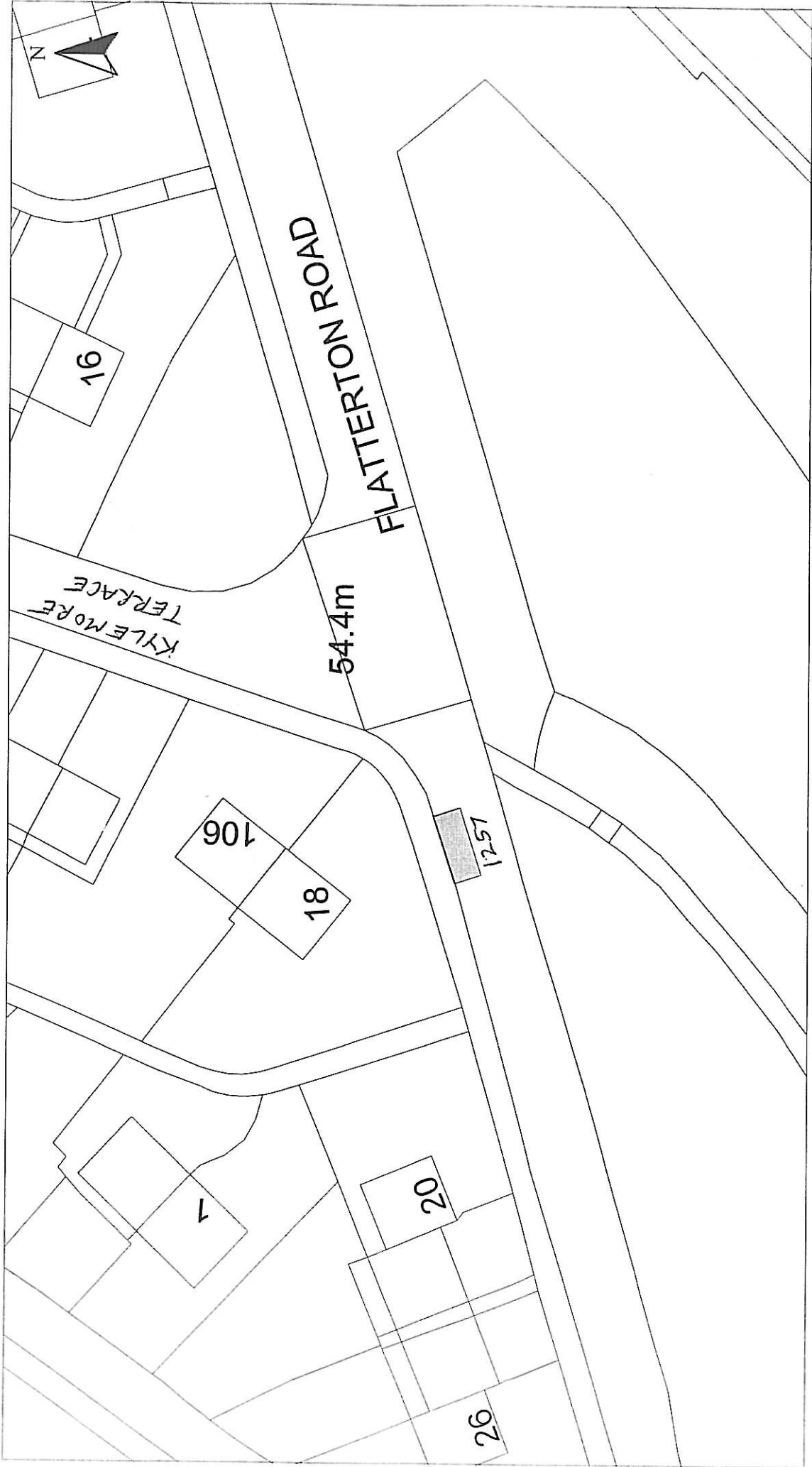

HEAD OF SERVICE
IAN MOFFAT

71 EAST HAMILTON STREET
GREENOCK, PA15 2JA

Disabled Bays

Reproduced from Ordnance Survey mapping with the permission of the Controller Her Majesty's Stationery Office. Copyright. Unauthorised reproduction infringes Crown Copyright and may result in prosecution or legal proceedings.

Licence No. LA03097L

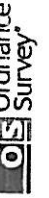

DISABLED PERSONS' PARKING PLACE
18 FLATTERTON ROAD, GREENOCK
PLACE No. 1257

Scale : 1:500

Prepared by : R. MACKAY

Drawn by : R. MACKAY

Drawing No. : 19/12

Date : .JAN 2013

Checked by :

Approved by :

File No. : 19/12

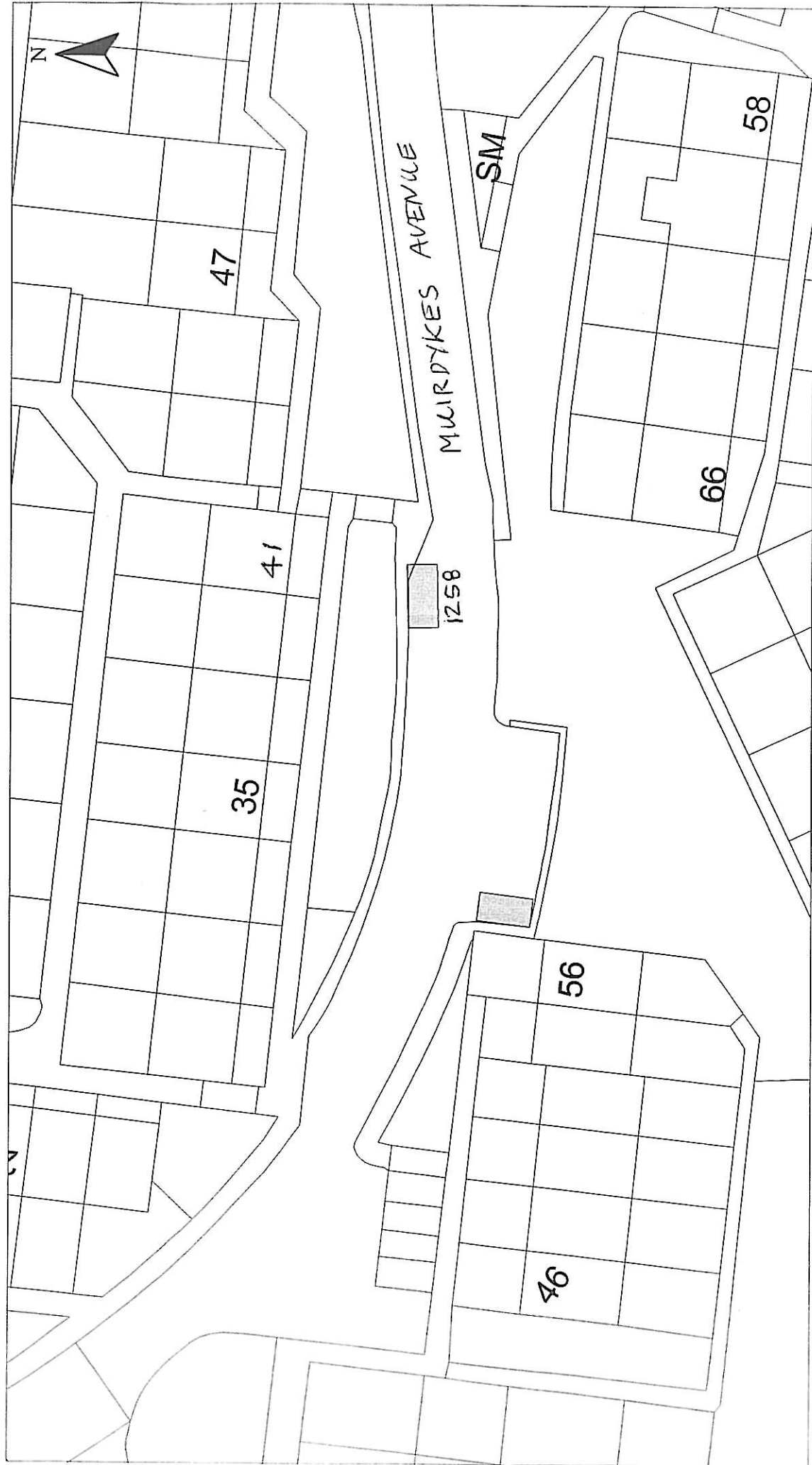

HEAD OF SERVICE
IAN MOFFAT

71 EAST HAMILTON STREET
GREENOCK, PA15 2UA

Reproduced from Ordnance Survey mapping with the permission of the Controller of Her Majesty's Stationary Office. Crown Copyright. Unauthorised reproduction infringes Crown Copyright and may result in prosecution or legal proceedings.



Licence No. LA00097L

DISABLED PERSONS' PARKING PLACE
41 MUIRDYKES AVENUE, PORT GLASGOW
PLACE No. 1258

Scale : 1:500

Prepared by : R. MACKAY

Drawn by : R. MACKAY

Drawing No. :

Date : JAN 2013

Checked by :

Approved by :

File No. : 19/12

Disabled Bays



HEAD OF SERVICE
IAN MOFFAT

71 EAST HAMILTON STREET
GREENOCK, PA15 2UA

Disabled Bays

Reproduced from Ordnance Survey mapping with the permission of the Controller of Her Majesty's Stationery Office. Crown Copyright. Unauthorised reproduction infringes Crown Copyright and may result in prosecution or legal proceedings.

Ordnance Survey
Licence No. LA03097L

DISABLED PERSONS' PARKING PLACE

**72 DAVAAR ROAD, GREENOCK
PLACE No. 1259**

Scale : 1:500

Prepared by : R. MACKAY

Drawn by : R. MACKAY

Drawing No. : 19/12

Date : JAN 2013

Checked by :

Approved by :

File No. :

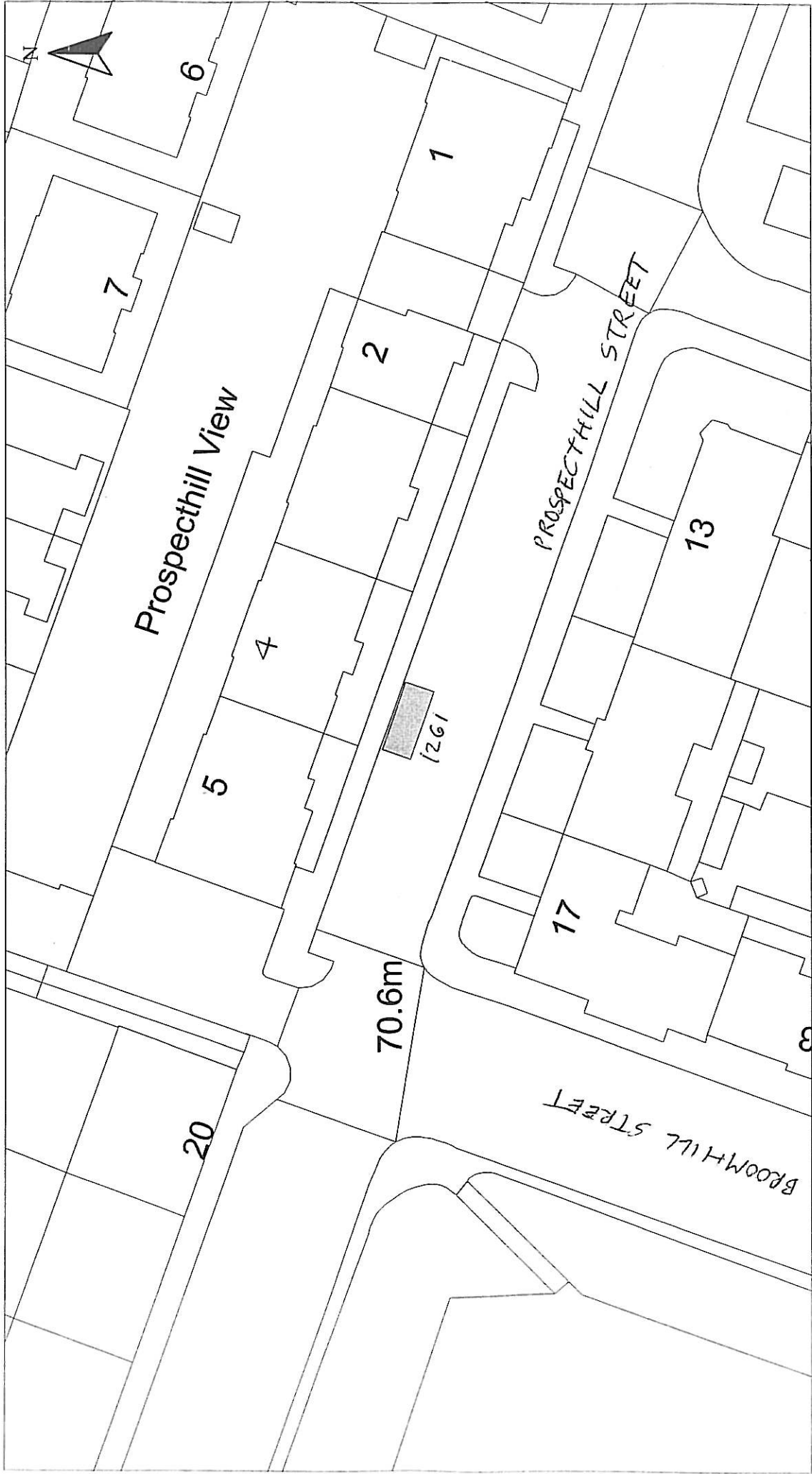

Disabled Bays	HEAD OF SERVICE IAN MOFFAT	Reproduced from Ordnance Survey mapping with the permission of the Controller of Her Majesty's Stationery Office. Crown Copyright. Unauthorised reproduction infringes Crown Copyright and may result in prosecution or legal proceedings.  Ordnance Survey Licence No. LA03097L	DISABLED PERSONS' PARKING PLACE 4 PROSPECTHILL STREET, GREENOCK PLACE No. 1261	Scale : 1:500 Prepared by : R. MACKAY Drawn by : R. MACKAY Drawing No. :	Date : JAN 2013 Checked by : Approved by : File No. : 19/12
71 EAST HAMILTON STREET GREENOCK, PA15 2JA					

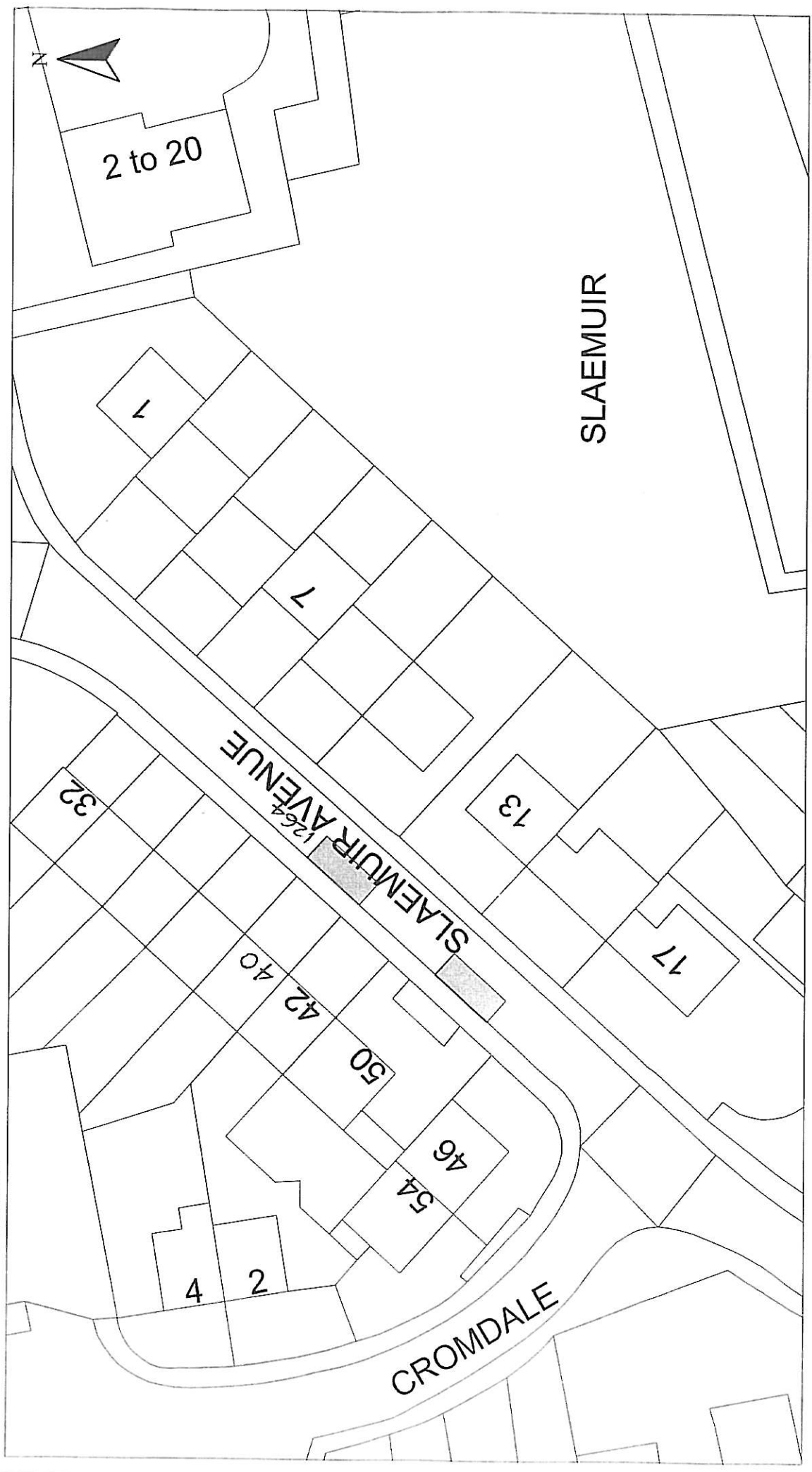

Disabled Bays 71 EAST HAMILTON STREET GREENOCK, PA15 2UA	HEAD OF SERVICE IAN MOFFAT		Reproduced from Ordnance Survey mapping with the permission of the Controller of Her Majesty's Stationery Office. Crown Copyright. Unauthorised reproduction infringes Crown Copyright and may result in prosecution or legal proceedings. Licence No. LA03097L 		DISABLED PERSONS' PARKING PLACE 40 SLAEMUIR AVENUE, PORT GLASGOW PLACE No. 1264		Scale : 1:500	Date : JAN 2013
	Prepared by : R. MACKAY		Checked by :		Approved by :		File No. : 19/12	
Drawn by : R. MACKAY		Drawing No. :		Date :		Checked by :		

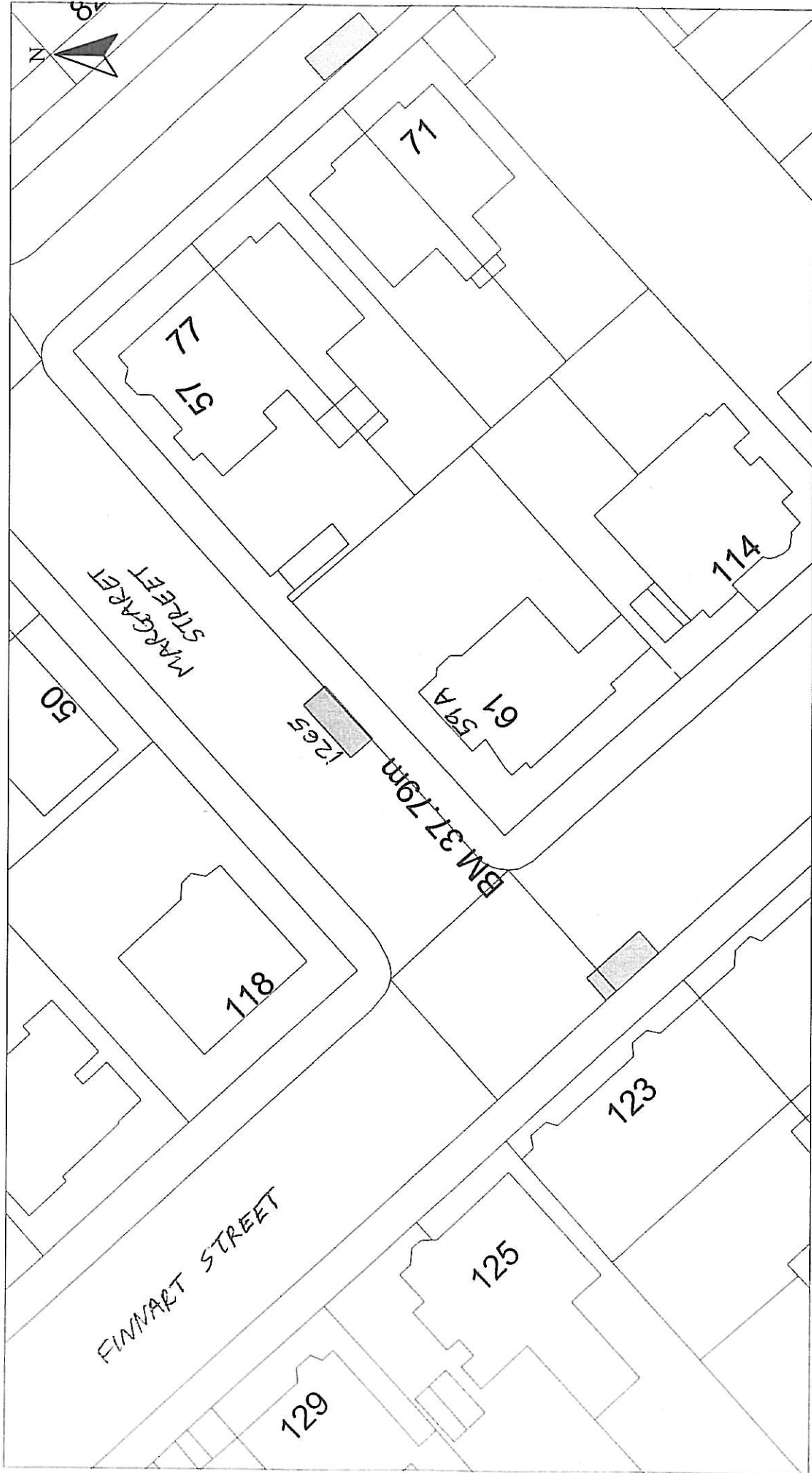

HEAD OF SERVICE
IAN MOFFAT

Disabled Bays
71 EAST HAMILTON STREET
GREENOCK, PA15 2UA

Reproduced from Ordnance Survey mapping with the permission of the Controller of Her Majesty's Stationery Office. Crown Copyright. Unauthorised reproduction infringes Crown Copyright and may result in prosecution or legal proceedings.

 Licence No. LA03097L

DISABLED PERSONS' PARKING PLACE
59A MARGARET STREET, GREENOCK
PLACE No. 1265

Scale : 1:500
 Date : JAN 2013
 Prepared by : R. MACKAY
 Checked by :
 Drawn by : R. MACKAY
 Approved by :
 Drawing No. : 19/12



HEAD OF SERVICE
IAN MOFFAT

71 EAST HAMILTON STREET
GREENOCK, PA15 2UA

Reproduced from Ordnance Survey mapping with the permission of the Controller of Her Majesty's Stationary Office. Crown Copyright. Unauthorised reproduction infringes Crown Copyright and may result in prosecution or legal proceedings.

Ordnance Survey
Licence No. LA03097L

DISABLED PERSONS' PARKING PLACE
21 GLENSIDE ROAD, PORT GLASGOW
PLACE No. 1266

Scale :	1:500	Date :	FEB 2013
Prepared by :	R. MACKAY	Checked by :	
Drawn by :	R. MACKAY	Approved by :	
Drawing No. :		File No. :	19/12

Disabled Bays

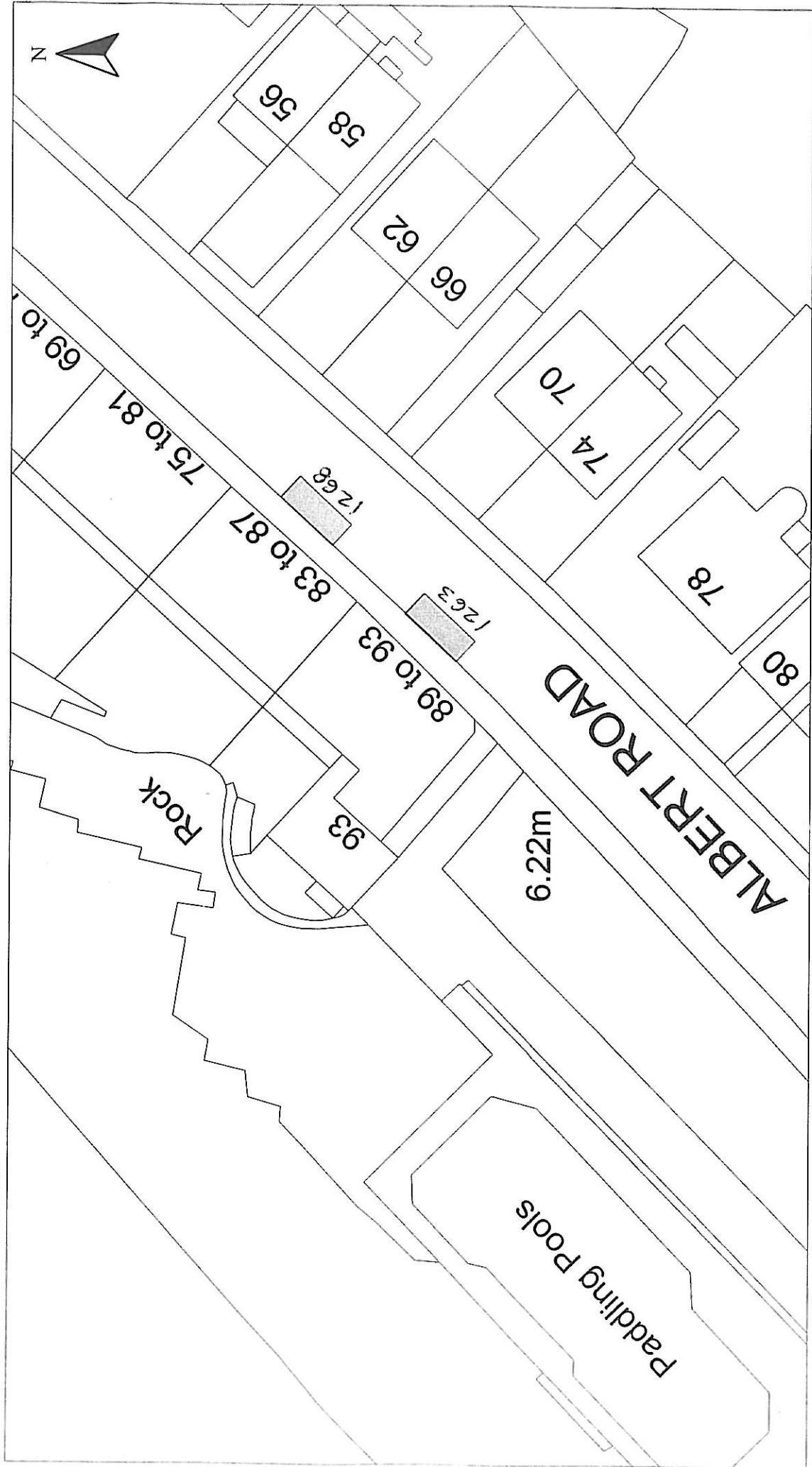

Disabled Bays HEAD OF SERVICE IAN MOFFAT 71 EAST HAMILTON STREET GREENOCK, PA15 2UA	Disabled Persons' Parking Place 85 & 91 ALBERT ROAD, GOUROCK PLACES Nos. 1263 & 1268		Scale : 1:500 Prepared by : R. MACKAY Drawn by : R. MACKAY Drawing No. :	Date : JAN 2013 Checked by : Approved by : File No. : 19/12
	Reproduced from Ordnance Survey mapping with the permission of the Controller of Her Majesty's Stationery Office. Crown Copyright. Users may not reproduce or transmit this information and may result in prosecution or legal proceedings.		Licence No. LA03097L 	

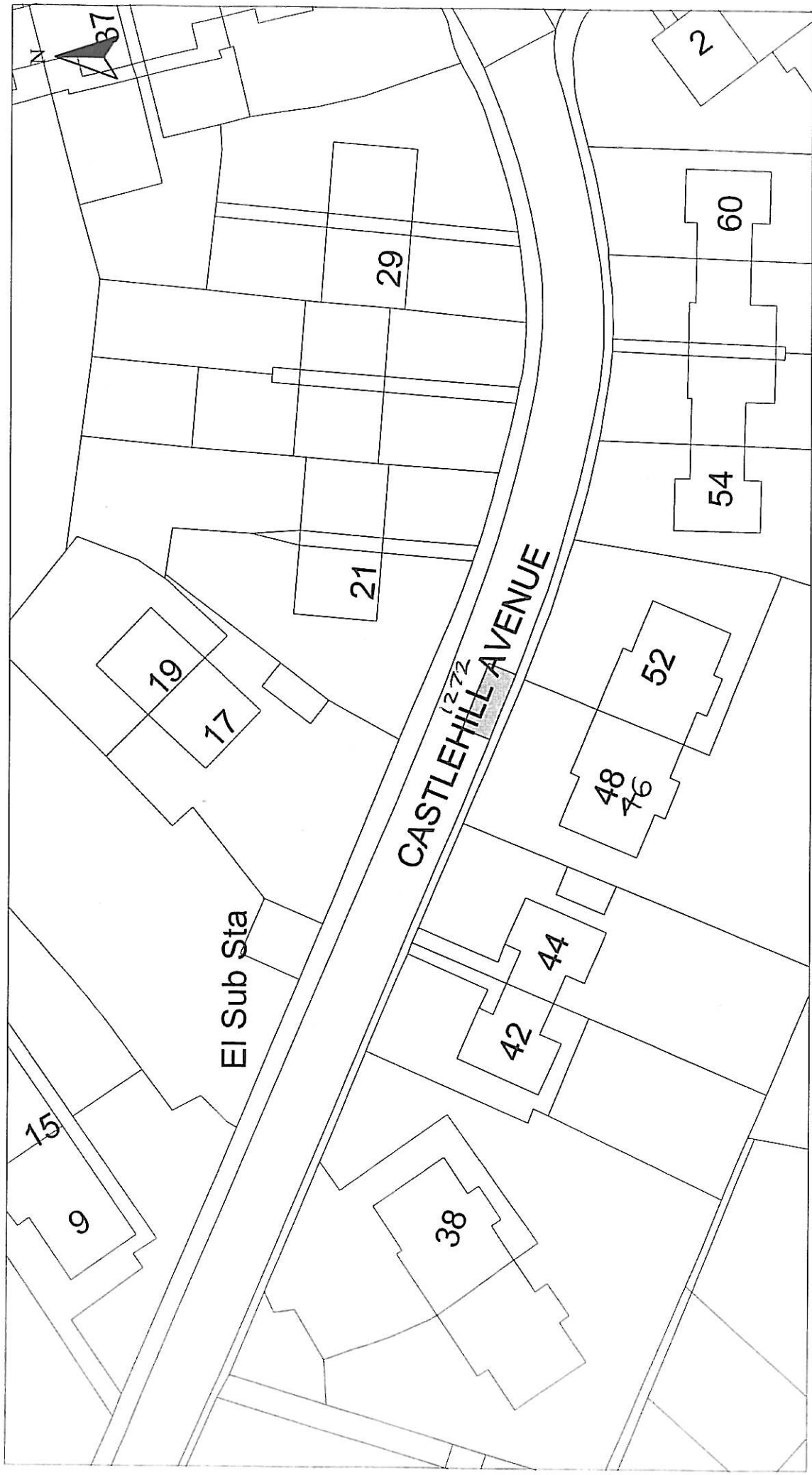

HEAD OF SERVICE
IAN MOFFAT

71 EAST HAMILTON STREET
GREENOCK, PA15 2UA

Disabled Bays

Reproduced from Ordnance Survey mapping with the permission of the Controller of Her Majesty's Stationery Office. Crown Copyright. Unauthorised reproduction infringes Crown Copyright and may result in prosecution or legal proceedings.



Licence No. LA03097L

DISABLED PERSONS' PARKING PLACE

46 CASTLEHILL AVENUE, PORT GLASGOW
PLACE No. 1272

Scale : 1:500

Prepared by : R. MACKAY

Drawn by : R. MACKAY

Drawing No. :

Date : JAN 2013

Checked by :

Approved by :

File No. : 19/12

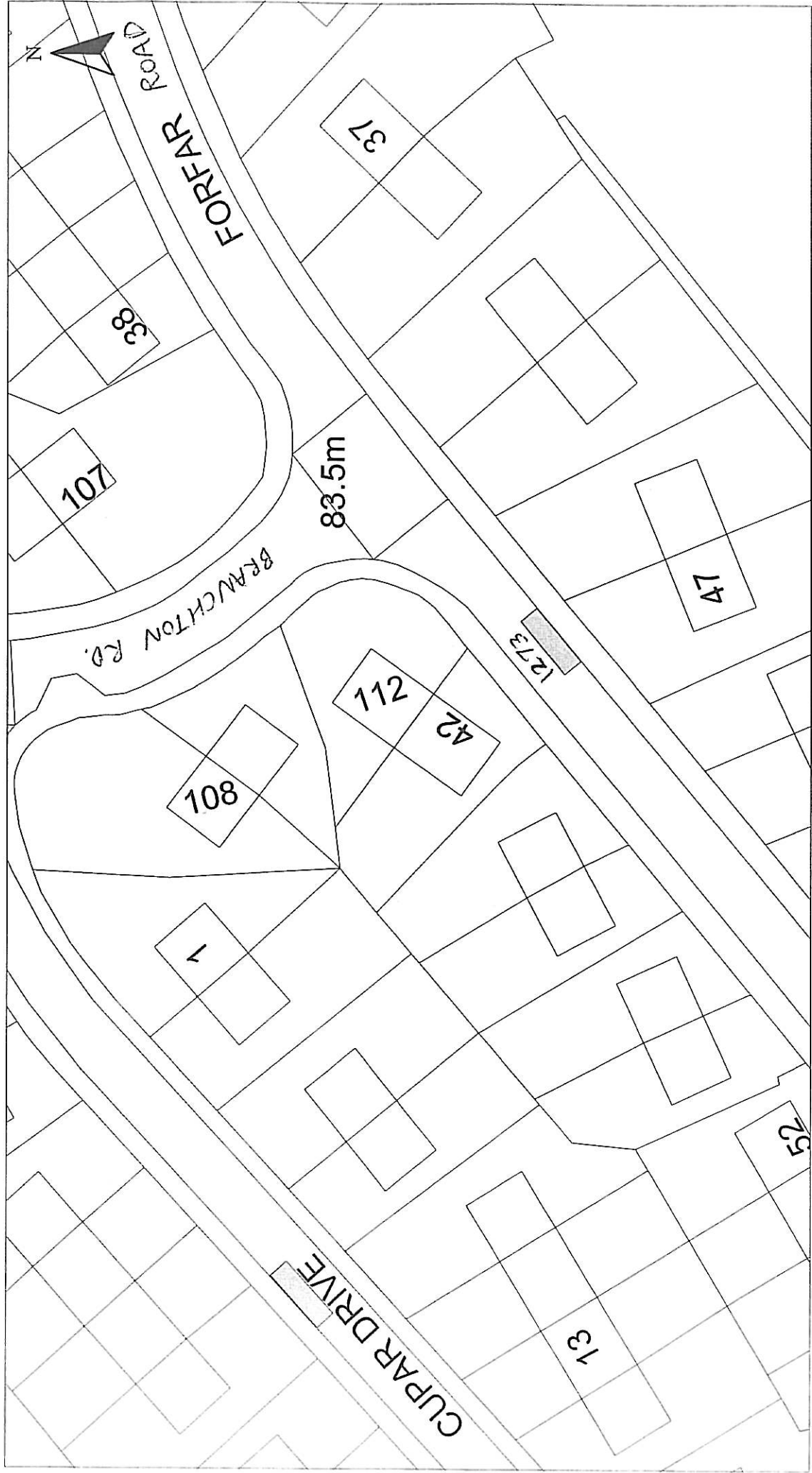

HEAD OF SERVICE
IAN MOFFAT

Disabled Bays
71 EAST HAMILTON STREET
GREENOCK, PA15 2UA

Reproduced from Ordnance Survey mapping with the permission of the Controller of Her Majesty's Stationery Office. Crown Copyright. Unauthorised reproduction infringes Crown Copyright and may result in prosecution or legal proceedings.

OS Ordnance Survey
Licence No. LA03097L

DISABLED PERSONS' PARKING PLACE
47 FORFAR ROAD, GREENOCK
PLACE No. 1273

Scale : 1:500

Prepared by : R. MACKAY

Drawn by : R. MACKAY

Drawing No. : 19/12

Date : JAN 2013

Checked by :

Approved by :

File No. :

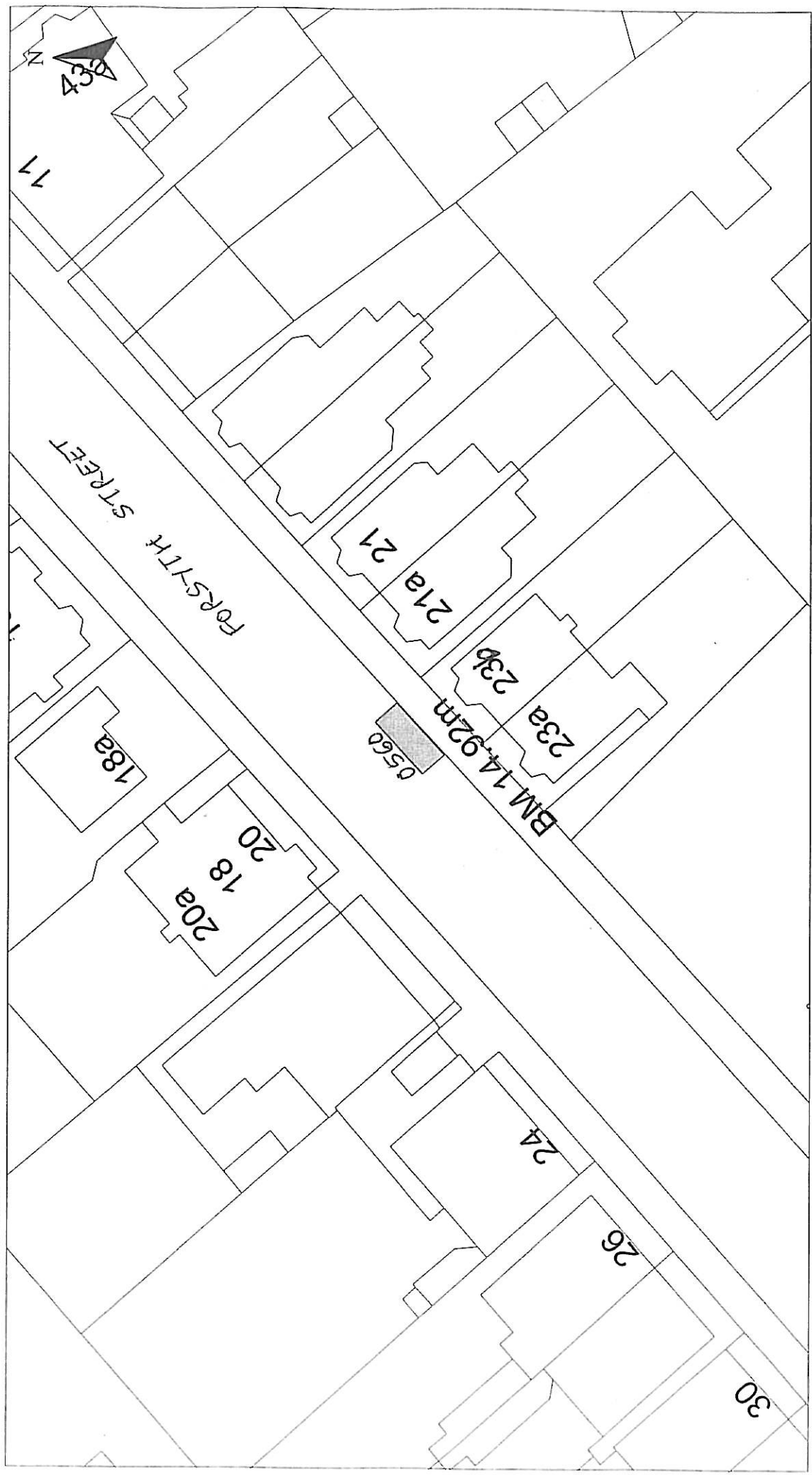

<p>Reproduced from Ordnance Survey mapping with the permission of the Controller of Her Majesty's Stationery Office. Crown Copyright. Unauthorised reproduction infringes Crown Copyright and may result in prosecution or legal proceedings.</p> <p>Licence No. LA03097L</p> 		<p>DISABLED PERSONS' PARKING PLACE 23B FORSYTH STREET, GREENOCK PLACE No. 0560 REVOCATION</p>		<p>Scale : 1:500</p>	<p>Date : JAN 2013</p>
<p>HEAD OF SERVICE IAN MOFFAT</p>		<p>Prepared by : R. MACKAY</p>		<p>Checked by :</p>	
<p>71 EAST HAMILTON STREET GREENOCK, PA15 2UA</p>		<p>Drawn by : R. MACKAY</p>		<p>Approved by :</p>	
<p>Disabled Bays</p>	<p>Drawing No. : 19/12</p>				

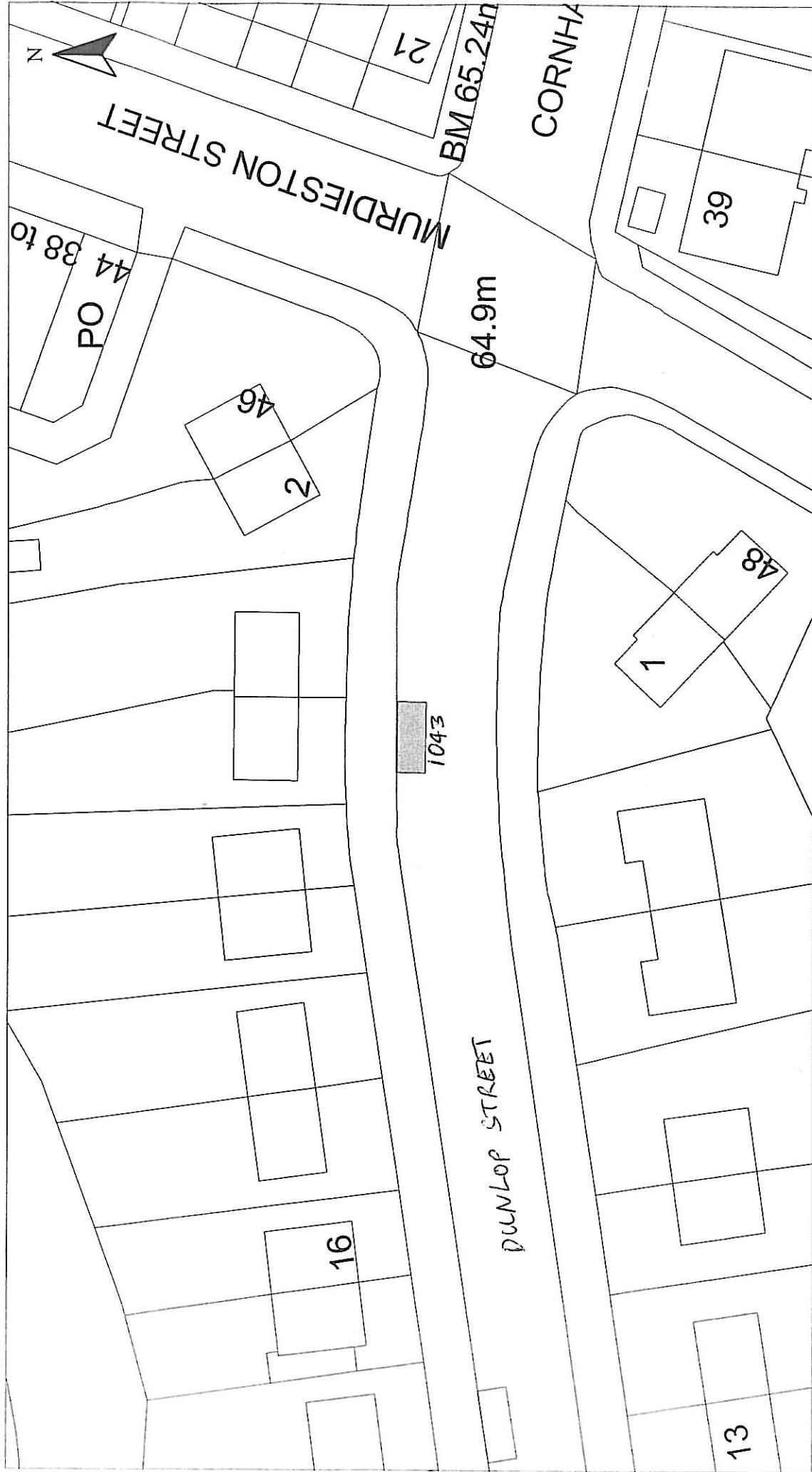

HEAD OF SERVICE
IAN MOFFAT

Disabled Bays

71 EAST HAMILTON STREET
GREENOCK, PA15 2UA

Reproduced from Ordnance Survey mapping with the permission of the Controller of Her Majesty's Stationery Office. Crown Copyright. Unauthorised reproduction infringes Crown Copyright and may result in prosecution or legal proceedings.

Licence No. LA03087L



DISABLED PERSONS' PARKING PLACE
2 DUNLOP STREET, GREENOCK
PLACE No. 1043 REVOCATION

Scale : 1:500

Prepared by : R. MACKAY

Drawn by : R. MACKAY

Approved by :

Date : FEB 2013

Checked by :

Approved by :

File No. : 19/12

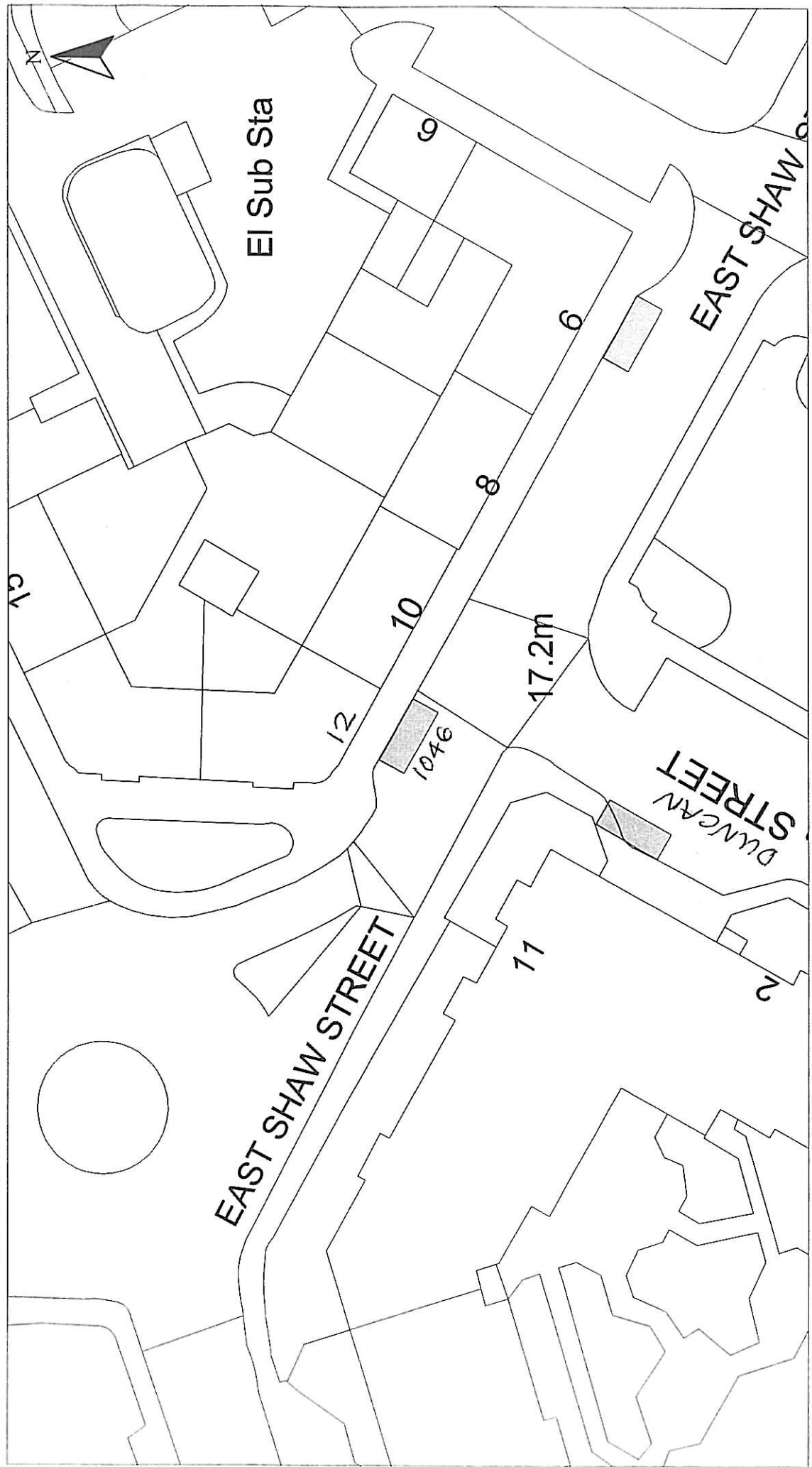

Disabled Bays	HEAD OF SERVICE IAN MOFFAT	Reproduced from Ordnance Survey mapping with the permission of the Controller of Her Majesty's Stationery Office. Crown Copyright. Unauthorised reproduction infringes Crown Copyright and may result in prosecution or legal proceedings. Licence No. LA03097L  Ordnance Survey	Scale : 1:500	Date : JAN 2013
	71 EAST HAMILTON STREET GREENOCK, PA15 2UA		DISABLED PERSONS' PARKING PLACE 12 EAST SHAW STREET, GREENOCK PLACE No. 1046 REVOCATION	Prepared by : R. MACKAY
			Drawn by : R. MACKAY	Approved by :
			Drawing No. :	File No. : 19/12

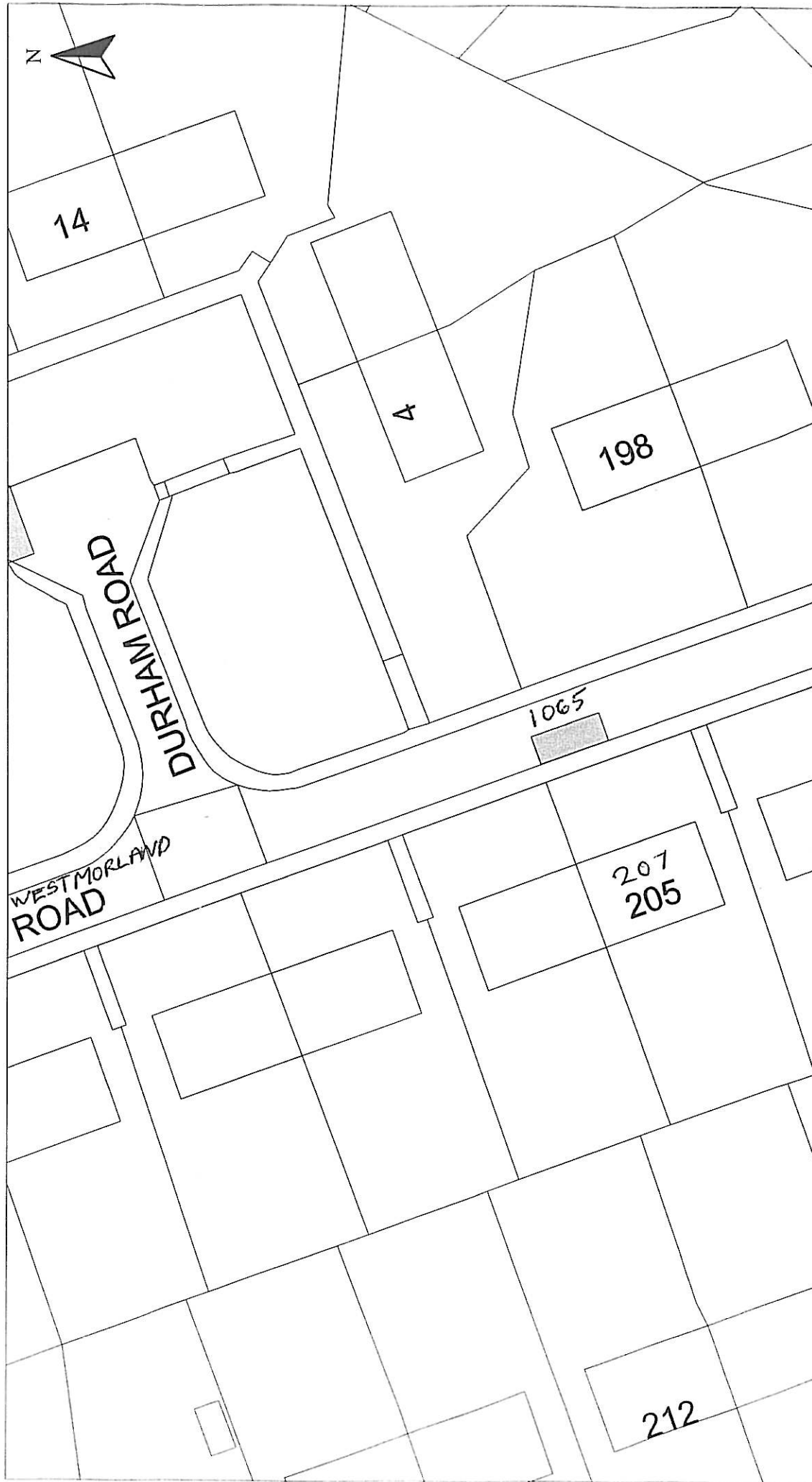

HEAD OF SERVICE IAN MOFFAT		Scale : 1:500		Date : JAN 2013	
Disabled Bays		Prepared by : R. MACKAY		Checked by :	
71 EAST HAMILTON STREET GREENOCK, PA15 2JA		Drawn by : R. MACKAY		Approved by :	
		Drawing No. :		File No. : 19/12	
Disabled Persons' Parking Place 207 Westmorland Road, Greenock PLACE No. 1065 REVOCATION			Reproduced from Ordnance Survey mapping with the permission of the Controller of Her Majesty's Stationery Office, Crown Copyright. Unauthorised reproduction infringes Crown Copyright and may result in prosecution or legal proceedings.		
			Licence No. LA03097L  Ordnance Survey		

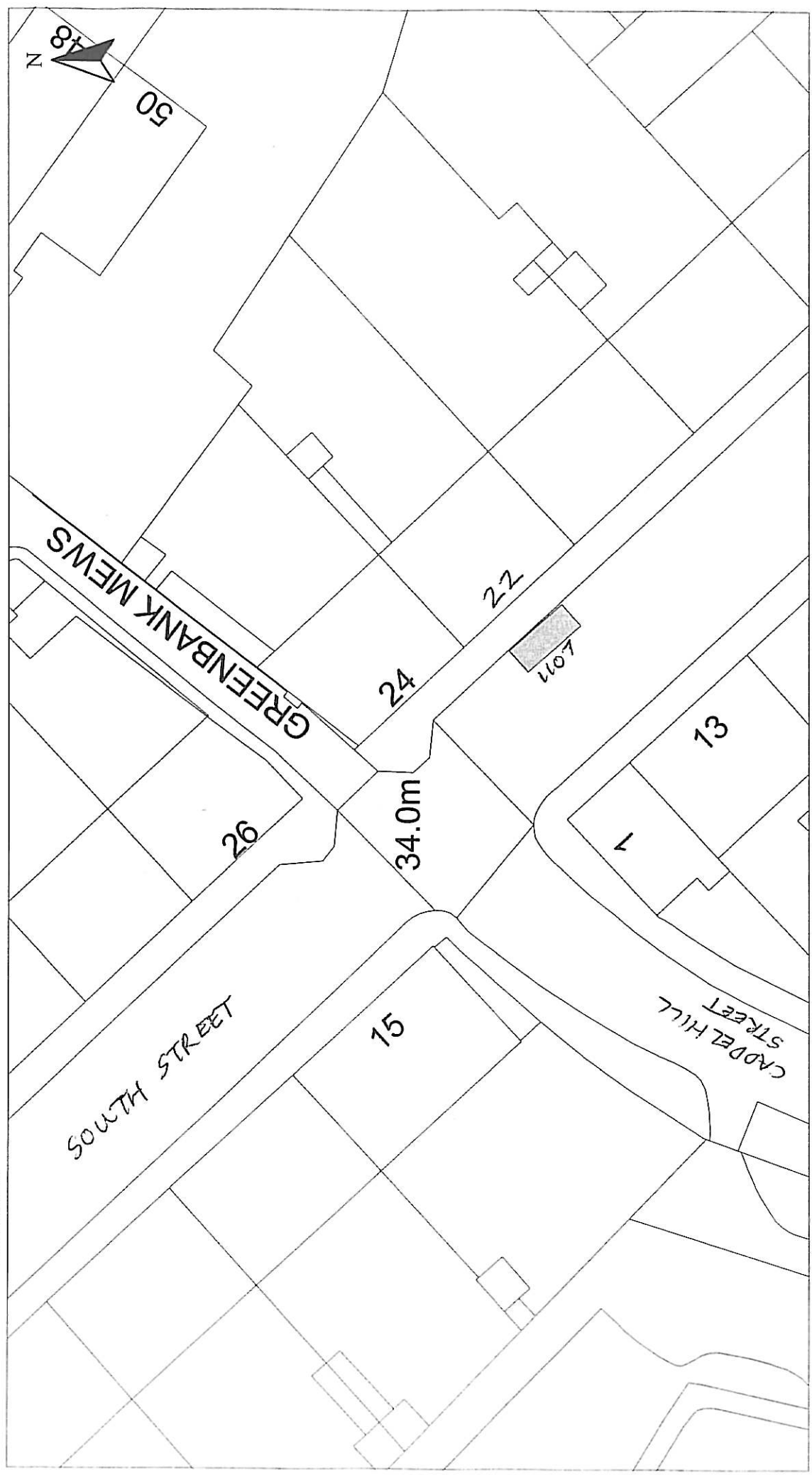

Disabled Bays	HEAD OF SERVICE IAN MOFFAT	71 EAST HAMILTON STREET GREENOCK, PA15 2JA	Reproduced from Ordnance Survey mapping with the permission of the Controller of Her Majesty's Stationery Office. Crown Copyright. Unauthorised reproduction infringes Crown Copyright and may result in prosecution or legal proceedings. Licence No. LA03097L 	Scale : 1:500	Date : JAN 2013
	DISABLED PERSONS' PARKING PLACE 22 SOUTH STREET, GREENOCK PLACE No. 1107 REVOCATION			Prepared by : R. MACKAY Drawn by : R. MACKAY Drawing No. :	Checked by : Approved by : File No. : 19/12

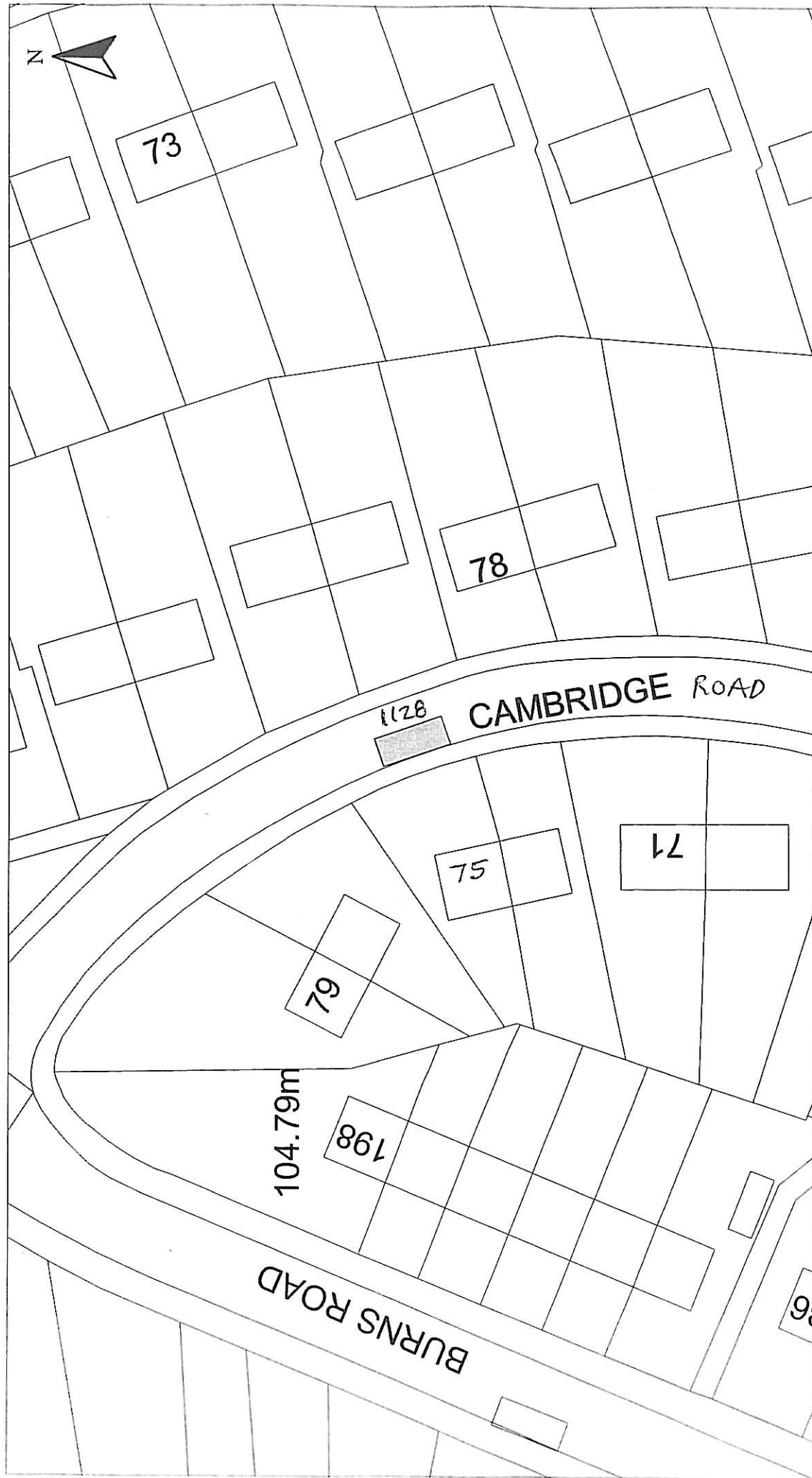

DISABLED PERSONS' PARKING PLACE
75 CAMBRIDGE ROAD, GREENOCK
PLACE No. 1128 REVOCATION

Reproduced from Ordnance Survey mapping with the permission of the Controller of Her Majesty's Stationery Office. Crown Copyright. Unauthorised reproduction infringes Crown Copyright and may result in prosecution or legal proceedings.

Ordnance Survey
Licence No. LA03097L

HEAD OF SERVICE
IAN MOFFAT

71 EAST HAMILTON STREET
GREENOCK, PA15 2UA

Disabled Bays

Scale : 1:500
Prepared by : R. MACKAY
Drawn by : R. MACKAY
Date : JAN 2013
Checked by :
Approved by :
File No. : 19/12

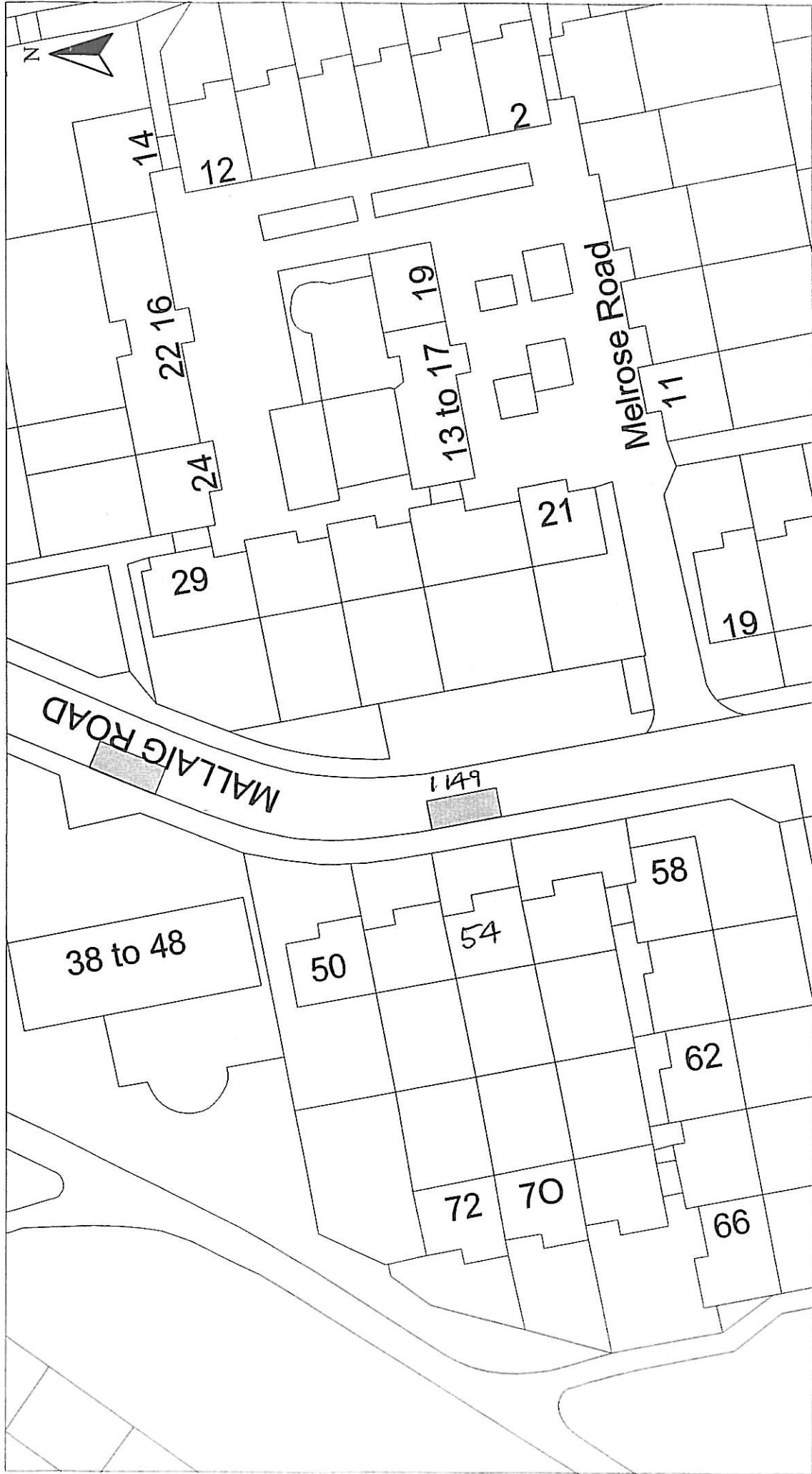

HEAD OF SERVICE
IAN MOFFAT

71 EAST HAMILTON STREET
GREENOCK, PA15 2UA

Disabled Bays

Reproduced from Ordnance Survey mapping with the permission of the Controller of Her Majesty's Stationery Office. Crown Copyright. Unauthorised reproduction infringes Crown Copyright and may result in prosecution or legal proceedings.

Licence No. LA03097L

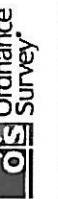

DISABLED PERSONS' PARKING PLACE

54 MALLAIG ROAD, GREENOCK
PLACE No. 1149 REVOCATION

Scale : 1:500

Prepared by : R. MACKAY

Drawn by : R. MACKAY

Drawing No. :

Date : JAN 2013

Checked by :

Approved by :

File No. : 19/12