

---

<b>Report To:</b>	<b>THE INVERCLYDE COUNCIL</b>	<b>Date:</b> 11 APRIL 2013
<b>Report By:</b>	<b>CORPORATE DIRECTOR ENVIRONMENT, REGENERATION &amp; RESOURCES</b>	<b>Report No:</b> LA/997/13
<b>Contact Officer:</b>	<b>JOANNA DALGLEISH</b>	<b>Contact No:</b> 01475 712123
<b>Subject:</b>	<b>PROPOSED TRAFFIC REGULATION ORDER – DISABLED PERSONS’ PARKING PLACES (ON STREET) ORDER NO 4 2012</b>	

---

## 1.0 PURPOSE

- 1.1 The purpose of the report is to introduce Traffic Regulation Order – Disabled Persons’ Parking Places (On Street) Order No 4 2012.

## 2.0 SUMMARY

- 2.1 In order to comply with the Disabled Persons’ Parking Places (Scotland) Act 2009, Section 5 and to provide assistance to disabled persons who hold a badge under the Disabled Persons (Badges for Motor Vehicles) (Scotland) Regulations 2000 as amended, the Environment and Regeneration Committee at the meeting held on 7 March 2013 agreed that The Inverclyde Council be asked to make the Traffic Regulation Order – Disabled Persons’ Parking Places (On Street) Order No 4 2012 in terms of the Road Traffic Regulation Act 1984, Roads (Scotland) Act 1984 and associated Regulations.
- 2.2 The proposals have been advertised and no objections have been received.
- 2.3 There are no legal or financial implications.

## 3.0 RECOMMENDATION

- 3.1 That a Resolution is made in the following terms:
- 3.2 THE INVERCLYDE COUNCIL, incorporated under the Local Government etc. (Scotland) Act 1994, RESOLVE TO MAKE as they HEREBY MAKE a Resolution under Section 32(1) and Part III of Schedule 9 of the Road Traffic Regulation Act 1984 to permit the provision of parking places for disabled persons who hold a badge under the Disabled Persons (Badges for Motor Vehicles) (Scotland) Regulations 2000 as amended all as detailed in a copy of the Order forming a supplement to the principal minute hereof, and that the Head of Environmental & Commercial Services and Head of Legal & Democratic Services be authorised to take all necessary action in connection therewith.

Appendix

**Legal & Democratic Services**

**THE INVERCLYDE COUNCIL**  
**DISABLED PERSONS' PARKING PLACES**  
**(ON STREET) ORDER NO. 4 2012**  
**TRAFFIC REGULATION ORDER**

**THE INVERCLYDE COUNCIL**

**DISABLED PERSONS' PARKING PLACES (ON STREET)**

**ORDER NO. 4 2012**

The Inverclyde Council in exercise of the powers conferred on them by Sections 32(1) of the Road Traffic Regulation Act 1984 ("the Act") and of all other enabling powers and after consultation with the Chief Constable of Strathclyde Police in accordance with Part III of Schedule 9 to the Act hereby make the following Order.

1. This Order may be cited as "The Inverclyde Council Disabled Persons' Parking Places (On Street) Order No. 4 2012 and shall come into operation on ##
2. In this Order the following expressions have the meanings hereby assigned to them:
  - "vehicle" unless the context otherwise requires, means a vehicle of any description and includes a machine or implement of any kind drawn or propelled along roads whether or not by mechanical power;
  - "parking place" means a place where a vehicle, or vehicles of any class, may wait i.e. the area of land specified in the Schedule for which the use as a parking place has been authorised by the Council under Section 32(1) of the Act;
  - "sign" means a traffic sign;
  - "disabled person's badge" means:
    - (a) a badge issued under Section 21 of the Chronically Sick and Disabled Persons Act 1970;
    - (b) a badge issued under a provision of the law of Northern Ireland corresponding to that section; or
    - (c) a badge issued by any member State other than the United Kingdom for purposes corresponding to the purposes for which badges under that section are issued;
  - "disabled person's vehicle" means a vehicle lawfully displaying a disabled person's badge;
  - "Council" means The Inverclyde Council;
3. Each area of road which is described in the Schedule and plans relative to this Order is hereby designated as a parking place.
4. The parking places designated in this Order shall only be used for the leaving of disabled persons' vehicles displaying a valid disabled person's badge.

5. The limits of each parking place designated in this Order shall be indicated on the carriageway as prescribed by The Traffic Signs Regulations and General Directions 2002.
6. Every vehicle left in any parking place designated in this Order shall stand such that no parking place is occupied by more than one vehicle and that every part of the vehicle is within the limits of the parking place provided that, where the length of a vehicle precludes compliance with this paragraph, such vehicle shall be deemed to be within the limits of a parking place if;
  - i. the extreme front portion or, as the case may be, the extreme rear portion of the vehicle is within 300mm of an indication on the carriageway provided under this Order in relation to the parking place; and
  - ii. the vehicle, or any part thereof, is not within the limits of any adjoining parking place.
7. Any person duly authorised by the Council or a police officer in uniform or a traffic warden or parking attendant may move or cause to be moved in case of any emergency, to any place they think fit, vehicles left in a parking place.
8. Any person duly authorised by the Council may suspend the use of a parking place or any part thereof whenever such suspension is considered reasonably necessary:
  - i. for the purpose of facilitating the movement of traffic or promoting its safety;
  - ii. for the purpose of any building operation, demolition, or excavation in or adjacent to the parking place or the laying, erection, alteration, removal or repair in or adjacent to the parking place of any sewer or of any main, pipe, apparatus for the supply of gas, water electricity or of any telecommunications apparatus, traffic sign or parking meter;
  - iii. for the convenience of occupiers of premises adjacent to the parking place on any occasion of the removal of furniture from one office or dwellinghouse to another or the removal of furniture from such premises to a depository or to such premises from a depository;
  - iv. on any occasion on which it is likely by reason of some special attraction that any street will be thronged or obstructed; or
  - v. for the convenience of occupiers of premises adjacent to the parking place at times of weddings or funerals or on other special occasions.
9. A police officer in uniform may suspend for not longer than twenty four hours the use of a parking place or part thereof whenever such suspension is considered reasonably necessary for the purpose of facilitating the movement of traffic or promoting its safety.

10. This Order insofar as it relates to the parking places to be revoked (R) and amended, as specified in the Schedule to this Order, partially revokes and amends the On Street Parking Places (Without Charges) Orders No. 2 2002 and No. 1 2009 and the Disabled Persons' Parking Places (On Street) Orders No. 2 2011 and No. 4 2011 respectively.

Sealed with the Common Seal of The Inverclyde Council and subscribed for them and on their behalf by ##

DRAFT

**INVERCLYDE COUNCIL**

**DISABLED PERSONS' PARKING PLACES (ON STREET)  
ORDER NO. 4 2012**

**Statement of Reasons for Proposing to Make  
the Above Order**

It is considered necessary to make the above Order to provide assistance for disabled persons who hold a badge under the Disabled Persons (Badges for Motor Vehicles) (Scotland) Regulations 2000 as amended and by revoking those parking places no longer required to maximise street parking capacity.

DRAFT

# INVERCLYDE COUNCIL

## DISABLED PERSONS' PARKING PLACES (ON-STREET) ORDER No.4 2012

### SCHEDULE

Rev A

All and whole that area of ground as described in Column 2 in the table below:

<u>Ref No.</u>	<u>Address of Disabled Person's Parking Place to be created or revoked @ "ex-adverso"</u>
1179	104 Braeside Road, Greenock
1202	28 Stafford Road, Greenock
1205	4 Staffa Avenue, Port Glasgow
1215	16A Kelburn Terrace, Port Glasgow
1218	28 Patrick Street, Greenock
1221	94 Fancy Farm Road, Greenock
1222	2 Adelaide Street, Gourock
1223	14 Leperstone Avenue, Kilmacolm
1225	45 Kilmacolm Road, Greenock
1229	18 Larkfield Grove, Greenock
1230	86 Nairn Road, Greenock
1231	22a Ardgowan Square, Greenock
1298	19D St John's Road, Gourock
1299	1 Nicol Street, Greenock
0151	15 Quarry Drive, Kilmacolm ®
0898	12 North Road, Port Glasgow ®
1080	73 Fancy Farm Road, Greenock ®
1129	60 Nelson Road, Gourock ®
1133	43 Ashton Road, Gourock ®



HEAD OF SERVICE  
IAN MOFFAT

71 EAST HAMILTON STREET  
GREENOCK, PA15 2UA

Disabled Bays

Reproduced from Ordnance Survey mapping with the permission of the Controller of Her Majesty's Stationery Office. Crown Copyright. Unauthorised reproduction infringes Crown Copyright and may result in prosecution or legal proceedings.

Licence No. LA03097L

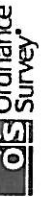

DISABLED PERSONS' PARKING PLACE

104 BRAESIDE ROAD, GREENOCK

PLACE No. 1179

Scale : 1:500

Prepared by : R. MACKAY

Drawn by : R. MACKAY

Drawing No. : 19/12

Date : JULY 2012

Checked by :

Approved by :

File No. :



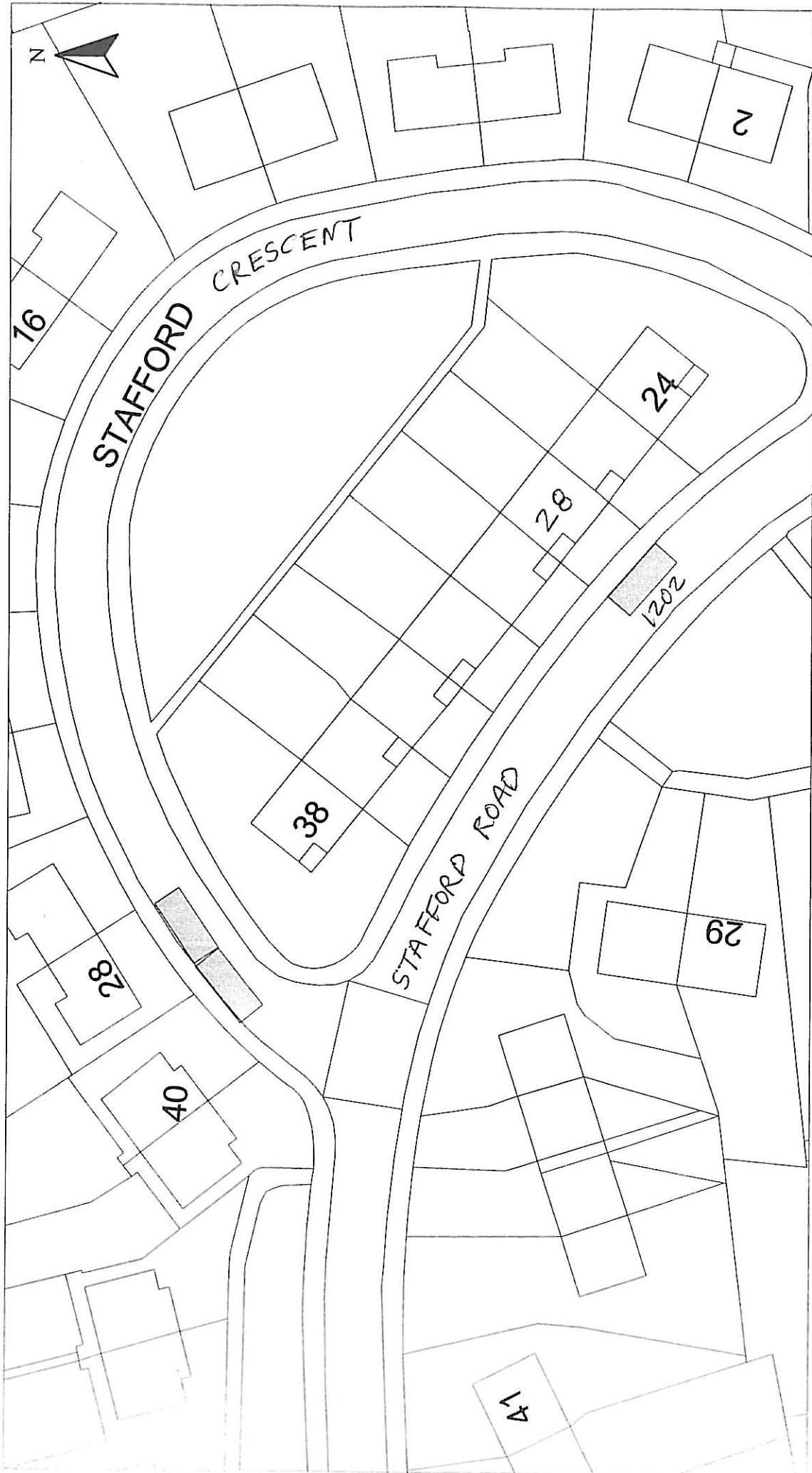

Scale :	1:500	Date :	OCT 2012
Prepared by :	R. MACKAY	Checked by :	
Drawn by :	R. MACKAY	Approved by :	
Drawing No. :		File No. :	19/12

**DISABLED PERSONS' PARKING PLACE**  
28 STAFFORD ROAD, GREENOCK  
PLACE No. 1202

Reproduced from Ordnance Survey mapping with the permission of the Controller of Her Majesty's Stationery Office. Ordnance Survey is a registered trademark of the Ordnance Survey Corporation. Unauthorised reproduction infringes Ordnance Survey's Copyright and may result in prosecution or legal proceedings.

Licence No. LA03097L

HEAD OF SERVICE  
IAN MOFFAT

71 EAST HAMILTON STREET  
GREENOCK, PA15 2UA



HEAD OF SERVICE  
IAN MOFFAT

71 EAST HAMILTON STREET  
GREENOCK, PA15 2JA

Disabled Bays

Reproduced from Ordnance Survey mapping with the permission  
of the Controller of Her Majesty's Stationery Office. Crown  
Copyright. Unauthorised reproduction infringes Crown Copyright  
and may result in prosecution or legal proceedings.

Licence No. LA03097L  
**Ordnance Survey**

**DISABLED PERSONS' PARKING PLACE**  
**4 STAFFA AVENUE, PORT GLASGOW**  
**PLACE No. 1205**

Scale : 1:500

Prepared by : R. MACKAY

Drawn by : R. MACKAY

Approved by :

Drawing No. :

Date : JULY 2012

Checked by :

Approved by :

File No. : 19/12

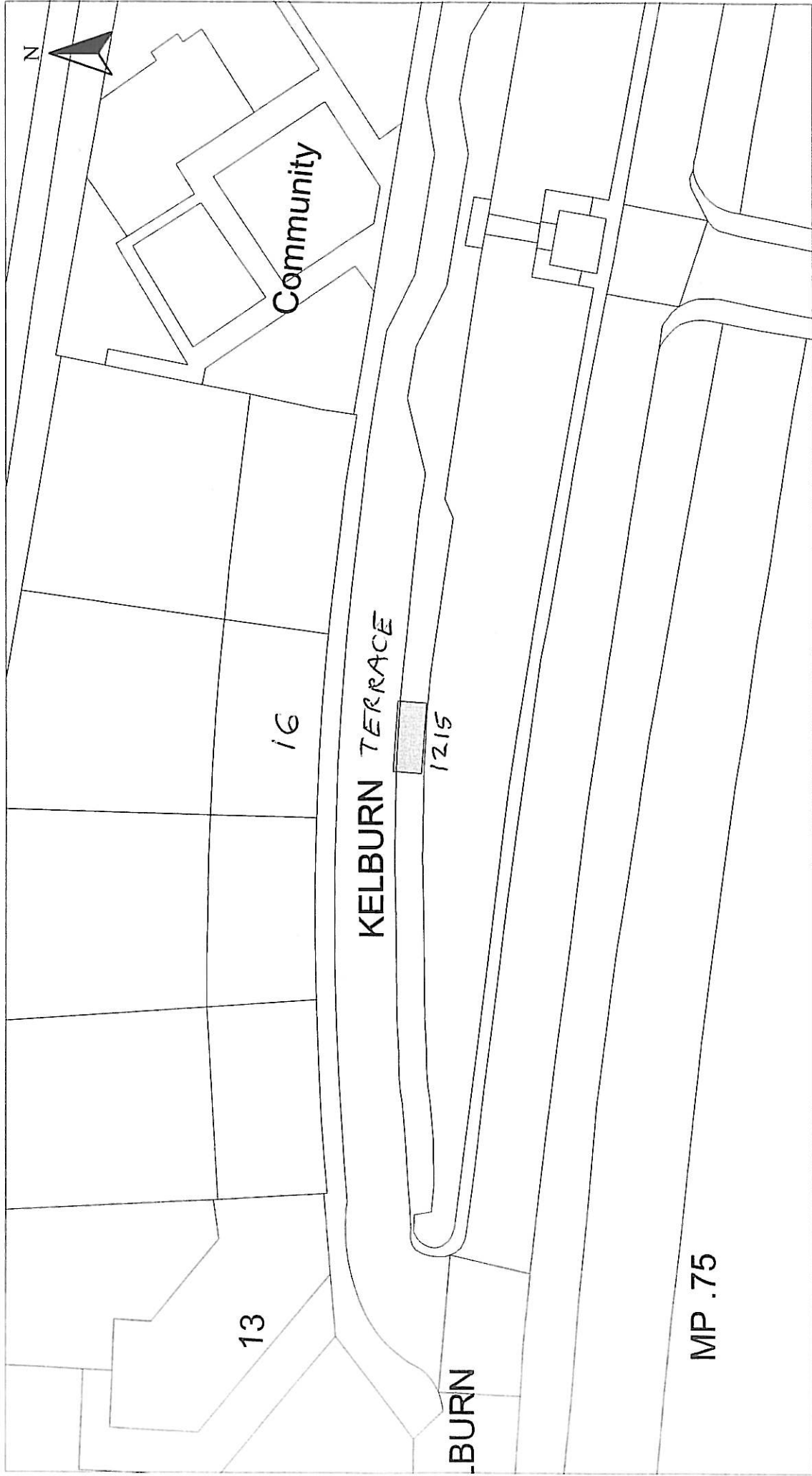

HEAD OF SERVICE  
IAN MOFFAT

Disabled Bays  
71 EAST HAMILTON STREET  
GREENOCK, PA15 2UA

Reproduced from Ordnance Survey mapping with the permission of Ordnance Survey on behalf of the Crown. All Rights Reserved. Copyright. Unauthorised reproduction infringes Crown Copyright and may result in prosecution or legal proceedings.

Licence No. LA039097L

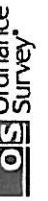

**DISABLED PERSONS' PARKING PLACE**  
16A KELBURN TERRACE, PORT GLASGOW  
PLACE No. 1215

Scale : 1:500

Prepared by : R. MACKAY

Drawn by : R. MACKAY

Drawing No. :

Date : JULY 2012

Checked by :

Approved by :

File No. : 19/12

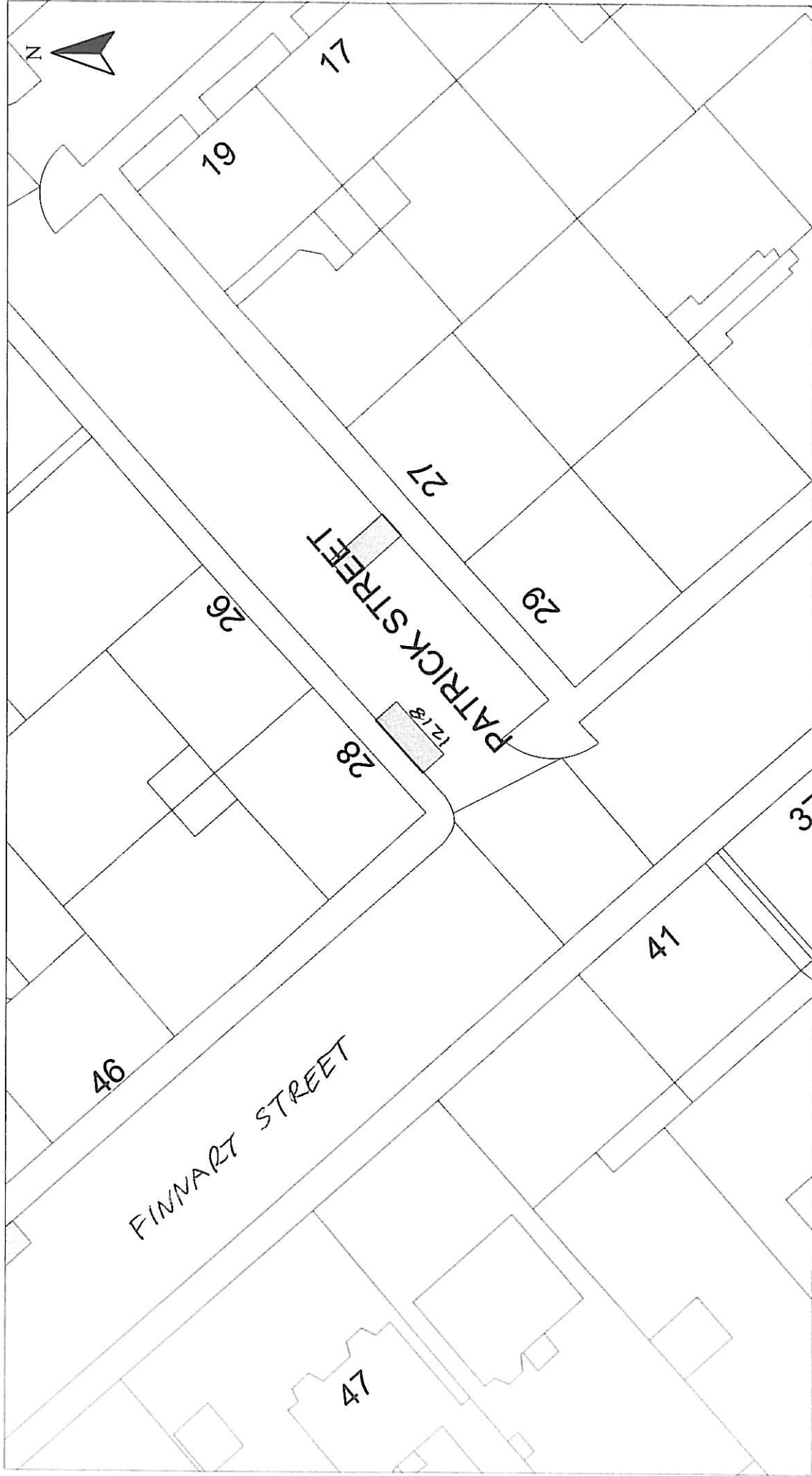

HEAD OF SERVICE  
IAN MOFFAT

Disabled Bays  
71 EAST HAMILTON STREET  
GREENOCK, PA15 2UA

DISABLED PERSONS' PARKING PLACE  
28 PATRICK STREET, GREENOCK  
PLACE No. 1218

Reproduced from Ordnance Survey mapping with the permission of the Controller of Her Majesty's Stationery Office. Crown Copyright. Unauthorised reproduction infringes Crown Copyright and may result in prosecution or legal proceedings.  
  
Licence No. LA03097L

Scale : 1:500  
Prepared by : R. MACKAY  
Drawn by : R. MACKAY  
Drawing No. :

Date : JULY 2012  
Checked by :  
Approved by :  
File No. : 19/12

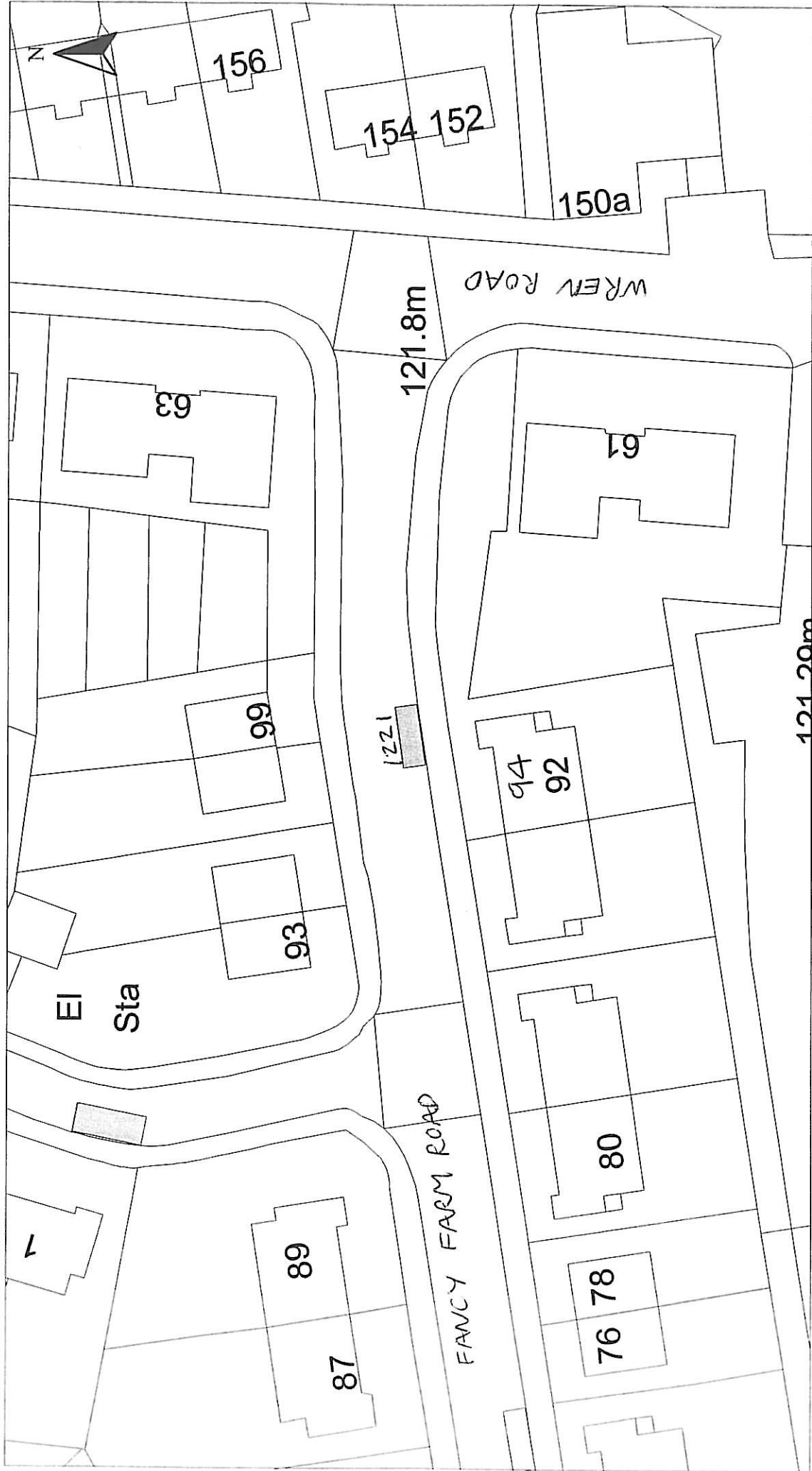

HEAD OF SERVICE  
IAN MOFFAT

71 EAST HAMILTON STREET  
GREENOCK, PA15 2UA

**DISABLED PERSONS' PARKING PLACE**  
94 FANCY FARM ROAD, GREENOCK  
PLACE No. 1221

Reproduced from Ordnance Survey mapping with the permission of the Controller of Her Majesty's Stationery Office. Crown Copyright and may result in prosecution or legal proceedings.

Licence No. LA03097L

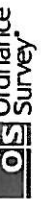

Scale : 1:500

Prepared by : R. MACKAY

Drawn by : R. MACKAY

Drawing No. :

Date : JULY 2012

Checked by :

Approved by :

File No. : 19/12

Disabled Bays

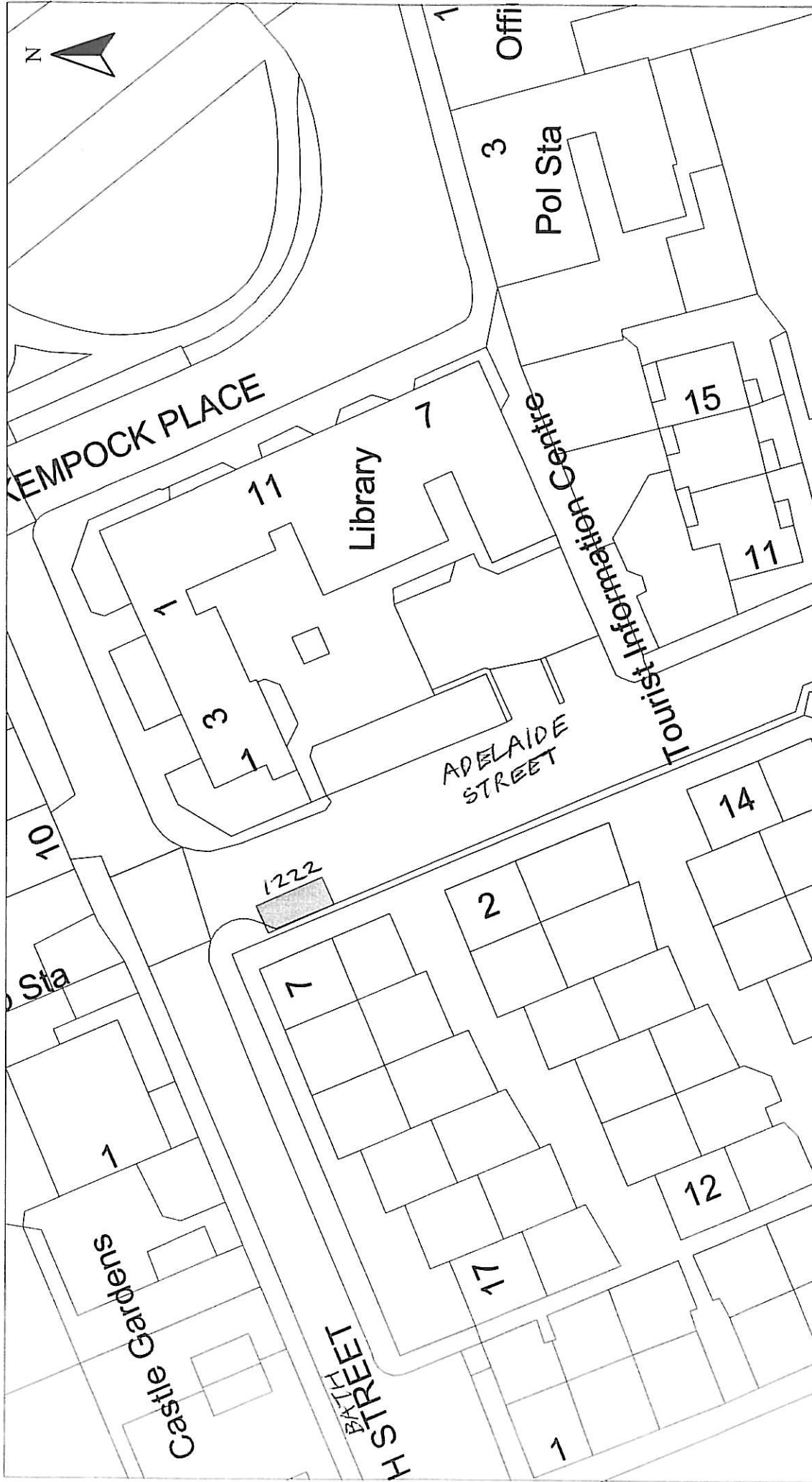

HEAD OF SERVICE IAN MOFFAT  71 EAST HAMILTON STREET GREENOCK, PA15 2UA	Scale : 1:500		Date : JULY 2012
	Prepared by : R. MACKAY		Checked by :
Disabled Bays	Drawn by : R. MACKAY		Approved by :
	Drawing No. : 1222		File No. : 19/12
DISABLED PERSONS' PARKING PLACE 2 ADELAIDE STREET, GOUROCK PLACE No. 1222			
Reproduced from Ordnance Survey mapping with the permission of the Controller of Her Majesty's Stationery Office. Crown Copyright. Unauthorised reproduction infringes Crown Copyright and may result in prosecution or legal proceedings. Licence No. LA03097L 			

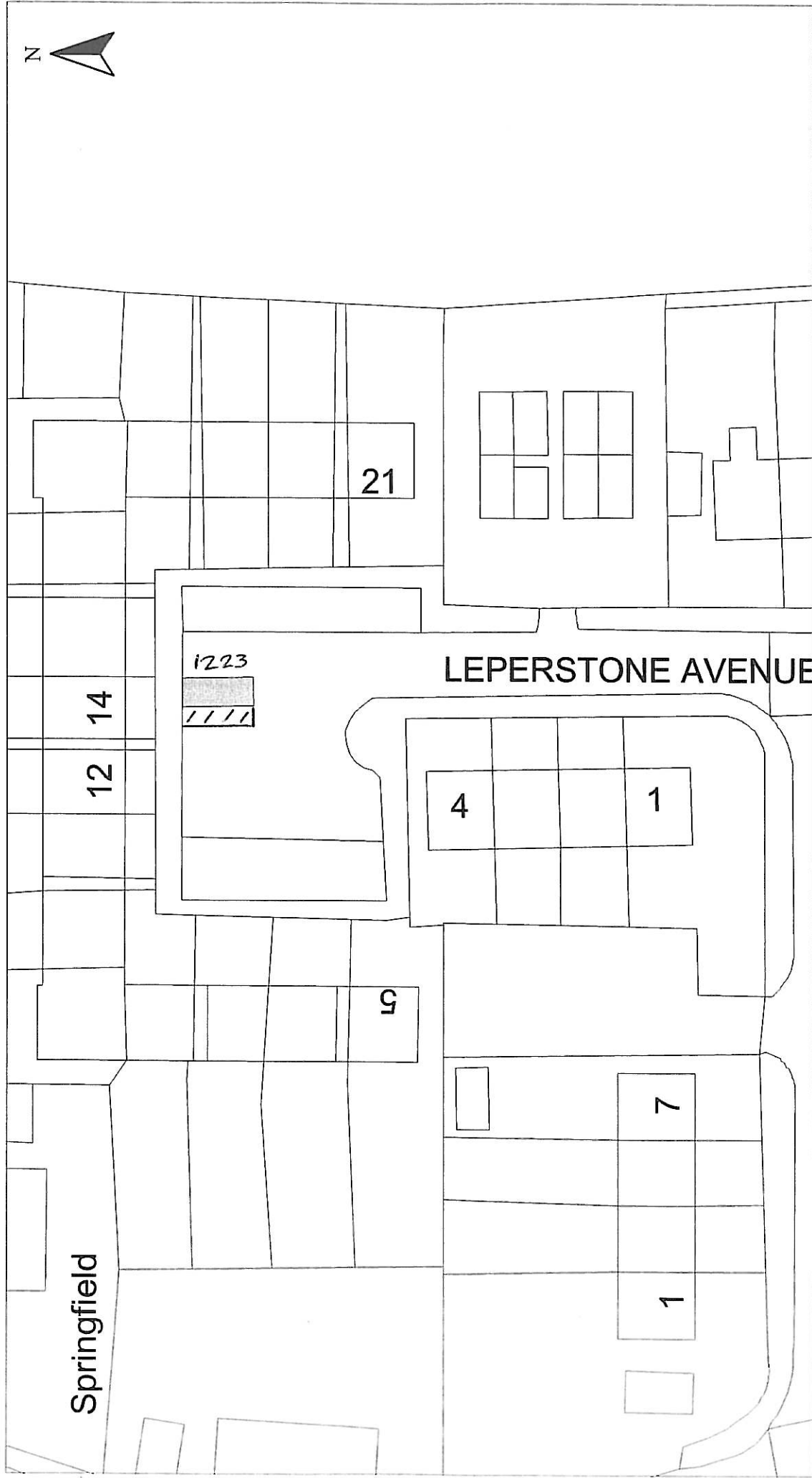

HEAD OF SERVICE  
IAN MOFFAT

71 EAST HAMILTON STREET  
GREENOCK, PA15 2UA

Reproduced from Ordnance Survey mapping with the permission of the Controller of Her Majesty's Stationery Office. Ordnance Survey is a registered trademark of Ordnance Survey. All rights reserved. Use of this information in any form without the permission of Ordnance Survey is prohibited. Ordnance Survey is a registered trademark of Ordnance Survey. All rights reserved. Use of this information in any form without the permission of Ordnance Survey is prohibited.



Licence No. LA03097L

DISABLED PERSONS' PARKING PLACE

14 LEPERSTONE AVENUE, KILMACOLM

PLACE No. 1223

Scale : 1:500

Prepared by : R. MACKAY

Drawn by : R. MACKAY

Drawing No. : 19/12

Date : JULY 2012

Checked by :

Approved by :

File No. :

Disabled Bays

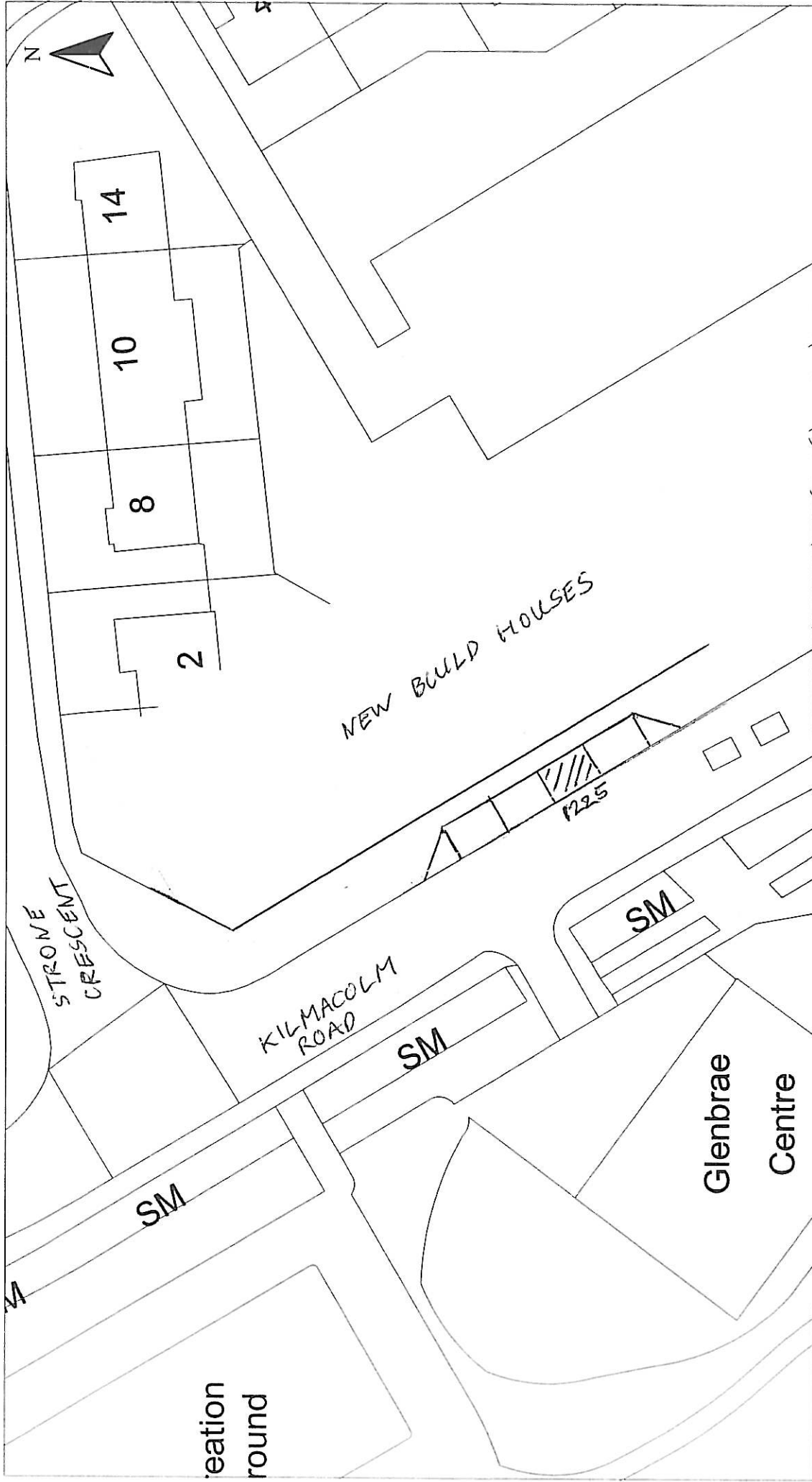

**DISABLED PERSONS' PARKING PLACE**  
45 KILMACOLM ROAD, GREENOCK  
PLACE No. 1225

Scale :	1:500	Date :	SEP 2012
Prepared by :	R. MACKAY	Checked by :	
Drawn by :	R. MACKAY	Approved by :	
Drawing No. :		File No. :	19/12

Reproduced from Ordnance Survey mapping with the permission of the Controller of Her Majesty's Stationery Office. Crown Copyright and may result in prosecution of legal proceedings.  
Ordnance Survey  
Licence No. LA03097L

HEAD OF SERVICE  
IAN MOFFAT  
71 EAST HAMILTON STREET  
GREENOCK, PA15 2UA

Disabled Bays



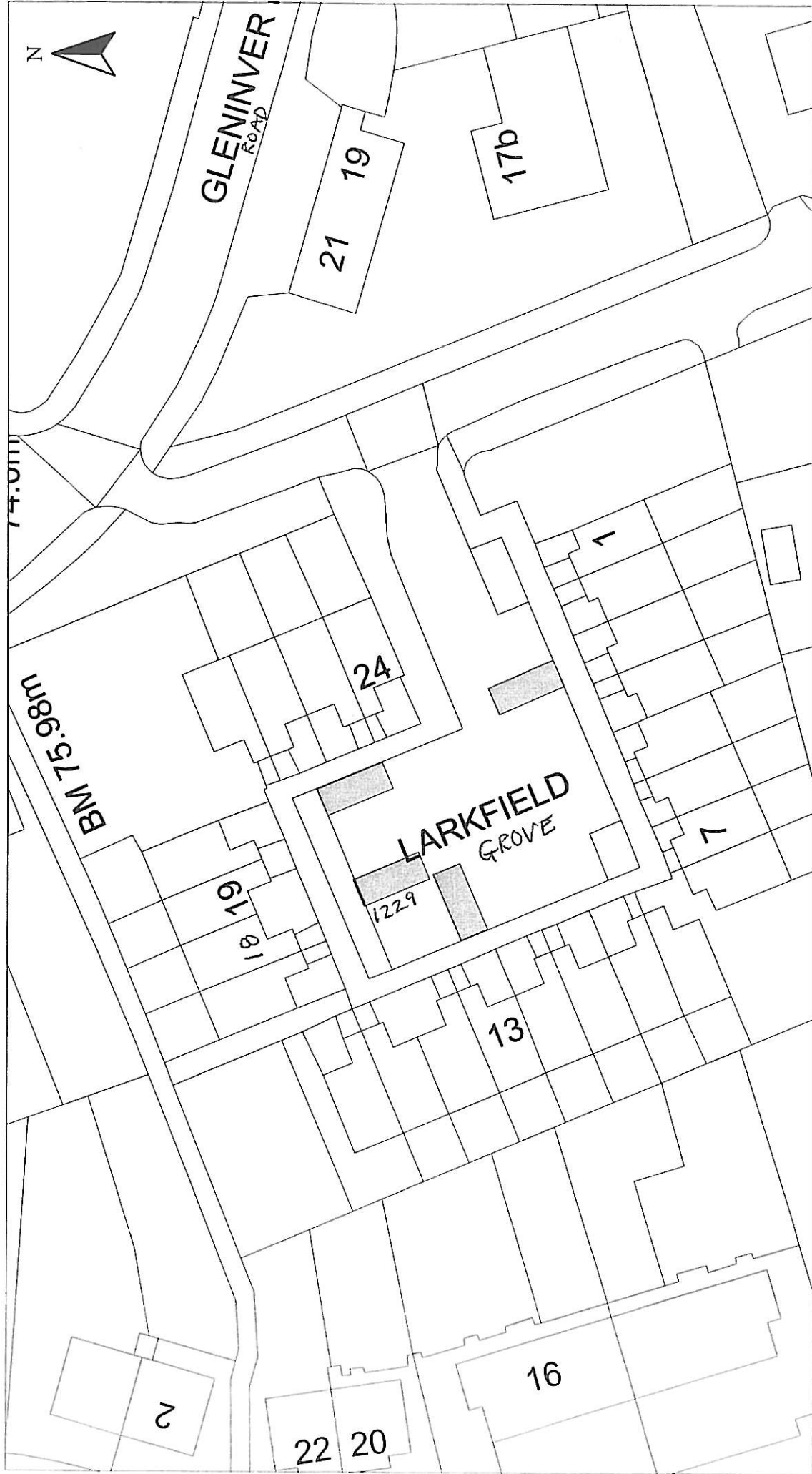

Disabled Bays	HEAD OF SERVICE IAN MOFFAT  71 EAST HAMILTON STREET GREENOCK, PA15 2UA	Reproduced from Ordnance Survey mapping with the permission of Ordnance Survey. All Rights Reserved. Copyright. Unauthorised reproduction infringes Crown Copyright and may result in prosecution or legal proceedings.  Licence No. LA03007L  Ordnance Survey	DISABLED PERSONS' PARKING PLACE 18 LARKFIELD GROVE, GREENOCK PLACE No. 1229	Scale : 1:500 Prepared by : R. MACKAY Drawn by : R. MACKAY Drawing No. :	Date : SEP 2012 Checked by : Approved by : File No. : 19/12
---------------	--	--	---	---	--

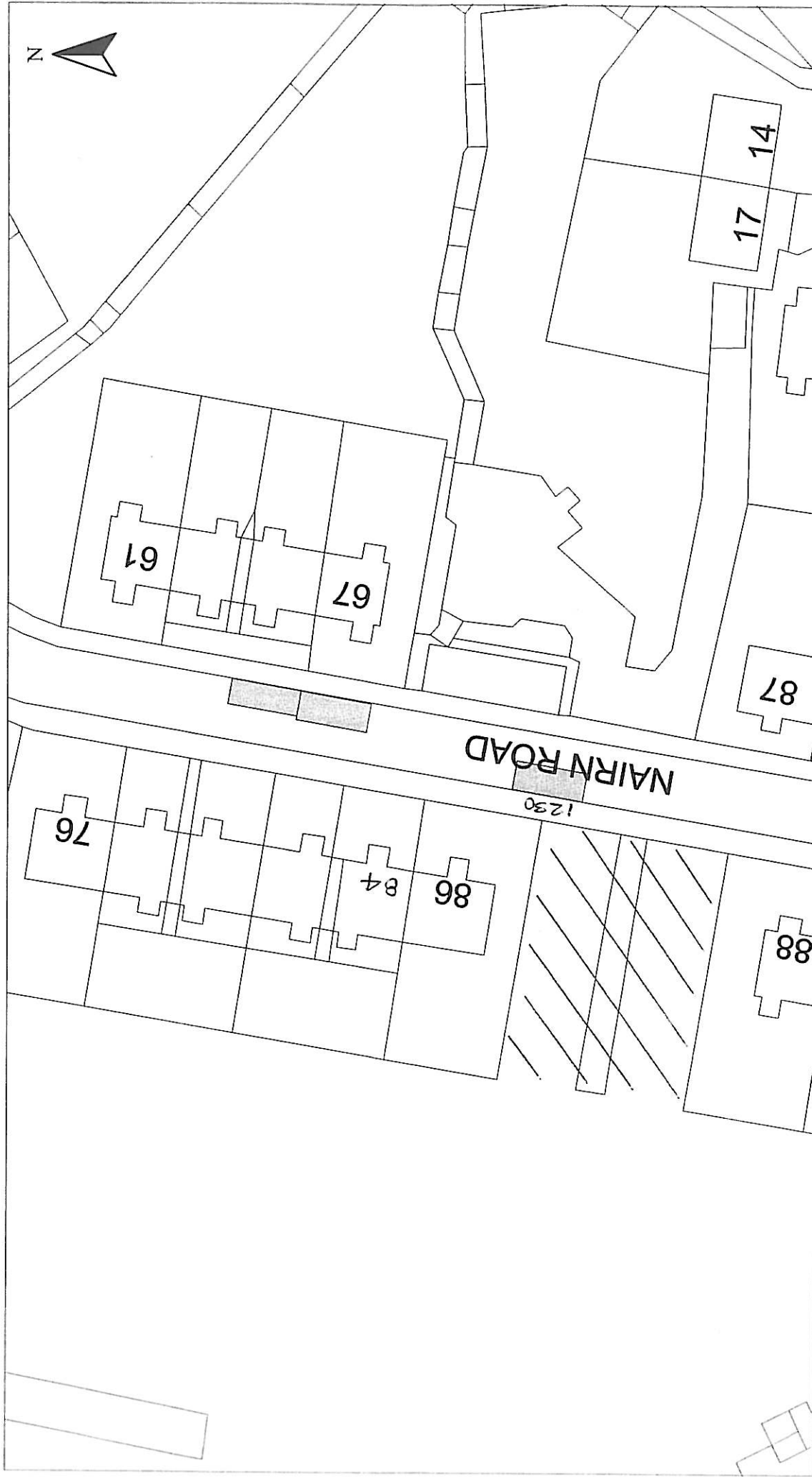

HEAD OF SERVICE  
IAN MOFFAT

Disabled Bays  
71 EAST HAMILTON STREET  
GREENOCK, PA15 2JA

**DISABLED PERSONS' PARKING PLACE**  
86 NAIRN ROAD, GREENOCK  
PLACE No. 1230

Reproduced from Ordnance Survey mapping with the permission of the Controller of Her Majesty's Stationery Office. Crown Copyright. Unauthorised reproduction infringes Crown Copyright and may result in prosecution or legal proceedings.  
Licence No. LA03097L  
**OS** Ordnance Survey

Scale :	1:500	Date :	OCT 2012
Prepared by :	R. MACKAY	Checked by :	
Drawn by :	R. MACKAY	Approved by :	
Drawing No. :		File No. :	19/12

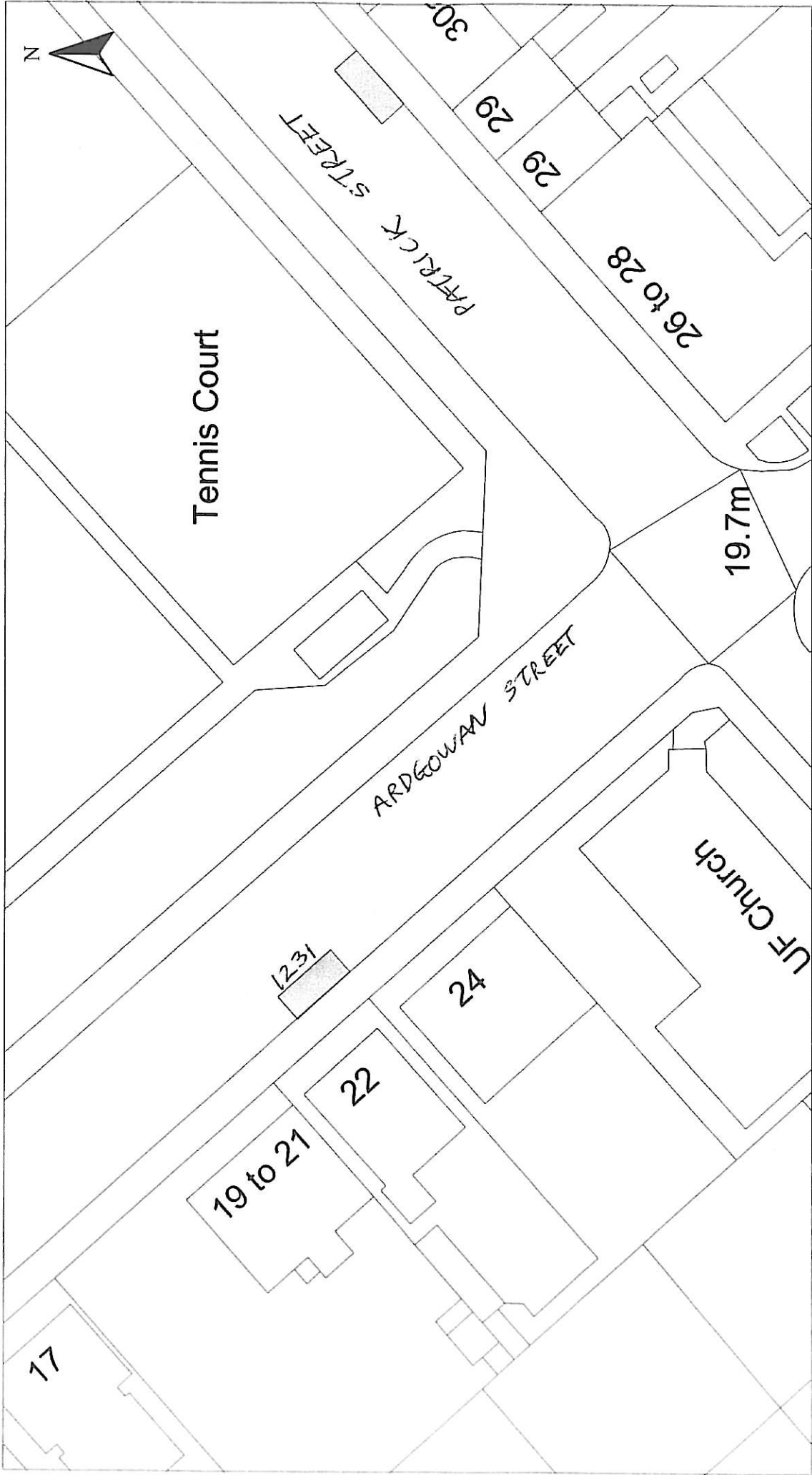

HEAD OF SERVICE  
IAN MOFFAT

Disabled Bays  
71 EAST HAMILTON STREET  
GREENOCK, PA15 2UA

Reproduced from Ordnance Survey mapping with the permission of the Controller of Her Majesty's Stationery Office. Crown Copyright. Unauthorised reproduction infringes Crown Copyright and may result in prosecution or legal proceedings.  
Ordnance Survey  
Licence No. LA03097L

**DISABLED PERSONS' PARKING PLACE**  
22A ARDGOWAN SQUARE, GREENOCK  
PLACE No. 1231

Scale : 1:500

Prepared by : R. MACKAY

Drawn by : R. MACKAY

Drawing No. :

Date : JULY 2012

Checked by :

Approved by :

File No. : 19/12

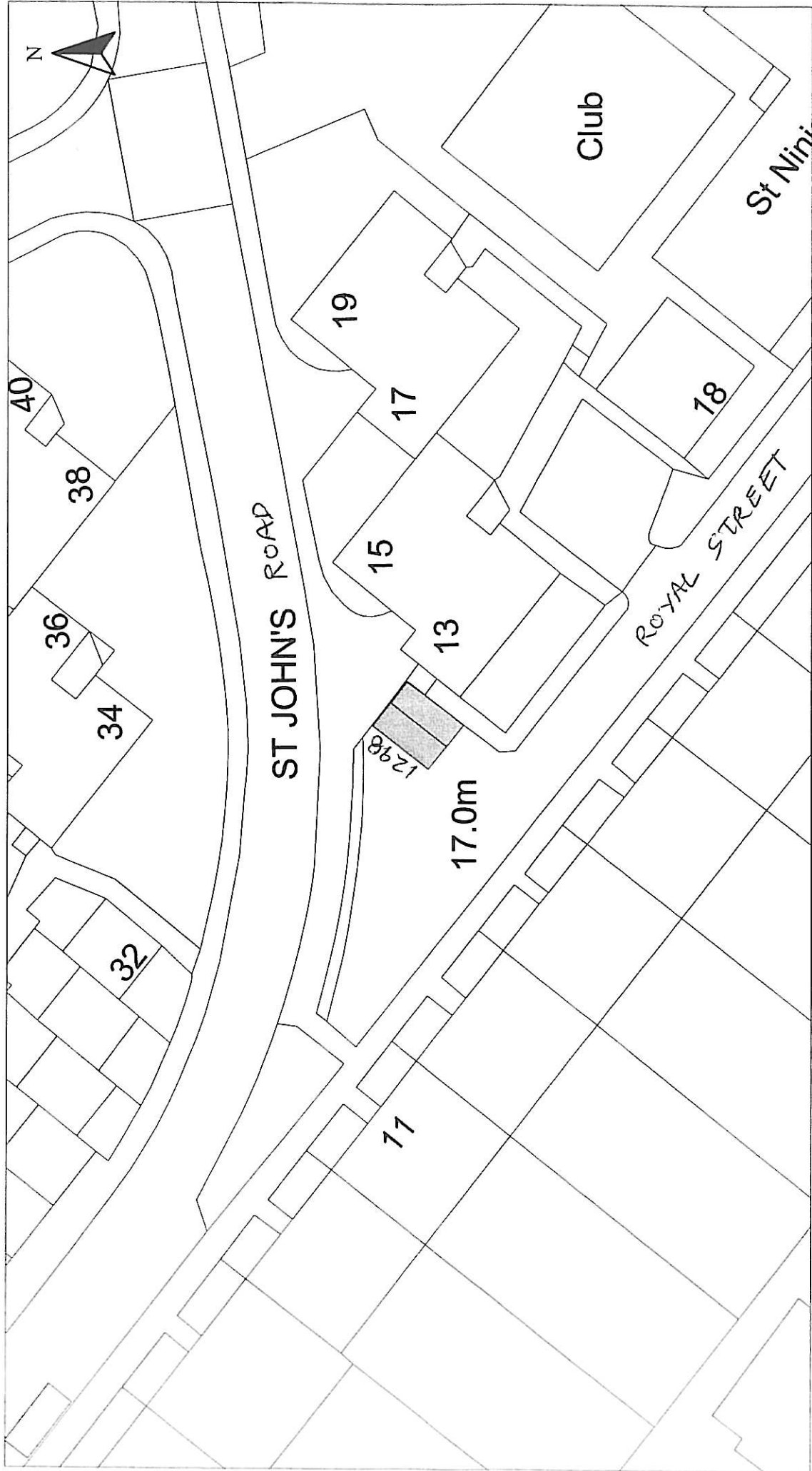

HEAD OF SERVICE  
IAN MOFFAT

71 EAST HAMILTON STREET  
GREENOCK, PA15 2JA

Disabled Bays

Reproduced from Ordnance Survey mapping with the permission of the Controller of Her Majesty's Stationery Office. Crown Copyright. Unauthorised reproduction infringes Crown Copyright and may result in prosecution or legal proceedings.

OS  
Ordnance Survey  
Licence No. LA03097L

**DISABLED PERSONS' PARKING PLACE**

19D St JOHN'S ROAD, GOUROCK  
PLACE No. 1298

Scale : 1:500

Prepared by : R. MACKAY

Drawn by : R. MACKAY

Drawing No. : 19/12

Date : NOV 2011

Checked by :

Approved by :

File No. : 19/12

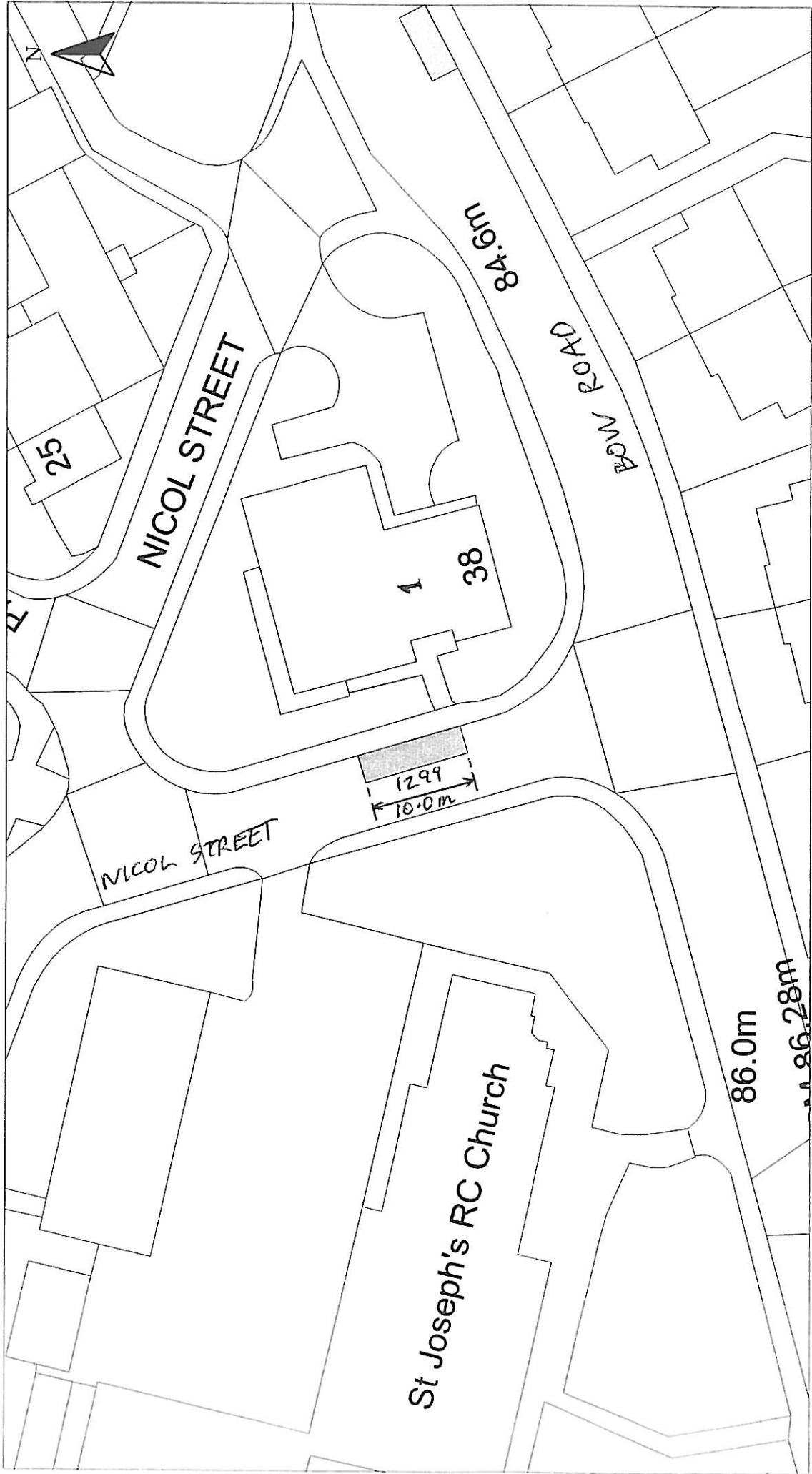

HEAD OF SERVICE  
IAN MOFFAT

Disabled Bays  
71 EAST HAMILTON STREET  
GREENOCK, PA15 2JA

Reproduced from Ordnance Survey mapping with the permission of the Controller of Her Majesty's Stationery Office. Crown Copyright. Unauthorised reproduction infringes Crown Copyright and may result in prosecution or legal proceedings.  
Ordnance Survey  
Licence No. LA03097L

**DISABLED PERSONS' PARKING PLACE**  
1 NICOL STREET, GREENOCK  
PLACE No. 1299

Date :	JULY 2012
Scale :	1:500
Prepared by :	R. MACKAY
Checked by :	
Drawn by :	R. MACKAY
Approved by :	
File No. :	19/12



HEAD OF SERVICE  
IAN MOFFAT

Disabled Bays  
71 EAST HAMILTON STREET  
GREENOCK, PA15 2UA

Reproduced from Ordnance Survey mapping with the permission of the Controller of Her Majesty's Stationery Office. Crown Copyright. Unauthorised reproduction infringes Crown Copyright and may result in prosecution or legal proceedings.  
Licence No. LA03097L  
**Ordnance Survey**

**DISABLED PERSONS' PARKING PLACE**  
15 QUARRY DRIVE, KILMACOLM  
PLACE No. 0151 REVOCATION

Scale : 1:500  
Prepared by : R. MACKAY  
Drawn by : R. MACKAY  
Drawing No. :

Date : JULY 2012  
Checked by :  
Approved by :  
File No. : 19/12

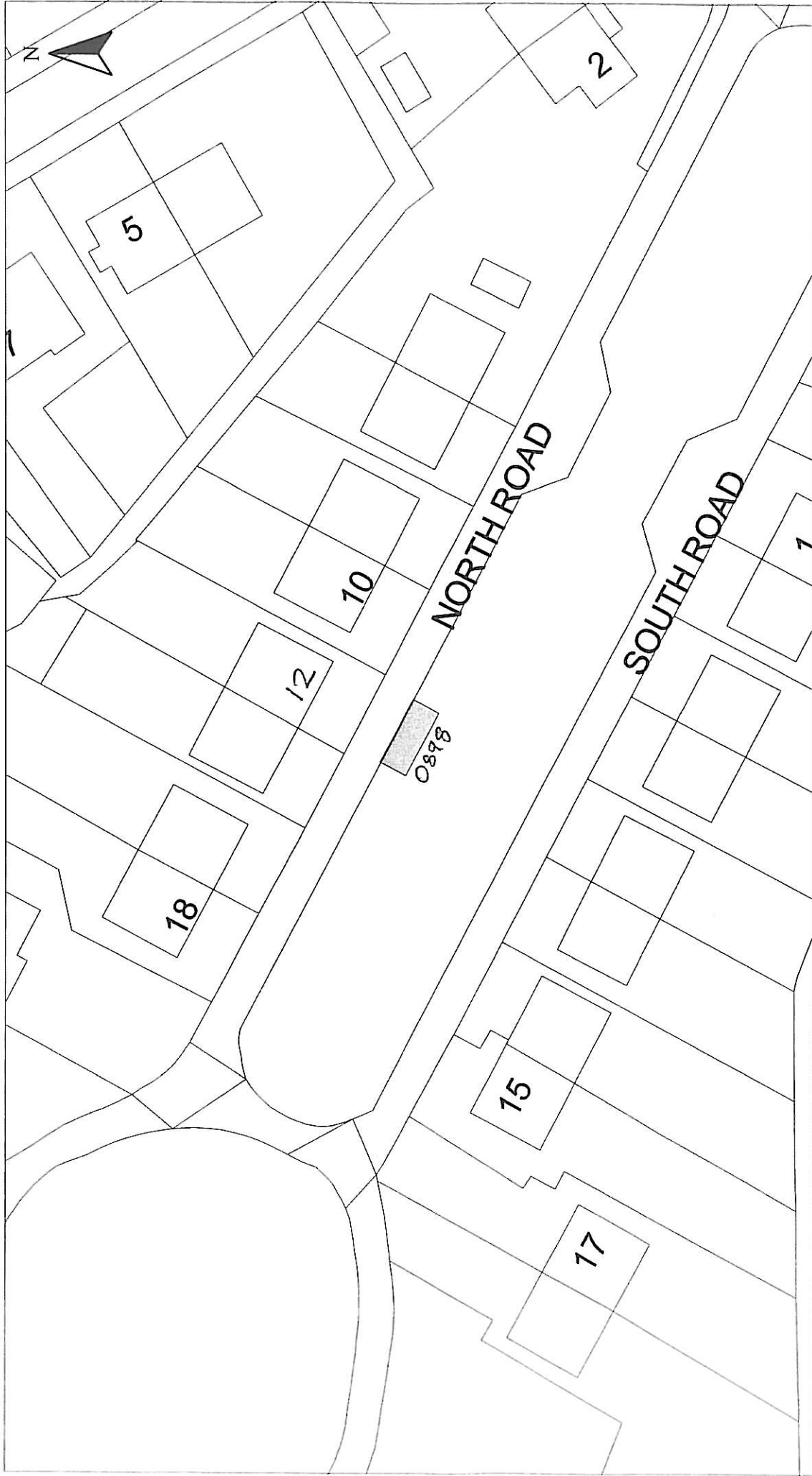

HEAD OF SERVICE  
IAN MOFFAT

71 EAST HAMILTON STREET  
GREENOCK, PA15 2UA

Disabled Bays

Reproduced from Ordnance Survey mapping with the permission of the Controller Her Majesty's Stationery Office. Crown Copyright. All rights reserved. No part of this publication may be reproduced in any form or by any means without the prior written permission of Ordnance Survey. Licence No. LA03097L



**Ordnance Survey**

**DISABLED PERSONS' PARKING PLACE**  
12 NORTH ROAD, PORT GLASGOW  
PLACE No. 0898 REVOCATION

Scale : 1:500  
Prepared by : R. MACKAY  
Drawn by : R. MACKAY  
Drawing No. : 19/12

Date : JULY 2012  
Checked by :  
Approved by :  
File No. :

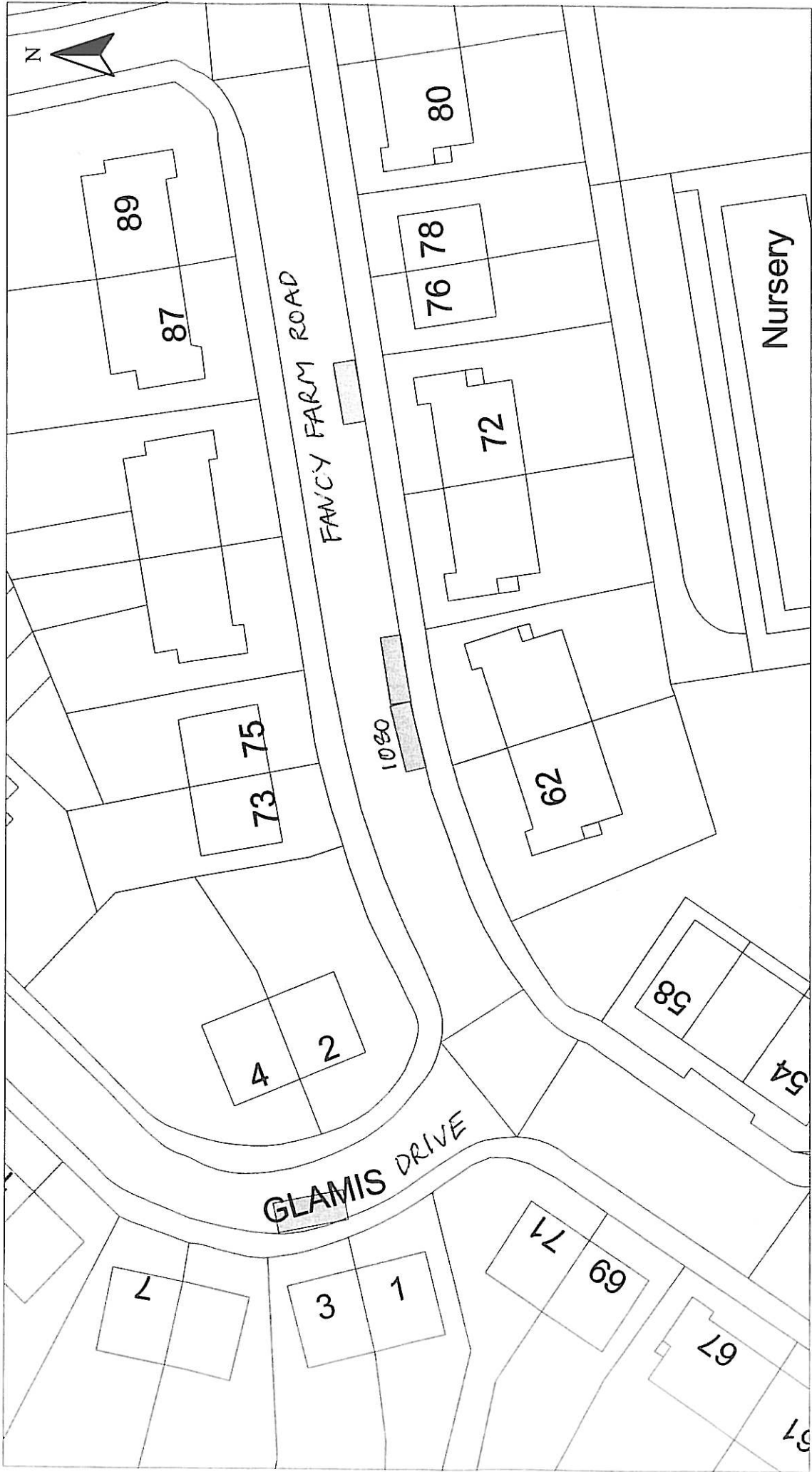

HEAD OF SERVICE IAN MOFFAT	DISABLED PERSONS' PARKING PLACE 73 FANCY FARM ROAD, GREENOCK PLACE No. 1080 REVOCATION	Scale :	1:500	Date :	JULY 2012
		Prepared by :	R. MACKAY	Checked by :	
Disabled Bays 71 EAST HAMILTON STREET GREENOCK, PA15 2UA		Drawn by :	R. MACKAY	Approved by :	
		Drawing No. :		File No. :	19/12

Reproduced from Ordnance Survey mapping with the permission of the Controller of Her Majesty's Stationery Office. Crown copyright. Unauthorised reproduction infringes Crown Copyright and may result in prosecution or legal proceedings.

**Ordnance Survey**  
Licence No. LA03097L



# Inverclyde council ENVIRONMENTAL & COMMERCIAL SERVICES



HEAD OF SERVICE IAN MOFFAT	DISABLED PERSONS' PARKING PLACE 60 NELSON ROAD, GOUROCK PLACE No. 1129 REVOCATION	Scale :	1:500	Date :	JULY 2012
		Prepared by :	R. MACKAY	Checked by :	
Disabled Bays	71 EAST HAMILTON STREET GREENOCK, PA15 2UA	Drawn by :	R. MACKAY	Approved by :	
		Drawing No. :		File No. :	19/12

Reproduced from Ordnance Survey mapping with the permission of Ordnance Survey. All rights reserved. Copyright © Ordnance Survey. Unauthorised reproduction infringes Crown Copyright and may result in prosecution or legal proceedings.

Licence No. LA03097L

Ordnance Survey

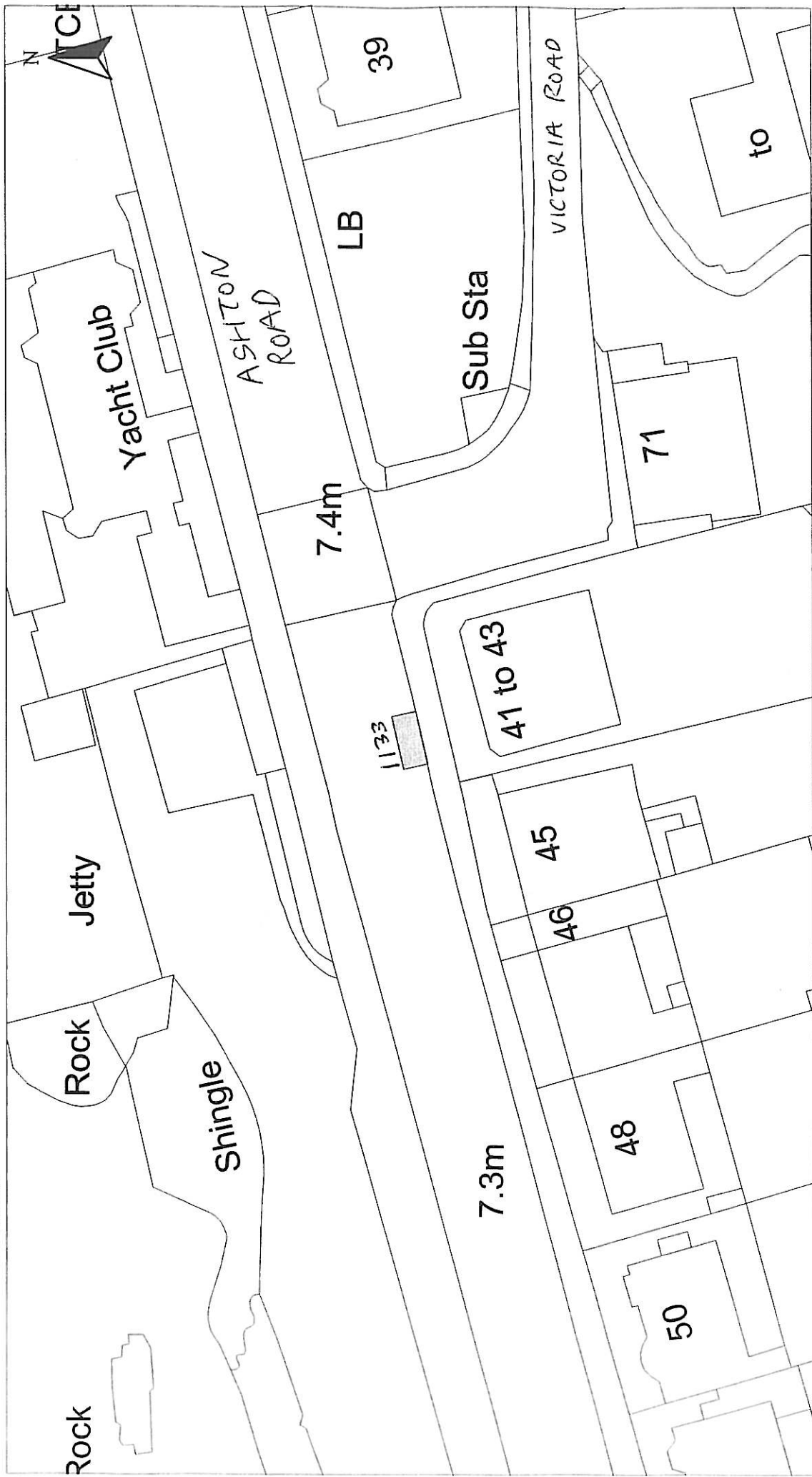

<p>HEAD OF SERVICE IAN MOFFAT</p>	<p>Scale : 1:500 Prepared by : R. MACKAY Drawn by : R. MACKAY Drawing No. :</p>	<p>Date : JULY 2012 Checked by : Approved by : File No. : 19/12</p>
<p>Disabled Bays</p>	<p><b>DISABLED PERSONS' PARKING PLACE</b> 43 ASHTON ROAD, GOUROCK PLACE No. 1133 REVOCATION</p>	
<p>Reproduced from Ordnance Survey mapping with the permission of the Controller of Her Majesty's Stationery Office. Crown Copyright. Unauthorised reproduction infringes Crown Copyright and may result in prosecution or legal proceedings.</p> <p>Licence No. LA03097L</p>  <p>Ordnance Survey</p>		