Report To: ENVIRONMENT & REGENERATION COMMITTEE **Date:** 7 MARCH 2013

Report By: CORPORATE DIRECTOR,
ENVIRONMENT, REGENERATION &
RESOURCES **Report No:** LA/957/13

Contact Officer: JOANNA DALGLEISH **Contact No:** 01475 712123

Subject: PROPOSED TRAFFIC REGULATION ORDER – DISABLED PERSONS’ PARKING PLACES (ON STREET) ORDER NO 4 2012

1.0 PURPOSE

- 1.1 Local Authorities are empowered to make Orders under the Road Traffic Regulation and Roads (Scotland) Acts 1984 and under the Council’s Scheme of Administration the Head of Environmental & Commercial Services is responsible for the making, implementation and review of Traffic Management Orders and Traffic Regulation Orders.

2.0 BACKGROUND

- 2.1 In order to comply with the Disabled Persons’ Parking Places (Scotland) Act 2009, Section 5, it is proposed to introduce a Traffic Regulation Order to accompany the provision of parking bays for the disabled. This will restrict parking to drivers displaying a Blue Badge only, and will enable the Police to enforce such restrictions.
- 2.2 The proposals have been advertised in the Greenock Telegraph and Paisley Express and full details of the proposals have been made available for public inspection during normal office hours at the offices of the Head of Environmental & Commercial Services, the Head of Legal & Democratic Services and at Central, Port Glasgow, Gourock and Kilmacolm Library. A copy of the draft Order is appended hereto for Members’ information.
- 2.3 No objections to the proposals have been received and, accordingly, the Committee is requested to approve the Order.
- 2.4 The Committee is asked to note that, if approved, the Order may not be implemented until the making of the Order has been advertised to allow any persons who so wish a period of six weeks to question the validity of the Order in terms of the Road Traffic Regulation Act 1984.

Appendix

3.0 RECOMMENDATION

- 3.1 That the Committee recommend to The Inverclyde Council the making of the Traffic Regulation Order – Disabled Persons’ Parking Places (On Street) Order No 4 2012 and remit it to the Head of Environmental & Commercial Services and Head of Legal & Democratic Services to arrange for its implementation.

Legal & Democratic Services

THE INVERCLYDE COUNCIL
DISABLED PERSONS' PARKING PLACES
(ON STREET) ORDER NO. 4 2012
TRAFFIC REGULATION ORDER

DRAFT

THE INVERCLYDE COUNCIL

DISABLED PERSONS' PARKING PLACES (ON STREET)

ORDER NO. 4 2012

The Inverclyde Council in exercise of the powers conferred on them by Sections 32(1) of the Road Traffic Regulation Act 1984 ("the Act") and of all other enabling powers and after consultation with the Chief Constable of Strathclyde Police in accordance with Part III of Schedule 9 to the Act hereby make the following Order.

1. This Order may be cited as "The Inverclyde Council Disabled Persons' Parking Places (On Street) Order No. 4 2012 and shall come into operation on ##
2. In this Order the following expressions have the meanings hereby assigned to them:
 - "vehicle" unless the context otherwise requires, means a vehicle of any description and includes a machine or implement of any kind drawn or propelled along roads whether or not by mechanical power;
 - "parking place" means a place where a vehicle, or vehicles of any class, may wait i.e. the area of land specified in the Schedule for which the use as a parking place has been authorised by the Council under Section 32(1) of the Act;
 - "sign" means a traffic sign;
 - "disabled person's badge" means:
 - (a) a badge issued under Section 21 of the Chronically Sick and Disabled Persons Act 1970;
 - (b) a badge issued under a provision of the law of Northern Ireland corresponding to that section; or
 - (c) a badge issued by any member State other than the United Kingdom for purposes corresponding to the purposes for which badges under that section are issued;
 - "disabled person's vehicle" means a vehicle lawfully displaying a disabled person's badge;
 - "Council" means The Inverclyde Council;
3. Each area of road which is described in the Schedule and plans relative to this Order is hereby designated as a parking place.
4. The parking places designated in this Order shall only be used for the leaving of disabled persons' vehicles displaying a valid disabled person's badge.

5. The limits of each parking place designated in this Order shall be indicated on the carriageway as prescribed by The Traffic Signs Regulations and General Directions 2002.
6. Every vehicle left in any parking place designated in this Order shall stand such that no parking place is occupied by more than one vehicle and that every part of the vehicle is within the limits of the parking place provided that, where the length of a vehicle precludes compliance with this paragraph, such vehicle shall be deemed to be within the limits of a parking place if;
 - i. the extreme front portion or, as the case may be, the extreme rear portion of the vehicle is within 300mm of an indication on the carriageway provided under this Order in relation to the parking place; and
 - ii. the vehicle, or any part thereof, is not within the limits of any adjoining parking place.
7. Any person duly authorised by the Council or a police officer in uniform or a traffic warden or parking attendant may move or cause to be moved in case of any emergency, to any place they think fit, vehicles left in a parking place.
8. Any person duly authorised by the Council may suspend the use of a parking place or any part thereof whenever such suspension is considered reasonably necessary:
 - i. for the purpose of facilitating the movement of traffic or promoting its safety;
 - ii. for the purpose of any building operation, demolition, or excavation in or adjacent to the parking place or the laying, erection, alteration, removal or repair in or adjacent to the parking place of any sewer or of any main, pipe, apparatus for the supply of gas, water electricity or of any telecommunications apparatus, traffic sign or parking meter;
 - iii. for the convenience of occupiers of premises adjacent to the parking place on any occasion of the removal of furniture from one office or dwellinghouse to another or the removal of furniture from such premises to a depository or to such premises from a depository;
 - iv. on any occasion on which it is likely by reason of some special attraction that any street will be thronged or obstructed; or
 - v. for the convenience of occupiers of premises adjacent to the parking place at times of weddings or funerals or on other special occasions.
9. A police officer in uniform may suspend for not longer than twenty four hours the use of a parking place or part thereof whenever such suspension is considered reasonably necessary for the purpose of facilitating the movement of traffic or promoting its safety.

10. This Order insofar as it relates to the parking places to be revoked (R) and amended, as specified in the Schedule to this Order, partially revokes and amends the On Street Parking Places (Without Charges) Orders No. 2 2002 and No. 1 2009 and the Disabled Persons' Parking Places (On Street) Orders No. 2 2011 and No. 4 2011 respectively.

Sealed with the Common Seal of The Inverclyde Council and subscribed for them and on their behalf by ##

DRAFT

INVERCLYDE COUNCIL

**DISABLED PERSONS' PARKING PLACES (ON STREET)
ORDER NO. 4 2012**

**Statement of Reasons for Proposing to Make
the Above Order**

It is considered necessary to make the above Order to provide assistance for disabled persons who hold a badge under the Disabled Persons (Badges for Motor Vehicles) (Scotland) Regulations 2000 as amended and by revoking those parking places no longer required to maximise street parking capacity.

DRAFT

INVERCLYDE COUNCIL

DISABLED PERSONS' PARKING PLACES (ON-STREET) ORDER No.4 2012

SCHEDULE

Rev A

All and whole that area of ground as described in Column 2 in the table below:

<u>Ref No.</u>	<u>Address of Disabled Person's Parking Place to be created or revoked @ "ex-adverso"</u>
1179	104 Braeside Road, Greenock
1202	28 Stafford Road, Greenock
1205	4 Staffa Avenue, Port Glasgow
1215	16A Kelburn Terrace, Port Glasgow
1218	28 Patrick Street, Greenock
1221	94 Fancy Farm Road, Greenock
1222	2 Adelaide Street, Gourock
1223	14 Leperstone Avenue, Kilmacolm
1225	45 Kilmacolm Road, Greenock
1229	18 Larkfield Grove, Greenock
1230	86 Nairn Road, Greenock
1231	22a Ardgowan Square, Greenock
1298	19D St John's Road, Gourock
1299	1 Nicol Street, Greenock
0151	15 Quarry Drive, Kilmacolm ®
0898	12 North Road, Port Glasgow ®
1080	73 Fancy Farm Road, Greenock ®
1129	60 Nelson Road, Gourock ®
1133	43 Ashton Road, Gourock ®



HEAD OF SERVICE
IAN MOFFAT

Disabled Bays
71 EAST HAMILTON STREET
GREENOCK, PA15 2UA

Reproduced from Ordnance Survey mapping with the permission of the Controller of Her Majesty's Stationery Office. Crown Copyright. Unauthorised reproduction infringes Crown Copyright and may result in prosecution or legal proceedings.

Licence No. LA03097L

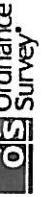

DISABLED PERSONS' PARKING PLACE

104 BRAESIDE ROAD, GREENOCK

PLACE No. 1179

Scale : 1:500

Prepared by : R. MACKAY

Drawn by : R. MACKAY

Drawing No. : 19/12

Date : JULY 2012

Checked by :

Approved by :

File No. :

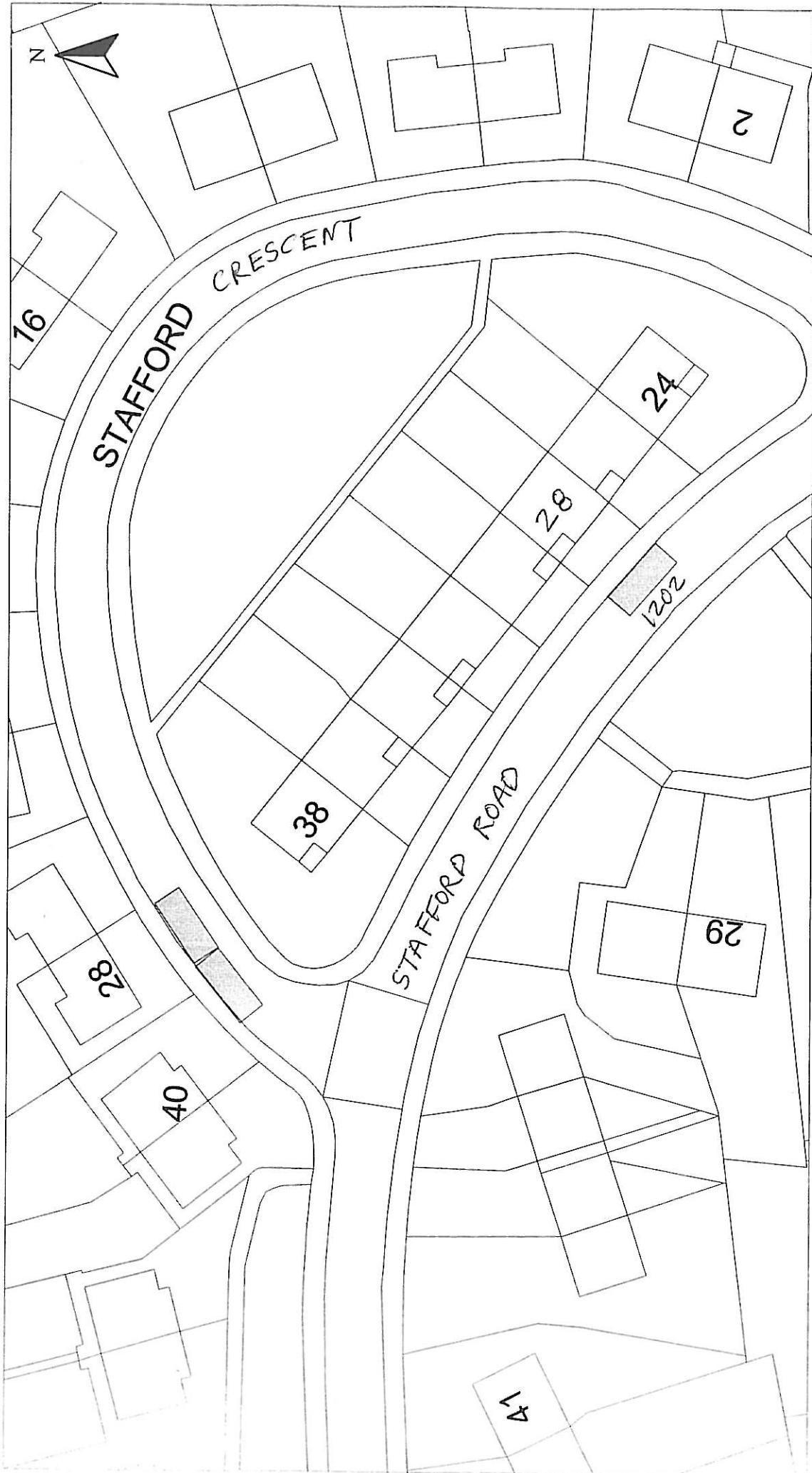

Scale :	1:500	Date :	OCT 2012
Prepared by :	R. MACKAY	Checked by :	
Drawn by :	R. MACKAY	Approved by :	
Drawing No. :		File No. :	19/12

DISABLED PERSONS' PARKING PLACE
28 STAFFORD ROAD, GREENOCK
PLACE No. 1202

Reproduced from Ordnance Survey mapping with the permission of the Controller of Her Majesty's Stationery Office. Ordnance Survey is a registered trademark of Ordnance Survey. Copyright. Unauthorised reproduction infringes Ordnance Survey's Copyright and may result in prosecution or legal proceedings.

Licence No. LA03097L

HEAD OF SERVICE
IAN MOFFAT

71 EAST HAMILTON STREET
GREENOCK, PA15 2UA

1202/28/2012



HEAD OF SERVICE
IAN MOFFAT

71 EAST HAMILTON STREET
GREENOCK, PA15 2JA

Disabled Bays

Reproduced from Ordnance Survey mapping with the permission
of the Controller of Her Majesty's Stationery Office. Crown
Copyright. Unauthorised reproduction infringes Crown Copyright
and may result in prosecution or legal proceedings.

Licence No. LA03097L



DISABLED PERSONS' PARKING PLACE
4 STAFFA AVENUE, PORT GLASGOW
PLACE No. 1205

Scale : 1:500

Prepared by : R. MACKAY

Drawn by : R. MACKAY

Checked by :

Approved by :

Drawing No. :

Date : JULY 2012

Checked by :

Approved by :

File No. : 19/12

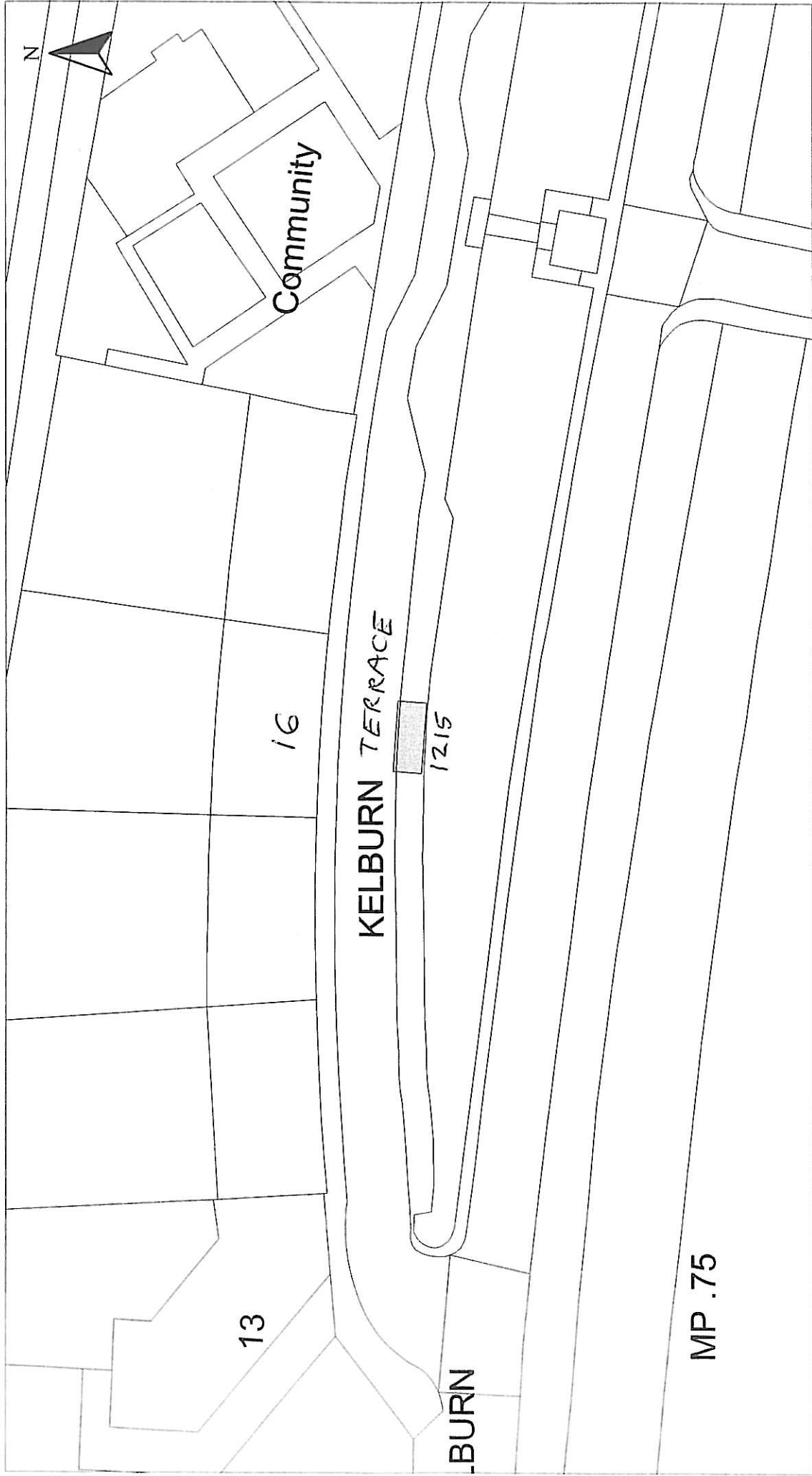

HEAD OF SERVICE
IAN MOFFAT

Disabled Bays
71 EAST HAMILTON STREET
GREENOCK, PA15 2UA

Reproduced from Ordnance Survey mapping with the permission of Ordnance Survey. All Rights Reserved. Ordnance Survey is a registered trademark of Ordnance Survey. Copyright. Unauthorised reproduction infringes Crown Copyright and may result in prosecution or legal proceedings.

Licence No. LA039097L

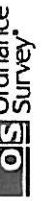

DISABLED PERSONS' PARKING PLACE
16A KELBURN TERRACE, PORT GLASGOW
PLACE No. 1215

Scale : 1:500

Prepared by : R. MACKAY

Drawn by : R. MACKAY

Drawing No. :

Date : JULY 2012

Checked by :

Approved by :

File No. : 19/12

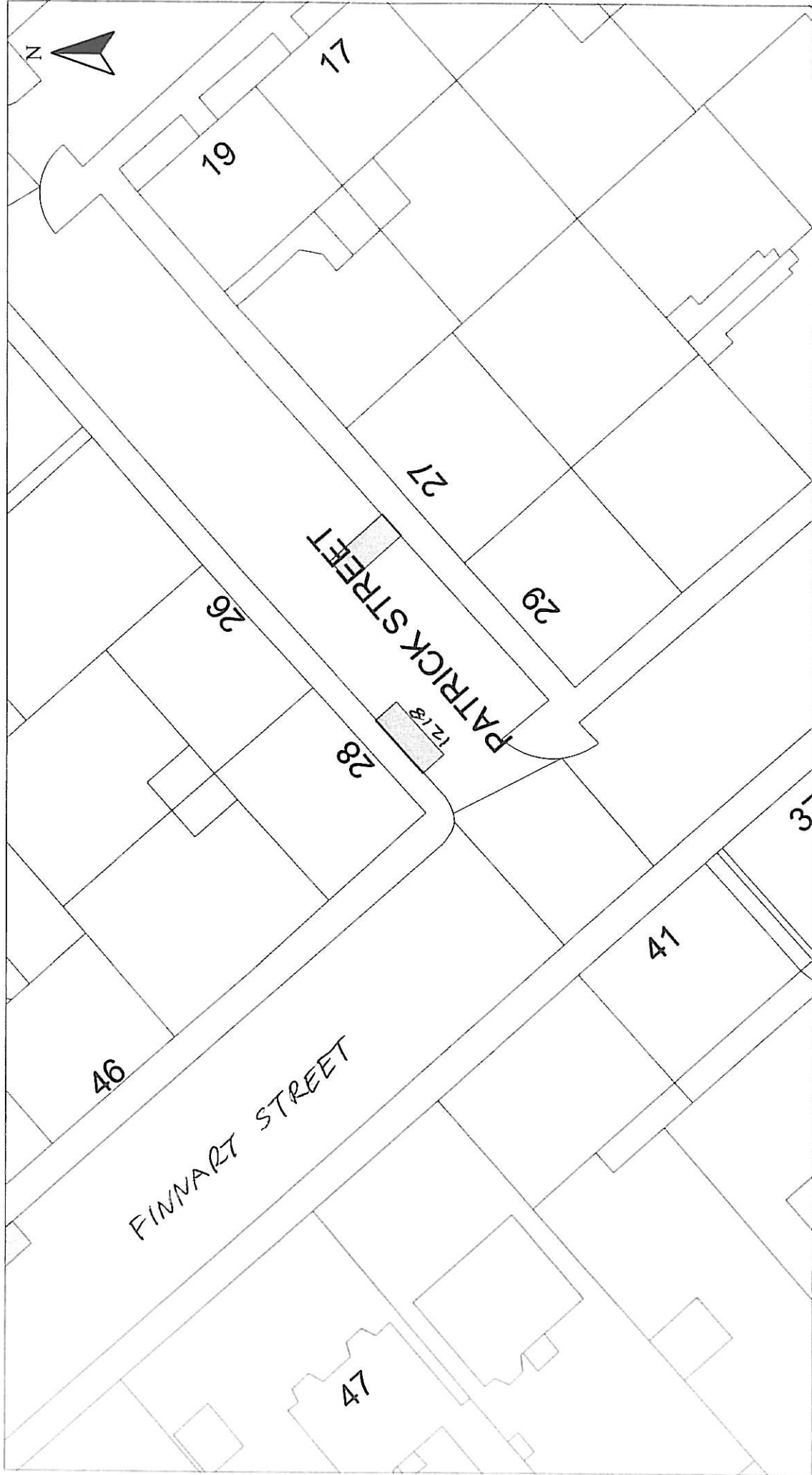

HEAD OF SERVICE
IAN MOFFAT

Disabled Bays
71 EAST HAMILTON STREET
GREENOCK, PA15 2UA

Reproduced from Ordnance Survey mapping with the permission of the Controller of Her Majesty's Stationery Office. Crown Copyright. Unauthorised reproduction infringes Crown Copyright and may result in prosecution or legal proceedings.

Licence No. LA03097L

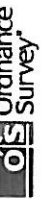

DISABLED PERSONS' PARKING PLACE
28 PATRICK STREET, GREENOCK
PLACE No. 1218

Scale : 1:500

Prepared by : R. MACKAY

Drawn by : R. MACKAY

Drawing No. : 19/12

Date : JULY 2012

Checked by :

Approved by :

File No. :

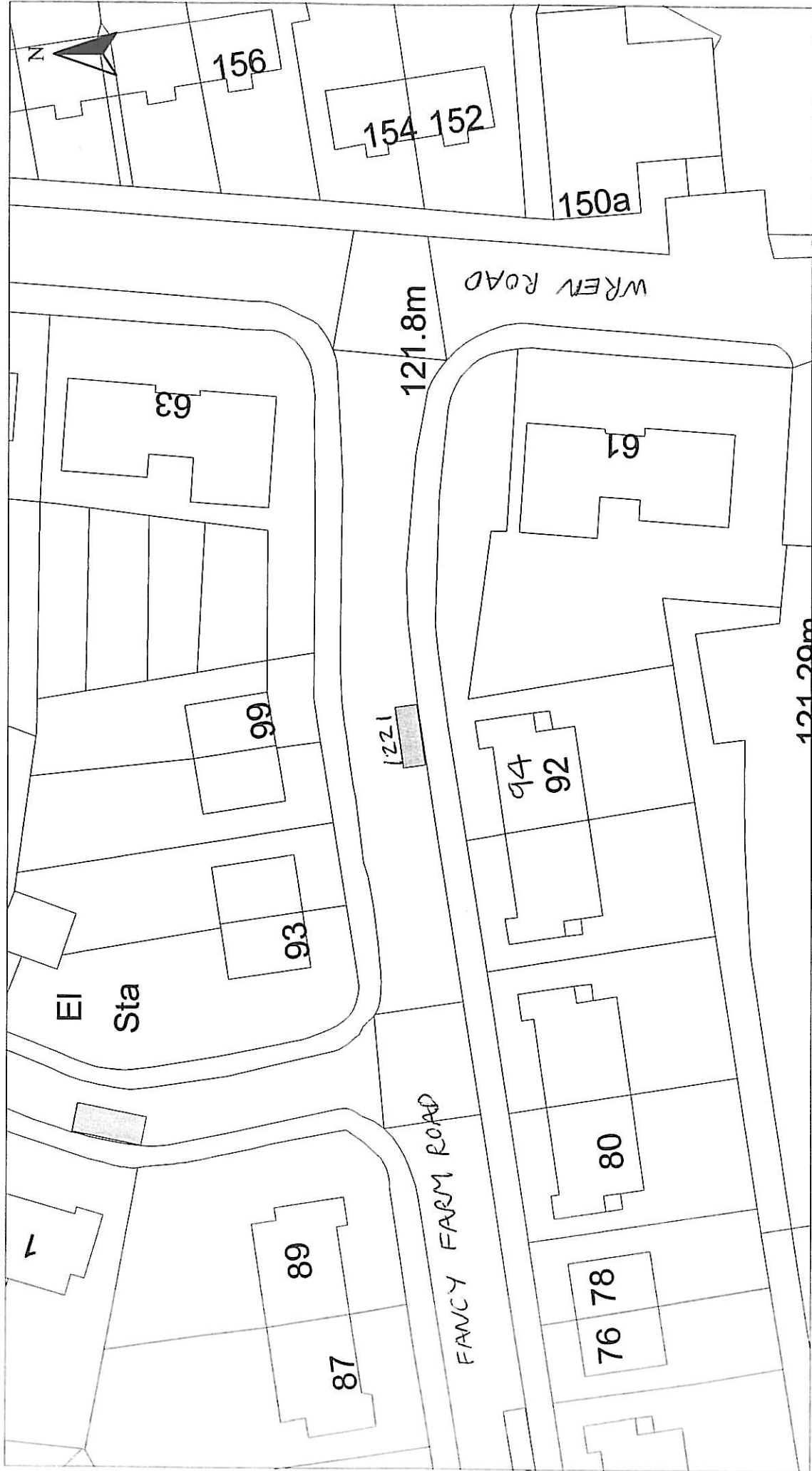

HEAD OF SERVICE
IAN MOFFAT

71 EAST HAMILTON STREET
GREENOCK, PA15 2UA

DISABLED PERSONS' PARKING PLACE
94 FANCY FARM ROAD, GREENOCK
PLACE No. 1221

Reproduced from Ordnance Survey mapping with the permission of the Controller of Her Majesty's Stationery Office. Crown Copyright and may result in prosecution or legal proceedings.

Licence No. LA03097L

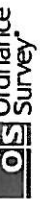

Scale : 1:500

Prepared by : R. MACKAY

Drawn by : R. MACKAY

Checked by :

Approved by :

File No. : 19/12

Date : JULY 2012

Disabled Bays

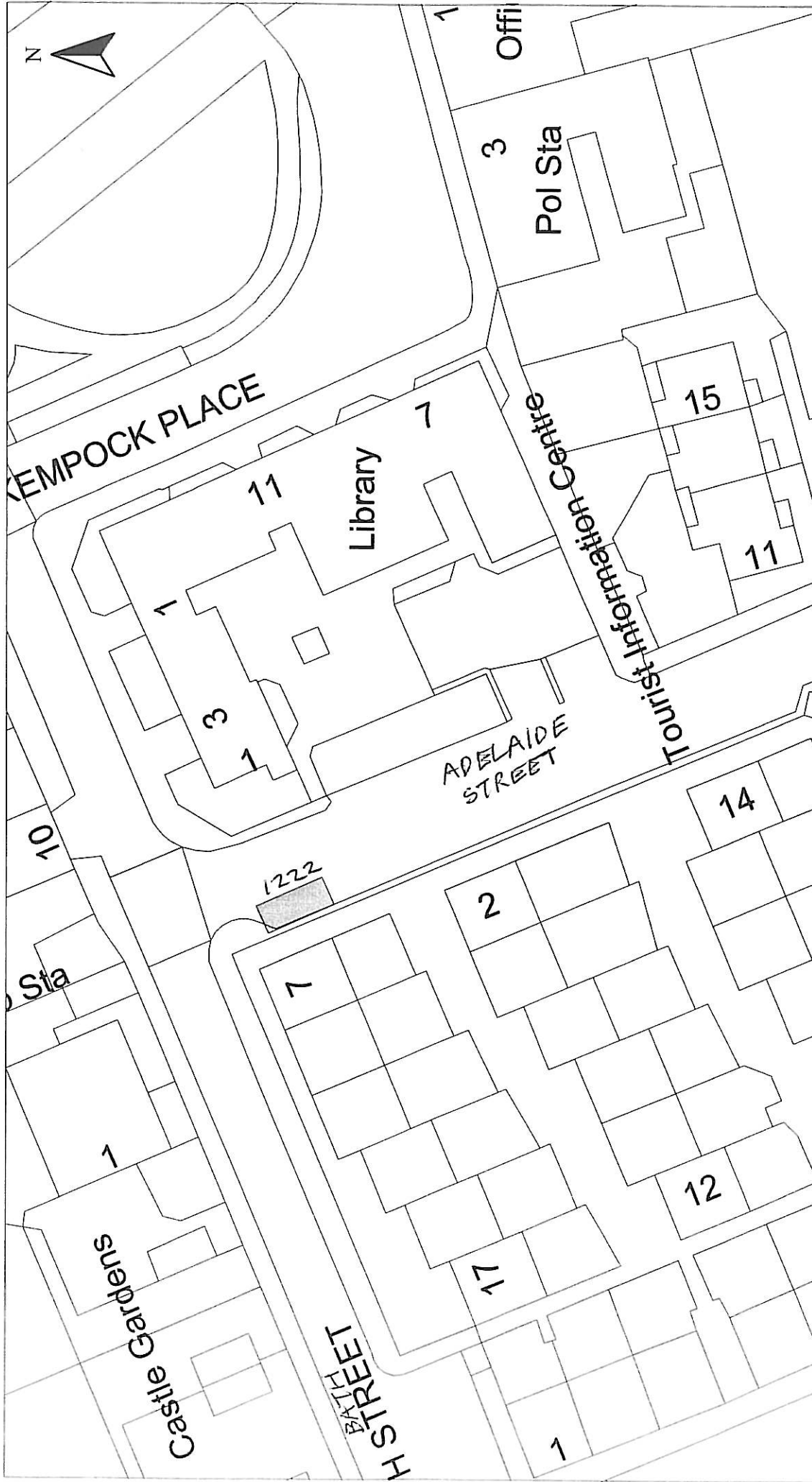

HEAD OF SERVICE
IAN MOFFAT

71 EAST HAMILTON STREET
GREENOCK, PA15 2UA

Disabled Bays

Reproduced from Ordnance Survey mapping with the permission of the Controller of Her Majesty's Stationery Office. Crown Copyright. Unauthorised reproduction infringes Crown Copyright and may result in prosecution or legal proceedings.

Licence No. LA03097L

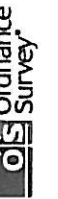

DISABLED PERSONS' PARKING PLACE

2 ADELAIDE STREET, GOUROCK

PLACE No. 1222

Scale : 1:500

Prepared by : R. MACKAY

Drawn by : R. MACKAY

Drawing No. : 19/12

Date : JULY 2012

Checked by :

Approved by :

File No. :

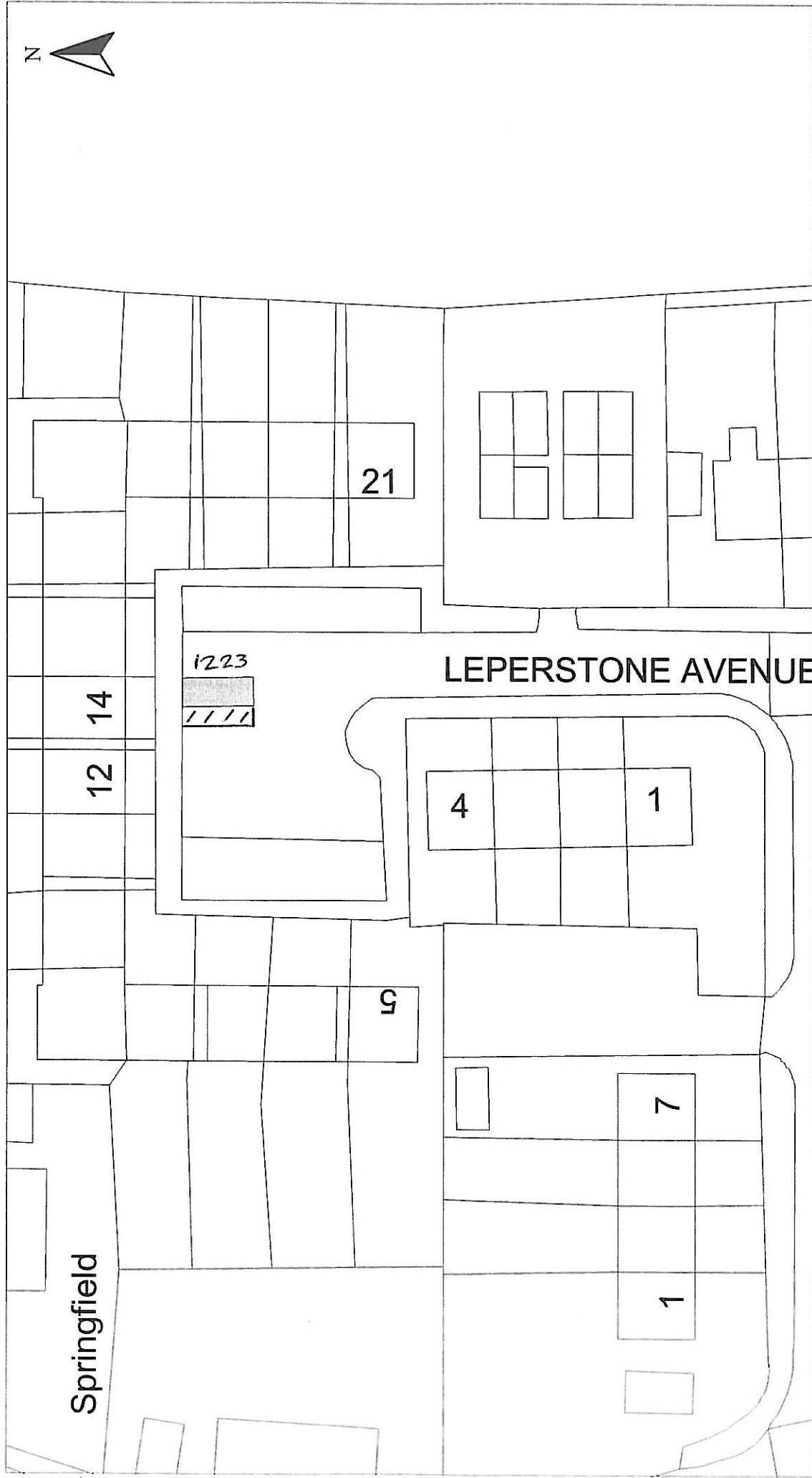

HEAD OF SERVICE
IAN MOFFAT

71 EAST HAMILTON STREET
GREENOCK, PA15 2UA

Reproduced from Ordnance Survey mapping with the permission of the Controller of Her Majesty's Stationery Office. Ordnance Survey is a registered trademark of Ordnance Survey Limited. All rights reserved. Use of this information in any form without the prior written permission of Ordnance Survey may result in prosecution or legal proceedings.

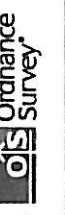

Licence No. LA03097L

DISABLED PERSONS' PARKING PLACE

14 LEPERSTONE AVENUE, KILMACOLM

PLACE No. 1223

Scale : 1:500

Prepared by : R. MACKAY

Drawn by : R. MACKAY

Drawing No. : 19/12

Date : JULY 2012

Checked by :

Approved by :

File No. :

Disabled Bays

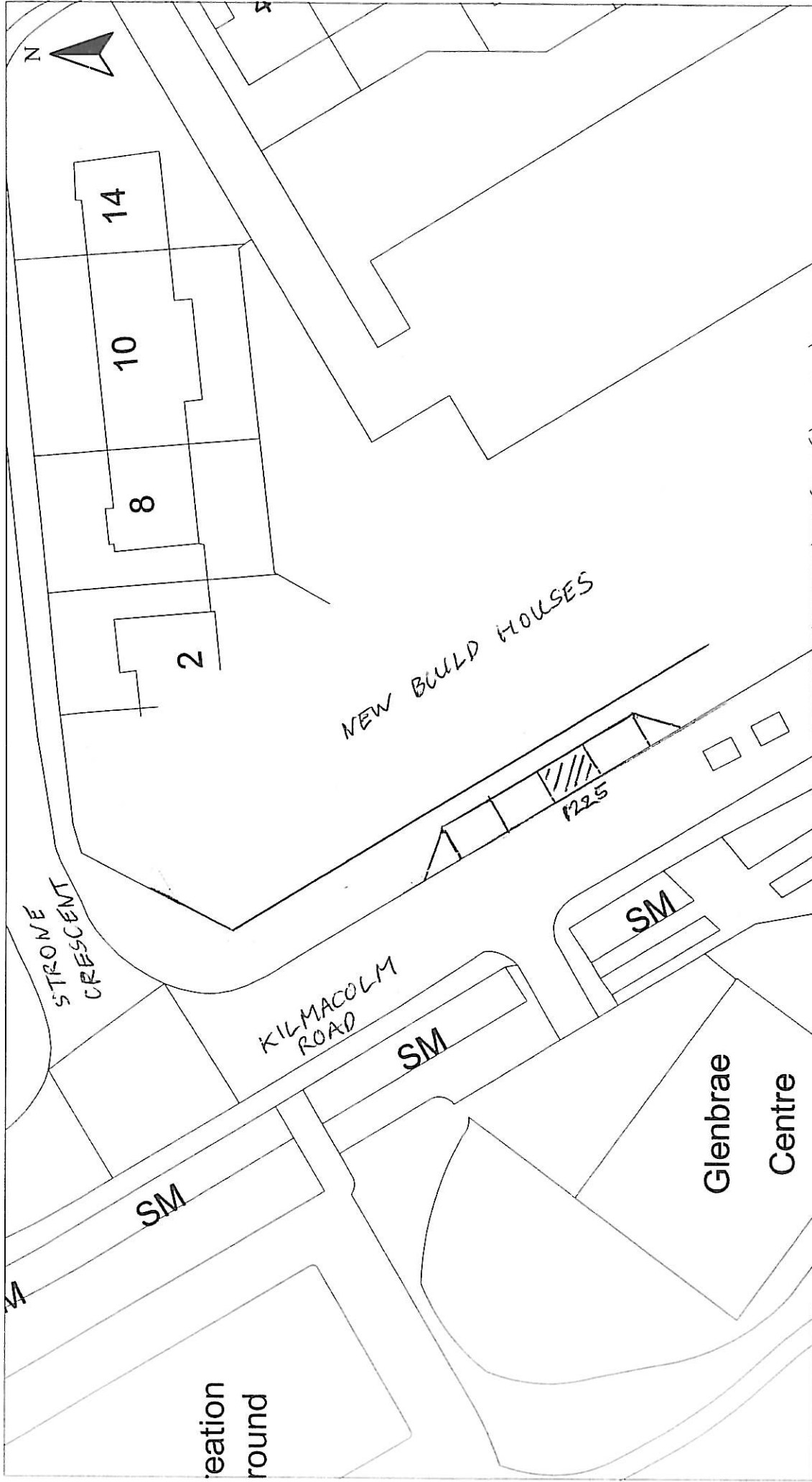

HEAD OF SERVICE
IAN MOFFAT

71 EAST HAMILTON STREET
GREENOCK, PA15 2UA

Reproduced from Ordnance Survey mapping with the permission
of the Controller of Her Majesty's Stationery Office. Crown
copyright and related rights reserved. Ordnance Survey
and may result in prosecution of legal proceedings.

Licence No. LA03097L



DISABLED PERSONS' PARKING PLACE

45 KILMACOLM ROAD, GREENOCK
PLACE No. 1225

Scale : 1:500

Prepared by : R. MACKAY

Drawn by : R. MACKAY

Checked by :

Approved by :

File No. : 19/12

Date : SEP 2012

Disabled Bays

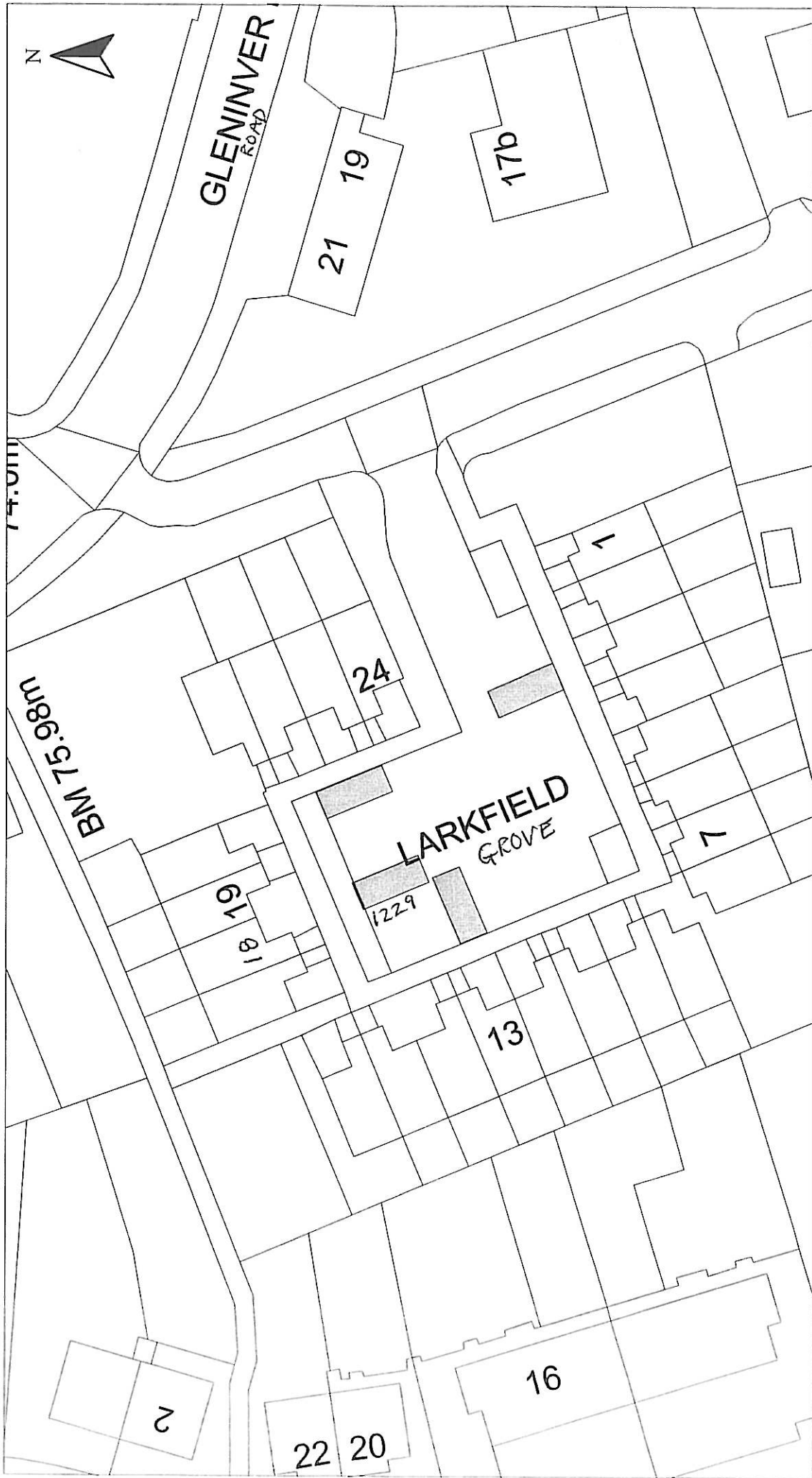

HEAD OF SERVICE
IAN MOFFAT

Disabled Bays
71 EAST HAMILTON STREET
GREENOCK, PA15 2UA

Reproduced from Ordnance Survey mapping with the permission of Ordnance Survey. All Rights Reserved. © Crown Copyright and may result in prosecution or legal proceedings.
Licence No. LA03007L
Ordnance Survey

DISABLED PERSONS' PARKING PLACE
18 LARKFIELD GROVE, GREENOCK
PLACE No. 1229

Scale :	1:500	Date :	SEP 2012
Prepared by :	R. MACKAY	Checked by :	
Drawn by :	R. MACKAY	Approved by :	
Drawing No. :		File No. :	19/12

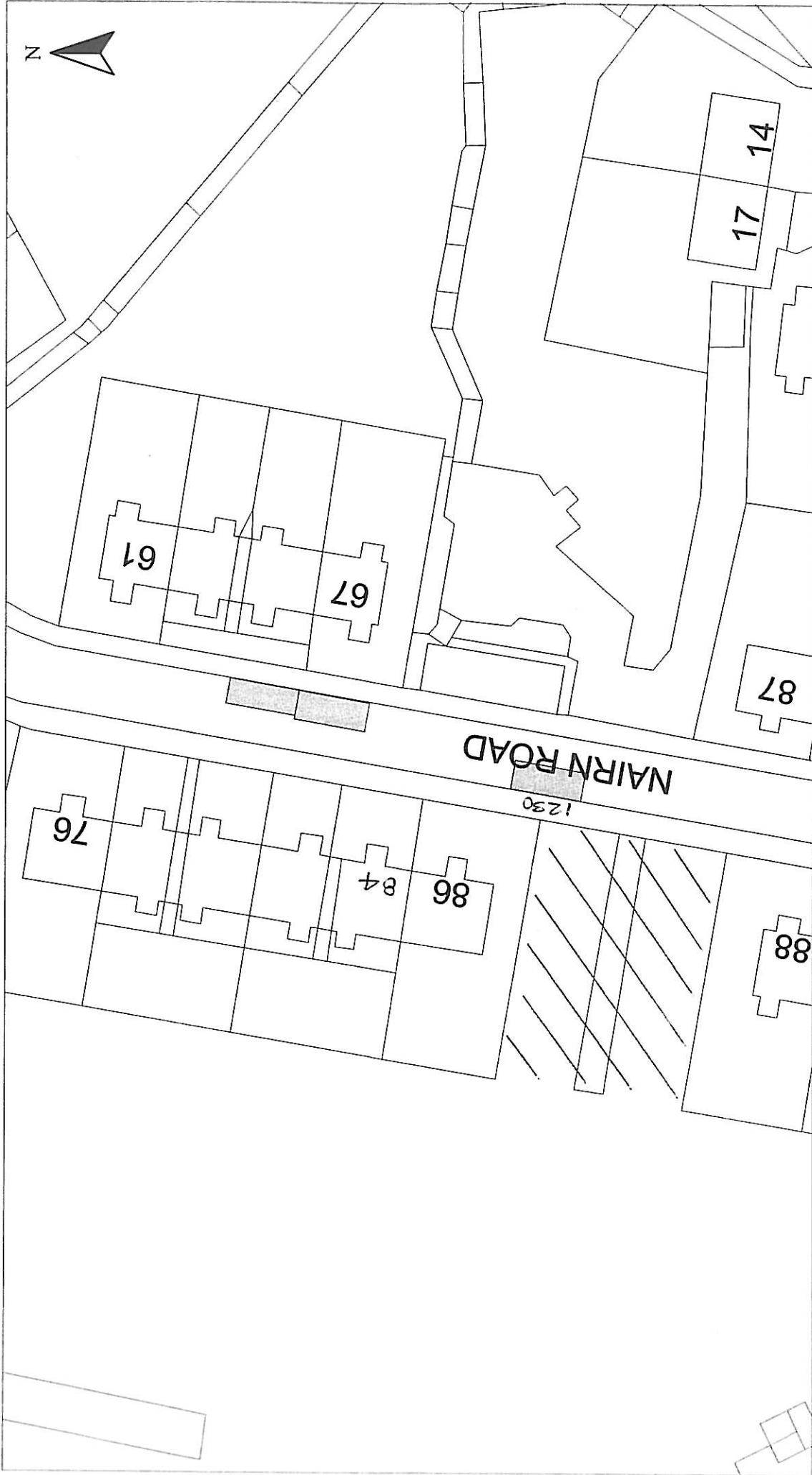

HEAD OF SERVICE
IAN MOFFAT

Disabled Bays
71 EAST HAMILTON STREET
GREENOCK, PA15 2JA

DISABLED PERSONS' PARKING PLACE

86 NAIRN ROAD, GREENOCK
PLACE No. 1230

Reproduced from Ordnance Survey mapping with the permission
of the Controller of Her Majesty's Stationery Office. Crown
Copyright. Unauthorised reproduction infringes Crown Copyright
and may result in prosecution or legal proceedings.

Licence No. LA03097L
OS Ordnance
Survey

Scale : 1:500

Prepared by : R. MACKAY

Drawn by : R. MACKAY

Drawing No. :

Date : OCT 2012

Checked by :

Approved by :

File No. : 19/12

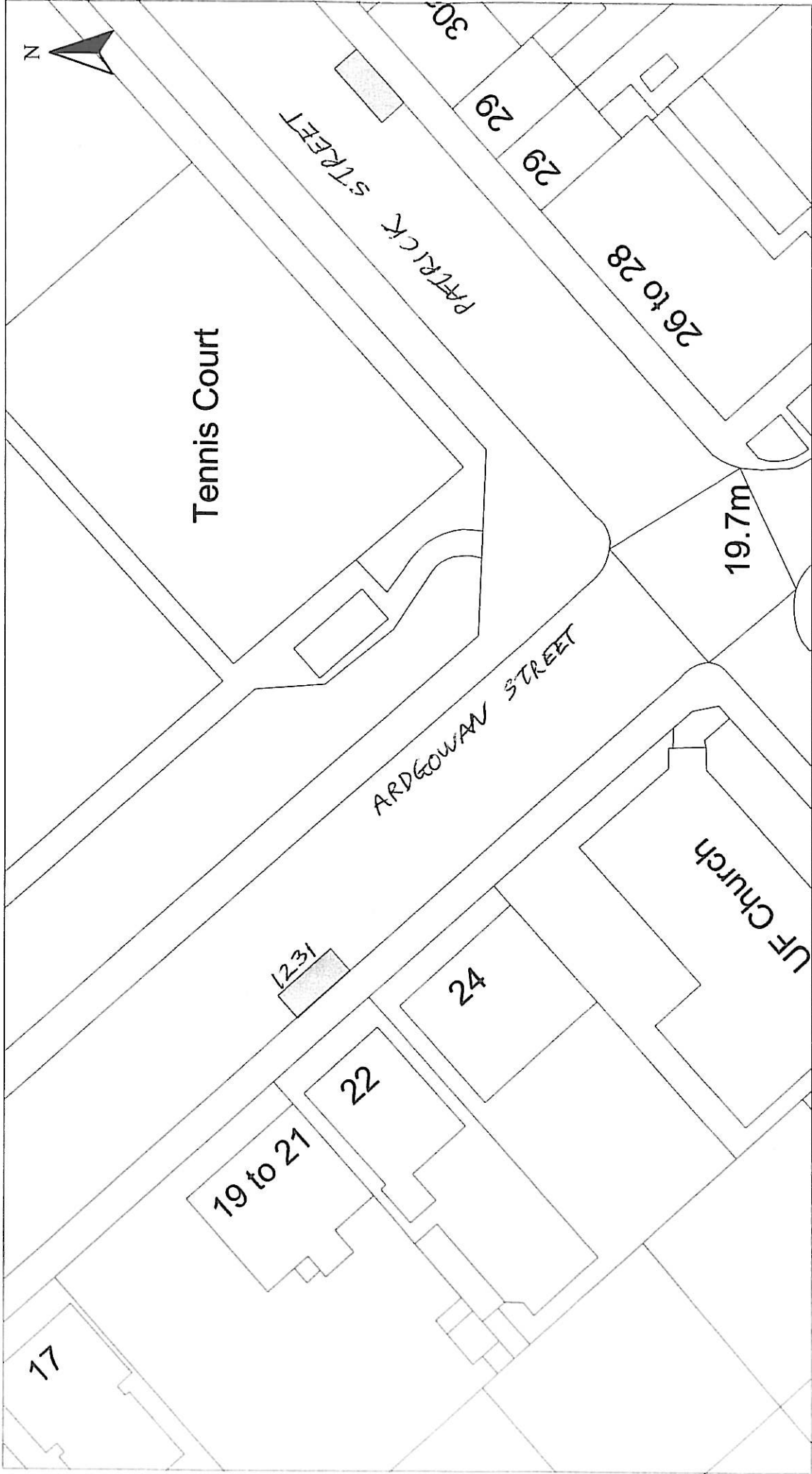

HEAD OF SERVICE
IAN MOFFAT

71 EAST HAMILTON STREET
GREENOCK, PA15 2UA

Reproduced from Ordnance Survey mapping with the permission of the Controller of Her Majesty's Stationery Office. Crown Copyright. Unauthorised reproduction infringes Crown Copyright and may result in prosecution or legal proceedings.
 Ordnance Survey
Licence No. LA03097L

DISABLED PERSONS' PARKING PLACE
22A ARDGOWAN SQUARE, GREENOCK
PLACE No. 1231

Scale : 1:500

Prepared by : R. MACKAY

Drawn by : R. MACKAY

Drawing No. :

Date : JULY 2012

Checked by :

Approved by :

File No. : 19/12

Disabled Bays

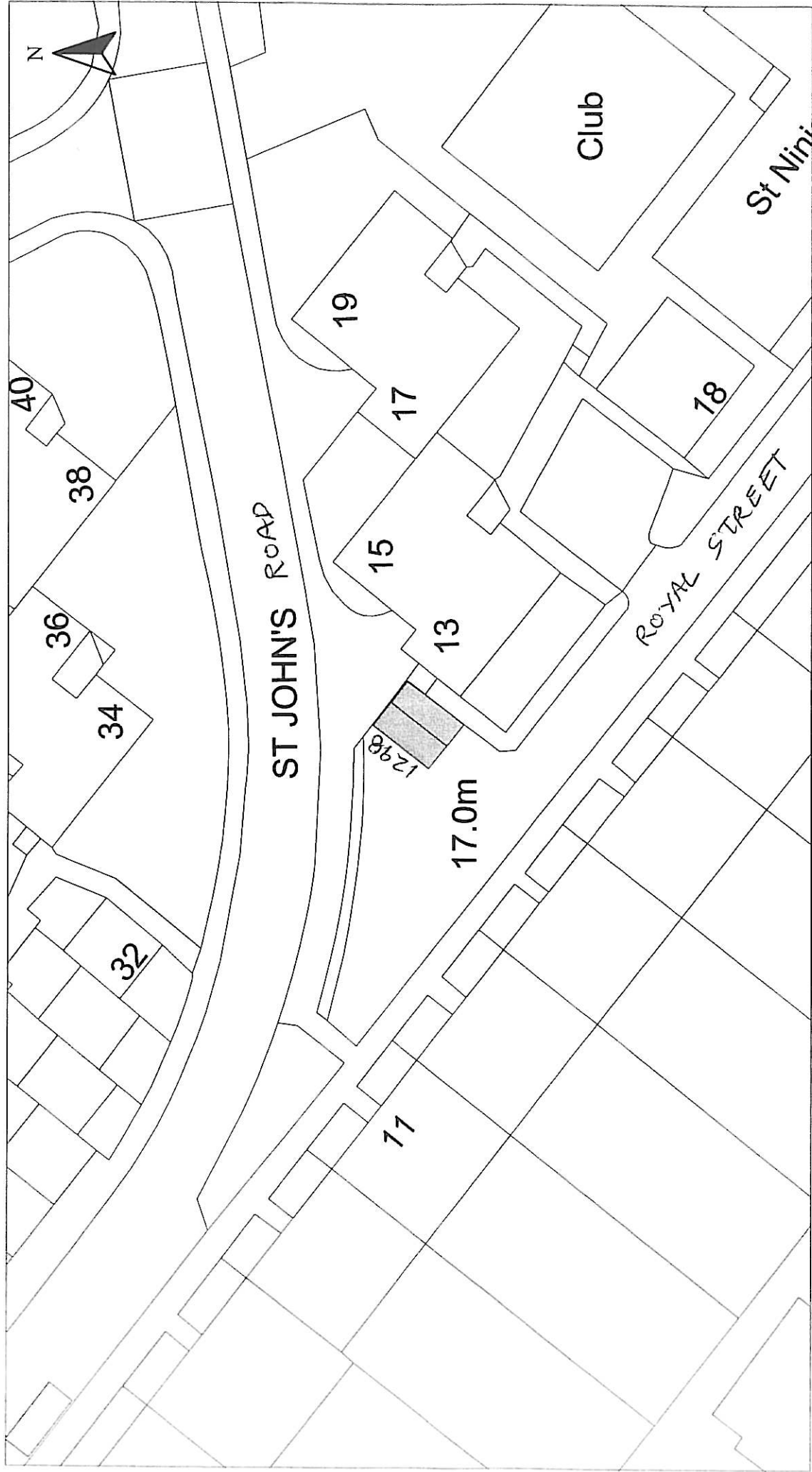

HEAD OF SERVICE
IAN MOFFAT

71 EAST HAMILTON STREET
GREENOCK, PA15 2JA

Disabled Bays

Reproduced from Ordnance Survey mapping with the permission of the Controller of Her Majesty's Stationery Office. Crown Copyright. Unauthorised reproduction infringes Crown Copyright and may result in prosecution or legal proceedings.

OS
Ordnance Survey
Licence No. LA03097L

DISABLED PERSONS' PARKING PLACE

19D St JOHN'S ROAD, GOUROCK
PLACE No. 1298

Scale : 1:500

Prepared by : R. MACKAY

Drawn by : R. MACKAY

Drawing No. : 19/12

Date : NOV 2011

Checked by :

Approved by :

File No. : 19/12

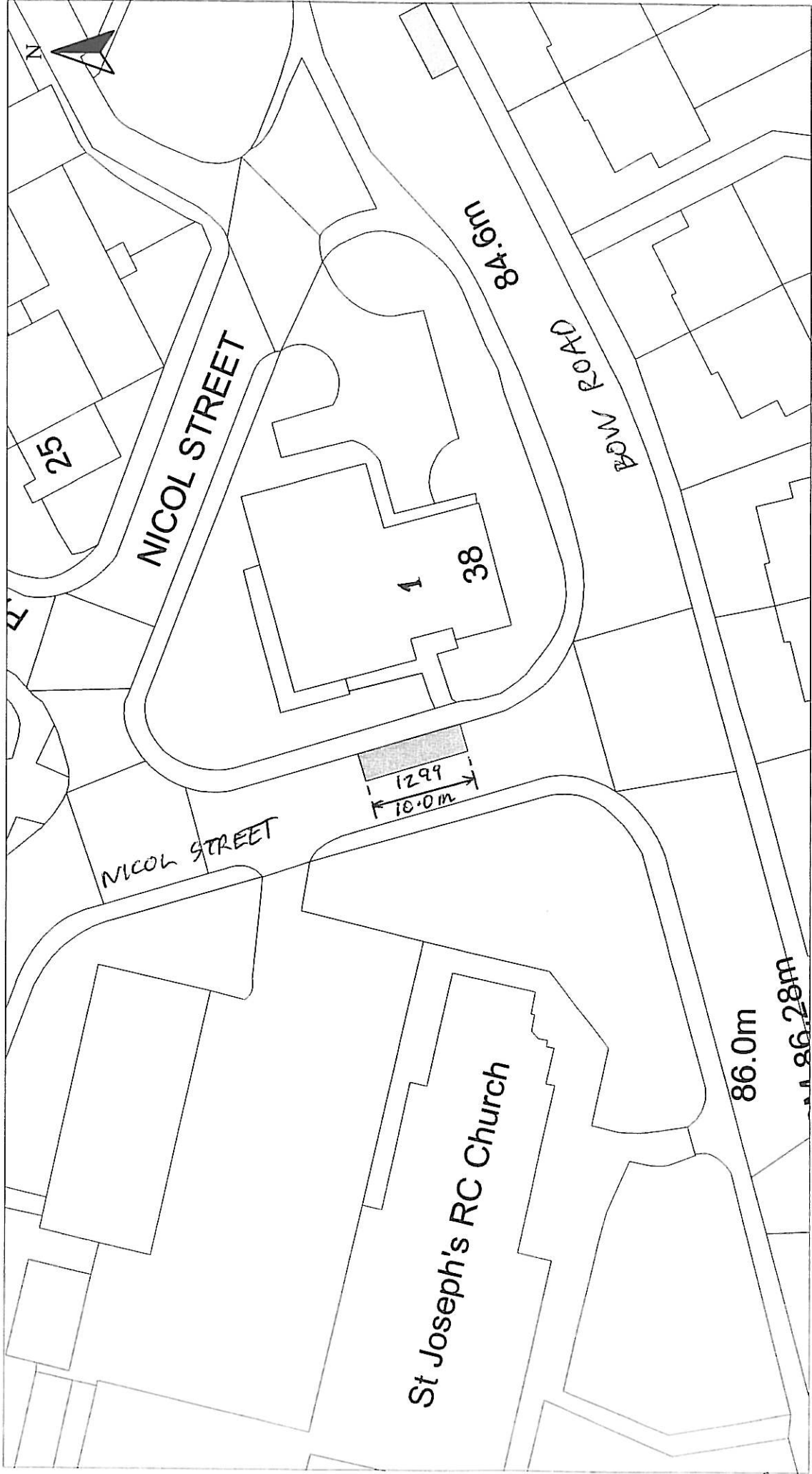

HEAD OF SERVICE
IAN MOFFAT

Disabled Bays
71 EAST HAMILTON STREET
GREENOCK, PA15 2JA

Reproduced from Ordnance Survey mapping with the permission of the Controller of Her Majesty's Stationery Office. Crown Copyright. Unauthorised reproduction infringes Crown Copyright and may result in prosecution or legal proceedings.
Ordnance Survey
Licence No. LA03097L

DISABLED PERSONS' PARKING PLACE
1 NICOL STREET, GREENOCK
PLACE No. 1299

Scale :	1:500	Date :	JULY 2012
Prepared by :	R. MACKAY	Checked by :	
Drawn by :	R. MACKAY	Approved by :	
Drawing No. :		File No. :	19/12



HEAD OF SERVICE
IAN MOFFAT

Disabled Bays
71 EAST HAMILTON STREET
GREENOCK, PA15 2UA

Reproduced from Ordnance Survey mapping with the permission of the Controller of Her Majesty's Stationery Office. Crown Copyright. Unauthorised reproduction infringes Crown Copyright and may result in prosecution or legal proceedings.
Licence No. LA03097L
Ordnance Survey

DISABLED PERSONS' PARKING PLACE
15 QUARRY DRIVE, KILMACOLM
PLACE No. 0151 REVOCATION

Scale : 1:500
Prepared by : R. MACKAY
Drawn by : R. MACKAY
Drawing No. :

Date : JULY 2012
Checked by :
Approved by :
File No. : 19/12

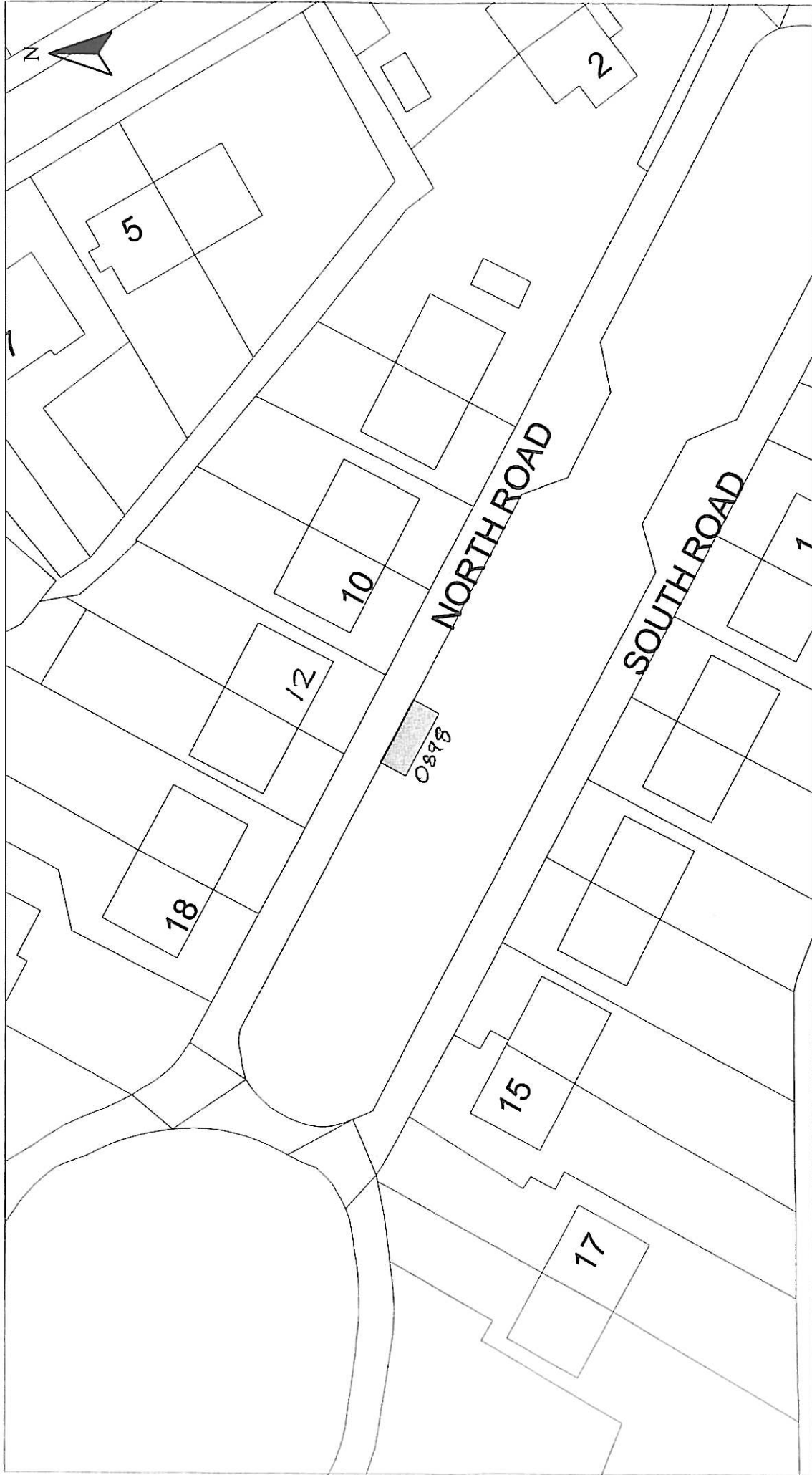

HEAD OF SERVICE
IAN MOFFAT

71 EAST HAMILTON STREET
GREENOCK, PA15 2UA

Disabled Bays

Reproduced from Ordnance Survey mapping with the permission of the Controller Her Majesty's Stationery Office. Crown Copyright. All rights reserved. No part of this publication may be reproduced in any form or by any means without prior written permission in writing from Ordnance Survey. Any use in violation of copyright may result in prosecution or legal proceedings.



Licence No. LA03097L

DISABLED PERSONS' PARKING PLACE
12 NORTH ROAD, PORT GLASGOW
PLACE No. 0898 REVOCATION

Scale : 1:500

Prepared by : R. MACKAY

Drawn by : R. MACKAY

Drawing No. : 19/12

Date : JULY 2012

Checked by :

Approved by :

File No. :

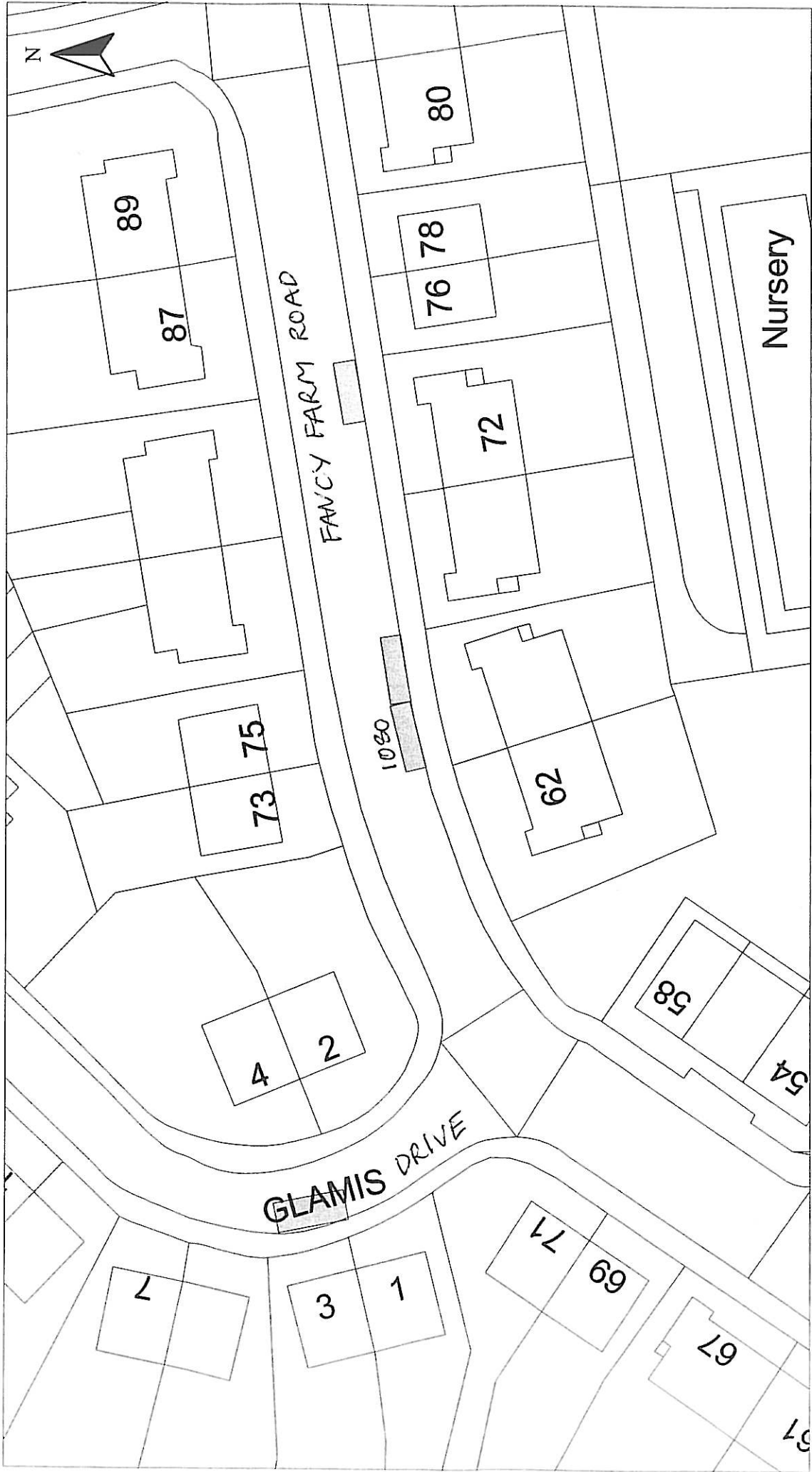

HEAD OF SERVICE IAN MOFFAT	DISABLED PERSONS' PARKING PLACE 73 FANCY FARM ROAD, GREENOCK PLACE No. 1080 REVOCATION	Scale : 1:500	Date : JULY 2012
		Prepared by : R. MACKAY	Checked by :
Disabled Bays 71 EAST HAMILTON STREET GREENOCK, PA15 2UA		Drawn by : R. MACKAY	Approved by :
		Drawing No. :	File No. : 19/12

Reproduced from Ordnance Survey mapping with the permission of the Controller of Her Majesty's Stationery Office. Crown copyright. Unauthorised reproduction infringes Crown Copyright and may result in prosecution or legal proceedings.

Ordnance Survey
Licence No. LA03097L

Inverclyde council

ENVIRONMENTAL & COMMERCIAL SERVICES



HEAD OF SERVICE IAN MOFFAT	DISABLED PERSONS' PARKING PLACE 60 NELSON ROAD, GOUROCK PLACE No. 1129 REVOCATION	Scale :	1:500	Date :	JULY 2012
		Prepared by :	R. MACKAY	Checked by :	
Disabled Bays 71 EAST HAMILTON STREET GREENOCK, PA15 2UA		Drawn by :	R. MACKAY	Approved by :	
		Drawing No. :		File No. :	19/12

Reproduced from Ordnance Survey mapping with the permission of Ordnance Survey. All rights reserved. Copyright © Ordnance Survey. Unauthorised reproduction infringes Crown Copyright and may result in prosecution or legal proceedings.

Licence No. LA03097L

Ordnance Survey

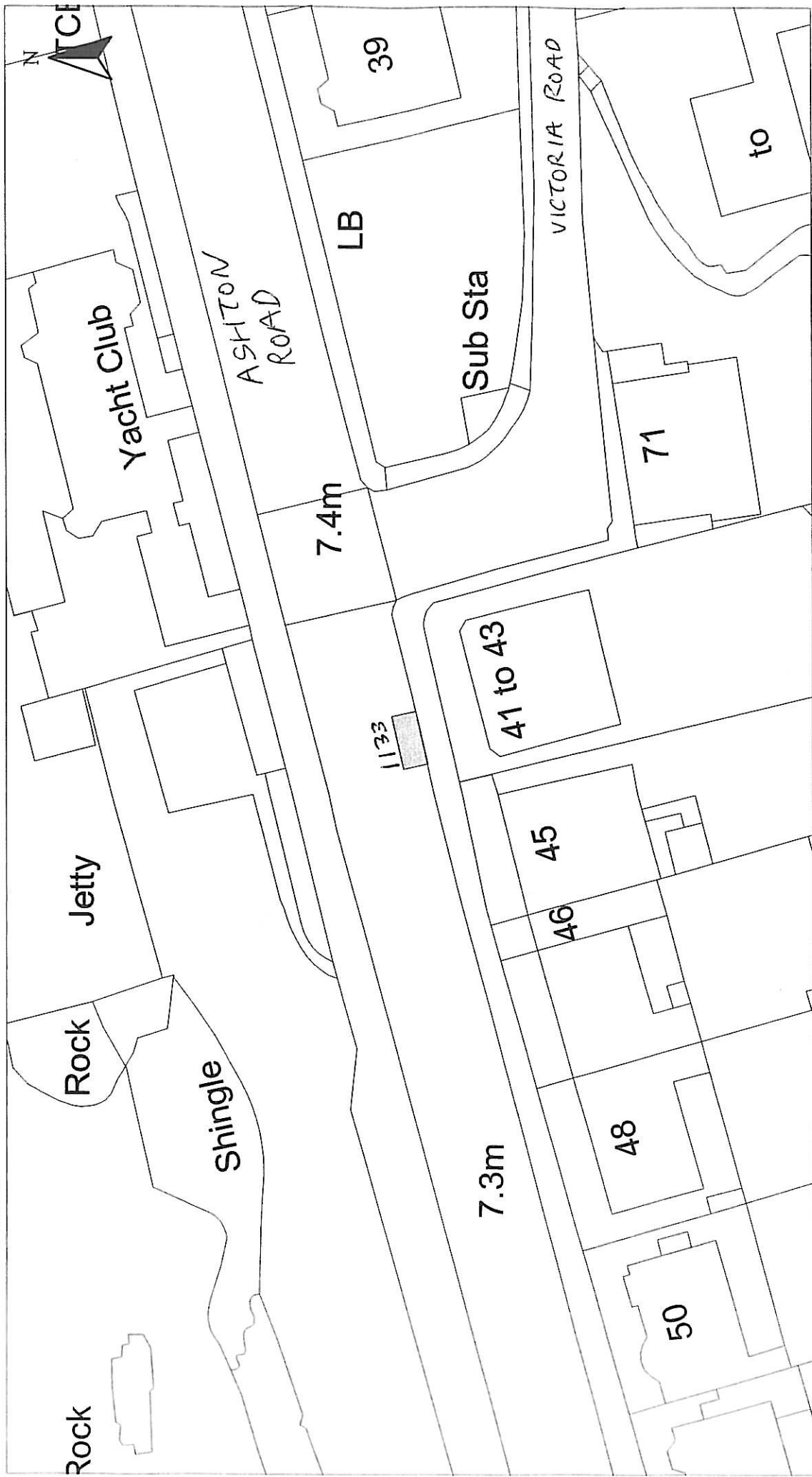

HEAD OF SERVICE IAN MOFFAT	71 EAST HAMILTON STREET GREENOCK, PA15 2UA	DISABLED PERSONS' PARKING PLACE		Scale : 1:500	Date : JULY 2012
		43 ASHTON ROAD, GOUROCK PLACE No. 1133 REVOCATION		Prepared by : R. MACKAY	Checked by :
Disabled Bays				Drawn by : R. MACKAY	Approved by :
				Drawing No. :	File No. : 19/12

Reproduced from Ordnance Survey mapping with the permission of the Controller of Her Majesty's Stationery Office. Crown Copyright. Unauthorised reproduction infringes Crown Copyright and may result in prosecution or legal proceedings.

Licence No. LA03097L

Ordnance Survey