

---

<b>Report To:</b>	<b>THE INVERCLYDE COUNCIL</b>	<b>Date:</b> 4 OCT 2012
<b>Report By:</b>	<b>CORPORATE DIRECTOR ENVIRONMENT, REGENERATION &amp; RESOURCES</b>	<b>Report No:</b> LA/897/12
<b>Contact Officer:</b>	<b>CAROLINE SHAW</b>	<b>Contact No:</b> 01475 712115
<b>Subject:</b>	<b>PROPOSED TRAFFIC REGULATION ORDER – DISABLED PERSONS PARKING PLACES (ON STREET) ORDER NO. 1 2012</b>	

---

## 1.0 PURPOSE

- 1.1 The purpose of the report is to introduce Traffic Regulation Order – Disabled Persons' Parking Places (On Street) Order No. 1 2012.

## 2.0 SUMMARY

- 2.1 In order to comply with the Traffic Signs Regulations and General Directions 2002, 7(1) and 7(2) and to provide assistance to disabled persons who hold a badge under the Disabled Persons (Badges for Motor Vehicles) (Scotland) Regulations 2000 as amended, the Environment and Regeneration Committee at the meeting held on 30 August 2012 agreed that The Inverclyde Council be asked to make the Traffic Regulation Order – Disabled Persons' Parking Places (On Street) Order No. 1 2012 in terms of the Road Traffic Regulation Act 1984 and Roads (Scotland) Act 1984 and associated Regulations.
- 2.2 The proposals have been advertised and two objections were received but subsequently withdrawn.
- 2.3 There are no legal or financial implications.

## 3.0 RECOMMENDATIONS

- 3.1 That a Resolution is made in the following terms.
- 3.2 THE INVERCLYDE COUNCIL, incorporated under the Local Government etc. (Scotland) Act 1994, RESOLVE TO MAKE as they HEREBY MAKE a Resolution under Section 32(1) and Part III of Schedule 9 of the Road Traffic Regulation Act 1984 to permit the provision of parking places for disabled persons who hold a badge under the Disabled Persons (Badges for motor Vehicles) (Scotland) Regulations 2000 as amended, all as detailed in a copy of the Order forming a supplement to the principal minute hereof, and that the Head of Environmental & Commercial Services and the Head of Legal & Democratic Services be authorised to take all necessary action in connection therewith. Appendix

**THE INVERCLYDE COUNCIL**  
**DISABLED PERSONS' PARKING PLACES**  
**(ON STREET) ORDER NO 1 2012**  
**TRAFFIC REGULATION ORDER**

DRAFT

## THE INVERCLYDE COUNCIL

### DISABLED PERSONS' PARKING PLACES (ON STREET) ORDER NO. 1 2012

The Inverclyde Council in exercise of the powers conferred on them by Sections 32(1) of the Road Traffic Regulation Act 1984 ("the Act") and of all other enabling powers and after consultation with the Chief Constable of Strathclyde Police in accordance with Part III of Schedule 9 to the Act hereby make the following Order.

1. This Order may be cited as "The Inverclyde Council Disabled Persons' Parking Places (On Street) Order No. 1 2012 and shall come into operation on ##
2. In this Order the following expressions have the meanings hereby assigned to them:
  - "vehicle" unless the context otherwise requires, means a vehicle of any description and includes a machine or implement of any kind drawn or propelled along roads whether or not by mechanical power;
  - "parking place" means a place where a vehicle, or vehicles of any class, may wait i.e. the area of land specified in the Schedule for which the use as a parking place has been authorised by the Council under Section 32(1) of the Act;
  - "sign" means a traffic sign;
  - "disabled person's badge" means:
    - (a) a badge issued under Section 21 of the Chronically Sick and Disabled Persons Act 1970;
    - (b) a badge issued under a provision of the law of Northern Ireland corresponding to that section; or
    - (c) a badge issued by any member State other than the United Kingdom for purposes corresponding to the purposes for which badges under that section are issued;
  - "disabled person's vehicle" means a vehicle lawfully displaying a disabled person's badge;
  - "Council" means The Inverclyde Council;
3. Each area of road which is described in the Schedule and plans relative to this Order is hereby designated as a parking place.
4. The parking places designated in this Order shall only be used for the leaving of disabled persons' vehicles displaying a valid disabled person's badge.

5. The limits of each parking place designated in this Order shall be indicated on the carriageway as prescribed by The Traffic Signs Regulations and General Directions 2002.
6. Every vehicle left in any parking place designated in this Order shall stand such that no parking place is occupied by more than one vehicle and that every part of the vehicle is within the limits of the parking place provided that, where the length of a vehicle precludes compliance with this paragraph, such vehicle shall be deemed to be within the limits of a parking place if;
  - i. the extreme front portion or, as the case may be, the extreme rear portion of the vehicle is within 300mm of an indication on the carriageway provided under this Order in relation to the parking place; and
  - ii. the vehicle, or any part thereof, is not within the limits of any adjoining parking place.
7. Any person duly authorised by the Council or a police officer in uniform or a traffic warden or parking attendant may move or cause to be moved in case of any emergency, to any place they think fit, vehicles left in a parking place.
8. Any person duly authorised by the Council may suspend the use of a parking place or any part thereof whenever such suspension is considered reasonably necessary:
  - i. for the purpose of facilitating the movement of traffic or promoting its safety;
  - ii. for the purpose of any building operation, demolition, or excavation in or adjacent to the parking place or the laying, erection, alteration, removal or repair in or adjacent to the parking place of any sewer or of any main, pipe, apparatus for the supply of gas, water electricity or of any telecommunications apparatus, traffic sign or parking meter;
  - iii. for the convenience of occupiers of premises adjacent to the parking place on any occasion of the removal of furniture from one office or dwellinghouse to another or the removal of furniture from such premises to a depository or to such premises from a depository;
  - iv. on any occasion on which it is likely by reason of some special attraction that any street will be thronged or obstructed; or
  - v. for the convenience of occupiers of premises adjacent to the parking place at times of weddings or funerals or on other special occasions.
9. A police officer in uniform may suspend for not longer than twenty four hours the use of a parking place or part thereof whenever such suspension is considered reasonably necessary for the purpose of facilitating the movement of traffic or promoting its safety.

10. This Order insofar as it relates to the parking places to be revoked (R) and amended, as specified in the Schedule to this Order, partially revokes and amends the Disabled Persons' Parking Places (On Street) Order No. 2 2010 and No. 1 2011 respectively.

Sealed with the Common Seal of The Inverclyde Council and subscribed for them and on their behalf by ##

DRAFT

**INVERCLYDE COUNCIL**

**DISABLED PERSONS' PARKING PLACES (ON STREET)  
ORDER NO. 1 2012**

**Statement of Reasons for Proposing to Make  
the Above Order**

It is considered necessary to make the above Order to provide assistance for disabled persons who hold a badge under the Disabled Persons (Badges for Motor Vehicles) (Scotland) Regulations 2000 as amended and by revoking those parking places no longer required to maximise street parking capacity.



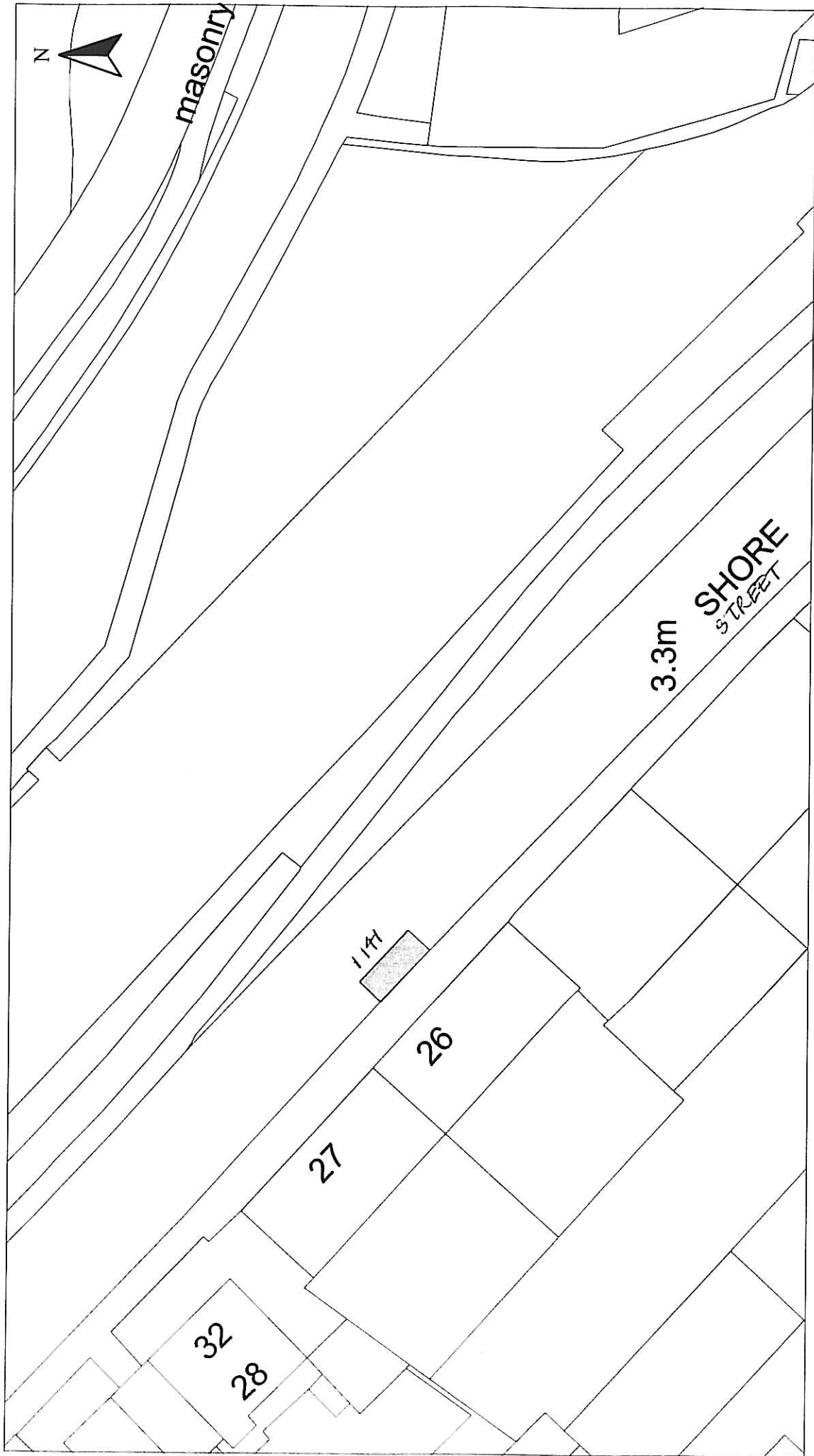

HEAD OF SERVICE  
IAN MOFFAT

Disabled Bays  
71 EAST HAMILTON STREET  
GREENOCK, PA15 2UA

Reproduced from Ordnance Survey mapping with the permission of the Controller of Her Majesty's Stationery Office. Crown Copyright. Unauthorised reproduction infringes Crown Copyright and may result in prosecution or legal proceedings.

Licence No. LA03097L  
**OS** Ordnance Survey

**DISABLED PERSONS' PARKING PLACE**  
26A SHORE STREET, GOUROCK  
PLACE No. 1141

Scale : 1:500  
Prepared by : R. MACKAY  
Drawn by : R. MACKAY  
Drawing No. :

Date : NOV 2011  
Checked by :  
Approved by :  
File No. : 19/12



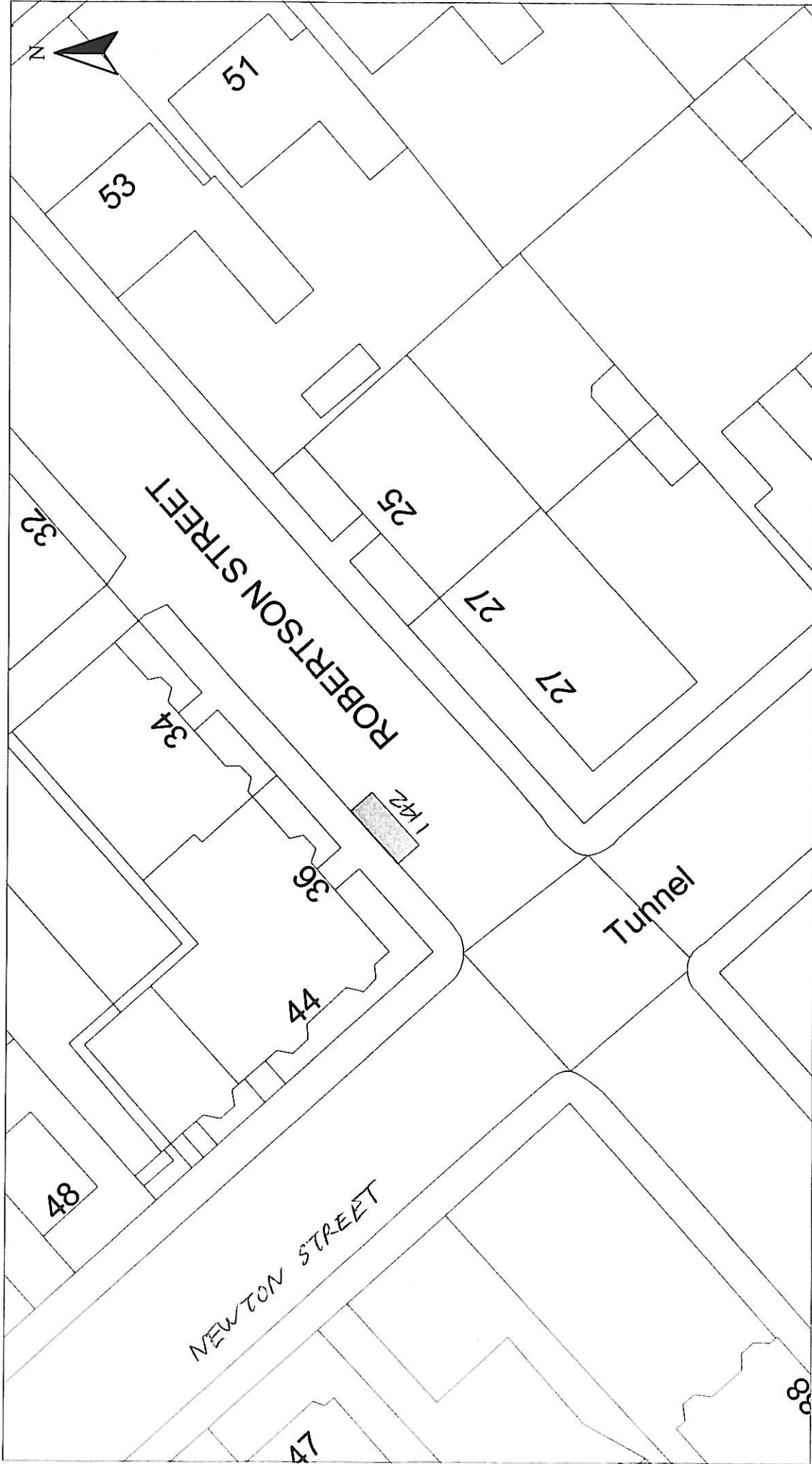

HEAD OF SERVICE  
IAN MOFFAT

Disabled Bays  
71 EAST HAMILTON STREET  
GREENOCK, PA15 2UA

Reproduced from Ordnance Survey mapping with the permission of the Controller of Her Majesty's Stationery Office. Crown Copyright. Unauthorised reproduction infringes Crown Copyright and may result in prosecution or legal proceedings.

Licence No. LA03097L  
**OS** Ordnance Survey

DISABLED PERSONS' PARKING PLACE

36 ROBERTSON STREET, GREENOCK

PLACE No. 1142

Scale : 1:500

Prepared by : R. MACKAY

Drawn by : R. MACKAY

Drawing No. :

Date : NOV 2011

Checked by :

Approved by :

File No. : 19/12

**Inverclyde** council  
**ENVIRONMENTAL & COMMERCIAL SERVICES**



HEAD OF SERVICE IAN MOFFAT		Scale : 1:500		Date : NOV 2011	
Disabled Bays		Prepared by : R. MACKAY		Checked by :	
71 EAST HAMILTON STREET GREENOCK, PA15 2UA		Drawing No. :		Approved by :	
Disabled PERSONS' PARKING PLACE 24 MAVIS ROAD, GREENOCK PLACE No. 1143		Drawing No. :		File No. : 19/12	
Reproduced from Ordnance Survey mapping with the permission of the Controller of Her Majesty's Stationary Office. Crown Copyright. Unauthorised reproduction infringes Crown Copyright and may result in prosecution or legal proceedings.					
Licence No. LA03097L  Ordnance Survey					

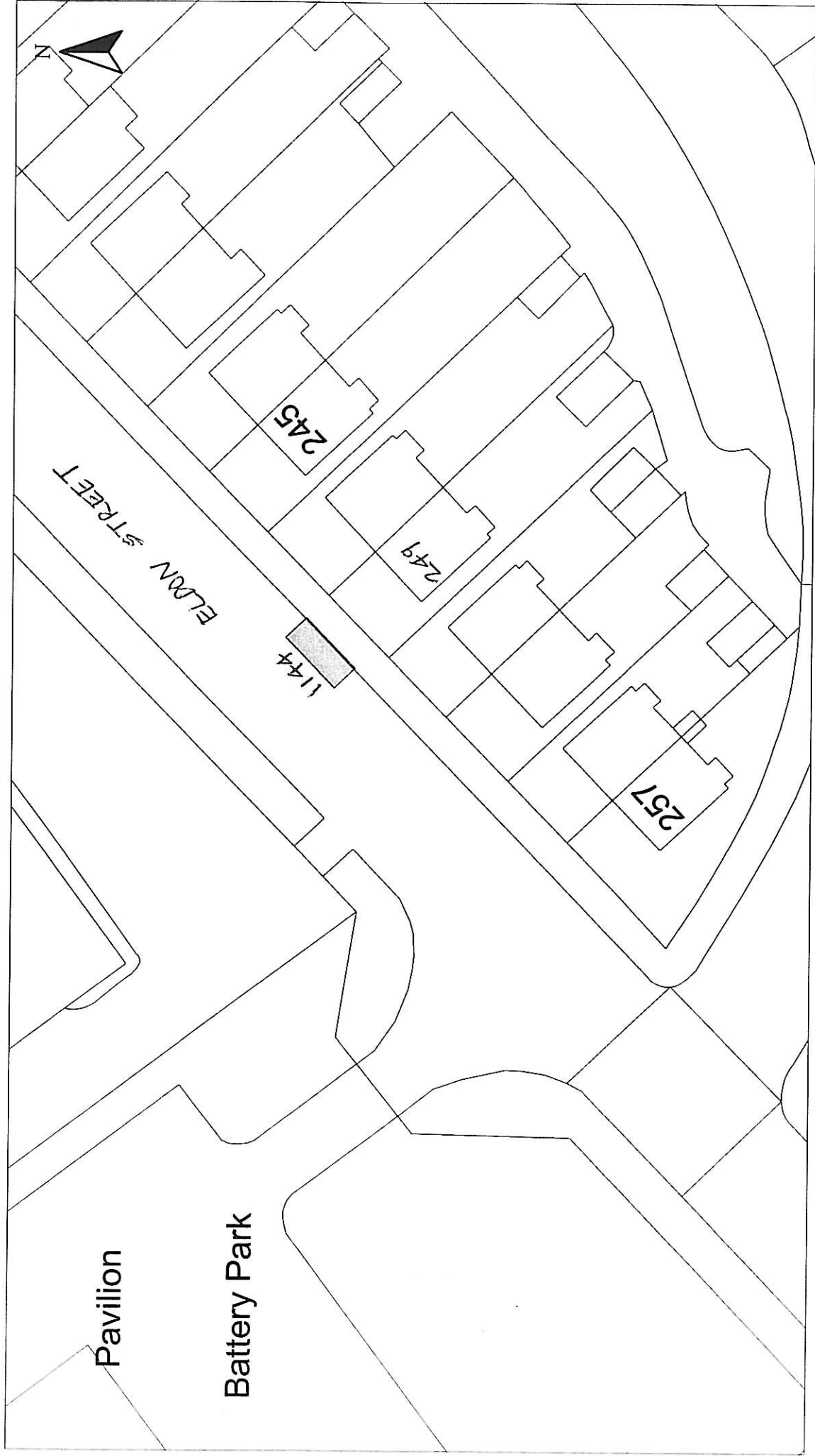

HEAD OF SERVICE  
IAN MOFFAT

Disabled Bays  
71 EAST HAMILTON STREET  
GREENOCK, PA15 2UA

Reproduced from Ordnance Survey mapping with the permission  
of the Controller of Her Majesty's Stationary Office. Crown  
Copyright. Unauthorised reproduction infringes Crown Copyright  
and may result in prosecution or legal proceedings.

Licence No. LA03097L



**DISABLED PERSONS' PARKING PLACE**

249 ELDON STREET, GREENOCK  
PLACE No. 1144

Scale : 1:500

Prepared by : R. MACKAY

Drawn by : R. MACKAY

Drawing No. :

Date : NOV 2011

Checked by :

Approved by :

File No. : 19/12

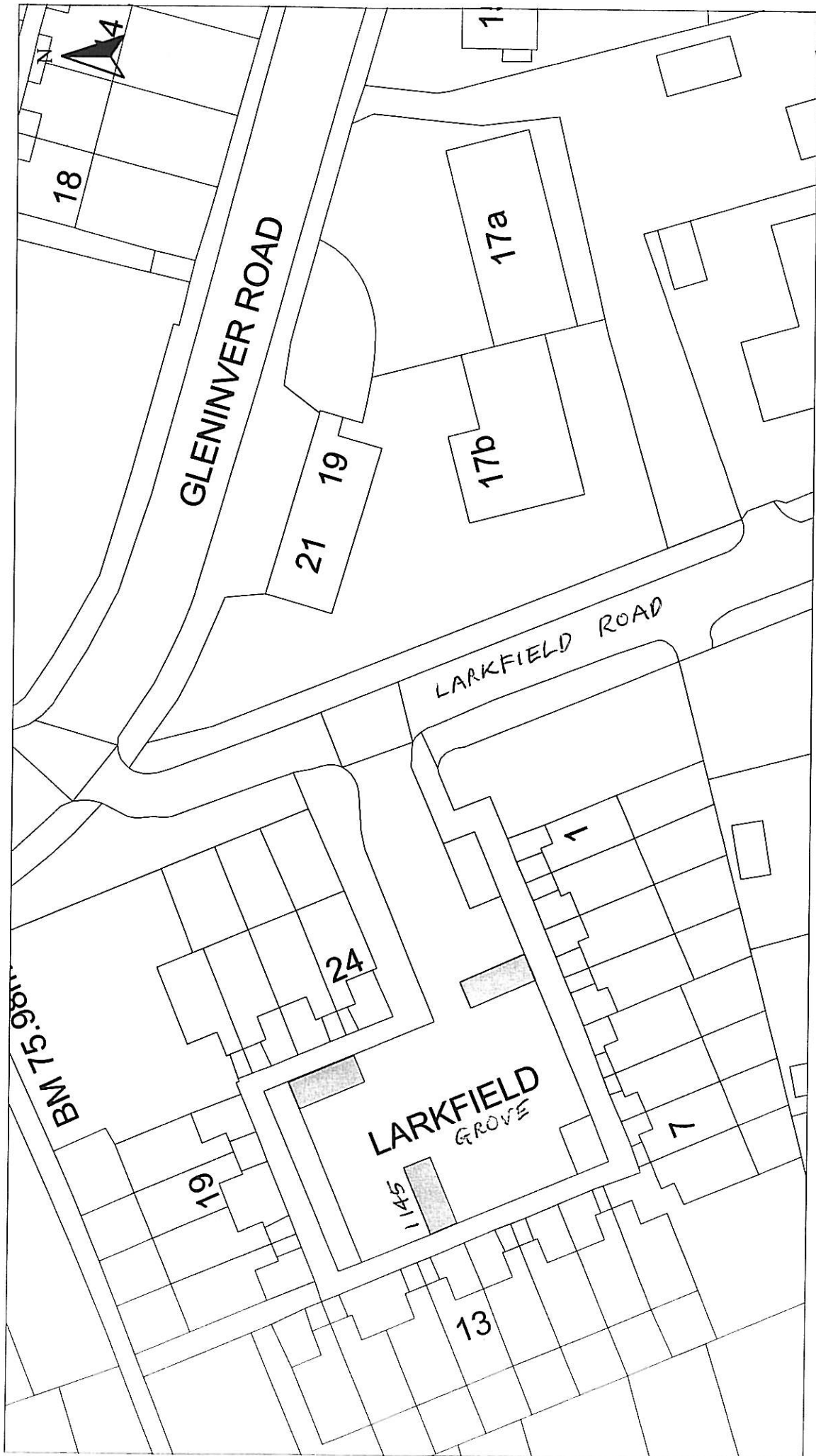

HEAD OF SERVICE  
IAN MOFFAT

71 EAST HAMILTON STREET  
GREENOCK, PA15 2JA

Reproduced from Ordnance Survey mapping with the permission of the Controller of Her Majesty's Stationery Office. Crown Copyright. Unauthorised reproduction infringes Crown Copyright and may result in prosecution or legal proceedings.



Licence No. LA03097L

**DISABLED PERSONS' PARKING PLACE**  
**13 LARKFIELD GROVE, GREENOCK**  
**PLACE No. 1145**

Scale : 1:500

Prepared by : R. MACKAY

Drawn by : R. MACKAY

Drawing No. :

Date : NOV 2011

Checked by :

Approved by :

File No. : 19/12

Disabled Bays

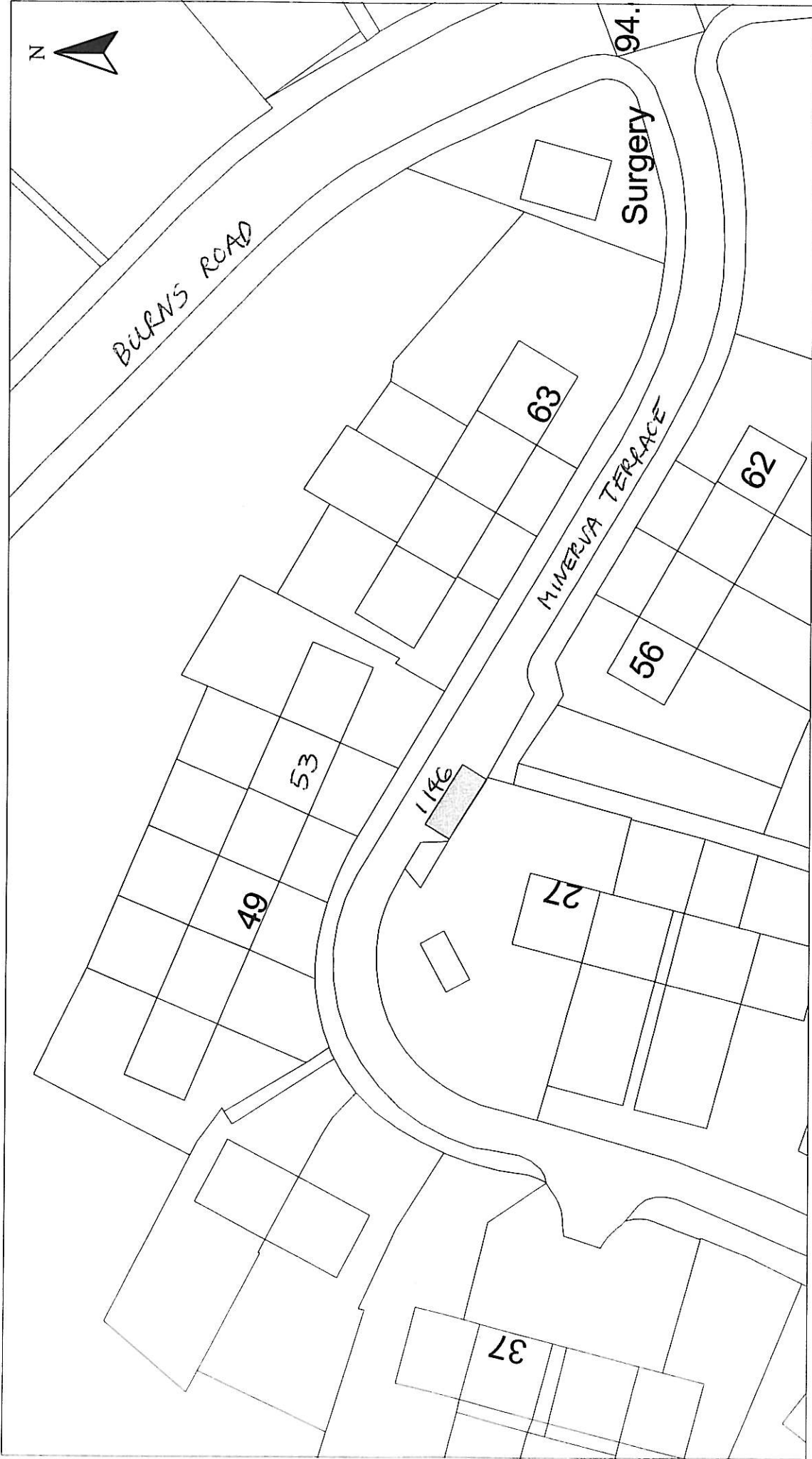

HEAD OF SERVICE  
IAN MOFFAT

71 EAST HAMILTON STREET  
GREENOCK, PA15 2UA

Disabled Bays

Reproduced from Ordnance Survey mapping with the permission of the Controller of Her Majesty's Stationery Office. Crown Copyright. Unauthorised reproduction infringes Crown Copyright and may result in prosecution or legal proceedings.

Ordnance Survey  
Licence No. LA03097L

**DISABLED PERSONS' PARKING PLACE**

**53 MINERVA TERRACE, GREENOCK**

**PLACE No. 1146**

Scale : 1:500

Prepared by : R. MACKAY

Drawn by : R. MACKAY

Drawing No. :

Date : NOV 2011

Checked by :

Approved by :

File No. : 19/12



HEAD OF SERVICE IAN MOFFAT	Scale : 1:500		Date : NOV 2011
	Prepared by : R. MACKAY		Checked by :
Disabled Bays 71 EAST HAMILTON STREET GREENOCK, PA15 2UA	Drawing No. : 1147		Approved by :
	Licence No. LA03097L		File No. : 19/12
Reproduced from Ordnance Survey mapping with the permission of the Controller of Her Majesty's Stationery Office. Crown Copyright. Unauthorised reproduction infringes Crown Copyright and may result in prosecution or legal proceedings.			
DISABLED PERSONS' PARKING PLACE 15 SLAEMUIR AVENUE, PORT GLASGOW PLACE No. 1147			

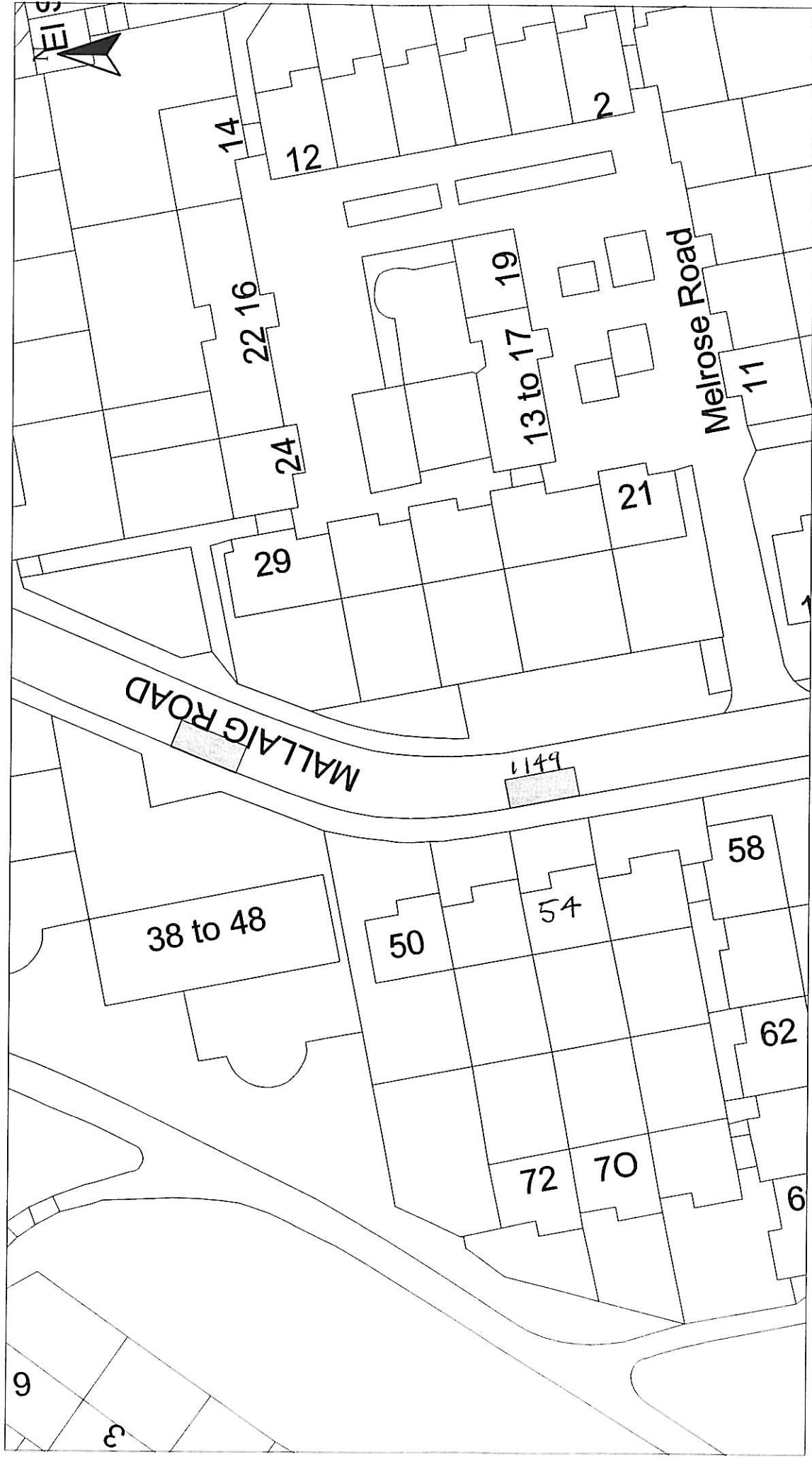

HEAD OF SERVICE  
IAN MOFFAT

71 EAST HAMILTON STREET  
GREENOCK, PA15 2JA

Disabled Bays

Reproduced from Ordnance Survey mapping with the permission of the Controller of Her Majesty's Stationery Office. Crown Copyright. Unauthorised reproduction infringes Crown Copyright and may result in prosecution or legal proceedings.

Licence No. LA03097L



**DISABLED PERSONS' PARKING PLACE**  
54 MALLAIG ROAD, PORT GLASGOW  
PLACE No. 1149

Scale : 1:500

Prepared by : R. MACKAY

Drawn by : R. MACKAY

Drawing No. :

Date : NOV 2011

Checked by :

Approved by :

File No. : 19/12

# Inverclyde council ENVIRONMENTAL & COMMERCIAL SERVICES

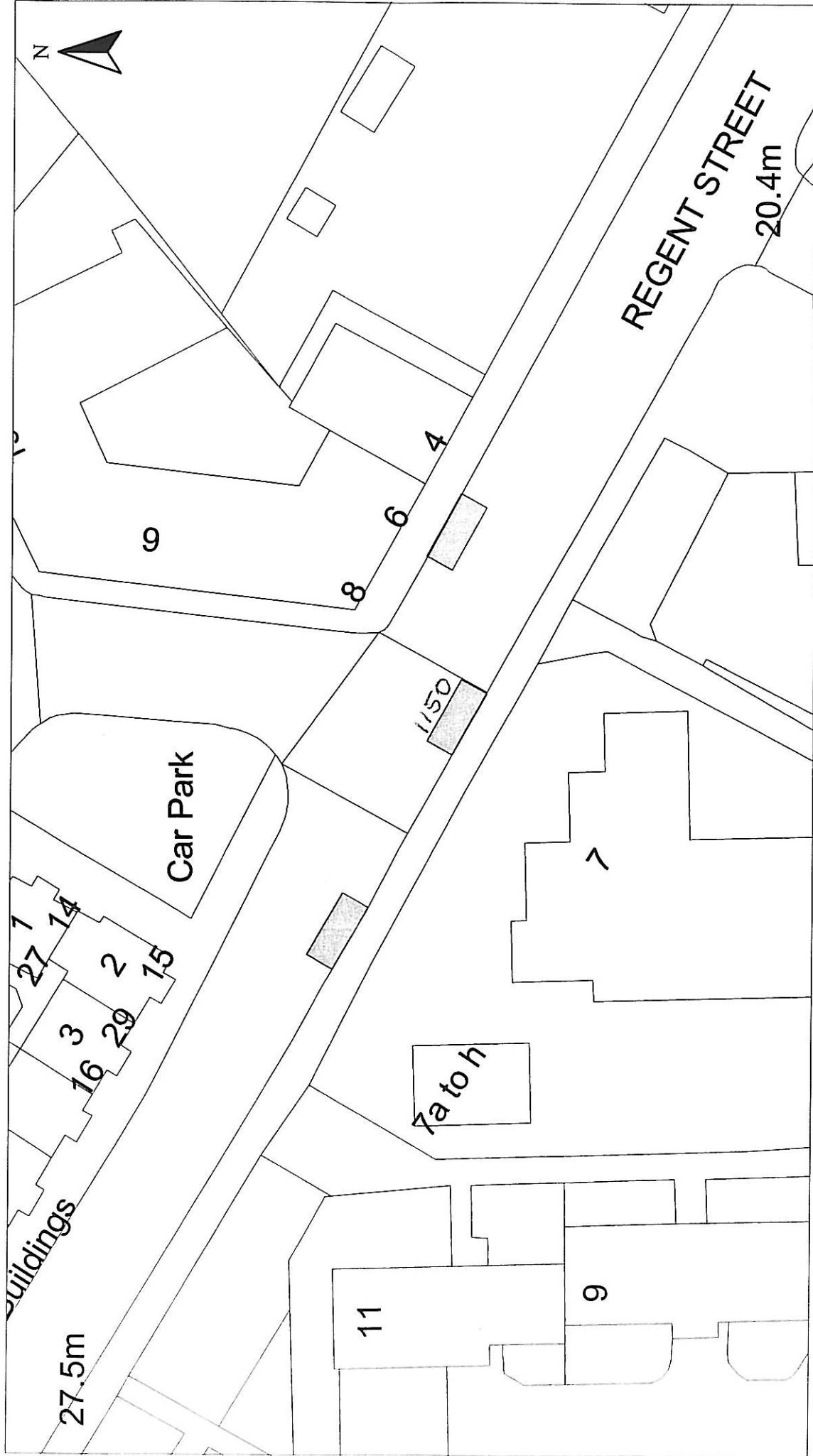

HEAD OF SERVICE IAN MOFFAT		Scale : 1:500		Date : NOV 2011	
Disabled Bays		Prepared by : R. MACKAY		Checked by :	
71 EAST HAMILTON STREET GREENOCK, PA15 2UA		Drawn by : R. MACKAY		Approved by :	
Disabled PERSONS' PARKING PLACE 7 REGENT STREET, GREENOCK PLACE No. 1150		Drawing No. :		File No. : 19/12	

Reproduced from Ordnance Survey mapping with the permission of the Controller of Her Majesty's Stationery Office. Crown Copyright. Unauthorised reproduction, storage, retrieval and may result in prosecution or legal proceedings.  
 Ordnance Survey  
 Licence No. LA03097L



# Inverclyde council ENVIRONMENTAL & COMMERCIAL SERVICES

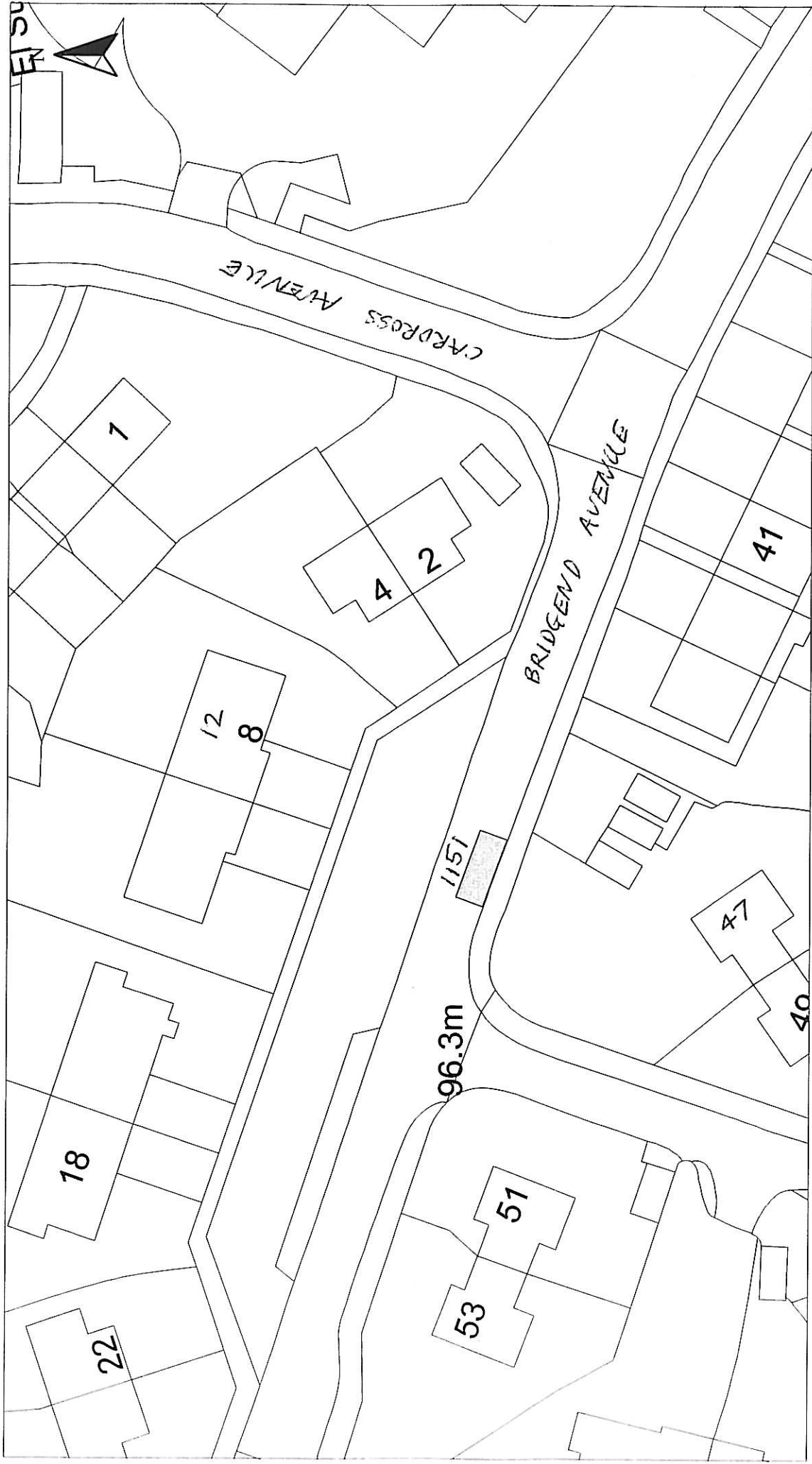

HEAD OF SERVICE  
IAN MOFFAT

71 EAST HAMILTON STREET  
GREENOCK, PA15 2UA

Reproduced from Ordnance Survey mapping with the permission of the Controller of Her Majesty's Stationery Office. Crown Copyright. Unauthorised reproduction in any form is prohibited and may result in prosecution or legal proceedings.

Licence No. LA03097L  
**Ordnance Survey**

**DISABLED PERSONS' PARKING PLACE**  
**12 BRIDGEND AVENUE, PORT GLASGOW**  
**PLACE No. 1151**

Scale : 1:500

Prepared by : R. MACKAY

Drawn by : R. MACKAY

Drawing No. :

Date : NOV 2011

Checked by :

Approved by :

File No. : 19/12

Disabled Bays

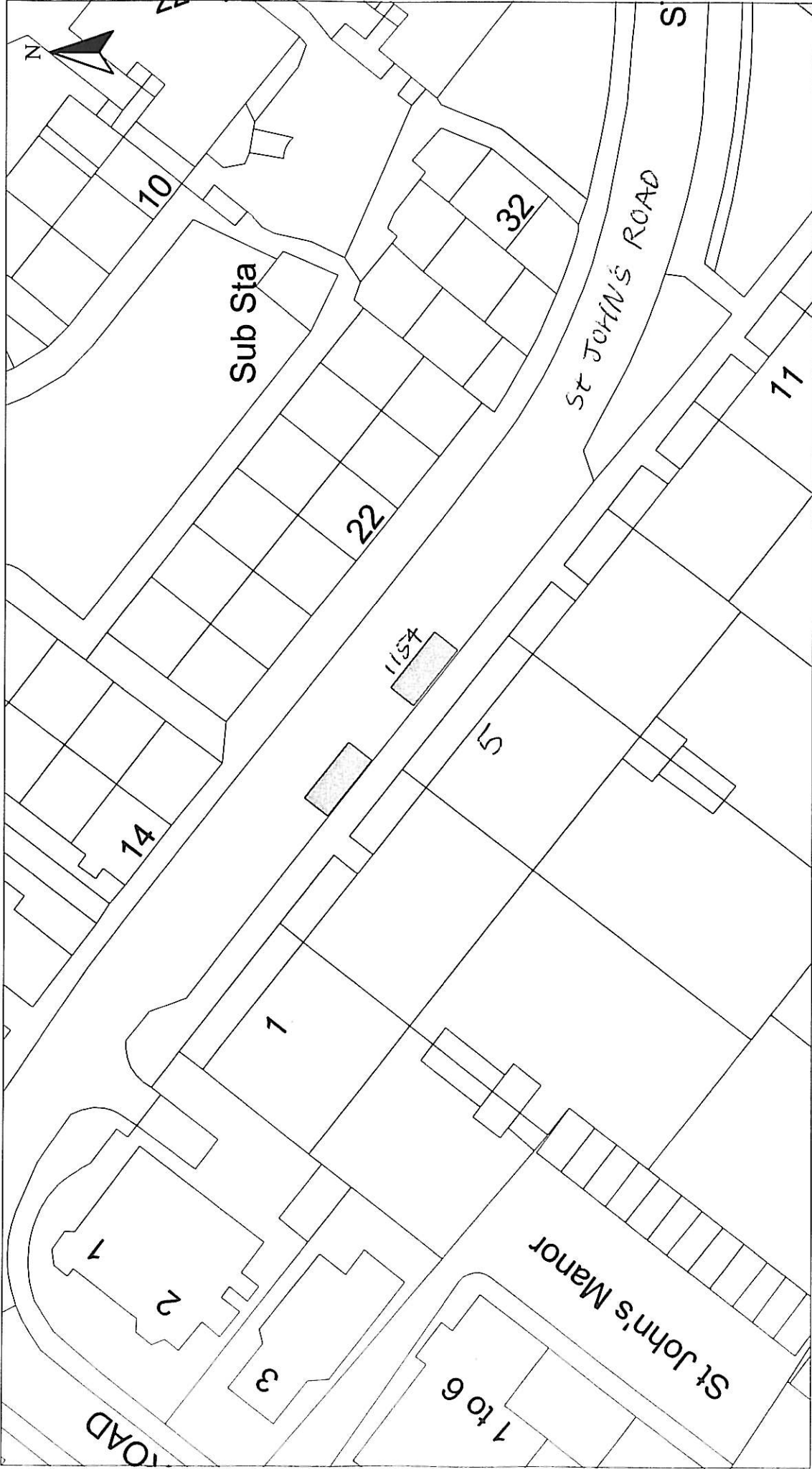

HEAD OF SERVICE  
IAN MOFFAT

Disabled Bays  
71 EAST HAMILTON STREET  
GREENOCK, PA15 2UA

Reproduced from Ordnance Survey mapping with the permission  
of the Controller of Her Majesty's Stationery Office. Crown  
Copyright. Unauthorised reproduction infringes Crown Copyright  
and may result in prosecution or legal proceedings.

Licence No. LA03097L

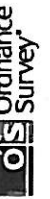

**DISABLED PERSONS' PARKING PLACE**

**5 St JOHN'S ROAD, GOUROCK**  
**PLACE No. 1154**

Scale : 1:500

Prepared by : R. MACKAY

Drawn by : R. MACKAY

Drawing No. :

Date : NOV 2011

Checked by :

Approved by :

File No. : 19/12



HEAD OF SERVICE  
IAN MOFFAT

Disabled Bays  
71 EAST HAMILTON STREET  
GREENOCK, PA15 2UA

Reproduced from Ordnance Survey mapping with the permission of the Controller of Her Majesty's Stationery Office. Crown Copyright. Unauthorised reproduction infringes Crown Copyright and may result in prosecution or legal proceedings.

Licence No. LA03097L

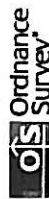

**DISABLED PERSONS' PARKING PLACE**

**5 MATHIE CRESCENT, GOUROCK**

PLACE No. 1157

Scale : 1:500

Prepared by : R. MACKAY

Drawn by : R. MACKAY

Drawing No. :

Date : NOV 2011

Checked by :

Approved by :

File No. : 19/12

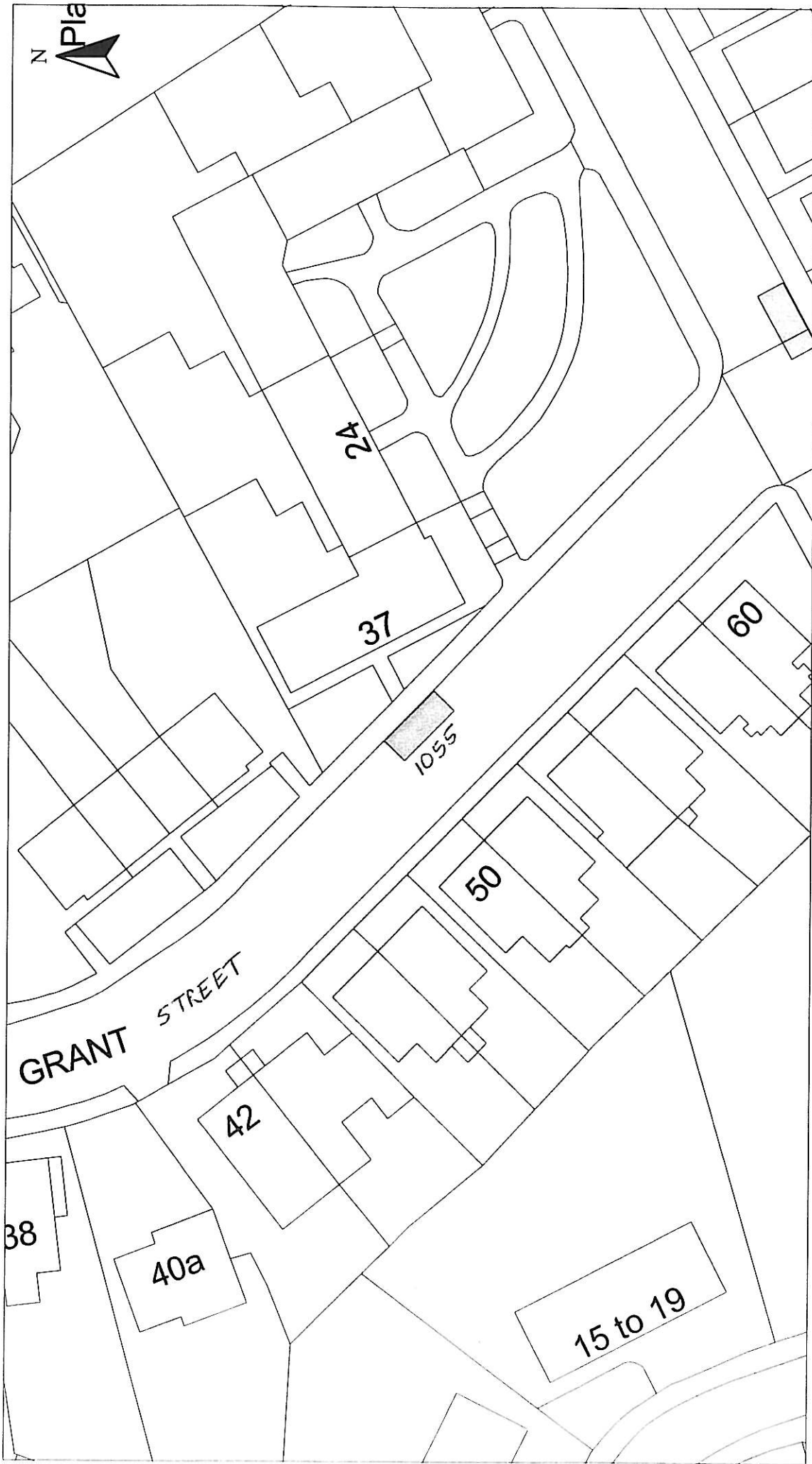

HEAD OF SERVICE  
IAN MOFFAT

71 EAST HAMILTON STREET  
GREENOCK, PA15 2UA

Disabled Bays

Reproduced from Ordnance Survey mapping with the permission of the Controller of Her Majesty's Stationery Office. Crown Copyright. Unauthorised reproduction infringes Crown Copyright and may result in prosecution or legal proceedings.

Licence No. LA03097L



**DISABLED PERSONS' PARKING PLACE**  
**37 GRANT STREET, GREENOCK**  
**PLACE No. 1055 AMENDMENT**

Scale :	1:500	Date :	NOV 2011
Prepared by :	R. MACKAY	Checked by :	
Drawn by :	R. MACKAY	Approved by :	
Drawing No. :		File No. :	19/12



HEAD OF SERVICE  
IAN MOFFAT

71 EAST HAMILTON STREET  
GREENOCK, PA15 2UA

Reproduced from Ordnance Survey mapping with the permission of the Controller of Her Majesty's Stationery Office. Crown Copyright. Unauthorised reproduction infringes Crown Copyright and may result in prosecution or legal proceedings.

Licence No. LA03087L  
**OS** Ordnance Survey

**DISABLED PERSONS' PARKING PLACE**  
34 DUNLOP STREET, GREENOCK  
PLACE No. 0984 REVOCATION

Scale :	1:500	Date :	NOV 2011
Prepared by :	R. MACKAY	Checked by :	
Drawn by :	R. MACKAY	Approved by :	
Drawing No. :		File No. :	19/12

Disabled Bays