

---

**Report To:** SAFE, SUSTAINABLE COMMUNITIES COMMITTEE      **Date:** 3 MAY 2011

**Report By:** CORPORATE DIRECTOR REGENERATION AND ENVIRONMENT      **Report No:** LA/690/11

**Contact Officer:** AUDREY WARMISHAM      **Contact No:** 01475 712118

**Subject:** PROPOSED TRAFFIC REGULATION ORDER – DISABLED PERSONS’ PARKING PLACES (ON STREET) ORDER NO 1 2011

---

### 1.0 PURPOSE

1.1 Local Authorities are empowered to make Orders under the Road Traffic Regulation and Roads (Scotland) Acts 1984 and under the Council's Scheme of Administration the Head of Environmental Services is responsible for the making, implementation and review of Traffic Management Orders and Traffic Regulation Orders.

### 2.0 BACKGROUND

2.1 In order to comply with the Traffic Signs Regulations and General Directions 2002, 7(1) and 7(2), it is proposed to introduce a Traffic Regulation Order to accompany the provision of parking bays for the disabled. This will restrict parking to drivers displaying a Blue Badge only, and will enable the Police to enforce such restrictions.

2.2 The proposals have been advertised in the Greenock Telegraph and full details of the proposals have been made available for public inspection during normal office hours at the offices of the Head of Environmental & Commercial Services, the Head of Legal & Democratic Services and Greenock Central, Port Glasgow, South West, Kilmacolm and Gourock Libraries. A copy of the draft Order is appended hereto for Members' information.

Appendix

2.3 One objection was received but has subsequently been withdrawn.

2.4 The Committee is asked to note that, if approved, the Order may not be implemented until the making of the order has been advertised to allow any persons who so wish a period of six weeks to question the validity of the Order in terms of the Road Traffic Regulation Act 1984.

### 3.0 RECOMMENDATION

3.1 That the Committee recommend to The Inverclyde Council the making of the Traffic Regulation Order – Disabled Persons’ Parking Places (On Street) Order No 1 2011 and remit it to the Head of Environmental & Commercial Services and Head of Legal & Democratic Services to arrange for its implementation.

**Legal & Democratic Services**

**THE INVERCLYDE COUNCIL**  
**DISABLED PERSONS' PARKING PLACES**  
**(ON STREET) ORDER NO 1 2011**  
**TRAFFIC REGULATION ORDER**

## THE INVERCLYDE COUNCIL

### DISABLED PERSONS' PARKING PLACES (ON STREET) ORDER NO 1 2011

The Inverclyde Council in exercise of the powers conferred on them by Sections 32(1) of the Road Traffic Regulation Act 1984 ("the Act") and of all other enabling powers and after consultation with the Chief Constable of Strathclyde Police in accordance with Part III of Schedule 9 to the Act hereby make the following Order.

1. This Order may be cited as "The Inverclyde Council Disabled Persons' Parking Places (On Street) Order No 1 2011 and shall come into operation on #####.
2. In this Order the following expressions have the meanings hereby assigned to them:
  - "vehicle" unless the context otherwise requires, means a vehicle of any description and includes a machine or implement of any kind drawn or propelled along roads whether or not by mechanical power;
  - "parking place" means a place where a vehicle, or vehicles of any class, may wait i.e. the area of land specified in the Schedule for which the use as a parking place has been authorised by the Council under Section 32(1) of the Act;
  - "sign" means a traffic sign;
  - "disabled person's badge" means:
    - (a) a badge issued under Section 21 of the Chronically Sick and Disabled Persons Act 1970;
    - (b) a badge issued under a provision of the law of Northern Ireland corresponding to that section; or
    - (c) a badge issued by any member State other than the United Kingdom for purposes corresponding to the purposes for which badges under that section are issued;
  - "disabled person's vehicle" means a vehicle lawfully displaying a disabled person's badge;
  - "Council" means The Inverclyde Council;
3. Each area of road which is described in the Schedule and plans relative to this Order is hereby designated as a parking place.
4. The parking places designated in this Order shall only be used for the leaving of disabled persons' vehicles displaying a valid disabled person's badge.

5. The limits of each parking place designated in this Order shall be indicated on the carriageway as prescribed by The Traffic Signs Regulations and General Directions 2002.
6. Every vehicle left in any parking place designated in this Order shall stand such that no parking place is occupied by more than one vehicle and that every part of the vehicle is within the limits of the parking place provided that, where the length of a vehicle precludes compliance with this paragraph, such vehicle shall be deemed to be within the limits of a parking place if;
  - i. the extreme front portion or, as the case may be, the extreme rear portion of the vehicle is within 300 mm of an indication on the carriageway provided under this Order in relation to the parking place; and
  - ii. the vehicle, or any part thereof, is not within the limits of any adjoining parking place.
7. Any person duly authorised by the Council or a police officer in uniform or a traffic warden or parking attendant may move or cause to be moved in case of any emergency, to any place they think fit, vehicles left in a parking place.
8. Any person duly authorised by the Council may suspend the use of a parking place or any part thereof whenever such suspension is considered reasonably necessary:
  - i. for the purpose of facilitating the movement of traffic or promoting its safety;
  - ii. for the purpose of any building operation, demolition, or excavation in or adjacent to the parking place or the laying, erection, alteration, removal or repair in or adjacent to the parking place of any sewer or of any main, pipe, apparatus for the supply of gas, water electricity or of any telecommunications apparatus, traffic sign or parking meter;
  - iii. for the convenience of occupiers of premises adjacent to the parking place on any occasion of the removal of furniture from one office or dwellinghouse to another or the removal of furniture from such premises to a depository or to such premises from a depository;
  - iv. on any occasion on which it is likely by reason of some special attraction that any street will be thronged or obstructed; or
  - v. for the convenience of occupiers of premises adjacent to the parking place at times of weddings or funerals or on other special occasions.
9. A police officer in uniform may suspend for not longer than twenty four hours the use of a parking place or part thereof whenever such suspension is considered reasonably necessary for the purpose of facilitating the movement of traffic or promoting its safety.

10. This Order insofar as it relates to the parking places to be revoked (R), as specified in the Schedule to this Order, partially revokes The Inverclyde Council On-Street Parking Places (Without Charges) Orders Nos 1 1999, 1 2000, 1 2002, 1 2004, 2 2005, 1 2006, 2 2006, 3 2007, 3 2009 and Disabled Persons' Parking Places (On Street) Order No 2 2010,

Sealed with the Common Seal of The Inverclyde Council and subscribed for them on their behalf by

DRAFT

**INVERCLYDE COUNCIL**

**DISABLED PERSONS' PARKING PLACES (ON STREET)  
ORDER NO 1 2011**

**Statement of Reasons for Proposing to Make  
the Above Order**

It is considered necessary to make the above Order to provide assistance for disabled persons who hold a badge under the Disabled Persons (Badges for Motor Vehicles) (Scotland) Regulations 2000 as amended and by revoking those parking places no longer required to maximise street parking capacity.

# INVERCLYDE COUNCIL

## DISABLED PERSONS' PARKING PLACES (ON-STREET) ORDER No. 1 2011

### SCHEDULE

All and whole that area of ground as described in Column 2 in the table below:

| <b><u>Ref No.</u></b> | <b><u>Address of Disabled Person's Parking Place<br/>to be created or revoked @ "ex-adverso"</u></b> |
|-----------------------|--|
| 1034                  | 7C Shaw Place, Greenock  |
| 1037                  | 36 Finlaystone Road, Kilmacolm   |
| 1038                  | 199 Grieve Road, Greenock  |
| 1039                  | 14 Waverley Street, Greenock   |
| 1040                  | 7 Shaw Place, Greenock   |
| 1042                  | 22 Mavis Road, Greenock  |
| 1043                  | 6 Dunlop Street, Greenock  |
| 1046                  | 12 East Shaw Street, Greenock  |
| 1047                  | 40 Quarry Drive, Kilmacolm   |
| 1049                  | 48 Maple Road, Greenock  |
| 1050                  | 27 Patrick Street, Greenock  |
| 1051                  | 114 Forsyth Street, Greenock   |
| 1054                  | 123 Finnart Street, Greenock   |
| 1055                  | 37 Grant Street, Greenock  |
|                       |  |
|                       |  |
|                       |  |
|                       |  |
|                       |  |
|                       |  |
|                       |  |
|                       |  |
|                       |  |
|                       |  |

INVERCLYDE COUNCIL

DISABLED PERSONS' PARKING PLACES (ON-STREET)  
ORDER No. 1 2011

SCHEDULE

| <u>Ref No.</u> | <u>Address of Disabled Person's Parking Place<br/>to be created or revoked ® "ex-adverso"</u> |
|----------------|---|
| 9905           | 115 Bardrainey Avenue, Port Glasgow ®   |
| 9906           | 3 Cardross Crescent, Greenock ®   |
| 9914           | 37 Nelson Street, Greenock ®  |
| 9921           | 21 Devon Road, Greenock ®   |
| 0515           | 85 Albert Road, Gourock ®   |
| 0632           | 41 Ashton Road, Gourock ®   |
| 0726           | 33 Glenhuntly Terrace, Port Glasgow ®   |
| 0902           | 6 Nelson Road, Greenock ®   |
| 0982           | 22 Mearns Street, Greenock ®  |
|                |   |
|                |   |
|                |   |
|                |   |
|                |   |
|                |   |
|                |   |
|                |   |
|                |   |
|                |   |
|                |   |
|                |   |
|                |   |



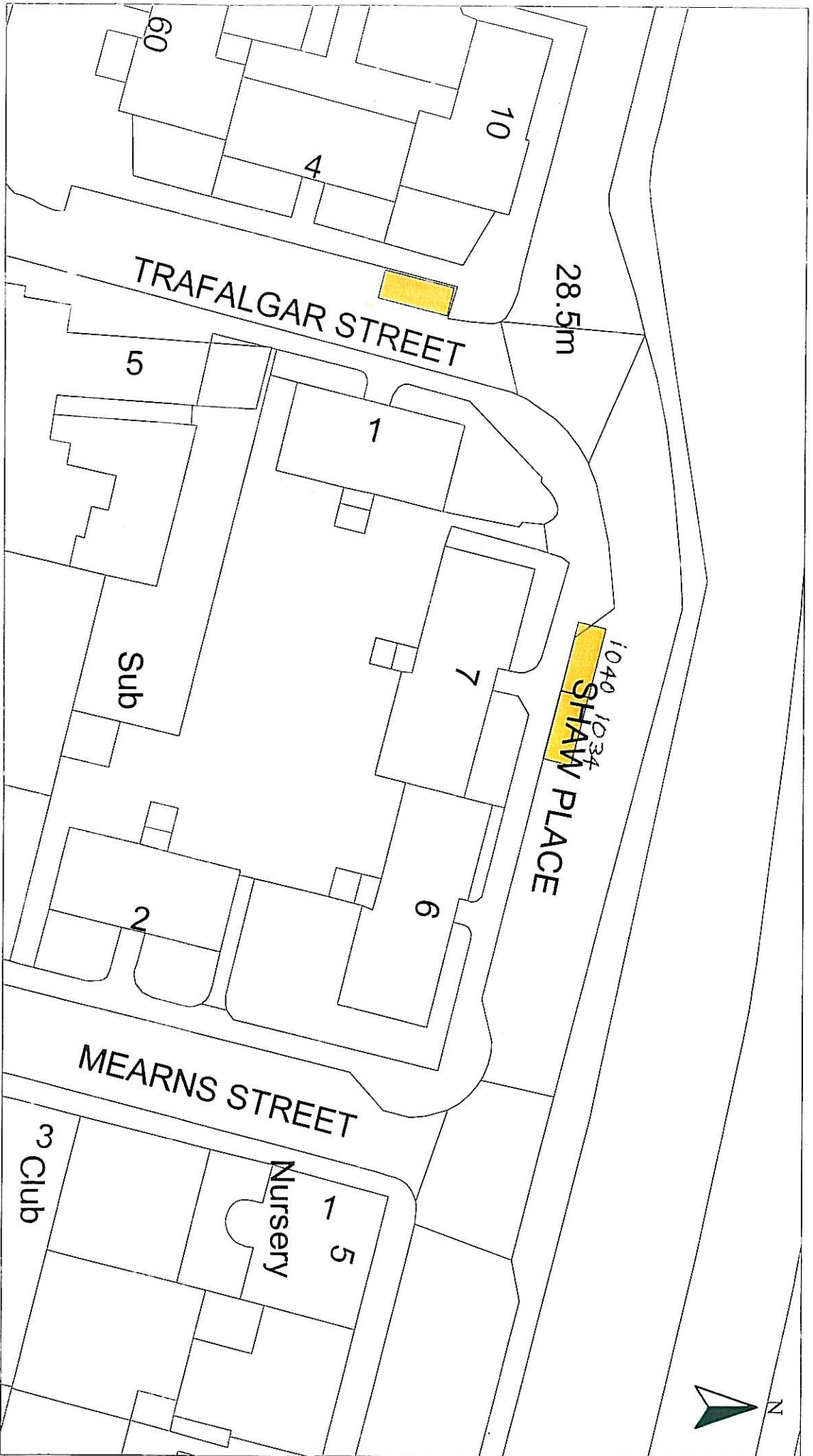

HEAD OF SERVICE  
ALAN G BARNES MCIMM CENV

71 EAST HAMILTON STREET  
GREENOCK, PA15 2UA

Disabled Bays

Reproduced from Ordnance Survey mapping with the permission of the Controller of Her Majesty's Stationery Office. Crown Copyright and may result in prosecution or legal proceedings.

Ordnance Survey

License No. LA03097L

DISABLED PERSONS' PARKING PLACE

7 SHAW PLACE, GREENOCK  
PLACE Nos. 1034 & 1040

|               |           |               |          |
|---------------|-----------|---------------|----------|
| Scale :       | 1:500     | Date :        | NOV 2010 |
| Prepared by : | R. MACKAY | Checked by :  |          |
| Drawn by :    | R. MACKAY | Approved by : |          |
| Drawing No. : |           | File No. :    | 19/12    |



HEAD OF SERVICE  
ALAN G BARNES MCIWM GENV

71 EAST HAMILTON STREET  
GREENOCK, PA15 2UA

Reproduced from: Ordnance Survey mapping with the permission of the Controller of Her Majesty's Stationery Office. Crown Copyright. Unauthorised reproduction infringes Crown Copyright and may result in prosecution or legal proceedings.

Licence No. LA03097L



DISABLED PERSONS' PARKING PLACE  
36 FINLAYSTONE ROAD, KILMACOLM  
PLACE No. 1037

|               |           |               |          |
|---------------|-----------|---------------|----------|
| Scale :       | 1:500     | Date :        | NOV 2010 |
| Prepared by : | R. MACKAY | Checked by :  |          |
| Drawn by :    | R. MACKAY | Approved by : |          |
| Drawing No. : |           | File No. :    | 19/12    |

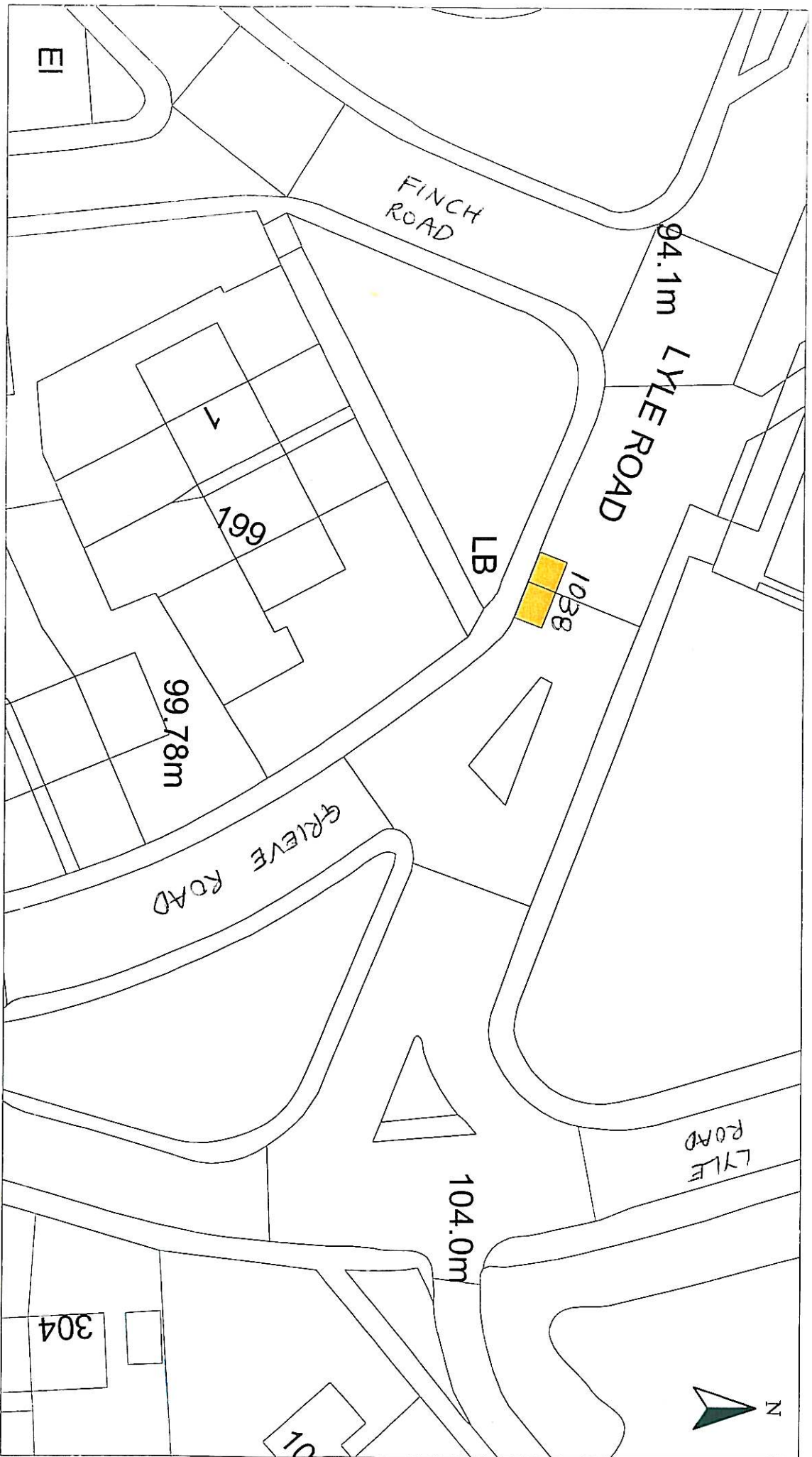

|  |  |   |  |
|--|--|---|--|
| HEAD OF SERVICE<br>ALAN G BARNES MCIVM CENV  |  | Disabled Bays   |  |
| 71 EAST HAMILTON STREET<br>GREENOCK, PA15 2UA  |  | 71 EAST HAMILTON STREET<br>GREENOCK, PA15 2UA                                       |  |
| Reproduced from Ordnance Survey mapping with the permission of the Controller of Her Majesty's Stationery Office. Copyright. Unauthorised reproduction infringes Crown Copyright and may result in prosecution or legal proceedings. |  |   |  |
| Licence No. LA03097L   |  |   |  |
| DISABLED PERSONS' PARKING PLACE<br>199 GRIEVE ROAD, GREENOCK<br>PLACE No. 1038   |  | Scale : 1:500<br>Prepared by : R. MACCKAY<br>Drawn by : R. MACCKAY<br>Drawing No. : |  |
| Date : NOV 2010  |  | Checked by :<br>Approved by :   |  |
| File No. : 19/12   |  | 304<br>10   |  |



HEAD OF SERVICE  
ALAN G BARNES MCIVM CENV

Disabled Bays  
71 EAST HAMILTON STREET  
GREENOCK, PA15 2UA

Reproduced from Ordnance Survey mapping with the permission of the Controller of Her Majesty's Stationery Office. Crown Copyright and may result in prosecution or legal proceedings.  
Licence No. LA03997L



DISABLED PERSONS' PARKING PLACE  
14 WAVERLEY STREET, GREENOCK  
PLACE No. 1039

|               |           |               |          |
|---------------|-----------|---------------|----------|
| Scale :       | 1:500     | Date :        | NOV 2010 |
| Prepared by : | R. MACKAY | Checked by :  |          |
| Drawn by :    | R. MACKAY | Approved by : |          |
| Drawing No. : |           | File No. :    | 19/12    |

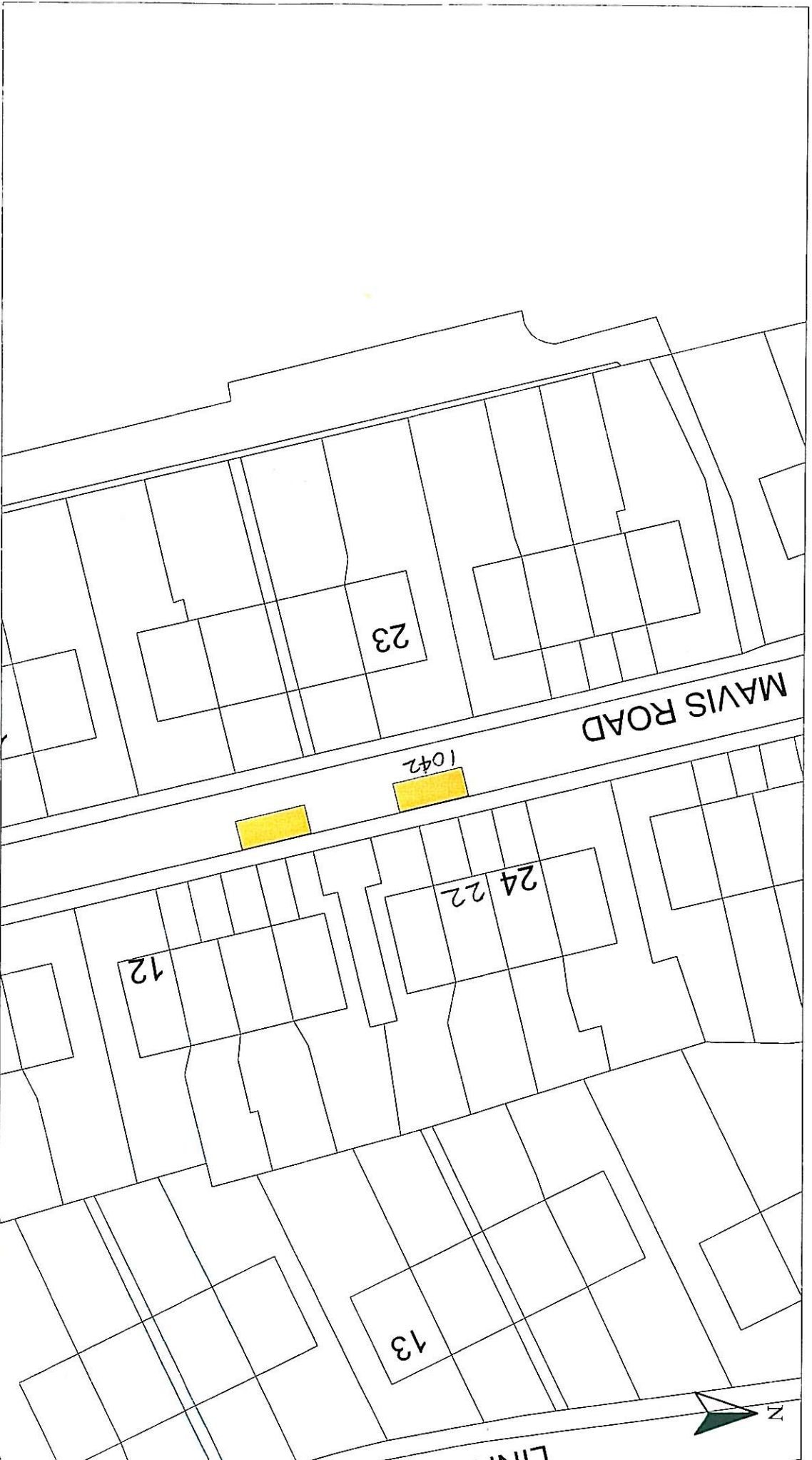

HEAD OF SERVICE  
ALAN G BARNES MCWM CENV

71 EAST HAMILTON STREET  
GREENOCK, PA15 2UA

Disabled Bays

Reproduced from Ordnance Survey mapping with the permission of the Controller of Her Majesty's Stationery Office. Crown Copyright. Unauthorised reproduction infringes Crown Copyright and may result in prosecution or legal proceedings.

Licence No. LA03097L



**DISABLED PERSONS' PARKING PLACE**

**22 MAVIS ROAD, GREENOCK**

PLACE No. 1042

|               |           |               |          |
|---------------|-----------|---------------|----------|
| Scale :       | 1:500     | Date :        | NOV 2010 |
| Prepared by : | R. MACKAY | Checked by :  |          |
| Drawn by :    | R. MACKAY | Approved by : |          |
| Drawing No. : |           | File No. :    | 19/12    |



|   |  |  |  |
|---|--|--|--|
| HEAD OF SERVICE<br>ALAN G BARNES MCIVM CENV   |  | Disabled Bays  |  |
| 71 EAST HAMILTON STREET<br>GREENOCK, PA15 2UA |  | Disabled Persons' Parking Place<br>6 DUNLOP STREET, GREENOCK<br>PLACE No. 1043 |  |
| Scale : 1:500                                 |  | Date : NOV 2010  |  |
| Prepared by : R. MACKAY                       |  | Checked by :   |  |
| Drawn by : R. MACKAY                          |  | Approved by :  |  |
| Drawing No. :                                 |  | File No. : 19/12   |  |

Reproduced from Ordnance Survey mapping with the permission of the Controller Her Majesty's Stationery Office. Copyright. Unauthorised reproduction infringes Crown Copyright and may result in prosecution or legal proceedings.

License No. LA03097L

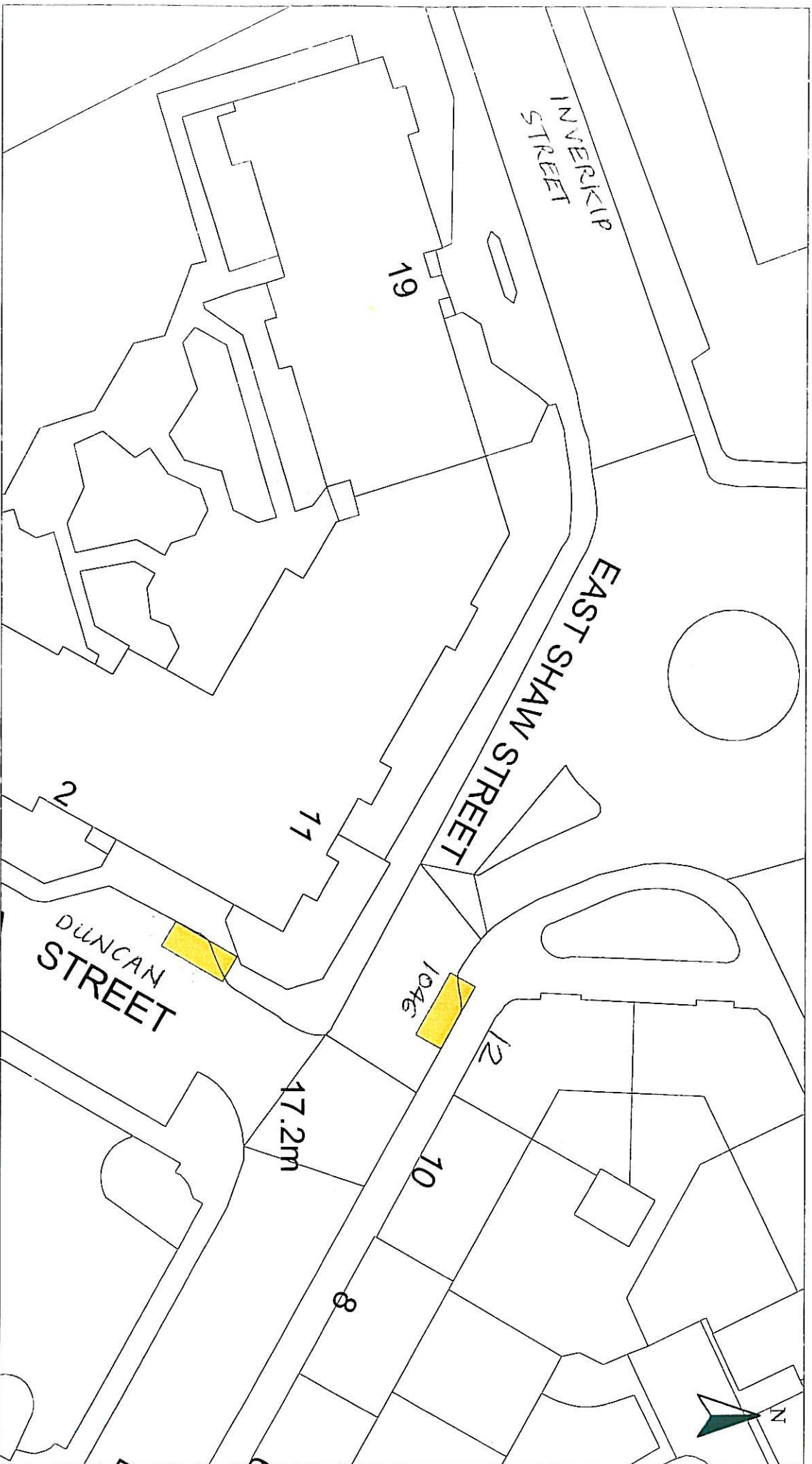

HEAD OF SERVICE  
ALAN G BARNES MCIVM CENV

71 EAST HAMILTON STREET  
GREENOCK, PA15 2UA

Reproduced from Ordnance Survey mapping with the permission of the Controller of Her Majesty's Stationery Office. Copyright. Unauthorised reproduction infringes Crown Copyright and may result in prosecution or legal proceedings.

Ordnance Survey  
Licence No. LA03097L

DISABLED PERSONS' PARKING PLACE  
12 EAST SHAW STREET, GREENOCK  
PLACE No. 1046

|               |           |               |          |
|---------------|-----------|---------------|----------|
| Scale :       | 1:500     | Date :        | NOV 2010 |
| Prepared by : | R. MACKAY | Checked by :  |          |
| Drawn by :    | R. MACKAY | Approved by : |          |
| Drawing No. : |           | File No. :    | 19/12    |

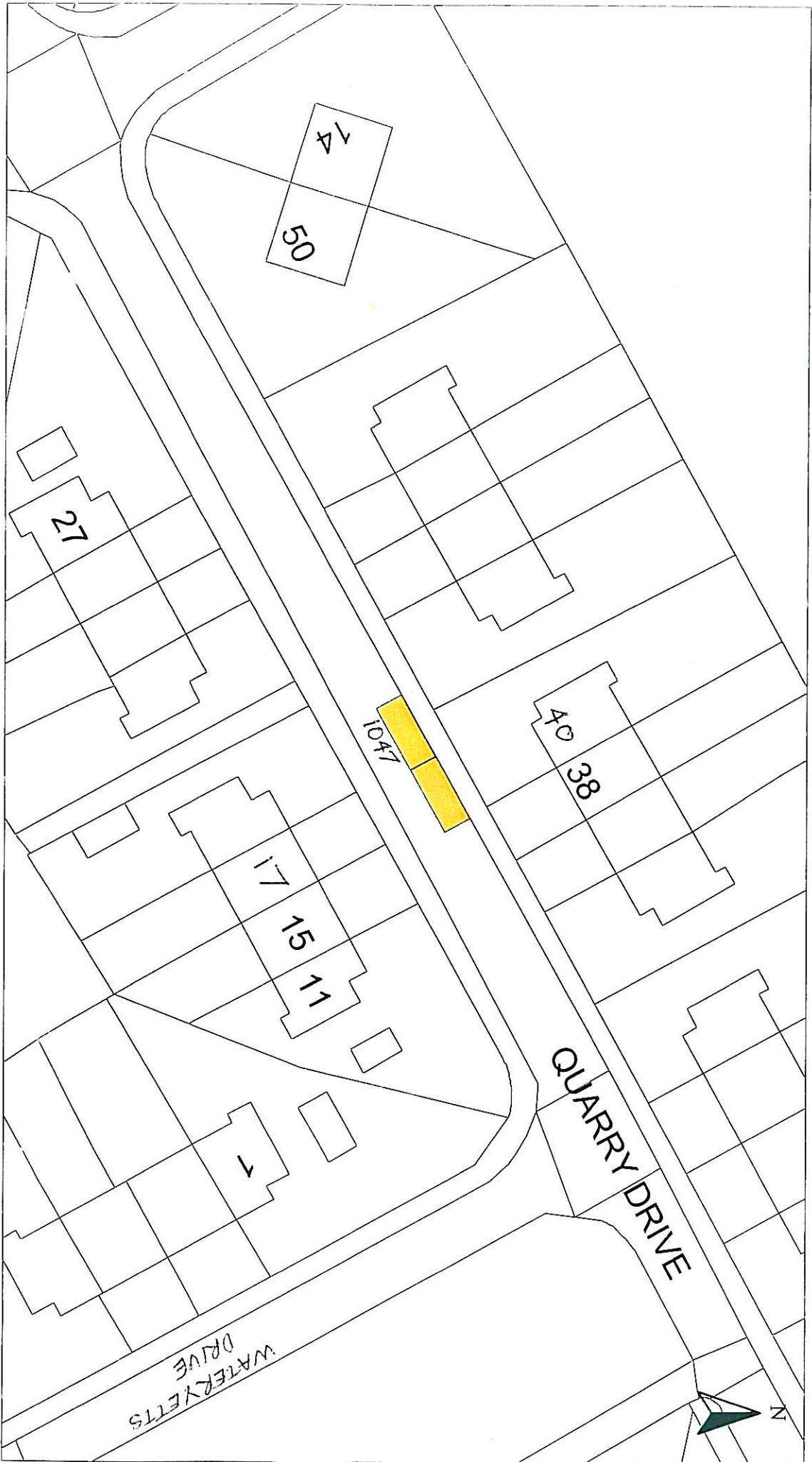

HEAD OF SERVICE  
ALAN G BARNES MCJWM CENV  
71 EAST HAMILTON STREET  
GREENOCK, PA15 2UA

Particulars from Ordnance Survey mapping with the permission of the Controller of Her Majesty's Stationery Office. Copyright, Unauthorised reproduction infringes Crown Copyright and may result in prosecution or legal proceedings.  
Licence No. LA03097L  
 Ordnance Survey

DISABLED PERSONS' PARKING PLACE  
40 QUARRY DRIVE, KILMACOLM  
PLACE No. 1047

|               |           |               |          |
|---------------|-----------|---------------|----------|
| Scale :       | 1:500     | Date :        | NOV 2010 |
| Prepared by : | R. MACKAY | Checked by :  |          |
| Drawn by :    | R. MACKAY | Approved by : |          |
| Drawing No. : |           | File No. :    | 19/12    |



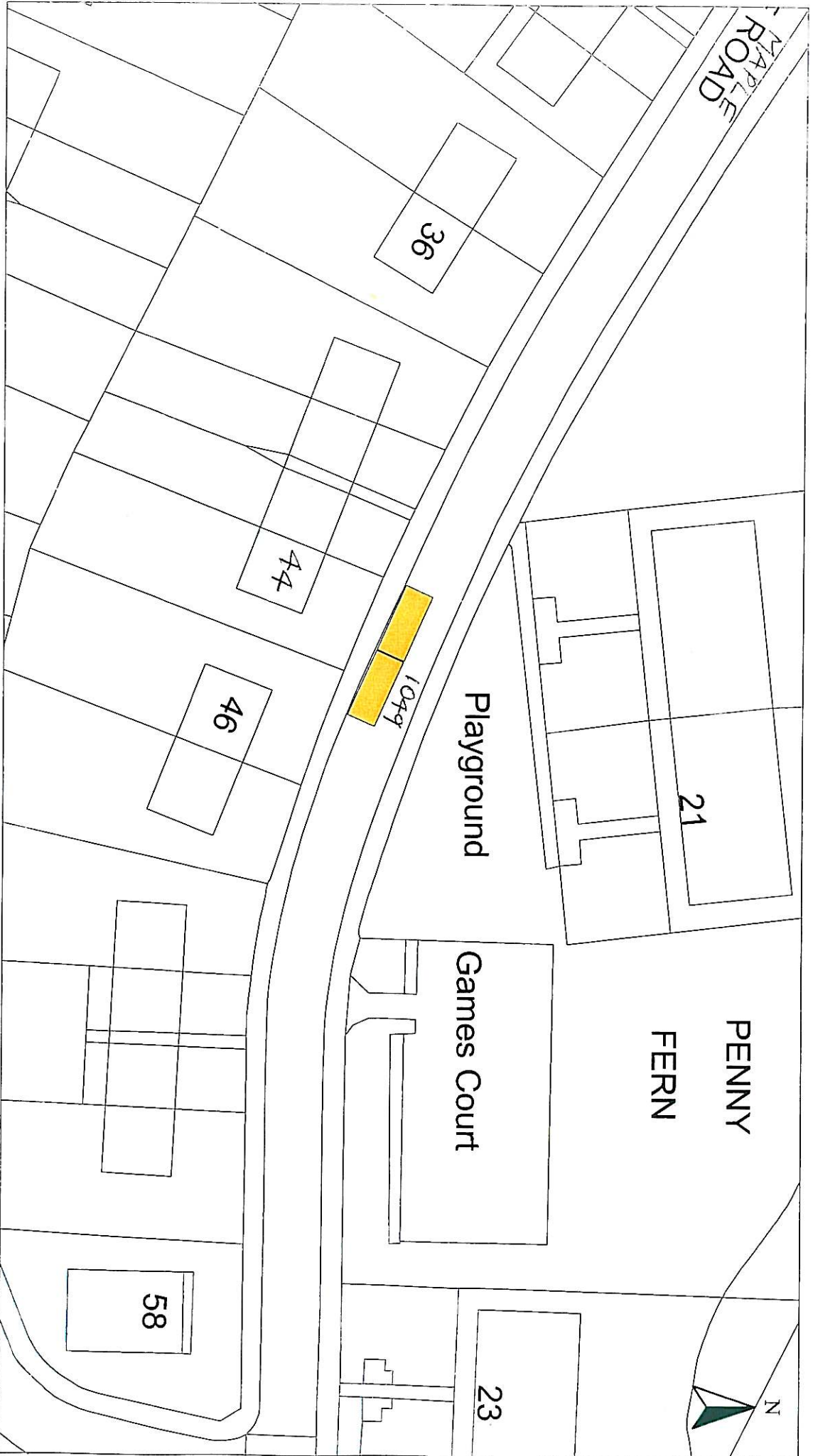

|  |  |                         |  |
|--|--|-------------------------|--|
| HEAD OF SERVICE<br>ALAN G BARNES MCIMM CENV  |  | Prepared by : R. MACKAY |  |
| Disabled Bays<br>71 EAST HAMILTON STREET<br>GREENOCK, PA15 2UA   |  | Checked by :            |  |
| Standard from: Ordnance Survey mapping with the permission of the Controller of Her Majesty's Stationery Office. Crown Copyright and map made in preparation of legal proceedings. |  | Date : NOV 2010         |  |
| Licence No. LA03097L   |  | Approved by :           |  |
|  |  | File No. : 19/12        |  |
| DISABLED PERSONS' PARKING PLACE<br>46 MAPLE ROAD, GREENOCK<br>PLACE No. 1049   |  | Drawing No. :           |  |

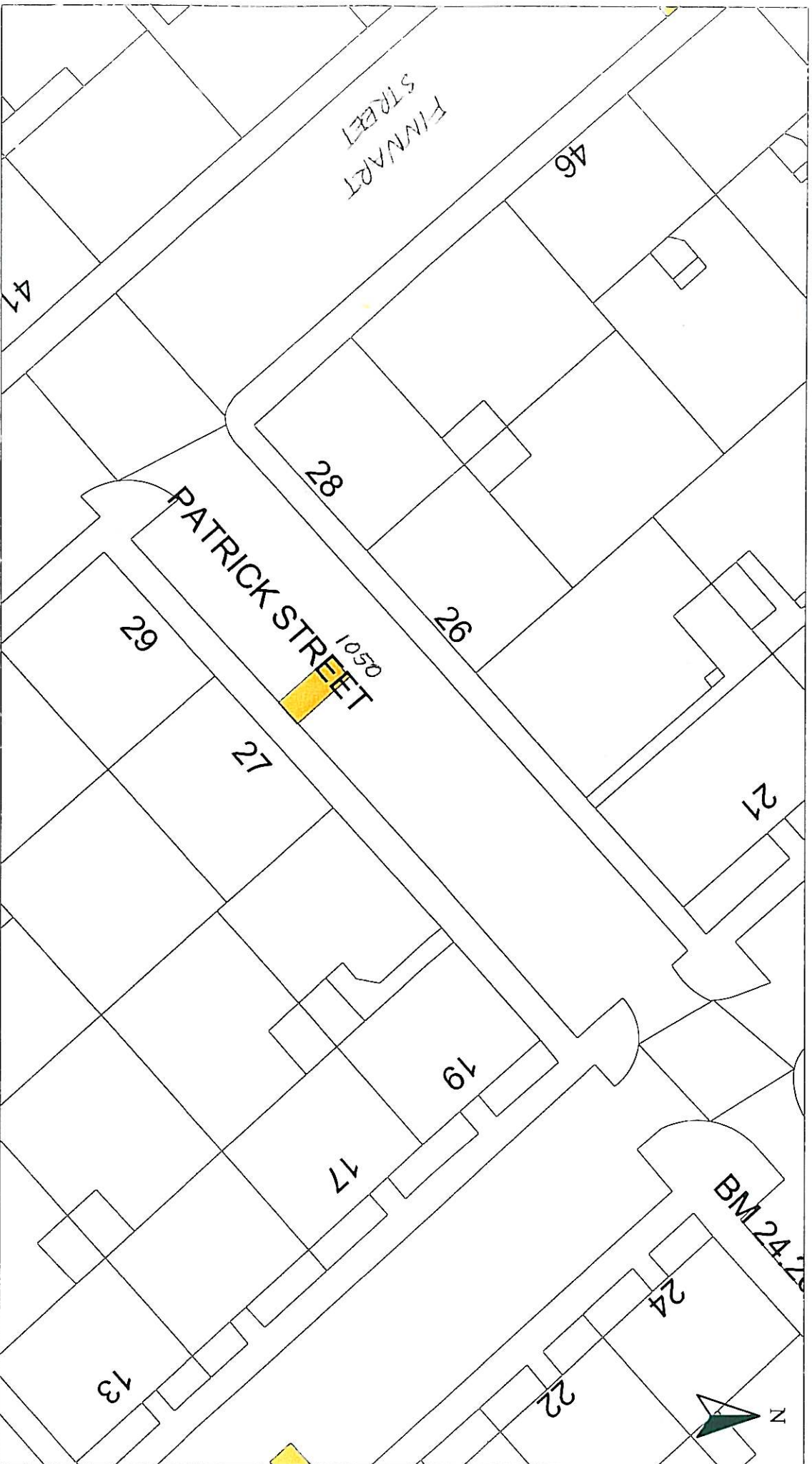

HEAD OF SERVICE  
ALAN G BARNES MCJWM CENV

Disabled Bays

71 EAST HAMILTON STREET  
GREENOCK, PA15 2UA

Reproduced from Ordnance Survey mapping with the permission of the Controller of Her Majesty's Stationery Office. Crown Copyright. Unauthorised reproduction infringes Crown Copyright and may result in prosecution or legal proceedings.

Licence No. LA03097L



DISABLED PERSONS' PARKING PLACE

27 PATRICK STREET, GREENOCK

PLACE No 1050

Scale : 1:500

Date : NOV 2010

Prepared by : R. MACKAY

Checked by :

Drawn by : R. MACKAY

Approved by :

Drawing No. :

File No. : 19/12

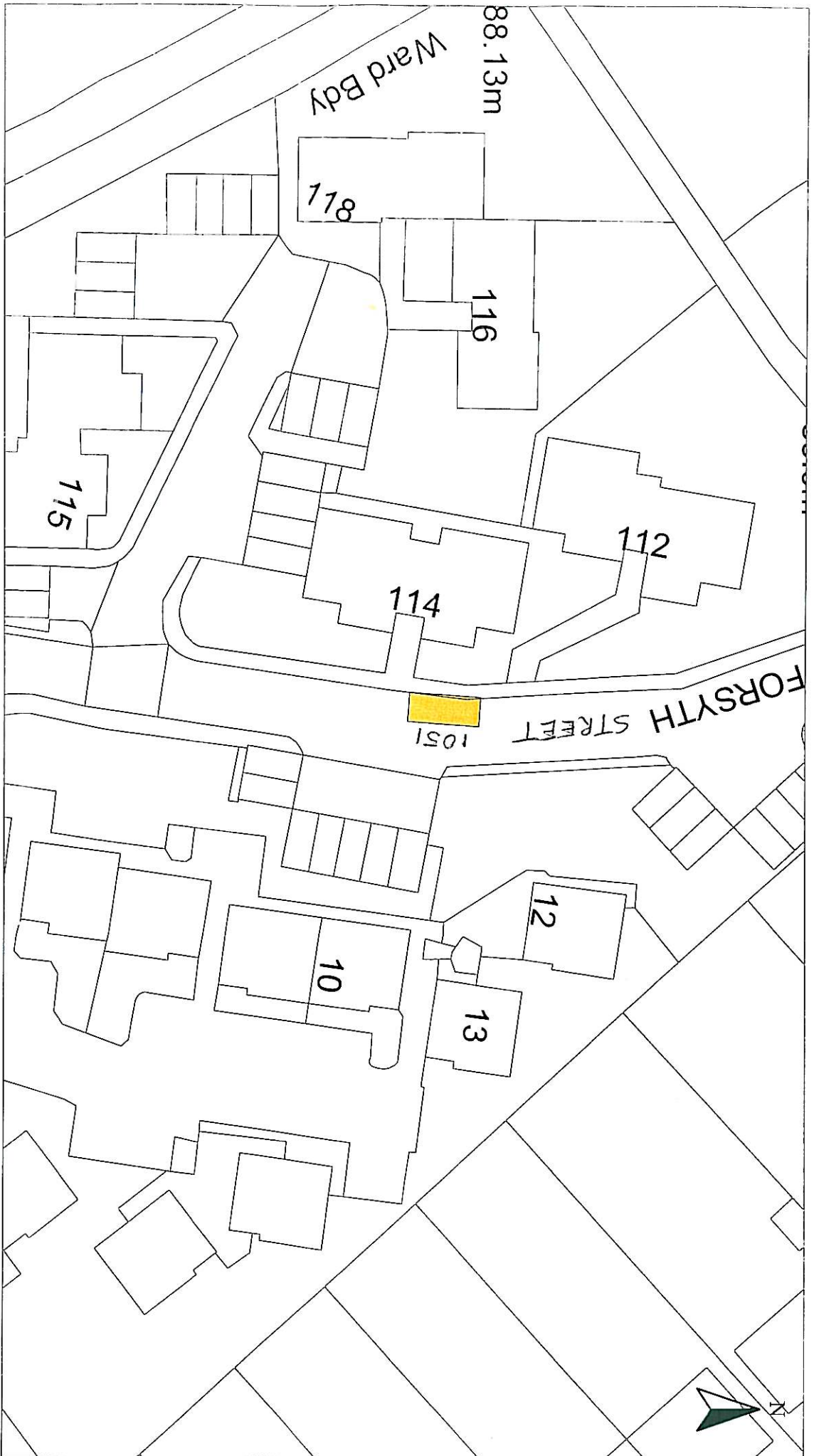

HEAD OF SERVICE  
ALAN G BARNES MCIWM CENV

Disabled Bays  
71 EAST HAMILTON STREET  
GREENOCK, PA15 2UA

Reproduced from Ordnance Survey mapping with the permission of the Controller of Her Majesty's Stationery Office. Crown Copyright and may result in prosecution or legal proceedings.

License No. LA03097L



DISABLED PERSONS' PARKING PLACE

114 FORSYTH STREET, GREENOCK

PLACE No. 1051

Scale : 1:500

Date : NOV 2010

Prepared by : R. MACKAY

Checked by :

Drawn by : R. MACKAY

Approved by :

Drawing No. :

File No. : 19/12

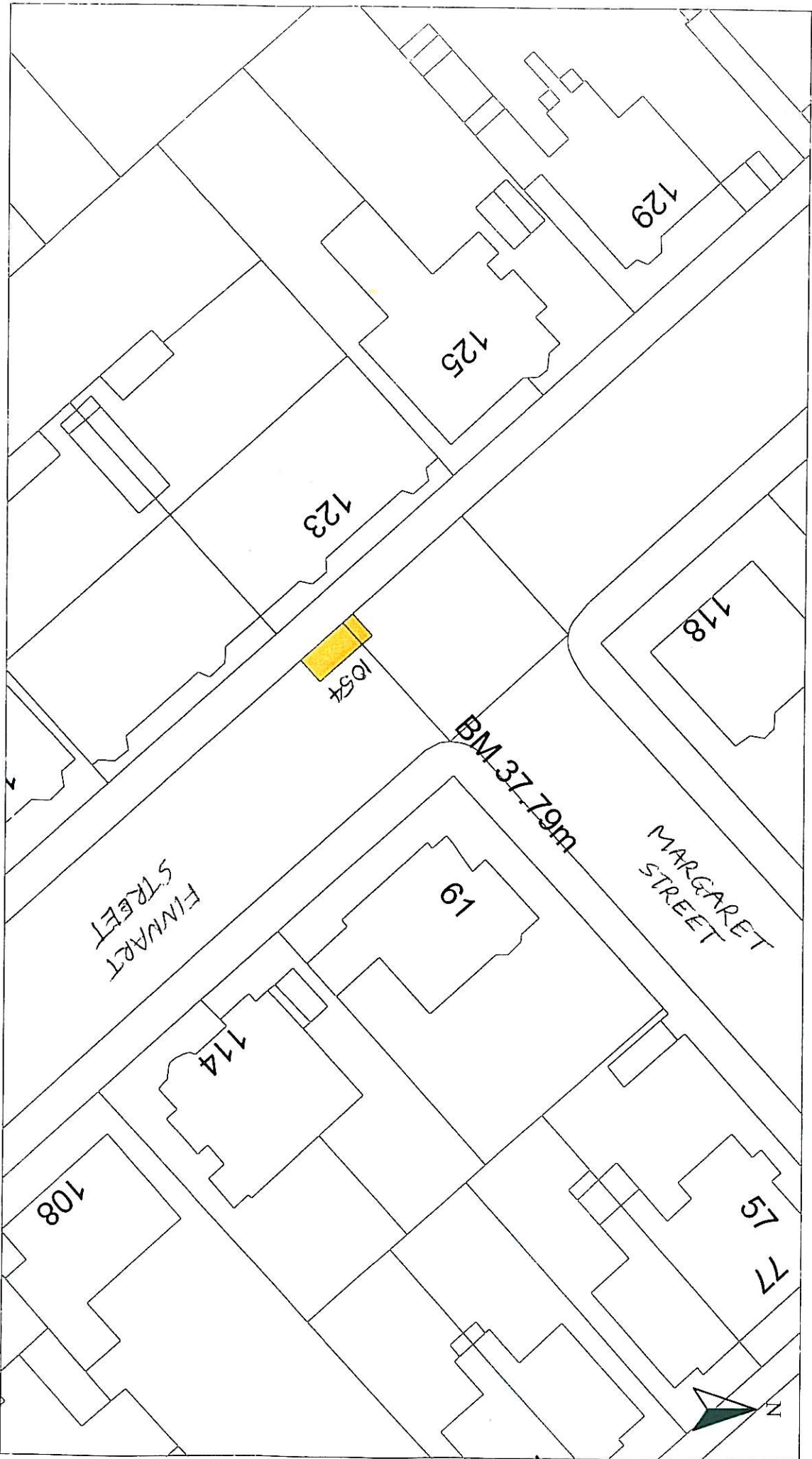

HEAD OF SERVICE  
ALAN G BARNES MCWM CENV  
71 EAST HAMILTON STREET  
GREENOCK, PA15 2UA

Reproduced from Ordnance Survey mapping with the permission of the Controller of Her Majesty's Stationery Office. Crown Copyright. Unauthorised reproduction infringes Crown Copyright and may result in prosecution or legal proceedings.  
Licence No. LA03097L  

DISABLED PERSONS' PARKING PLACE  
123 FINNART STREET, GREENOCK  
PLACE No 1054

|               |           |               |          |
|---------------|-----------|---------------|----------|
| Scale :       | 1:500     | Date :        | NOV 2010 |
| Prepared by : | R. MACKAY | Checked by :  |          |
| Drawn by :    | R. MACKAY | Approved by : |          |
| Drawing No. : |           | File No. :    | 19/12    |

Disabled Bays

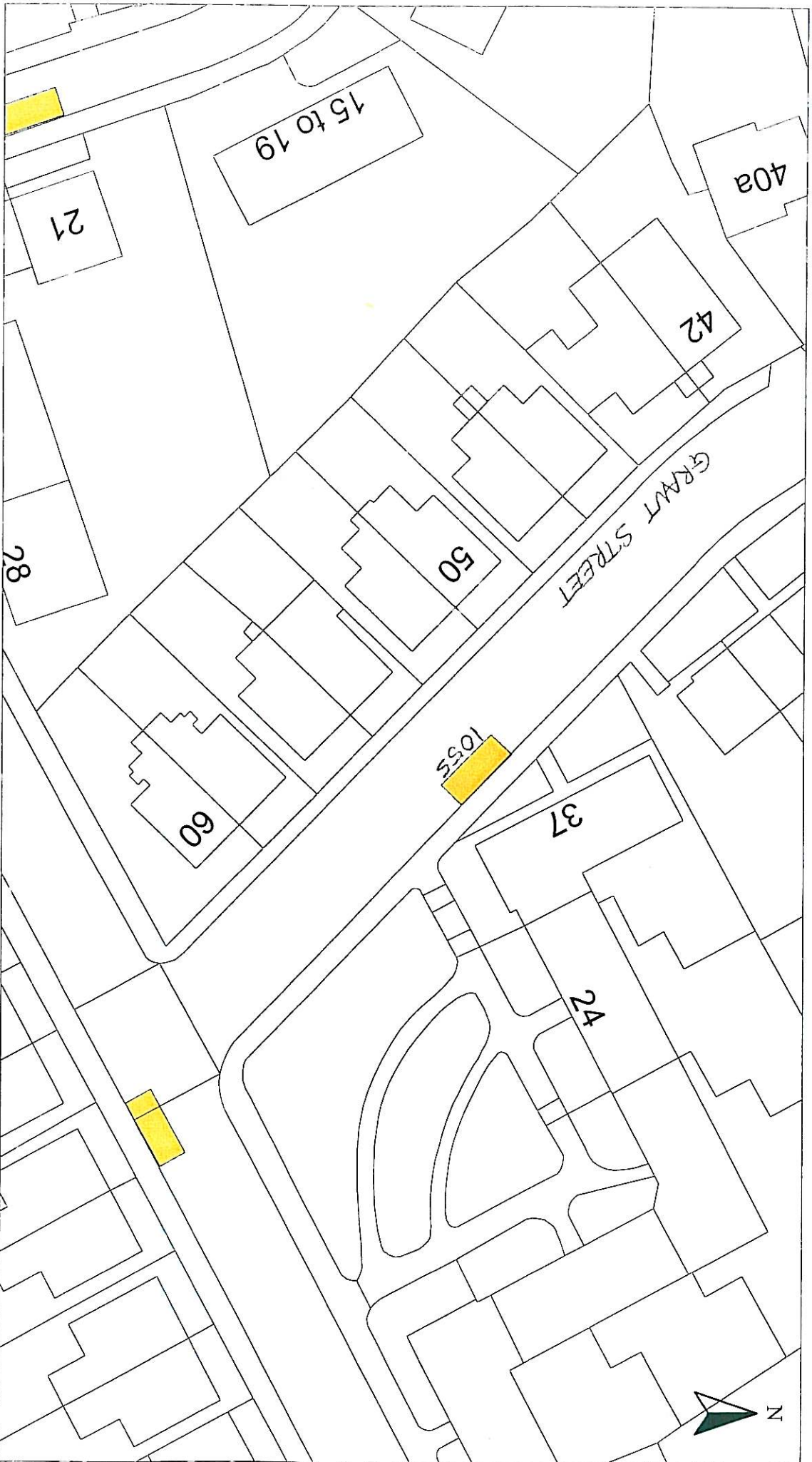

HEAD OF SERVICE  
ALAN G BARNES MCJWM CENV

Disabled Bays  
71 EAST HAMILTON STREET  
GREENOCK, PA15 2UA

Reproduced from Ordnance Survey mapping with the permission of the Controller of Her Majesty's Stationery Office. Crown Copyright. Unauthorised reproduction infringes Crown Copyright and may result in prosecution or legal proceedings.

Licence No. LA03097L



DISABLED PERSONS' PARKING PLACE

37 GRANT STREET, GREENOCK  
PLACE No. 1055

Scale : 1:500 Date : NOV 2010

Prepared by : R. MACKAY Checked by :

Drawn by : R. MACKAY Approved by :

Drawing No. : File No. : 19/12

# Inverclyde council

## ENVIRONMENTAL & COMMERCIAL SERVICES

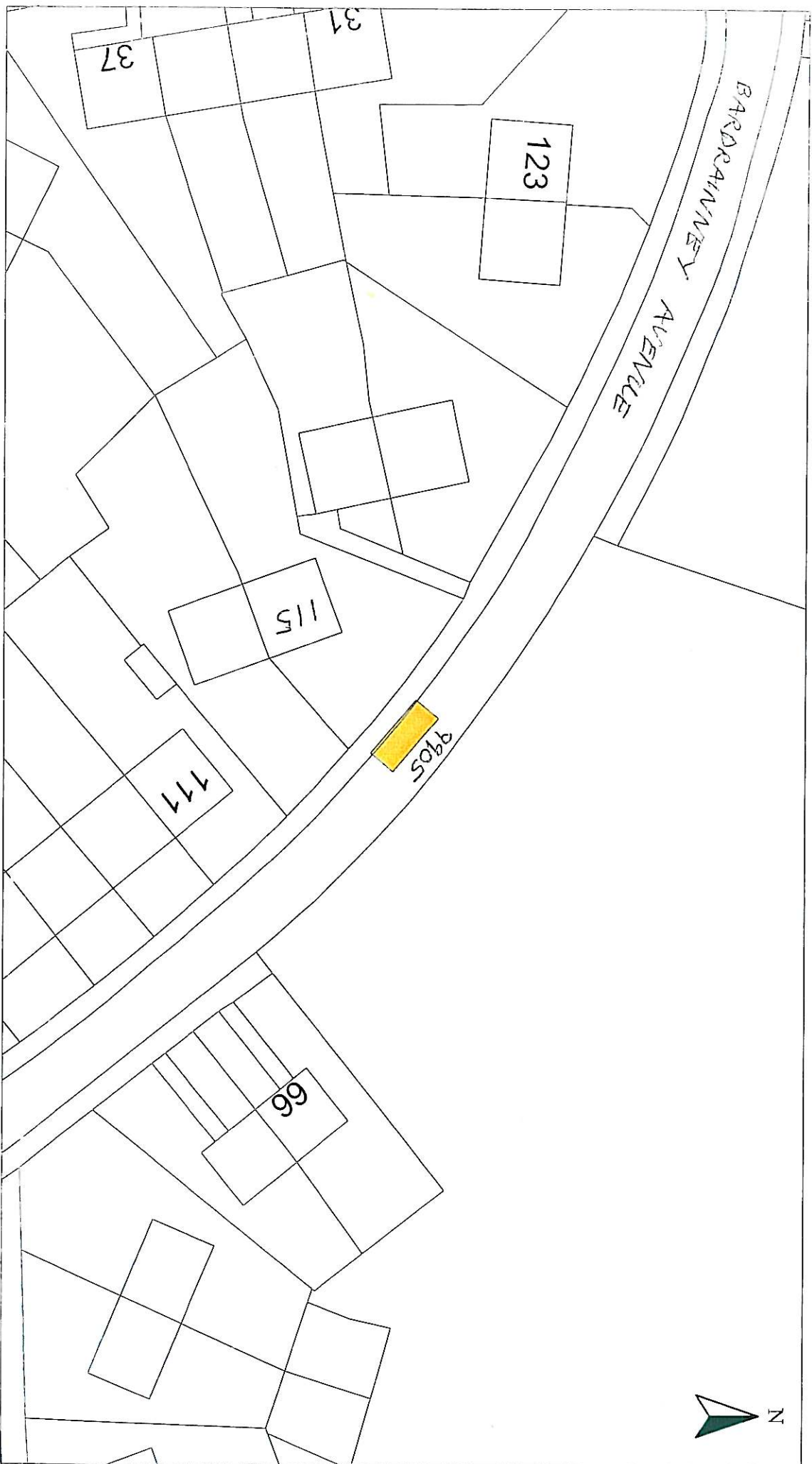

HEAD OF SERVICE  
ALAN G BARNES MCIWM CEIV

71 EAST HAMILTON STREET  
GREENOCK, PA15 2UA

Disabled Bays

Reproduced from Ordnance Survey mapping with the permission of the Controller of Her Majesty's Stationery Office. Crown Copyright. Unauthorised reproduction infringes Crown Copyright and may result in prosecution or legal proceedings.

Licence No. LA03037L



**DISABLED PERSONS' PARKING PLACE**  
115 BARRAINNEY AVE, PORT GLASGOW  
PLACE No. 9905 REVOCATION

|               |           |               |          |
|---------------|-----------|---------------|----------|
| Scale :       | 1:500     | Date :        | NOV 2010 |
| Prepared by : | R. MACKAY | Checked by :  |          |
| Drawn by :    | R. MACKAY | Approved by : |          |
| Drawing No. : |           | File No. :    | 19/12    |

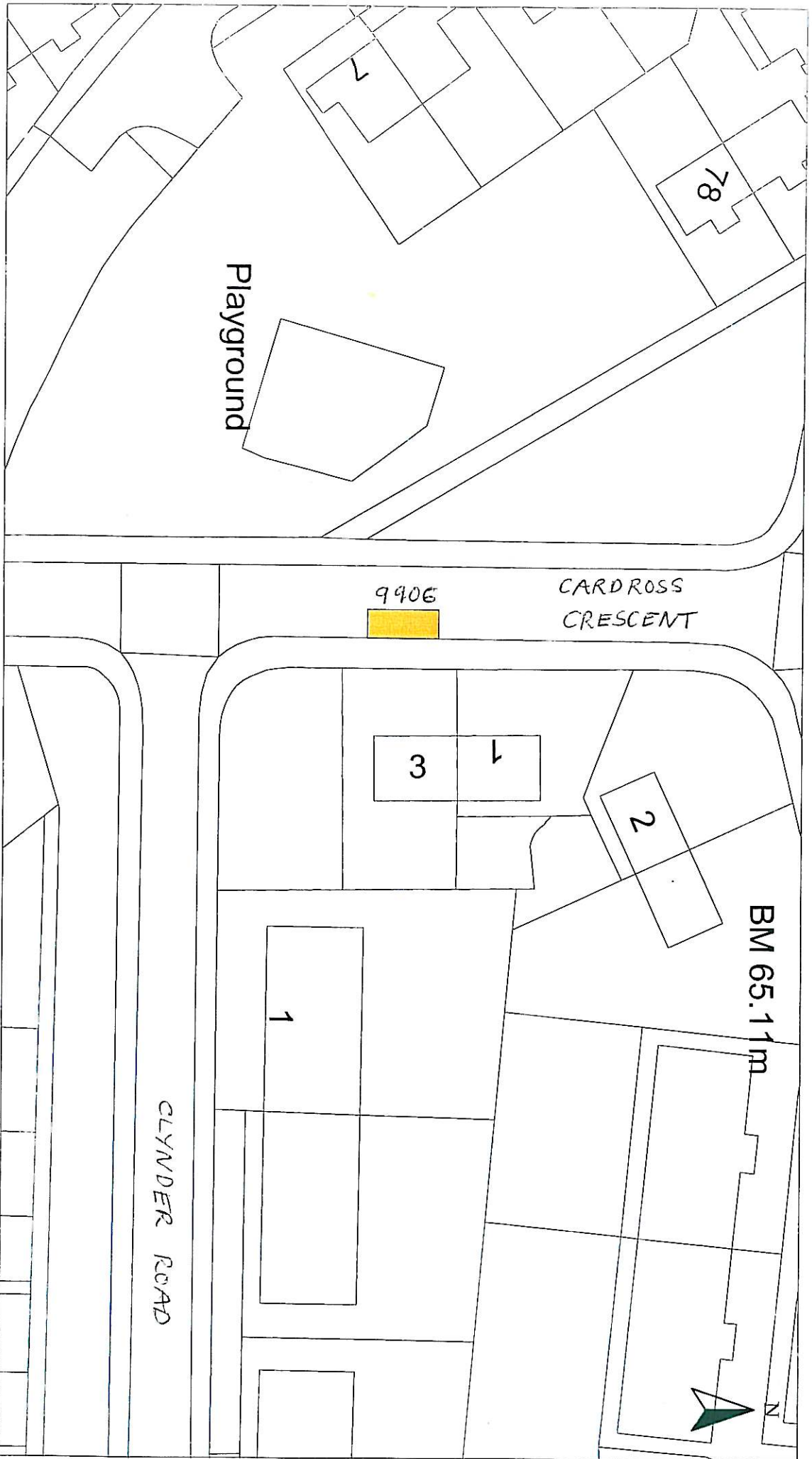

HEAD OF SERVICE  
ALAN G BARNES MCWM CENV

Disabled Bays

71 EAST HAMILTON STREET  
GREENOCK, PA15 2UA

Reproduced from Ordnance Survey mapping with the permission  
of the Ordnance Survey. All Rights Reserved. Crown  
Copyright. Ordnance Survey is a registered trademark  
and may result in prosecution of legal proceedings.

License No. LA03097L

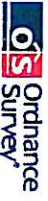

DISABLED PERSONS' PARKING PLACE  
3 CARDROSS CRESCENT, GREENOCK  
PLACE No. 9906 REVOCATION

Scale : 1:500

Prepared by : R. MACKAY

Drawn by : R. MACKAY

Drawing No. :

Date : NOV 2010

Checked by :

Approved by :

File No. :

19/12

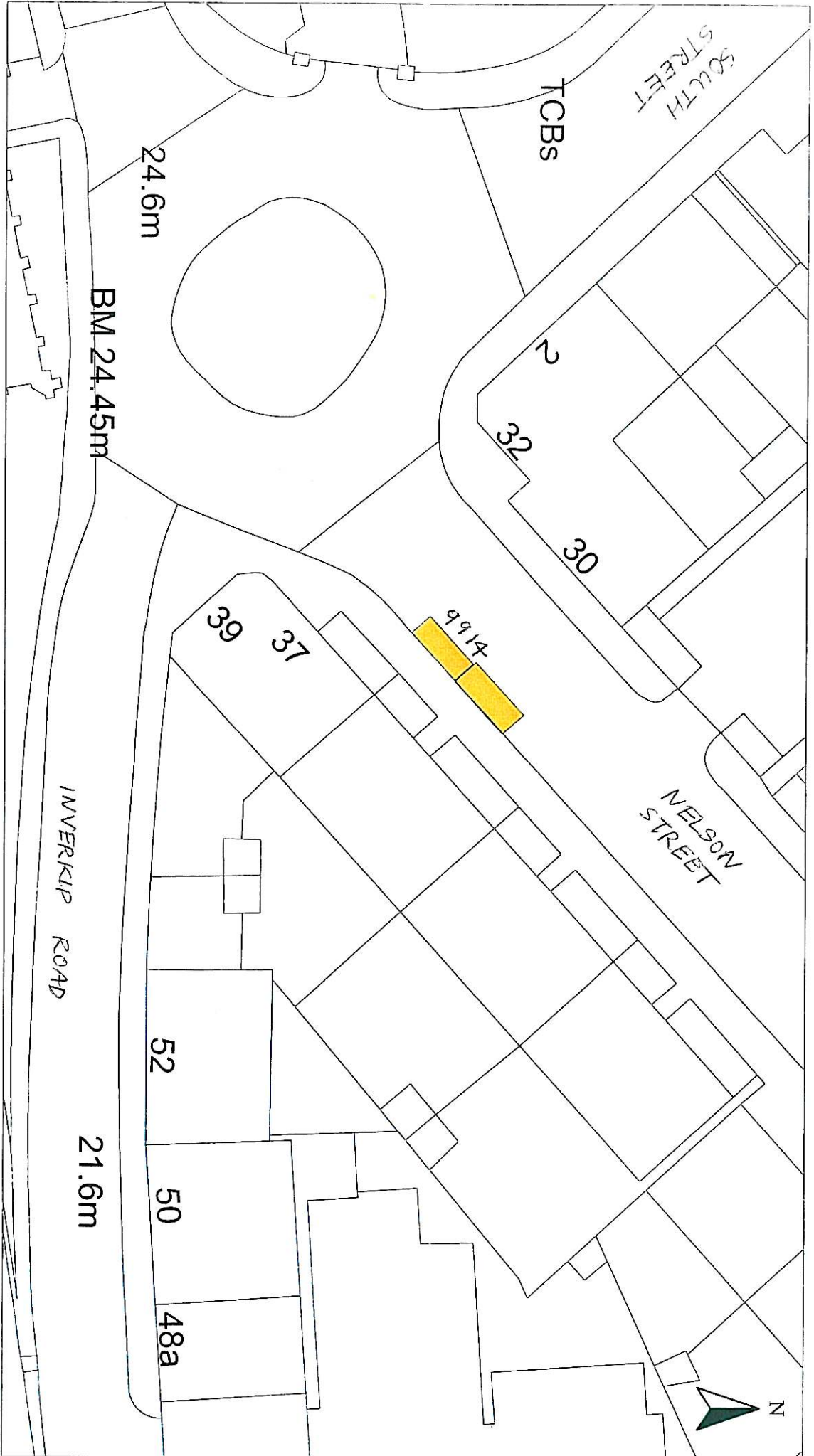

|  |  |  |  |
|--|--|--|--|
| HEAD OF SERVICE<br>ALAN G BARNIES MCIVM CEHV   |  | Prepared from Ordnance Survey mapping with the permission of the Ordnance Survey. All rights reserved. Copyright. Unauthorised reproduction in any form and by any means in electronic, mechanical, photocopying, recording, or by any information storage and retrieval system is prohibited. |  |
| Disabled Bays<br>71 EAST HAMILTON STREET<br>GREENOCK, PA15 2UA                             |  | Licence No. LA03097L<br>   |  |
| DISABLED PERSONS' PARKING PLACE<br>37 NELSON STREET, GREENOCK<br>PLACE No. 9914 REVOCATION |  | Scale : 1:500<br>Prepared by : R. MACKAY<br>Drawn by : R. MACKAY<br>Drawing No. :  |  |
|  |  | Date : NOV 2010<br>Checked by :<br>Approved by :<br>File No. : 19/12   |  |



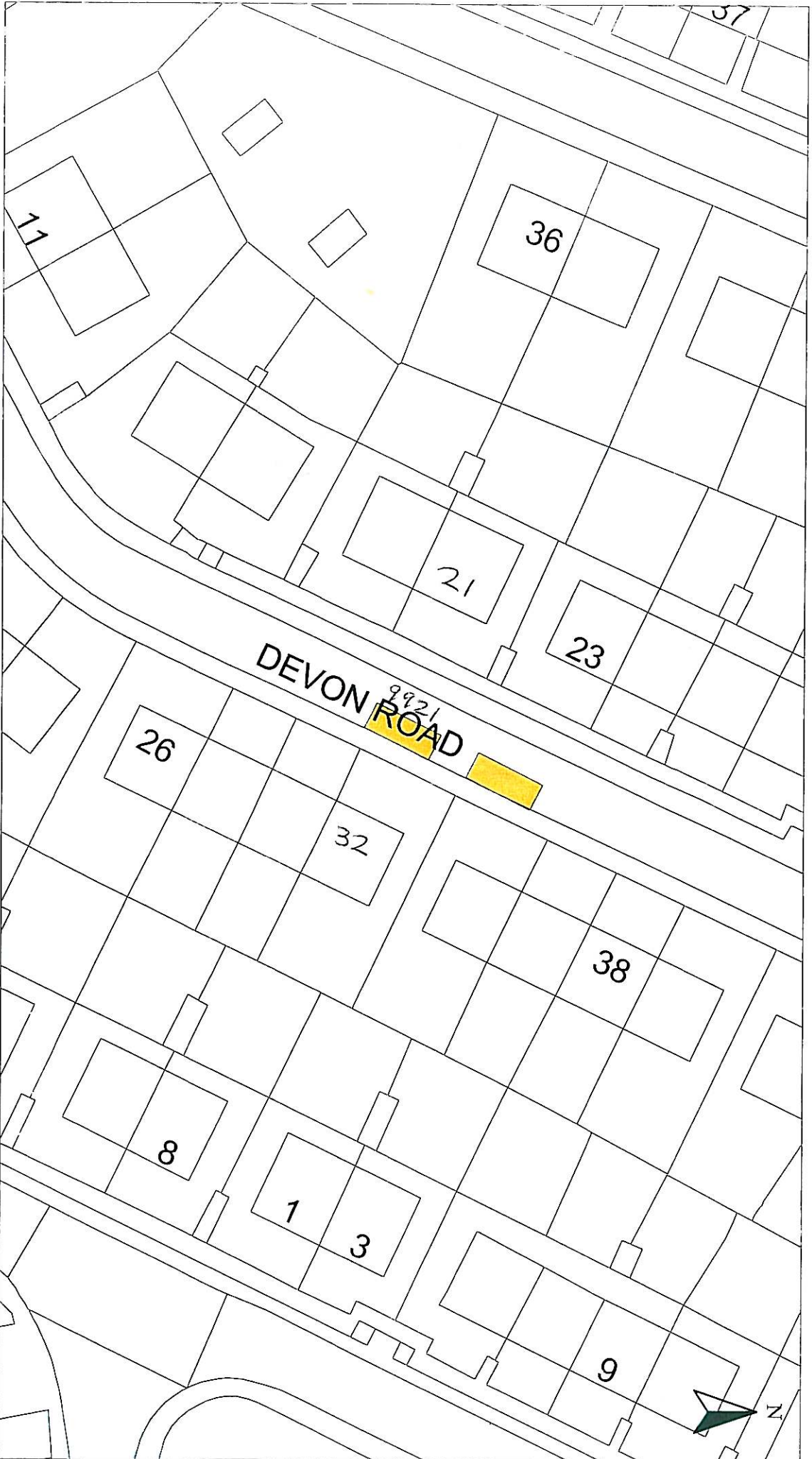

HEAD OF SERVICE  
ALAN G BARNES MCIMM CENV

Disabled Bays

71 EAST HAMILTON STREET  
GREENOCK, PA15 2UA

Reproduced from Ordnance Survey mapping with the permission of the Controller of Her Majesty's Stationery Office. Crown Copyright. Unauthorised reproduction infringes Crown Copyright and may result in prosecution or legal proceedings.

Licence No. LA03097L



DISABLED PERSONS' PARKING PLACE

21 DEVON ROAD, GREENOCK  
PLACE No. 9921 REVOCATION

Scale : 1:500

Date : NOV 2010

Prepared by : R. MACKAY

Checked by :

Drawn by : R. MACKAY

Approved by :

Drawing No. :

File No. : 19/12

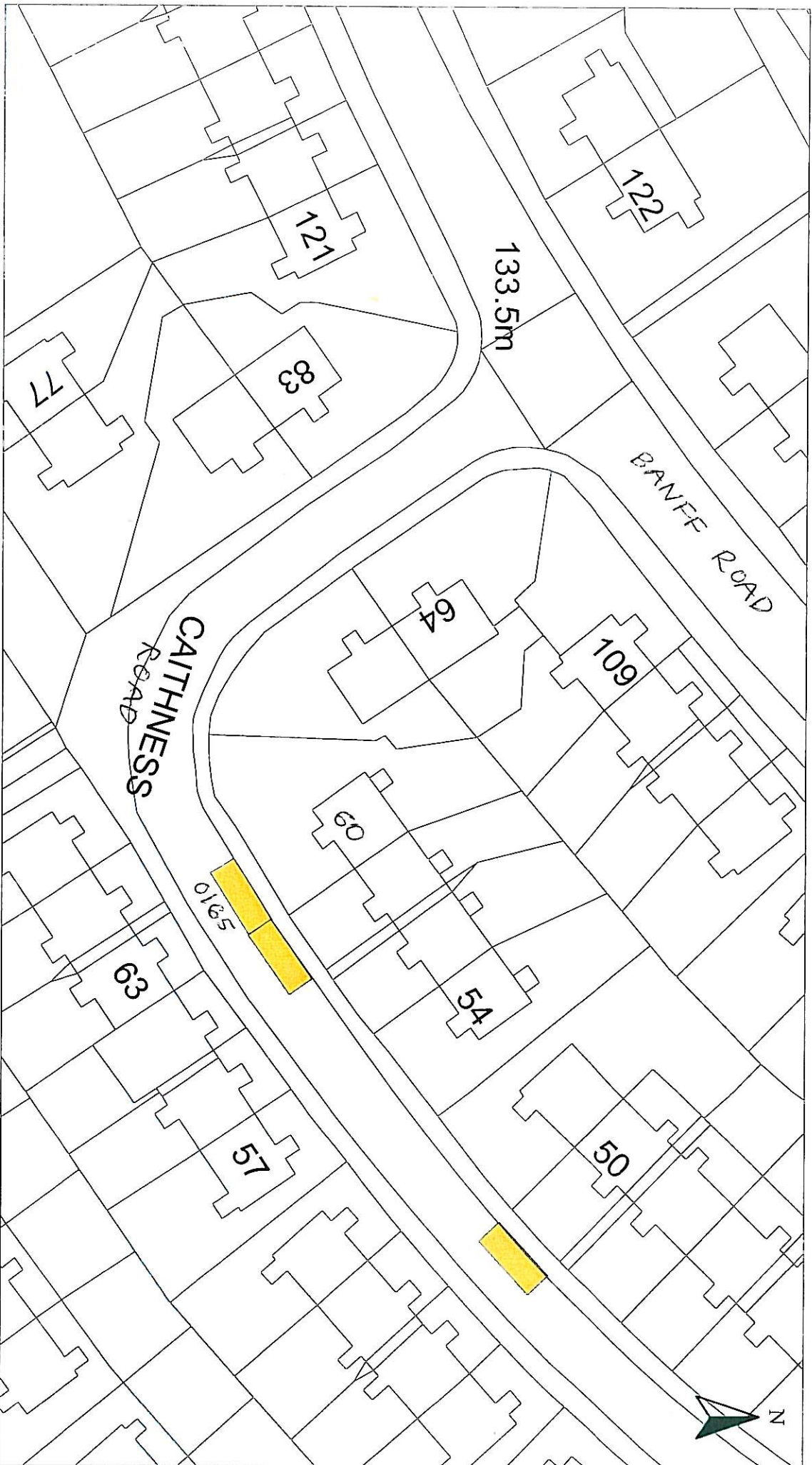

HEAD OF SERVICE  
ALAN G BARNES MCJWM CENV

Disabled Bays

71 EAST HAMILTON STREET  
GREENOCK, PA15 2UA

Reproduced from Ordnance Survey mapping with the permission of the Controller of Her Majesty's Stationery Office. Crown Copyright. Unauthorised reproduction infringes Crown Copyright and may result in prosecution or legal proceedings.

Licence No. LA03097L



DISABLED PERSONS' PARKING PLACE

60 CAITHNESS ROAD, GREENOCK  
PLACE No. 0165 REVOCATION

Scale : 1:500

Prepared by : R. MACKAY

Drawn by : R. MACKAY

Drawing No. :

Date : NOV 2010

Checked by :

Approved by :

File No. :

19/12

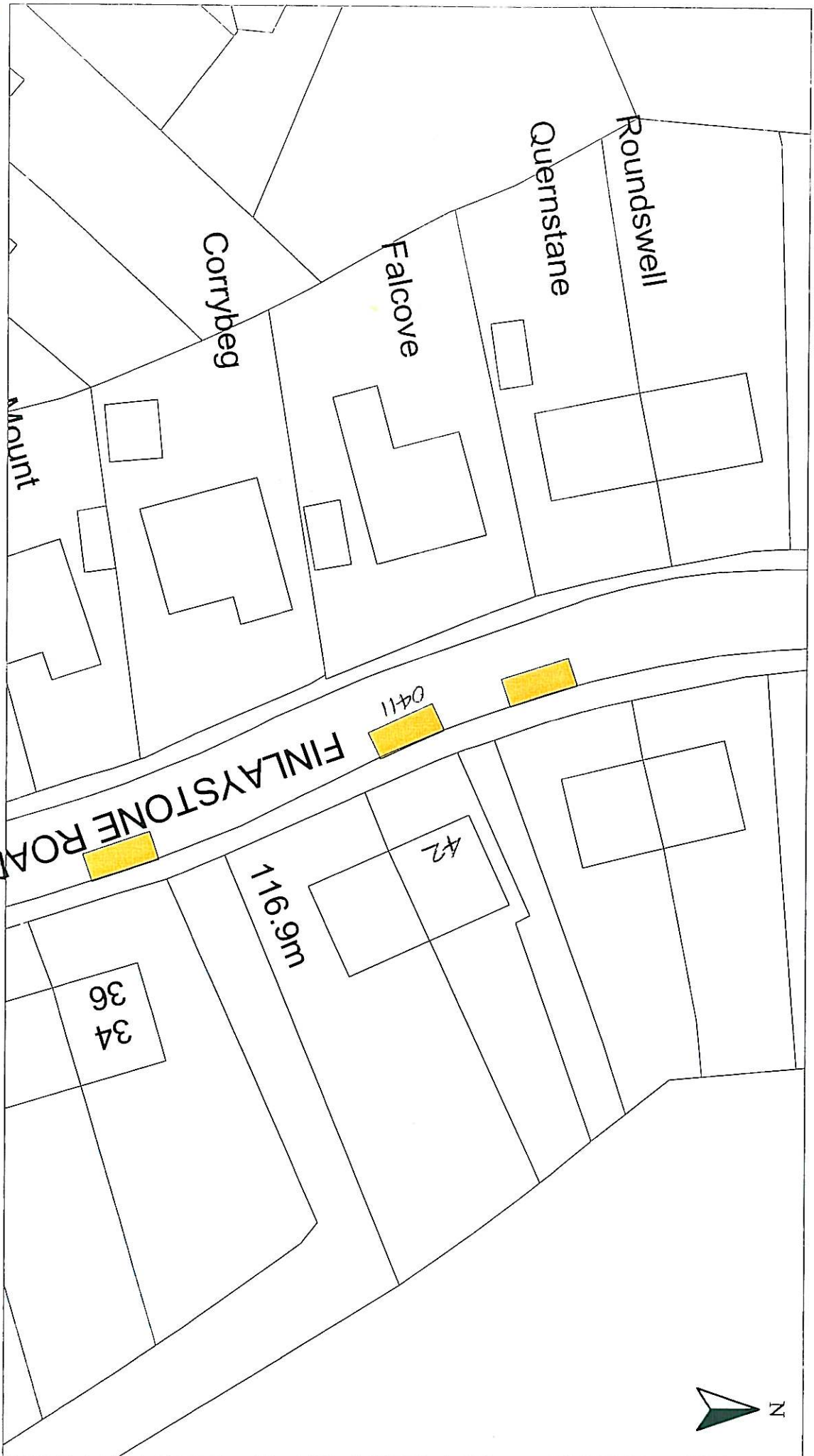

HEAD OF SERVICE  
ALAN G BARNES MCJWM CENV

71 EAST HAMILTON STREET  
GREENOCK, PA15 2UA

Reproduced from Ordnance Survey mapping with the permission of the Controller of Her Majesty's Stationery Office. Crown Copyright. Unauthorised reproduction infringes Crown Copyright and may result in prosecution or legal proceedings.

License No. LA03097L



DISABLED PERSONS' PARKING PLACE  
42 FINLAYSTONE ROAD, KILMACOLM  
PLACE No. 0411 REVOCATION

|               |           |               |          |
|---------------|-----------|---------------|----------|
| Scale :       | 1:500     | Date :        | NOV 2010 |
| Prepared by : | R. MACKAY | Checked by :  |          |
| Drawn by :    | R. MACKAY | Approved by : |          |
| Drawing No. : |           | File No. :    | 19/12    |

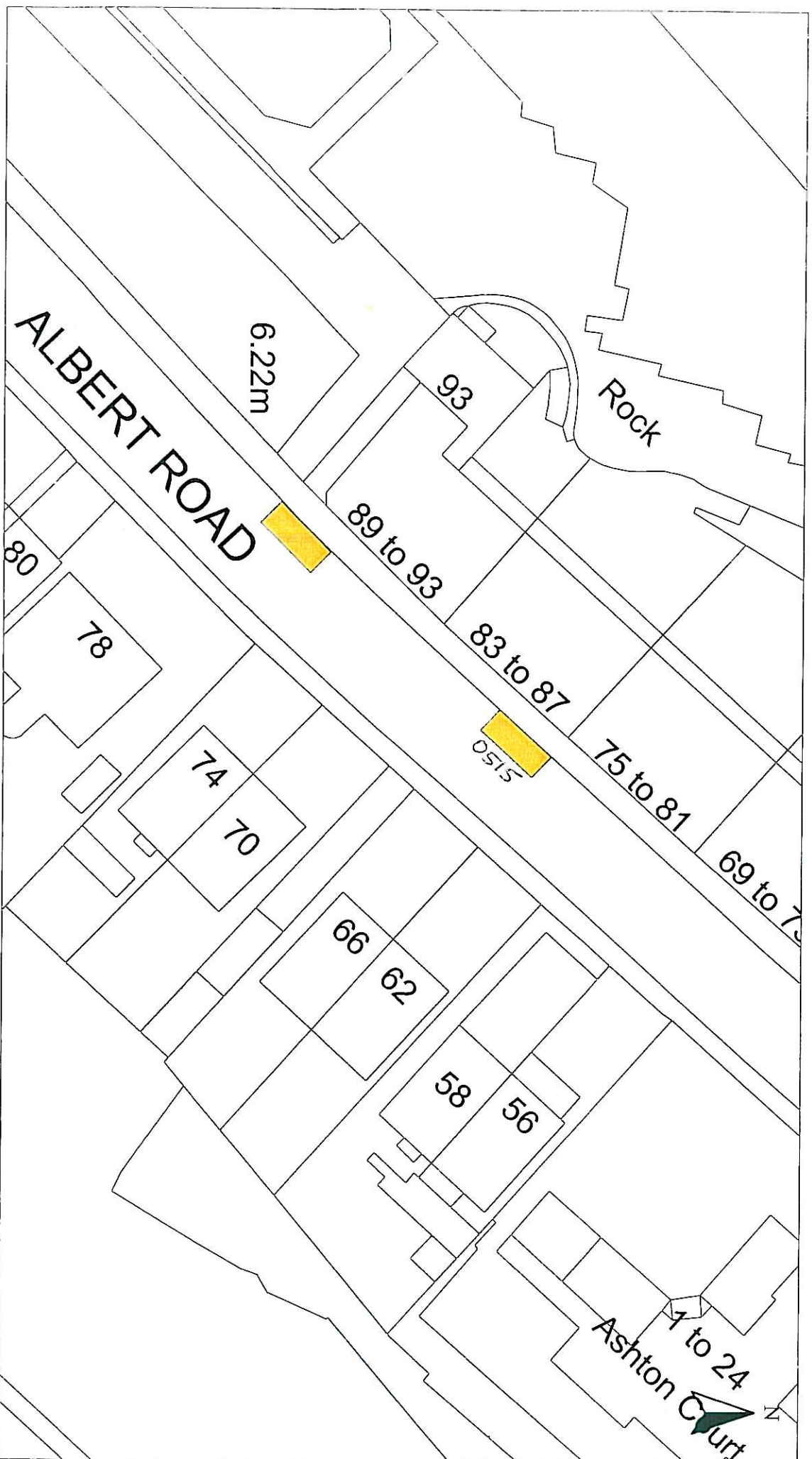

|  |           |   |          |
|--|-----------|---|----------|
| HEAD OF SERVICE<br>ALAN G BARNES MCJWM CEnv  |           | Disabled Bays                           |          |
| 71 EAST HAMILTON STREET<br>GREENOCK, PAIS 2UA  |           | License No. LA03097L                    |          |
| Disabled Persons' Parking Place<br>85 ALBERT ROAD, GOURROCK<br>PLACE No. 0515 REVOCATION |           | Ordnance Survey logo<br>Ordnance Survey |          |
| Scale :  | 1:500     | Date :                                  | NOV 2010 |
| Prepared by :  | R. MACKAY | Checked by :                            |          |
| Drawn by :   | R. MACKAY | Approved by :                           |          |
| Drawing No. :  |           | File No. :                              | 19/12    |

Reproduced from Ordnance Survey mapping with the permission of the Controller of Her Majesty's Stationery Office. Crown Copyright and may result in prosecution or legal proceedings.

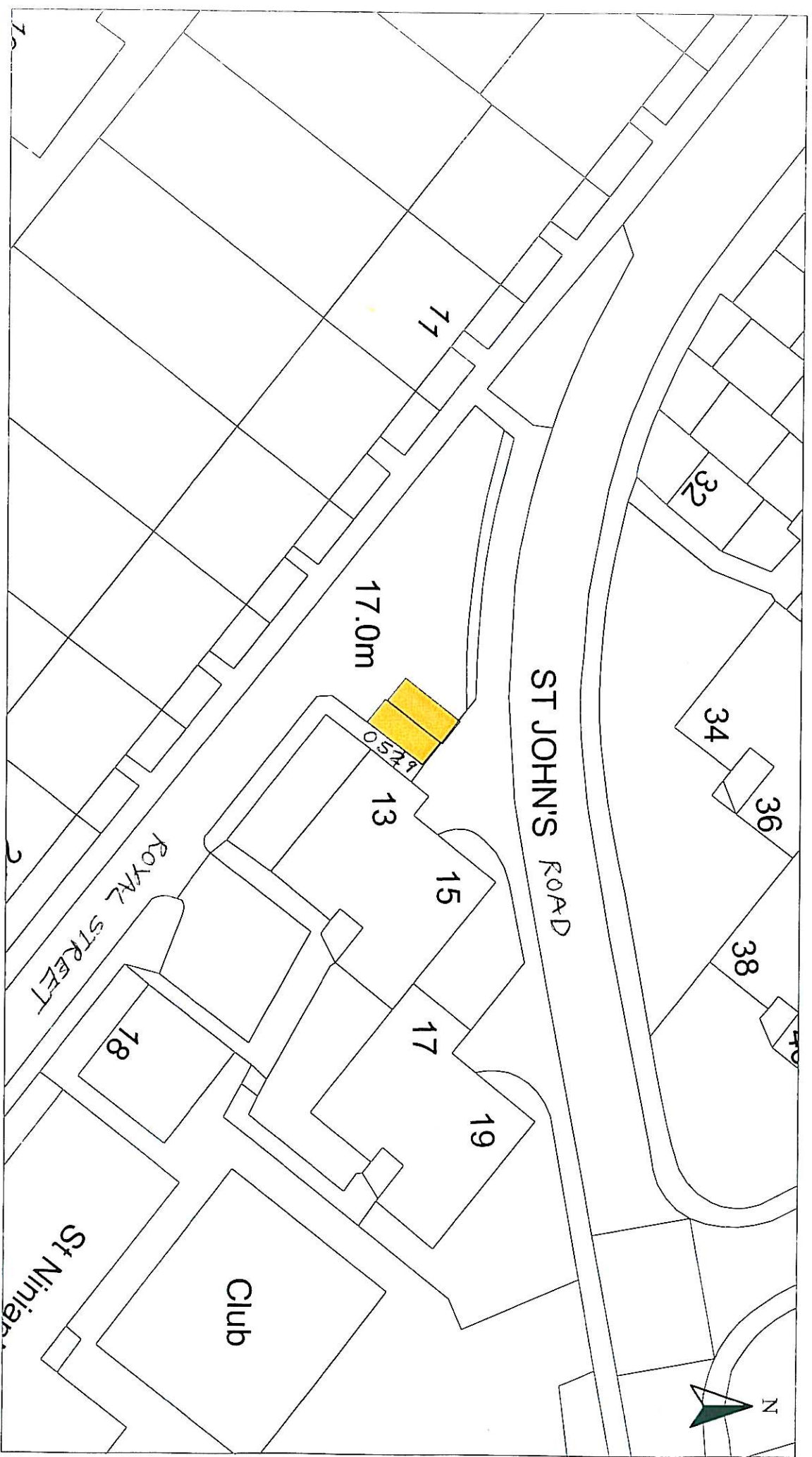

HEAD OF SERVICE  
ALAN G BARNES MCWM CENV

71 EAST HAMILTON STREET  
GREENOCK, PA15 2UA

Reproduced from Ordnance Survey mapping with the permission of the Controller of Her Majesty's Stationery Office. Crown Copyright. Unauthorised reproduction infringes Crown Copyright and may result in prosecution or legal proceedings.

Licence No. LA03097L

DISABLED PERSONS' PARKING PLACE

13B ST JOHN'S ROAD, GOUROCK  
PLACE No. 0529 REVOCATION

|               |           |               |          |
|---------------|-----------|---------------|----------|
| Scale :       | 1:500     | Date :        | NOV 2010 |
| Prepared by : | R. MACKAY | Checked by :  |          |
| Drawn by :    | R. MACKAY | Approved by : |          |
| Drawing No. : |           | File No. :    | 19/12    |

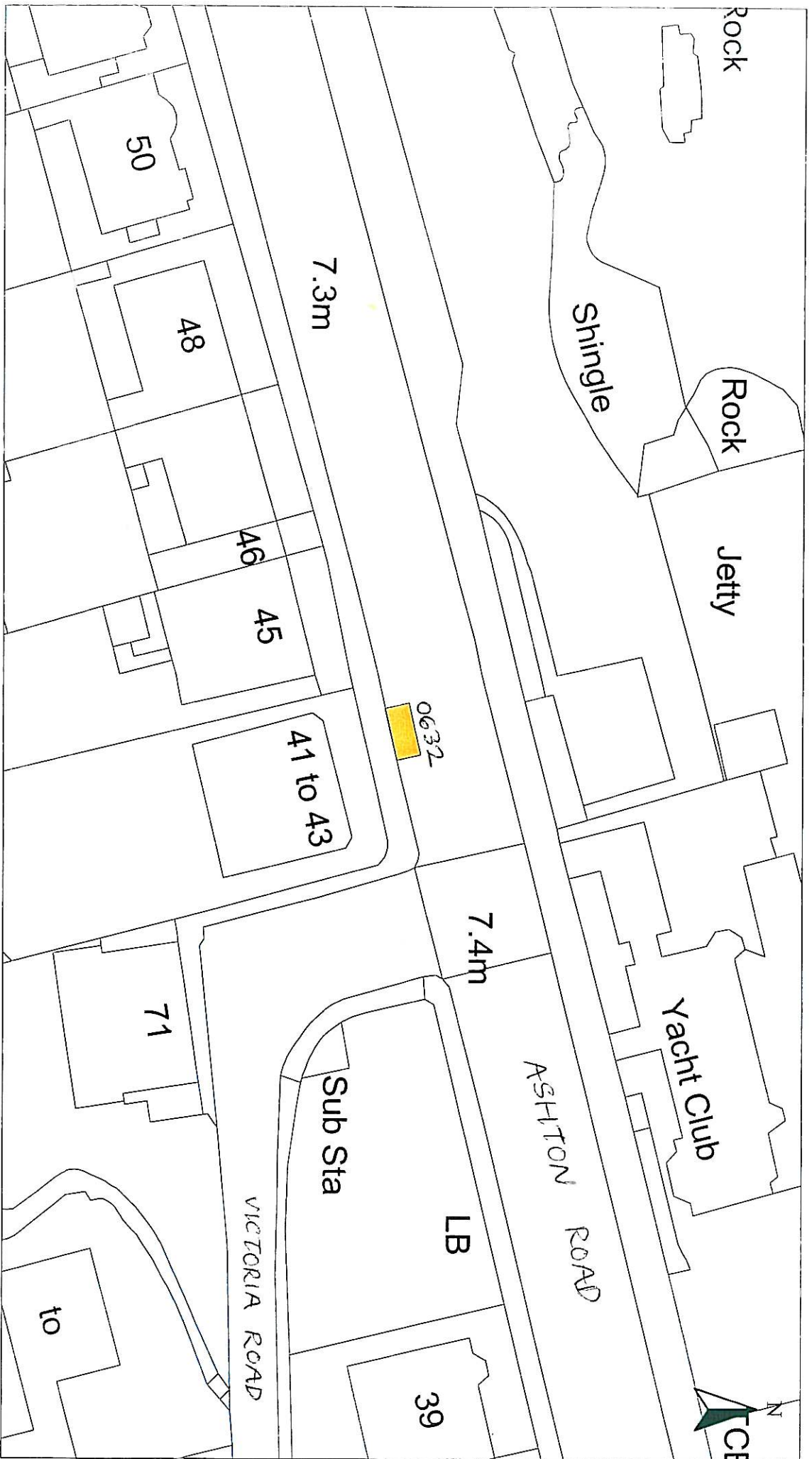

|  |           |  |          |
|--|-----------|--|----------|
| HEAD OF SERVICE<br>ALAN G BARNES MCIWM CENV  |           | Disabled Bays<br>71 EAST HAMILTON STREET<br>GREENOCK, PAIS 2UA |          |
| Retrieved from Ordnance Survey mapping with the permission of the Controller of Her Majesty's Stationery Office. Crown Copyright and may result in prosecution of right proceedings. |           |  |          |
| License No. LA03097L   |           |  |          |
| DISABLED PERSONS' PARKING PLACE<br>41 ASHTON ROAD, GOUROCK<br>PLACE No. 0632 REVOCATION  |           |  |          |
| Scale :  | 1:500     | Date :   | NOV 2010 |
| Prepared by :  | R. MACKAY | Checked by :   |          |
| Drawn by :   | R. MACKAY | Approved by :  |          |
| Drawing No. :  |           | File No. :   | 19/12    |

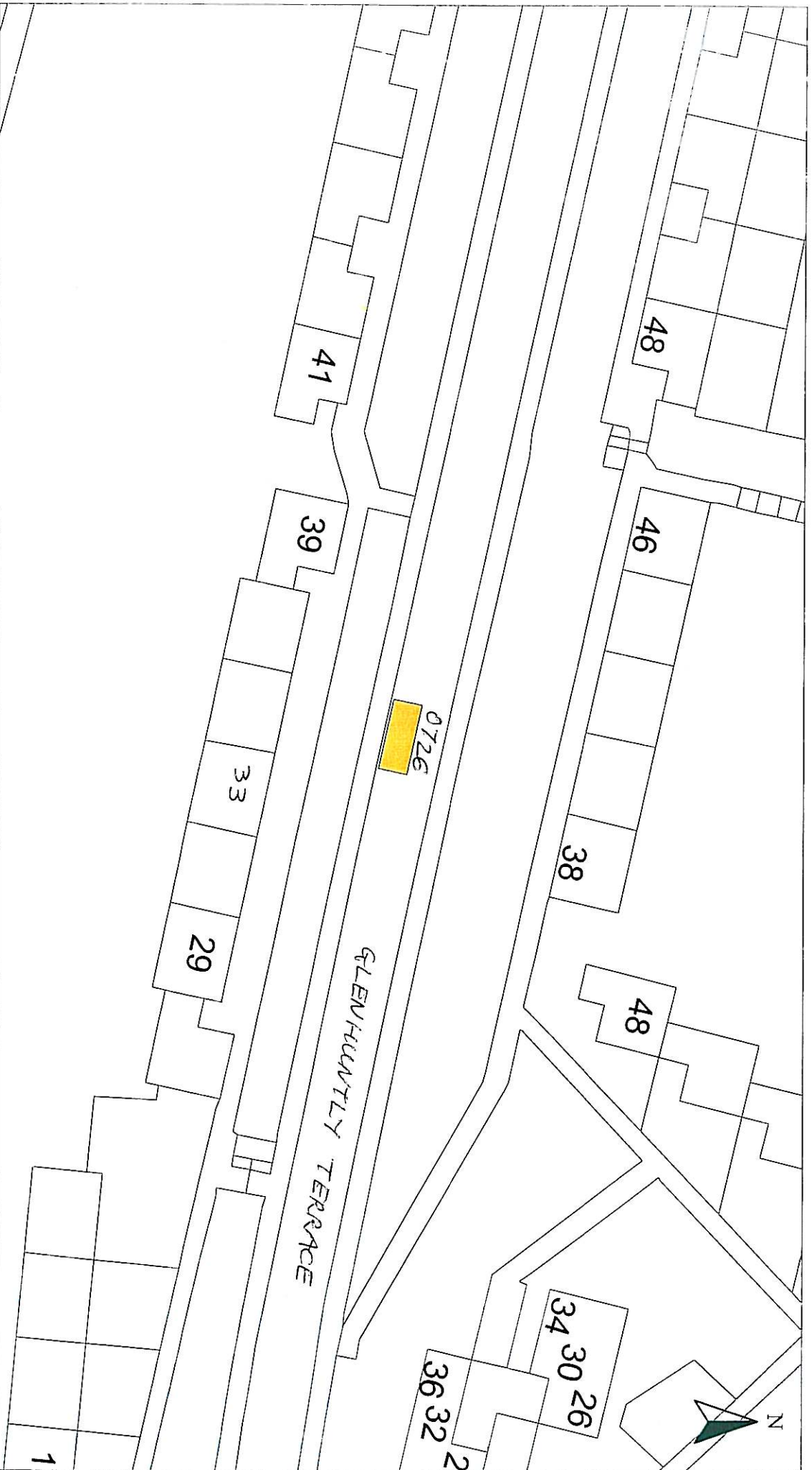

HEAD OF SERVICE  
ALAN G BARNES MCJWM CENV

Disabled Bays

71 EAST HAMILTON STREET  
GREENOCK, PAIS 2UA

Reproduced from Ordnance Survey mapping with the permission of the Controller of Her Majesty's Stationery Office. Crown Copyright. Unauthorised reproduction infringes Crown Copyright and may result in prosecution or legal proceedings.

Licence No. LA03097L



DISABLED PERSONS' PARKING PLACE

33 GLENHUNTLY TERR, PORT GLASGOW  
PLACE No. 0726 REVOCATION

Scale : 1:500

Date : NOV 2010

Prepared by : R. MACKAY

Checked by :

Drawn by : R. MACKAY

Approved by :

Drawing No. :

File No. : 19/12

# Inverclyde council

## ENVIRONMENTAL & COMMERCIAL SERVICES

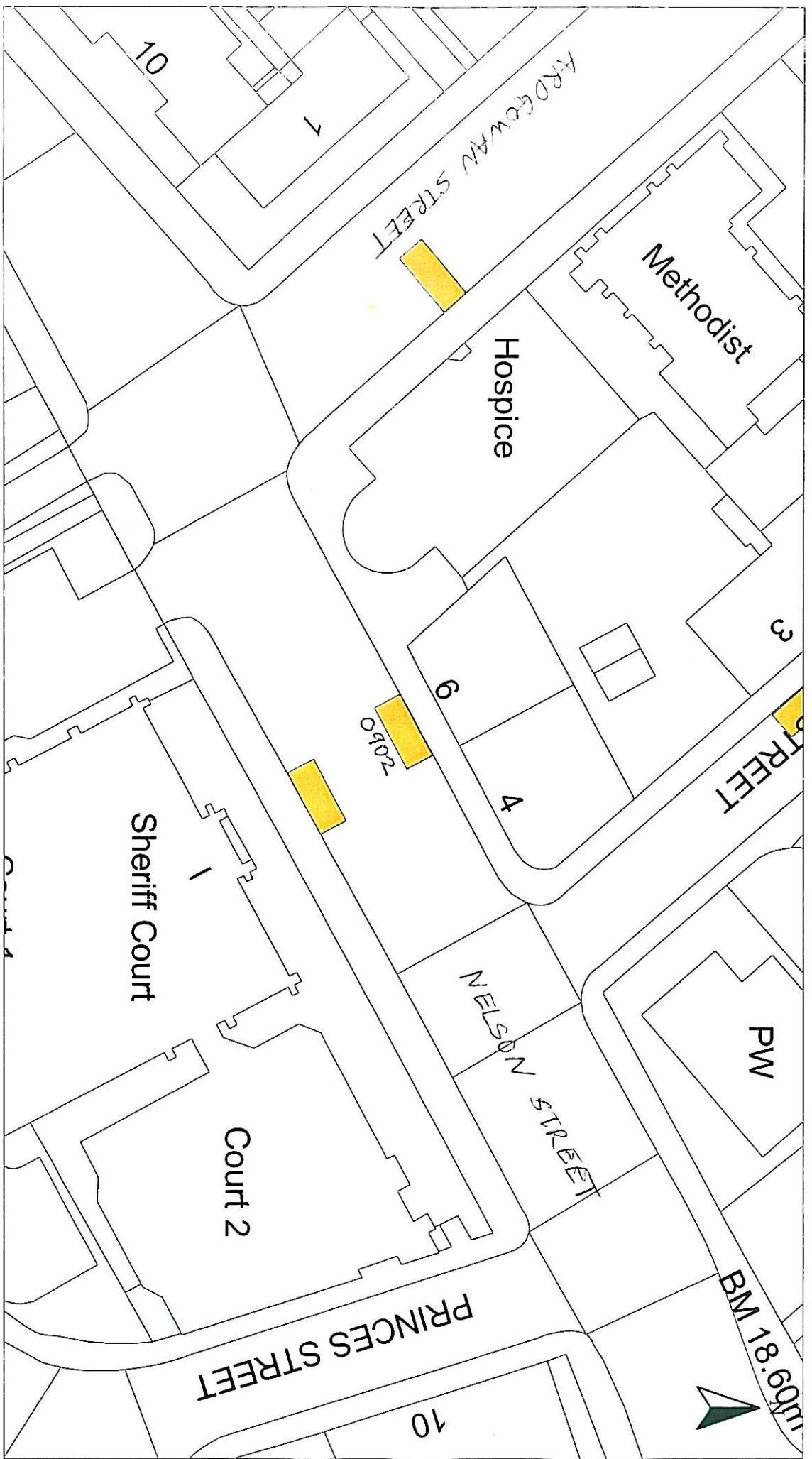

HEAD OF SERVICE  
 ALAN G BARNES MCIWM CENV  
 71 EAST HAMILTON STREET  
 GREENOCK, PA15 2UA

Reproduced from Ordnance Survey mapping with the permission of the Controller of Her Majesty's Stationery Office. Crown Copyright. Unauthorised reproduction infringes Crown copyright and may result in prosecution or legal proceedings.  
 Licence No. LA03097L  

DISABLED PERSONS' PARKING PLACE  
 6 NELSON STREET, GREENOCK  
 PLACE No. 0902 REVOCATION

|               |           |               |          |
|---------------|-----------|---------------|----------|
| Scale :       | 1:500     | Date :        | NOV 2010 |
| Prepared by : | R. MACKAY | Checked by :  |          |
| Drawn by :    | R. MACKAY | Approved by : |          |
| Drawing No. : |           | File No. :    | 19/12    |



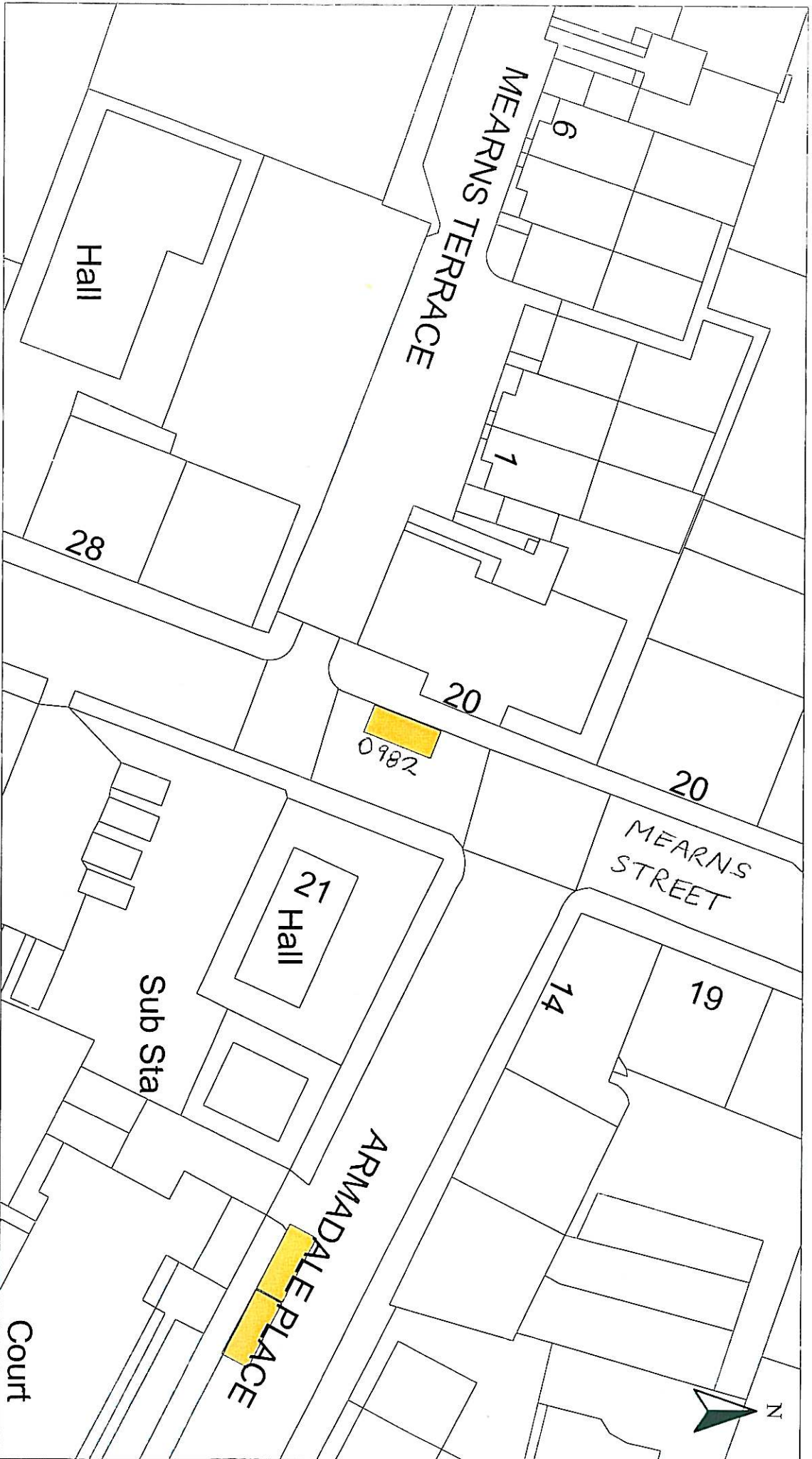

HEAD OF SERVICE  
ALAN G BARNES MCIMM CENV

71 EAST HAMILTON STREET  
GREENOCK, PA15 2UA

Disabled Bays

Reproduced from Ordnance Survey mapping with the permission of the Controller of Her Majesty's Stationery Office. Copyright. Unauthorised reproduction infringes Crown Copyright and may result in prosecution or legal proceedings.

Licence No. LA030971

DISABLED PERSONS' PARKING PLACE  
22 MEARN'S STREET, GREENOCK  
PLACE No. 0982 REVOCATION

|               |           |               |          |
|---------------|-----------|---------------|----------|
| Scale :       | 1:500     | Date :        | NOV 2010 |
| Prepared by : | R. MACKAY | Checked by :  |          |
| Drawn by :    | R. MACKAY | Approved by : |          |
| Drawing No. : |           | File No. :    | 19/12    |